

At a glance

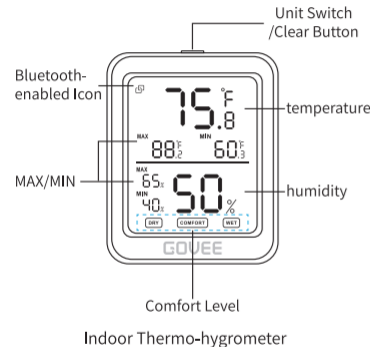

1

Unit Switch/Clear Button

Tap to switch temp unit to °C/°F on LCD screen. Press and hold for 3 seconds to clear MAX and MIN records for temp and humidity.

MAX/MIN

Maximum/Minimum temp and humidity readings in the past.

Comfort Level

DRY	Humidity is below 30%.
COMFORT	Humidity is between 30% - 60%, while temp is 20°C - 26°C.
WET	Humidity is above 60%.
Elsewise	No icon.

Bluetooth-enabled Icon

Display	Bluetooth is connected
Not shown	Bluetooth isn't connected.

2

Specification

Accuracy	Temp: $\pm 0.3^{\circ}\text{C}$ Humidity: $\pm 3\%$
Operating Temp	0°C - 50°C (32°F - 122°F)
Operating Humidity	0% - 99%
Bluetooth-enabled Distance	50m/164ft (No obstacles)

Installing Your Device

- 1 Place in the battery (Make sure the electrode direction match is correct).

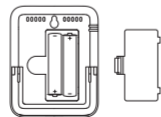

3

2 Install.

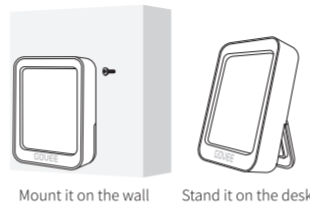

Mount it on the wall

Stand it on the desk

4

Downloading the Govee Home App

- Download the GoveeHome app from the App Store (iOS devices) or Google Play (Android devices).

- A smart phone or tablet running IOS 9.3 (or above) or Android 4.3 (or above).



Connecting to Bluetooth

- 1 Turn on Bluetooth in your phone and get close to the thermo-hygrometer (Location Services/GPS should be turned on for Android users).

5

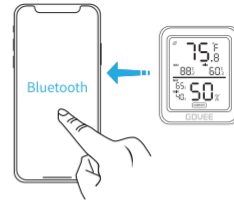

- 2 Open Govee Home, tap "+" icon at the top right corner and select "H5075".

- 3 Follow instructions in App to complete connecting.

- 4 It shows Bluetooth-enabled icon on LCD screen after successful connection.



- 5 Please check the above steps and try again if connection fails.

6

We are devoted to offer you a better user experience with our smart and connected technology.

interference will not occur in a particular installation. If this equipment does cause harmful interference to radio or television reception, which can be determined by turning the equipment off and on, the user is encouraged to try to correct the interference by one or more of the following measures:

- 1.Reorient or relocate the receiving antenna.
- 2.Increase the separation between the equipment and receiver.
- 3.Connect the equipment into an outlet on a circuit different from that to which the receiver is connected.
- 4.Consult the dealer or an experienced radio/TV technician for help.

FCC Radiation Exposure Statement

This equipment complies with FCC radiation exposure limits set forth for an uncontrolled environment. This equipment should be installed and operated with minimum distance 20cm between the radiator & your body.

FCC STATEMENT

This device complies with Part 15 of the FCC Rules. Operation is subject to the following two conditions:(1) This device may not cause harmful interference, and (2) This device must accept any interference received, including interference that may cause undesired operation.Warning: Changes or modifications not expressly approved by the party responsible for compliance could void the user's authority to operate the equipment.

NOTE: This equipment has been tested and found to comply with the limits for a Class B digital device, pursuant to Part 15 of the FCC Rules.

These limits are designed to provide reasonable protection against harmful interference in a residential installation. This equipment generates uses and can radiate radio frequency energy and, if not installed and used in accordance with the instructions, may cause harmful interference to radio communications. However, there is no guarantee that

Warring

- 1 Keep the device work within range of operating temp and humidity.
- 2 Please take out the battery if you don't use it for a long time.
- 3 Don't disassemble the device privately.

Customer Service

- Warranty: 12-Month Limited Warranty
- Support: Lifetime Technical Support
- Email: support@govee.com
- Official Website: www.govee.com
- @Govee @Govee @Govee
- @Goveeofficial

- 3 Data in App cannot be refreshed.
 - a. Check whether Bluetooth in your phone is turned on.
 - b. Keep your phone close to the thermo-hygrometer.

- 4 No/Delayed message alerts in App.
 - a. Make sure Bluetooth in your phone is turned on.
 - b. Check whether Govee Home is allowed in your phone.

Troubleshooting

- 1 Incomplete readings showing on LCD screen.
 - a. Check whether the battery compacity is low or battery installation is incorrect.
 - b. Make sure it works within range of operating temp and humidity.
 - c. Avoid falling from high places.

- 2 Cannot manage the device with App.

Make sure your phone is within Bluetooth-enabled range.

Using the Thermo-hygrometer with Govee Home

Alarm me

Message Alert:
App pushes alert messages once temp/humidity is beyond preset range.

Temperature unit °F °C

Unit Switch:
Switch temp unit to °C/°F in App.

--.- °F

--.- %

Calibration: Calibrate temp/humidity.