

At a glance

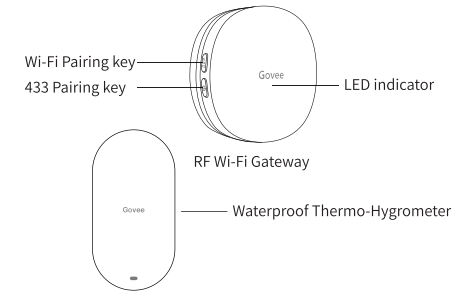

RF Wi-Fi Gateway

Wi-Fi pairing button:For pairing network and the gateway.
433 pairing button:For pairing sensor and the gateway.
LED indicator:For reflecting the status of the gateway:

Blue light is always on	Wi-Fi connection is normal
Red light is always on	Wi-Fi connection failed
Blue light flashes slowly	Wi-Fi pairing mode
Red and blue lights flash alternately	Searching for sensor
Blue light flashes quickly	The gateway is connecting

Specification

RF Wi-Fi Gateway	
Voltage	AC110-240V 50/60Hz
Wi-Fi frequency	2.4Ghz
Wi-Fi working distance	30m/100ft
RF working frequency	433MHZ
RF working distance (in open ground)	100m/328ft

Waterproof Thermo-Hygrometer	
Voltage	DC 3V
Working distance (in open ground)	100m/328ft
Accuracy	Temp: ±0.3°C, Humidity: ±3%
Operating temperature	-20°C~60°C (4°F ~140°F)
Operating humidity	0% - 99%

Installation

- 1.Plug the gateway into the socket;
- 2.Pull out the battery insulation sheet;

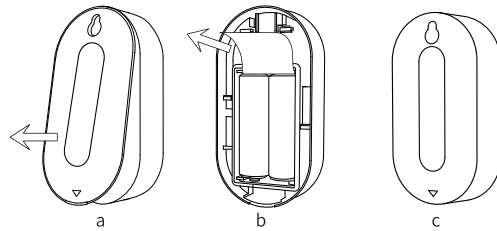

3.Place the sensor.

Govee Home App

What you need:

- A Wi-Fi router supporting the 2.4GHz (not 5 GHz) and 802.11 b/g/n bands. Please check your network information before you try to connect.
- A smart phone or tablet which could be connected to a 2.4Ghz Wi-Fi network and runs IOS 9.3 system(or above) or Android 4.3 system (or above).

Download the GoveeHome app from the App Store (IOS devices) or Google Play (Android devices).



Connection

Note: Please make sure the Wi-Fi network is 2.4GHz and 802.11 b/g/n bands before you start to connect gateway to the network.

- 1 Connect your phone with family Wi-Fi network first;
- 2 Open the app, tap "+" icon at the top right corner and select "H5040"or"H5053";
- 3 Gateway enters into the pairing mode;

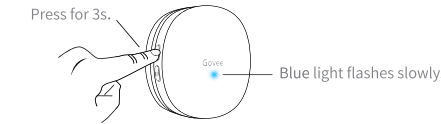

4 Set family Wi-Fi information;

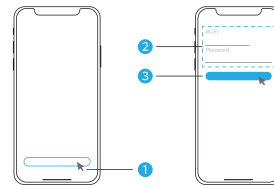

5 Enter into Wi-Fi setting page of your phone;

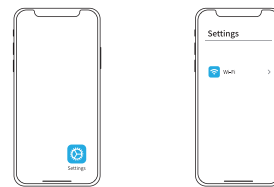

6 Connect gateway Wi-Fi;

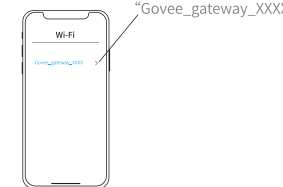

7 Return to APP;

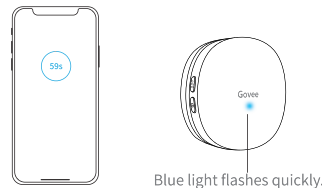

8 Connection succeeded.

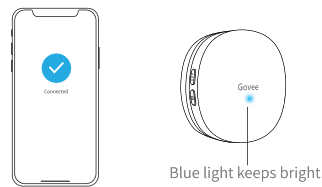

9 Connection failed.

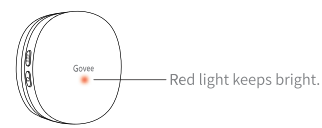

Please recheck the above steps and try again.

We are devoted to offer you a better user experience with our smart and connected technology.

Using your device

1 Controlling your devices with the Govee-Home app.

Alarm me	<input type="checkbox"/>
Alarm me	<input checked="" type="checkbox"/>
Message Alert: App pushes alert messages once temp/humidity is beyond preset range.	

Export data
Export Data: Export data in CSV format after filling in email and time slot.

Temperature unit	<input checked="" type="radio"/> °F <input type="radio"/> °C
Unit Switch: Switch temp unit in App (Note: Temp unit in export data is the same as that in App)	

--.- °F	<input type="button" value="-"/> <input type="button" value="+"/>
--.- %	<input type="button" value="-"/> <input type="button" value="+"/>
Calibration: Calibrate temp/humidity data	

2 Add sensor

Please refer to the following steps to add sensor or re-add sensor back:

1. Gateway enters into the pairing mode.

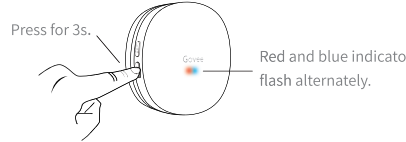

2. Sensor sends the pairing signal.

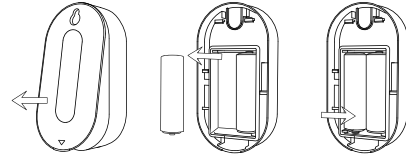

Pull out the batteries and then place batteries back.

3. Gateway receives the signal.

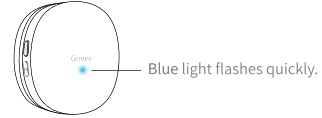

4. Connection succeeded.

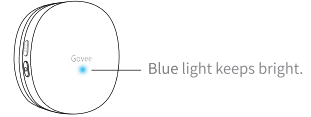

Attention:

- a. If you have not paired the gateway and sensor successfully within 30s, the gateway indicator will turn blue automatically and flash quickly, and then exit the pairing mode;
- b. If the connection fails, please carefully check the above steps and repeat the attempts.

Troubleshooting and Warning

Troubleshooting

1. The gateway could not be connected to the Wi-Fi network or the connection is unstable?
 - a. Product supports only 2.4 GHz (not 5 GHz) network.
 - b. Check the name of the network and the password. Please try to avoid special characters.
 - c. The device should be placed within the coverage of the router signal. Please keep the distance between the gateway and the router in 30 meters (100ft) .
 - d. Reduce barriers like metal door or multiple / heavy walls; gateway and the router in 30 meters (100ft) .
2. The sensors do not work?
 - a. Pull out the insulation sheet before using.
 - b. Check the battery capacity.
 - c. Check if the sensor installed correctly.
3. The app alarm is delayed or no alarm?
 - a. Turn on the relevant permissions to the "GoveeHome" APP.
 - b. Shorten the distance and reduce the barriers between the sensor and gateway.

4. The sensor faults or misses some data?

- a. Shorten the distance and reduce the barriers between the sensor and gateway.
- b. Please remove all the H5053 devices in the APP and then re-pair.
- c. Replace the battery.

Warning

1. Please ensure that the product works within the specified temperature and humidity range.
2. Please do not violently disassemble the product.

Customer Service

Warranty: 12-Month Limited Warranty

Support: Lifetime Technical Support

Email: support@govee.com

Official Website: www.govee.com

@Govee @Govee @Govee @Goveeofficial

FCC STATEMENT

This device complies with Part 15 of the FCC Rules. Operation is subject to the following two conditions:
(1) This device may not cause harmful interference, and (2) This device must accept any interference received, including interference that may cause undesired operation.
Warning: Changes or modifications not expressly approved by the party responsible for compliance could void the user's authority to operate the equipment.

NOTE: This equipment has been tested and found to comply with the limits for a Class B digital device, pursuant to Part 15 of the FCC Rules.

These limits are designed to provide reasonable protection against harmful interference in a residential installation. This equipment generates uses and can radiate radio frequency energy and, if not installed and used in accordance with the instructions, may cause harmful interference to radio communications. However, there is no guarantee that interference will not occur in a particular installation. If this equipment does cause harmful interference to radio or television reception, which can be determined by turning the equipment off and on, the user is encouraged to try to correct the interference by one or more of the following measures:

- 1.Reorient or relocate the receiving antenna.
- 2.Increase the separation between the equipment and receiver.
- 3.Connect the equipment into an outlet on a circuit different from that to which the receiver is connected.
- 4.Consult the dealer or an experienced radio/TV technician for help.

RF Warning Statement: This device has been evaluated to meet general RF exposure requirement. The device can be used in portable exposure condition without restriction.



User Manual

MODEL: H5053+H5040
Wireless Thermo-Hygrometer With
Wi-Fi Gateway

H5040+H5053说明书

版本:3.0

料号:836-5040-23501

折叠尺寸:75×105(mm)

展开尺寸:525×105(mm)

材质:100G书页纸

工艺:四色印刷

