

Einbauanweisungen / INSTALLATION INSTRUCTIONS

Der Einsatz von Schlagschraubern ist nicht zulaessig.
USE OF AN IMPACT WRENCH IS NOT ALLOWED.

Ebenheit der ECU Anschraubflaeche am Fahrzeug: $\square 0,8\text{mm}$
FLATNESS OF ECU MOUNTING AREA AT THE VEHICLE: $\square 0,8\text{mm}$

Erhöhung auf der Ebene zwischen den Befestigungspunkten sind bis max. 0,4mm zulaessig.
PEAKS ON PLAIN BETWEEN MOUNTING POINTS MUST NOT BE MORE THAN 0,4mm.

Stecksystem (Stecker, Kabel, Kabelbinder) nach Kundenangaben.
Kunde stellt Dauerfestigkeit in eigener Verantwortung sicher.
Für Maengel keine KB-Gewahrleistung.
CONNECTOR SYSTEM (CONNECTOR, CABLE, TIE-WRAPS) DEFINED BY CUSTOMER.
LIFETIME DURABILITY IS WITHIN CUSTOMERS RESPONSIBILITY ONLY:
NO KB-WARRANTY FOR DEFECTS OR MALFUNCTION.

Steckerpins dürfen nicht beruehrt werden. ESD Schutz muß gewährleistet sein.
IT'S NOT ALLOWED TO TOUCH THE CONNECTOR PINS. ESD PROTECTION HAS TO BE ENSURED.

Einbaulage: Steckerleiste nach unten siehe Y182151
INSTALLATION: CONNECTOR STRIP DOWNWARDS SEE Y182151

Spannung: VOLTAGE:	Nennspannung NOMINAL VOLTAGE	8V - 32V
Betriebstemperatur OPERATION TEMPERATURE		-30 °C TO +65 °C
Lagerbedingungen STORAGE CONDITIONS		-20 °C TO +50 °C HUMIDITY MAX. 50 %
Schutzart nach ISO 20653 Elektronikraum (alle Kabelbaumstecker gesteckt) ELECTRONIC AREA (ALL HARNESS-PLUGS MOUNTED) PROTECTION CLASS ACC. TO ISO 20653		IP 6K9K

Disclaimer
The information contained herein is intended for the exclusive use of trained persons within the commercial vehicle industry. This product or component may be suitable only for the specific application set forth herein. Statements regarding the suitability of products for certain types of applications are based on Knorr-Bremse understanding of typical requirements. Such statements, however, are not binding statements about the suitability of products for any different application. It is at all times the user's responsibility to validate the suitability of a particular product for use in a different application than contained herein. This information does not purport to be all-inclusive and no responsibility is assumed as a result of its use. In no event may we be held liable for any damage or loss except in the case of willful intent or gross negligence on our part, or if any mandatory legal provisions apply.

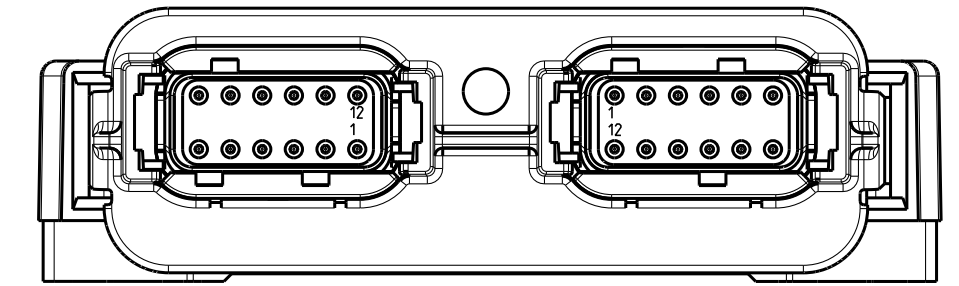
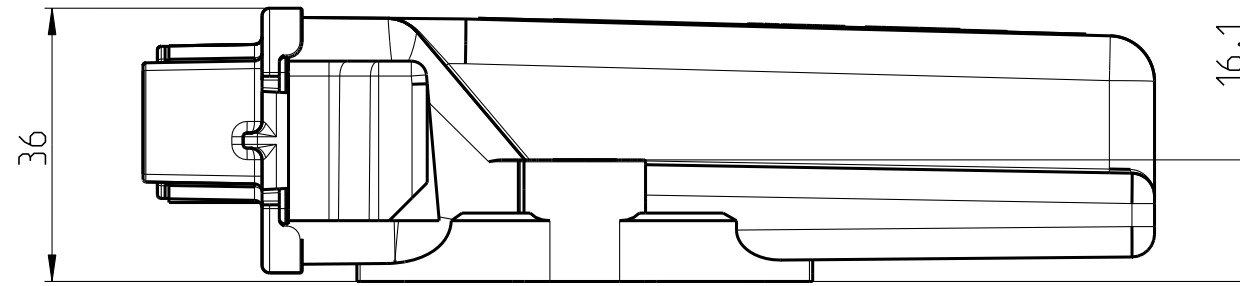

X1
DTM13-12PA-R008
KEY A

X2
DTM13-12PB-R008
KEY B

OR DUMMY PLUG CODE B
K108022
must be ordered extra as
a special accessory

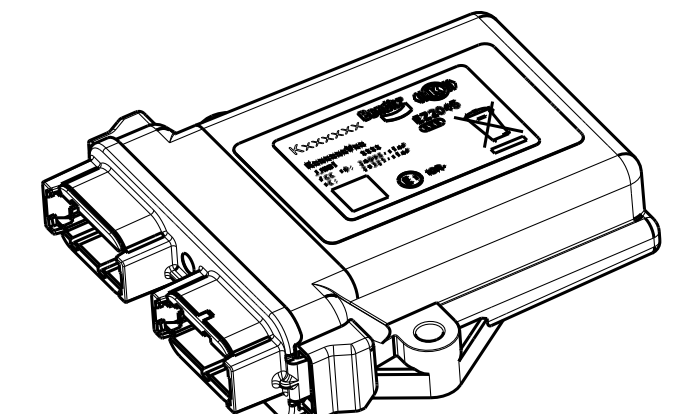
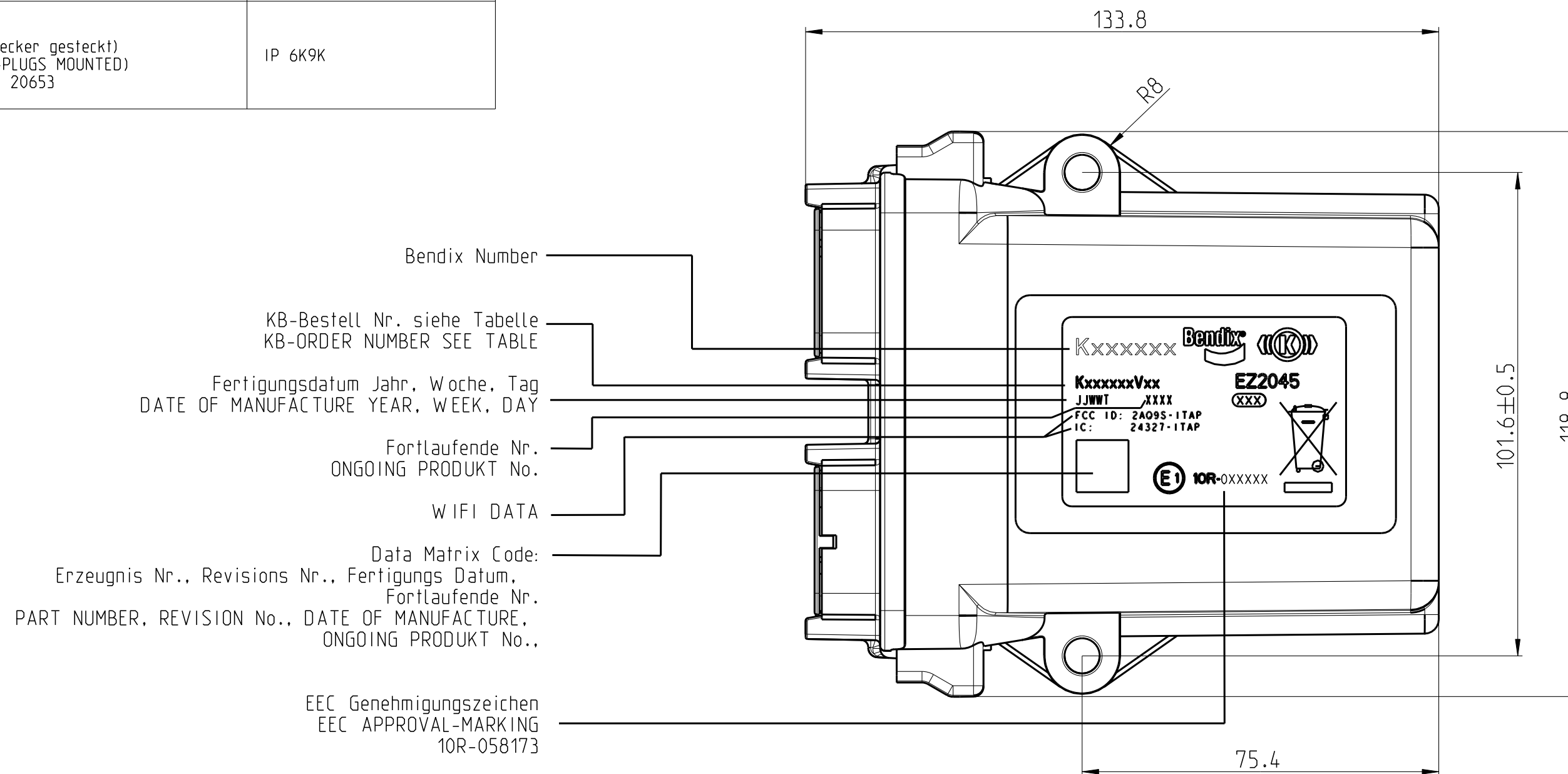

1:2

K167205	Y250787	K168856	i-TAP Camera
KB-Bestell Nr. KB-ORDER NUMBER	TKU TECHNICAL CUST. INFORM.	Bendix Number	Bemerkung REMARKS

000 New Release	18-09-18 kudalkah		
Rev.	Revision Reference	Date	Name
Numbers of described parts:	ISO 128-30	Special Characteristics:	Surface Treatment: Length Unit: mm Scale: 1:1
See Table 1	First Angle Proj.	Tolerancing Principle +-1 mm	Material: -x- Weight: ca. 0.275 kg
CAD Model No.:	M269086	General Tolerances DIN 7167	Made from:
KNORR-BREMSE	Systeme für Nutzfahrzeuge GmbH	ISO13715	ECU
		CAD Sys.: PRO/ENGINEER	Elektr. Steuergeraet
		Responsible Dept./Team	iTAP Camera
		Drawn	2018/08/01 Kudalkar
		Release Process Documentation in EDM, Level and Status Information in Watermark.	Drawing Number: Z227360
			Doc-Type: ID Language: 52
			Drw-Rev: 000
			Sheet 1 of 1

This document contains proprietary and confidential information and such information may not be disclosed to others for any purpose or used in any way without written consent from the KNORR-BREMSE Organisation