

Easyfone

KW2 Kids Smartwatch User Manual

1. What's in the box

Kids Smart Watch	Charging Cable	User Manual	SIM Card Picker	speedtalk Activation Guide
1	1	1	1	1



1

2. Kids smartwatch display

Front side:

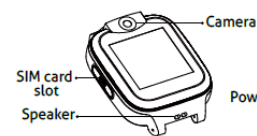

Back side:

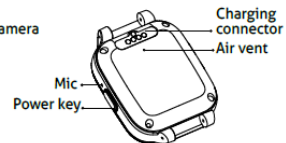

Remind: Do not poke the mic and air vent with sharp objects such as card removal pins.

2

SHENZHEN TIANLUNLE TECHNOLOGY CO., LIMITED

Customer Service E-mail: support@easyfone.com.cn

WhatsApp: +86 135 1071 9880

Facebook: www.facebook.com/Easyfone.Products

FC IC

10. Charging

Please align charging contacts of the watch with metallic contacts on the charging cable until charging power indicator appears on watch screen.

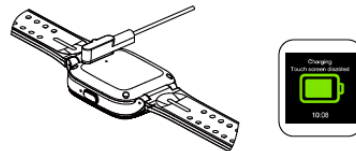

10

11. Basic function



Chat

Click "Chat", On "Chat" page, press and hold "HOLD" to record voice, and then release to send voice. Click the unread message on the screen to play voice message.



Phone

Click "Phone", Select contact to make a phone call; if can't make a call, please check whether contact is added on APP.

11

3. Activate the SIM card plan

For US customers

The smartwatch come with an included pre-installed SpeedTalk SIM card, Scan the below QR code or visit www.activatespeedtalk.com to enter SIM card number to activate and select your SIM card plan.



Note: Do not power on the watch until activation is done.

3

For customers outside the US

Package NOT included a SIM card.

This is an unlocked 4G device, It allows you to choose your prefer local 4G network carriers as the network provider.

SIM Card Size: Nano Size SIM Card.



4

4. SIM card installation

US customers can ignore this steps

Please read carefully before turn on watch to avoid any abnormal caused by wrong card installation.



1. Pull out SIM card via card picker.

2. Put the SIM card into card slot, chip upside, and insert to watch.

Note: For new SIM card, do not install the SIM card until activation is done.

5



Video call

Click "Video call", Select contact and select video chat.

Remind: Long video calls will cause the watch to heat up. Please do not make video calls for a long time. Please do not wear the watch when the high temperature alarm pops up. Wear the watch after the temperature drops to avoid high temperature scald.



Camera

Click "Camera" to start to take pictures. You can view and delete photos in "Gallery".

12



Add friends

Click "Add friends", After insert SIM card, On "Add Friends" page, one-tap to add friends, and it will search to add friends automatically.



Steps

Click "steps", you can view the number of daily steps.

13



VoiceRecord

Click "VoiceRecord", You can record or view more recordings.

Positioning

Turn on App, click "location" to check GPS track and positioning.

14

5. Download "Trackino" APP

Download "Trackino" APP on your own device through followed methods:

1. Scan QR code to download APP.
2. Download from iOS App store and Google Play Store.



Download on the App Store



Download on the Google Play

6

6. Register & Login with "Trackino"

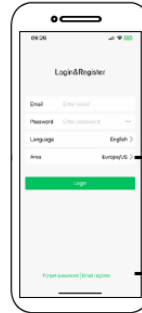

Register with Email

Note:
Area - Please choose Europe/US.

Click Email register.

7

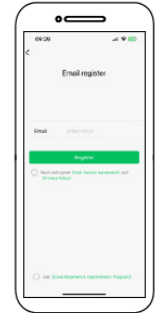

Enter email

12. Specifications

Specifications	
Size	55x42.6x15.5mm
Color	Red/Green
Display	1.4-inch IPS display, resolution of 240x240
Memory	ROM:128MB RAM:48MB
Sensor	Accelerometer

19

Positioning	GPS/LBS/A-GPS
Battery	720mAh
Camera	0.3MP
System	Easyfone OS
Package Contents	Kids Smartwatch x1 Charging Cable x1 User Manual x1 SIM Card Picker x1 speedtalk Activation Guide x1 (For US customers only)

20

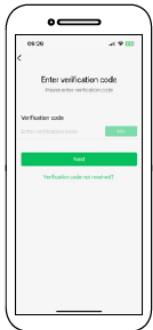

Enter verification code

8

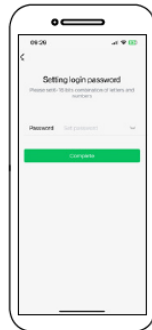

Setting login password

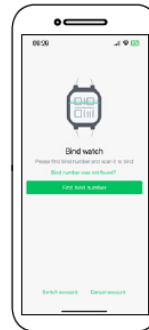

Bind watch

9



Scan watch QR code

13. FCC Statement

Any Changes or modifications not expressly approved by the party responsible for compliance could void the user's authority to operate the equipment. This device complies with part 15 of the FCC Rules. Operation is subject to the following two conditions: (1) This device may not cause harmful interference, and (2) this device must accept any interference received, including interference that may cause undesired operation.

Note: This equipment has been tested and found to comply with the limits for a Class B digital device, pursuant to part 15 of the FCC Rules. These limits are designed to provide reasonable protection against harmful interference in a residential installation.

21

This equipment generates, uses and can radiate radio frequency energy and, if not installed and used in accordance with the instructions, may cause harmful interference to radio communications. However, there is no guarantee that interference will not occur in a particular installation. If this equipment does cause harmful interference to radio or television reception, which can be determined by turning the equipment off and on, the user is encouraged to try to correct the interference by one or more of the following measures:

- Reorient or relocate the receiving antenna.
- Increase the separation between the equipment and receiver.
- Connect the equipment into an outlet on a circuit different from

22

7. Scan QR code and bind watch

1. Turn on App and login.
2. Turn to bind watch interface, tap "Find bind number" and scan QR code to bind watch.

Obtain code:



1. Slide left on main interface to find Bind function, click it to enter and obtain bind code.
2. Scan QR code or enter the bind code manually.

10

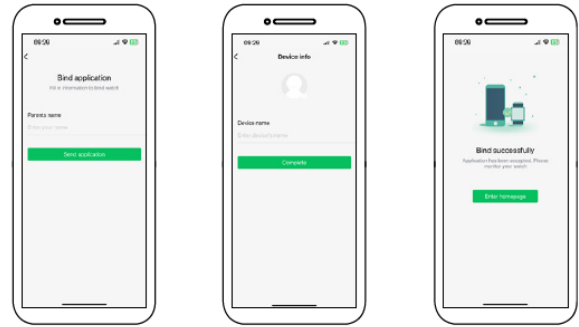

Enter your name

Enter watch's name

Bind successfully

11

that to which the receiver is connected.

—Consult the dealer or an experienced radio/TV technician for help.

The device has been tested and complies with FCC/ISED SAR limits.

Le dispositif a été testé et est conforme aux limites de la FCC/ISED SAR.

This device complies with Innovation, Science and Economic Development Canada Compliance licence-exempt RSS standard (s).

23

Operation is subject to the following two conditions: (1) this device may not cause interference, and (2) this device must accept any interference, including interference that may cause undesired operation of the device.

Le présent appareil est conforme aux CNR d'Innovation, Sciences et Développement économique Canada applicables aux appareils radio exempts de licence.

L'exploitation est autorisée aux deux conditions suivantes:

- (1) l'appareil ne doit pas produire de brouillage, et
- (2) l'utilisateur de l'appareil doit accepter tout brouillage radioélectrique subi, même si le brouillage est susceptible d'en compromettre le fonctionnement.

24

8. Function button operation



Function Button

- Long press to turn on (If watch can't turn on, please confirm whether watch is out of power)
- Short press to turn off/on screen
- One-tap SOS
Long press for 3s to send emergency call (Need to set emergency contact person in APP)

Remind: If the new watch cannot be turned on, it is likely that the watch is out of power. Please plug in the charging cable until the watch shows the charging interface.

12

9. Basic operation

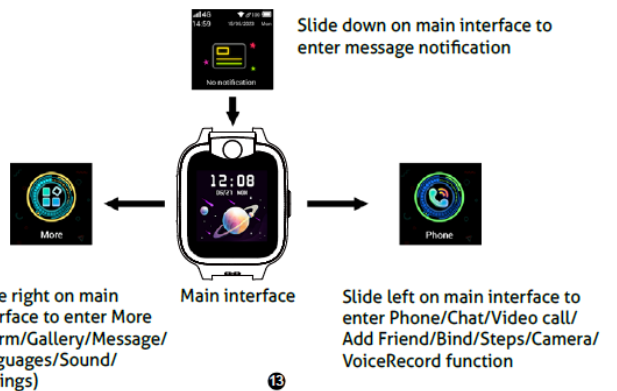

Slide right on main interface to enter More (Alarm/Gallery/Message/Languages/Sound/Settings)

Slide left on main interface to enter Phone/Chat/Video call/Add Friend/Bind/Steps/Camera/VoiceRecord function

13

25

26