



PolaroidWave
Underwater Streaming Camera

User Manual



What's Included

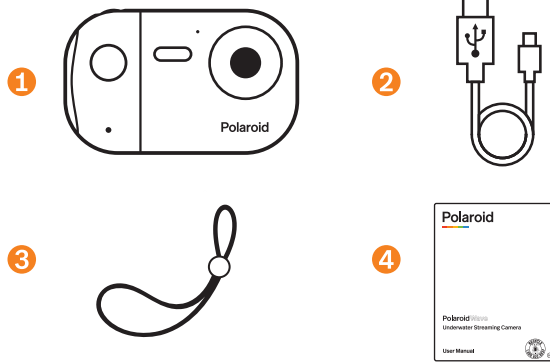

- 1 Polaroid Wave underwater camera
- 2 USB charging cable
- 3 Wrist strap
- 4 User Manual

Micro SD memory card NOT included

A Quick Look at Your Camera

- ① Power / OK button
- ② Shutter release
- ③ LED flash light
- ④ Selfie indicator
- ⑤ Lens
- ⑥ Microphone
- ⑦ 2.4" LCD preview screen
- ⑧ Busy indicator
- ⑨ Mode / Menu button
- ⑩ Zoom in button
- ⑪ Zoom out button
- ⑫ Port cover
- ⑬ Micro USB port
- ⑭ Micro SD memory card slot

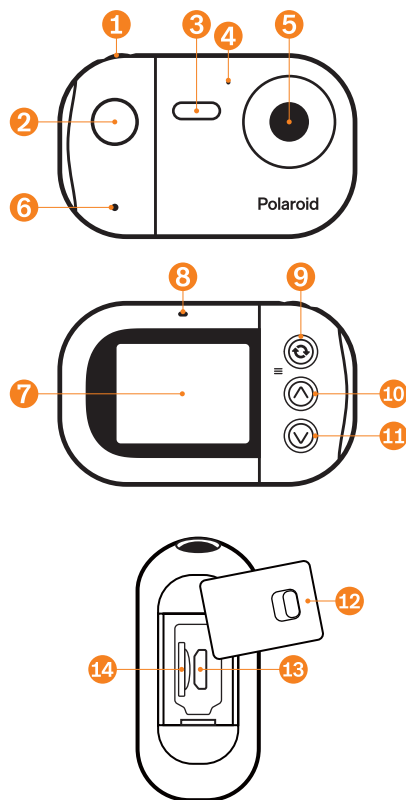

Inserting a Memory Card

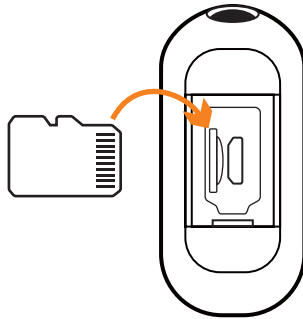

Before turning on your camera, insert a Micro SD memory card (NOT included) into the **memory card slot** . The memory card is needed in order to store photos or videos.

Note: Class 4 or higher Micro SD memory cards are supported (up to 64GB).

Charging Your Camera

Your camera has a built-in lithium-ion battery. To charge the battery, follow the below steps.

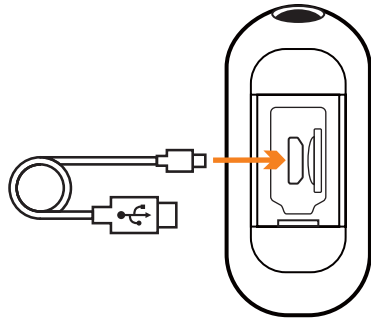

1. Insert the Micro USB end of the included **USB cable** into the Micro USB port  on your camera.

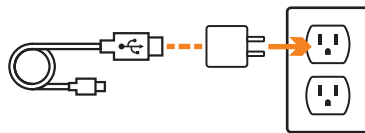

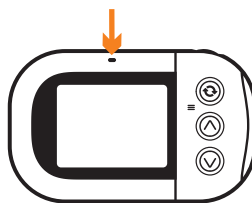

2. Insert the other end of the **USB cable** into the USB port of a computer or a suitable 5V / 1A USB charging adapter (NOT included).

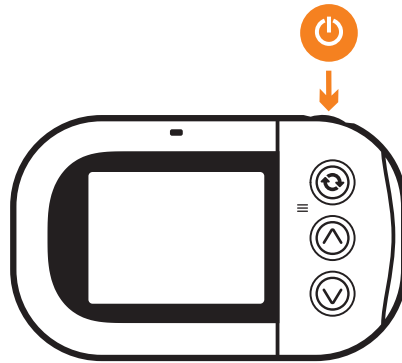

Note: A charging indicator light  will illuminate while charging and then turn off once charging is complete.

Turning On Your Camera



Press and hold the Power / OK button  for approximately 3-4 seconds to power on or power off your camera.

Note: Press and hold the Power/OK button for approximately 6-7 seconds to restart the camera if the camera freeze.

Changing Modes

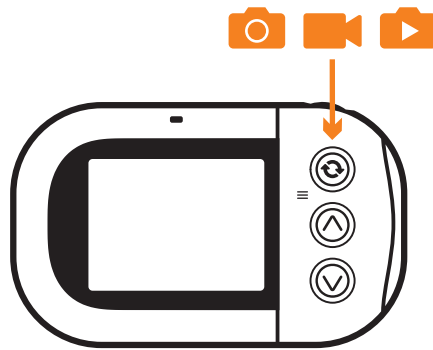

Once the camera is powered on, press the **Mode / Menu button**  repeatedly to switch between the camera's different modes.

The camera has three modes:



1. **Photo Capture Mode** : capturing photos
2. **Video Capture Mode** : recording video
3. **Playback Mode** : reviewing photos & videos

Photo Capture Mode



By default, when you first turn on your camera, it will be in **Photo Capture Mode**. Use this mode when you want to take photos.

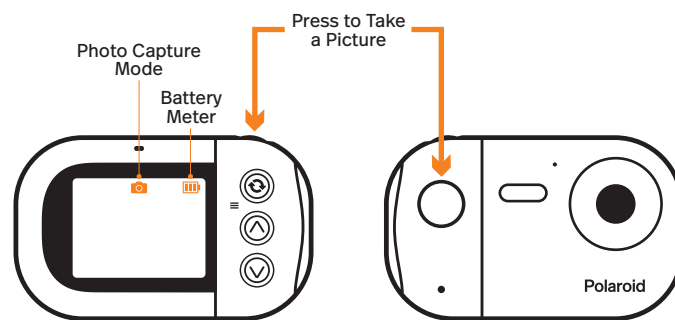

Press the **Power/ OK button 1** or **Shutter release 2** to take a picture.

Photos will automatically be recorded to the Micro SD memory card.

Photo Capture Mode Settings

While in **Photo Capture Mode** , press the **Mode / Menu button**  for approximately 2-3 seconds to access the **Photo Capture Mode Settings Menu**.

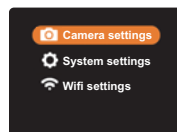
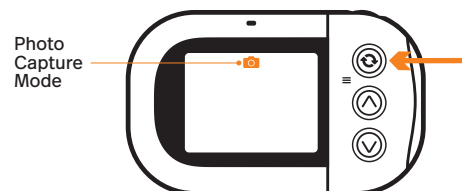

Make sure the **Camera settings** is selected on the on-screen menu, and press the **Power / OK button** .

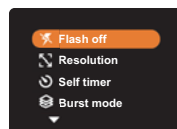

There are seven photo settings that can be adjusted:

- **Flash settings** allow you to turn on the camera's LED flash light while taking photos in a poorly lit area.
- **Resolution settings** determines the size and quality of the photo.
- **Self timer** allows you to take a photo after a selected amount of time.
- **Burst mode** allows you to take three photos instantaneously after the **Shutter release**  is pressed.
- **Metering** allows you to pick a pre-set that automatically adjusts light sensitivity.
- **Auto review** lets you choose if you want to view your photo immediately after shooting it.
- **White balance settings** attempt to balance out any color casts so that objects which appear white in person are rendered white in your photos.

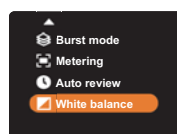

Video Capture Mode

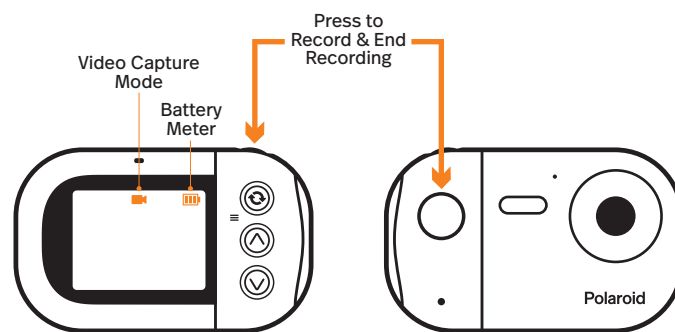

When you want to take a video, press the **Mode / Menu button** ③ repeatedly after turning on your camera to enter **Video Capture Mode**.





Press the **Power/ OK button** ① or **Shutter release** ② to begin recording video. Press it again to end your recording

Video will automatically be recorded to the Micro SD memory card.

Video Capture Mode Settings

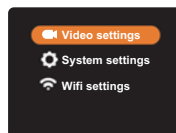
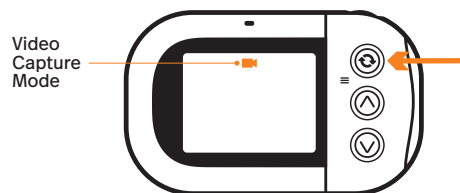
While in Video Capture Mode , press the Mode / Menu button  for approximately 2-3 seconds to access the Video Capture Mode Settings Menu.



Make sure the Video settings is selected on the on-screen menu, and press the Power / OK button .

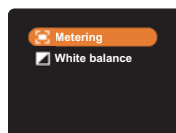

There are two video settings that can be adjusted:



- **Metering** allows you to pick a pre-set that automatically adjusts light sensitivity.
- **White balance settings** attempt to balance out any color casts so that objects appear which appear white in person are rendered white in your videos.

Playback Mode

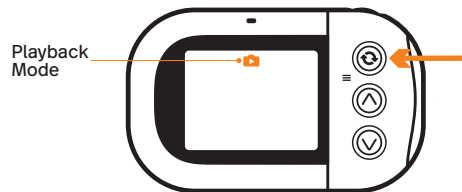

When you want to view the photos and videos you've taken, press the **Mode / Menu button**  repeatedly after turning on your camera to enter **Playback Mode**.



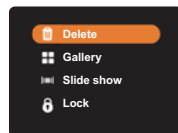

Playback Mode Settings

While in **Playback Mode** , press the **Mode / Menu button**  for approximately 2-3 seconds to access the **Playback Mode Settings Menu**.



- **Delete** allows you to delete a photo or video.
- **Gallery** allows you to view thumbnails of images and quickly select desired photos by using the **Zoom in**  (up) and **Zoom out**  (down) buttons.
- **Slide show** allows you to view your photos in succession.
- **Lock** can be selected to lock a photo or video in place so it can't be deleted without unlocking it.

General System Settings

When in Photo Capture  or Video Capture  Modes, you can press and hold the Mode / Menu button  for approximately 2-3 seconds to access the General System Settings.

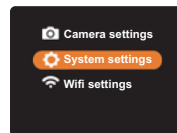
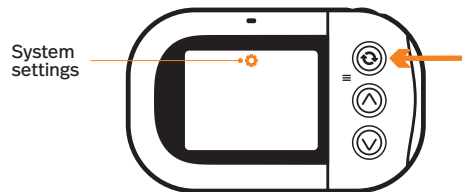

Make sure the System settings is selected on the on-screen menu, and press the Power / OK button .

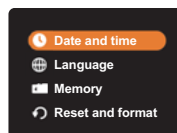



There are four general settings:

- Select **Date and time** to set the camera to the current date.
- **Language setting** allows you to choose which language is used on the camera's display screen.
- **Memory setting** allows you to see how much remaining memory you have on your memory card.
- If you are having issues with your camera's performance, select **Reset and format** to reset the camera to the original default settings and to format the memory card.

NOTE: Formatting the memory card will cause all contents to be deleted.

Wifi Settings

When in Photo Capture  or Video Capture  Modes, you can press and hold the Mode / Menu button  for approximately 2-3 seconds to access the Wifi Settings Menu.

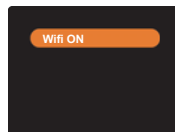
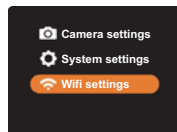

Make sure the Wifi settings is selected on the on-screen menu, and press the Power / OK button  to turn the camera's Wifi ON.



Follow the camera's on-screen instructions to connect your device to the camera's Wifi. On your device, select the camera's Wifi and enter the provided password.

NOTE: While your device is connected to the camera's Wifi, you will not have access to the internet.

Connect to the Polaroid Wave App

The **Polaroid Wave** app allows you to see the camera's live view and stored recordings directly from your device.



1. Download the **Polaroid Wave** app on the App Store® (for iOS devices) or the Google Play™ store (for Android™ devices).

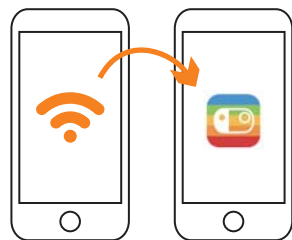

2. With your device connected to the camera's Wifi, open the **Polaroid Wave** app on your device.

Using the Polaroid Wave App

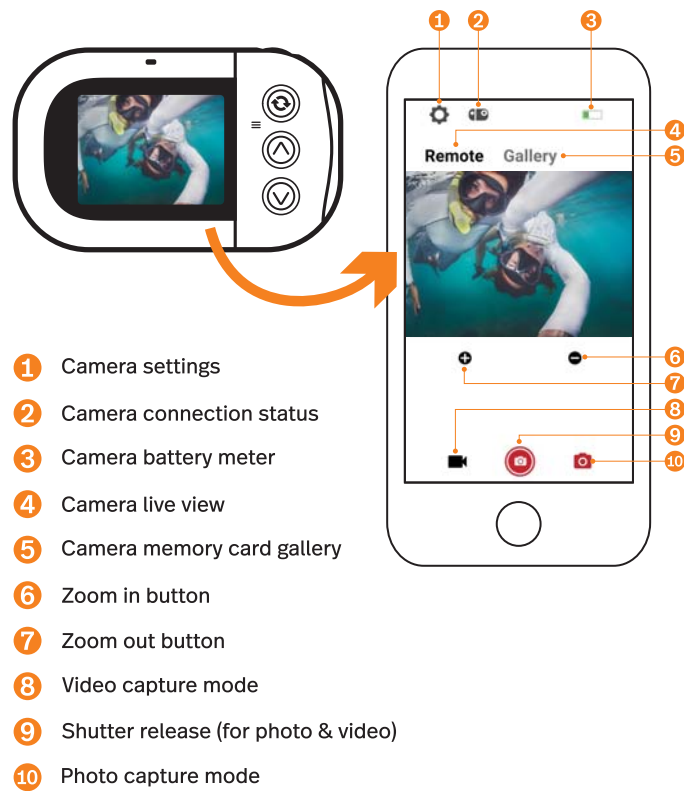

Using the Polaroid Wave App

When viewing the Camera memory card gallery **5**, you can download photos onto your phone, delete images or share downloaded images.

- 1 Select / Cancel multiple images
- 2 Share images*
- 3 Delete images
- 4 Download images

*Note: Only downloaded images can be shared using the app.

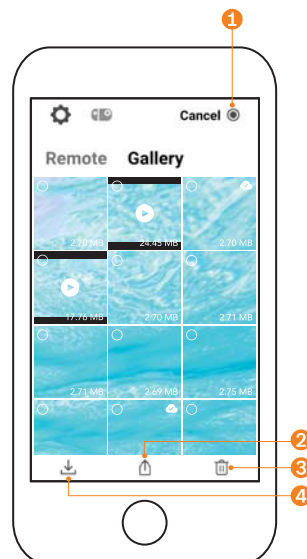

FCC Statement

Changes or modifications not expressly approved by the party responsible for compliance could void the user's authority to operate the equipment.

This device complies with Part 15 of the FCC Rules. Operation is subject to the following two conditions: (1) this device may not cause harmful interference, and (2) this device must accept any interference received, including interference that may cause undesired operation.

This equipment has been tested and found to comply with the limits for a Class B digital device, pursuant to Part 15 of the FCC Rules. These limits are designed to provide reasonable protection against harmful interference in a residential installation. This equipment generates, uses and can radiate radio frequency energy and, if not installed and used in accordance with the instructions, may cause harmful interference to radio communications. However, there is no guarantee that interference will not occur in a particular installation.

If this equipment does cause harmful interference to radio or television reception, which can be determined by turning the equipment off and on, the user is encouraged to try to correct the interference by one or more of the following measures:

- Reorient or relocate the receiving antenna.
- Increase the separation between the equipment and receiver.
- Connect the equipment into an outlet on a circuit different from that to which the receiver is connected.
- Consult the dealer or an experienced radio/TV technician for help.

FCC Radiation Exposure Statement

The device has been evaluated to meet general RF exposure requirement.
The device can be used in portable exposure condition without restriction.

Support

For warranty information and technical support, please call 877-408-0033 or visit polaroid.com/help. For e-mail support, please contact us at polaroid@sakar.com.

One Year Warranty

This warranty covers the original consumer purchaser only and is not transferable.

This warranty covers products that fail to function properly UNDER NORMAL USAGE, due to defects in material or workmanship. Your product will be repaired or replaced at no charge for parts or labor for a period of one year.

What is not covered by warranty

Damage or malfunctions not resulting from defects in material or workmanship and damages or malfunctions from other than normal use, including but limited to, repair by unauthorized parties, tampering, modification or accident.

To obtain warranty service and troubleshooting information:

Call 877-408-0033 or visit our website at www.polaroid.com.

To receive warrant service along with the name and address of an authorized product service center, the original consumer purchaser must contact us for problem determination and service procedures. Proof of purchase in the form of a bill of sale or receipted invoice, evidencing that the product is within the applicable warranty period(s). MUST be presented in order to obtain the requested service. It is your responsibility to properly package and send any defective products along with a dated copy of proof of purchase, a written explanation of the problem, and a valid return address to the authorized service center at your expense. Do not include any other items or accessories with the defective product. Any product received by the authorized service center that are not covered by warranty will be returned unrepared.

E-Waste Notification

PLR IP Holdings, LLC, its licensees, affiliates, and Sakar International, Inc. fully supports all electronic waste initiatives. As responsible stewards of the environment, and to avoid violating established laws, you should properly dispose of this product in compliance with all applicable regulations, directives or other governances in the area where you reside. Please check with local authorities or the retailer where you purchased this product to determine a location where you can appropriately dispose of the product.

You may also go to www.polaroid.com and reference Social Responsibility <https://polaroid.com/pages/social-responsibility> to learn more about the specific laws in your area and to locate a collection facility near your home.

If your electronic device has internal memory on which personal or other confidential data may be stored, you may want to perform a data sanitization process before you dispose of your device to assure another party cannot access your personal data. Data sanitization varies by the type of product and its software, and you may want to research the best sanitization process for your device before disposal. You may also check with your local recycling facility to determine their data sanitization procedures during the recycling process.

Copyright © 2020 All rights reserved.

Product features, specifications and appearance are subject to change without notice.

Polaroid



 **Have questions? We've got answers.**

Visit us at polaroid.com/support or
give us a call at 1-877-408-0033



Instantly recognizable. Instantly reassuring. The Polaroid Classic Border and Polaroid Color Spectrum logos let you know you've purchased a product that exemplifies the best qualities of our brand and that contributes to our rich heritage of quality and innovation.

©2020 All rights reserved. Polaroid, Polaroid Wave, Polaroid Color Spectrum and Polaroid Classic Border Logo are trademarks of PLR IP Holdings, LLC, used under license. PLR IP Holdings, LLC does not manufacture this product or provide any Manufacturer's Warranty or support.