

Instruction Manual Smart Baby Camera

Model No. IPC163

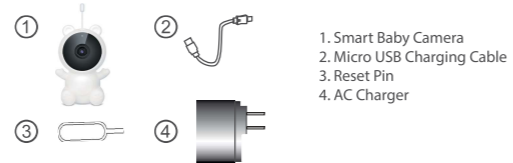

1 What's Included



1. Smart Baby Camera
2. Micro USB Charging Cable
3. Reset Pin
4. AC Charger

2 Parts of the Camera

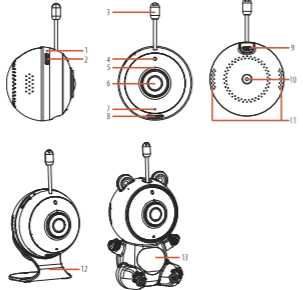

1. Reset Button
2. Micro SD Card Slot
3. Temperature Sensor
4. Light Sensor
5. Built-in MIC
6. Lens
7. Indicator Light
8. Night Lamp
9. Micro USB
10. Tripod
11. Dual Speakers
12. Magnetic Base (optional)
13. Teddy Silicon Case (optional)

3 Initial Setup

Turning On the Camera

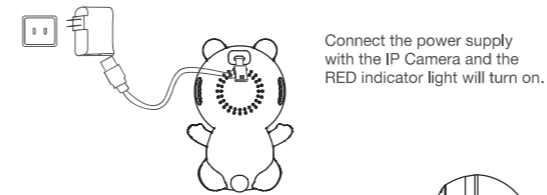

If the camera is failed to connect, it needs to be reset. To reset the IP camera, use the setup tool to press the "Reset" button on the back of the camera. Press and hold until the indicator turns red. Release the "Reset" button and wait for the system to reboot. This will take around 15 seconds.

Installing the Memory Card

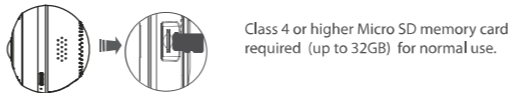

Indicator Light



When the red indicator light flashes quickly, it is in setting mode and means you can setup the camera via your mobile device.

When the blue indicator light is steady, it indicates that the camera is connected to the Wi-Fi.

Camera Operation

Preparations before use

Mobile device system requirements:
Android OS 4.4 or higher
iOS 9.0 or higher

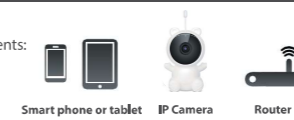

Install the App

Use your mobile phone or tablet to search for "TuyaSmart" in Google Play (for Android OS) or in the Apple app store (for iOS) to find the app, and install it according to the instructions.



Register an account

If this is the first time using the app, you need to register an account as per below:

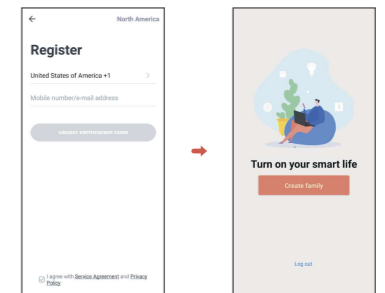
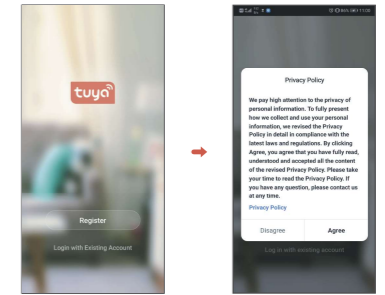

4 Connecting Your IP Camera with the App

Note: Your IPC Camera is supported only on a 2.4GHz Wi-Fi network. For setup, make sure your mobile device is connected to a 2.4GHz Wi-Fi network.

1. After installing the app 'TuyaSmart', launch the app and follow the prompts to setup the app. Then tap '+' or 'Add Device' from the home page. Tap 'Security & Sensor', then choose 'Smart Camera'.

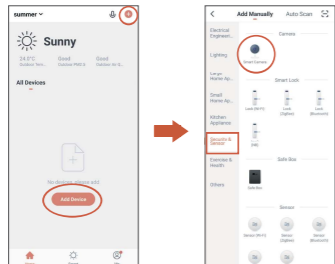

2. Power the device on and make sure the indicator is flashing quickly or a prompt tone is heard. Then tap 'next step'.

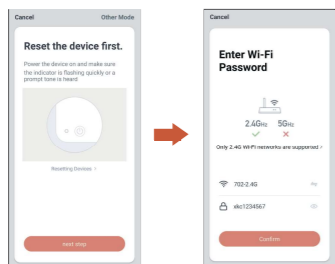

Make sure your smart device is connected to a 2.4G Wi-Fi network, then tap 'Confirm'.

3. The app will guide you to scan mobile device with the camera. When you tap 'Continue' the mobile phone displays a QR code. Hold the camera 15 to 20 cm in front of the mobile device for the camera to scan the QR code.

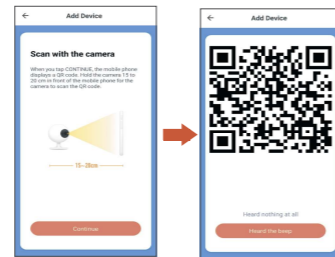

4. In connecting, make sure your router, mobile and device are as close as possible. Once the camera gets the information from the mobile device, the camera indicator will turn and keep to blue color which means the camera is connected successfully. Your camera's Live Camera view with streaming video will be opened.

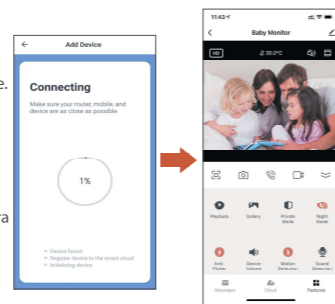

TROUBLESHOOTING

If...	Try This...
The camera does not find or connect the router.	<ul style="list-style-type: none"> Make sure the Wi-Fi router supports DHCP protocol. Make sure that the DHCP option is turned on. Make sure the camera and your mobile device connect to the same Wi-Fi router. Make sure you selected the correct 2.4GHz router only in your device Wi-Fi setting. Make sure you entered the correct password for the router you selected. Make sure you are within the Wi-Fi range of the router. Make sure the Wi-Fi router is enabled. Make sure the camera is properly powered on. Make sure the Wi-Fi router has enabled SSID broadcasting.
Poor video stream or video quality is not clear.	<ul style="list-style-type: none"> Please check your home upload speed to meet the minimum requirement. 1Mbps for 480P stream, 2Mbps for 720P and 4Mbps for 1080P. Clean the lens if it's dirty or has fingerprint marks on it.
There is no video or light indicator.	<ul style="list-style-type: none"> Verify that the camera is powered on and is plugged in properly.

SPECIFICATION

Item	Specification
Image Sensor	1/2.7" Colour CMOS
Recording Resolution	1920 x 1080 15fps, 640 x 480 20 fps
Viewing Angle	100°(D)
Night Vision	up to 5m
Video Compression	H.264
Audio	Two-way talk
WIFI	2.4GHz
Wireless Security	WEP, WPA, WPA2
Power Consumption	up to 5W
Micro SD Card	up to 32GB Class 10

This device complies with part 15 of the FCC Rules. Operation is subject to the following two conditions:
(1) This device may not cause harmful interference, and
(2) this device must accept any interference received, including interference that may cause undesired operation.
NOTE: This equipment has been tested and found to comply with the limits for a Class B digital device, pursuant to part 15 of the FCC Rules. These limits are designed to provide reasonable protection against harmful interference in a residential installation.
This equipment generates, uses and can radiate radio frequency energy and, if not installed and used in accordance with the instructions, may cause harmful interference to radio communications. However, there is no guarantee that interference will not occur in a particular installation. If this equipment does cause harmful interference to radio or television reception, which can be determined by turning the equipment off and on, the user is encouraged to try to correct the interference by one or more of the following measures:
- Reorient or relocate the receiving antenna.
- Increase the separation between the equipment and receiver.
- Connect the equipment into an outlet on a circuit different from that to which the receiver is connected.
- Consult the dealer or an experienced radio/ TV technician for help.
Warning: Changes or modifications to this unit not expressly approved by the part responsible for compliance could void the user's authority to operate the equipment.
FCC Radiation Exposure Statement
This equipment complies with FCC radiation exposure limits set forth for an uncontrolled environment.
This equipment should be installed and operated with minimum distance 20cm between the radiator & your body.