

User Manual

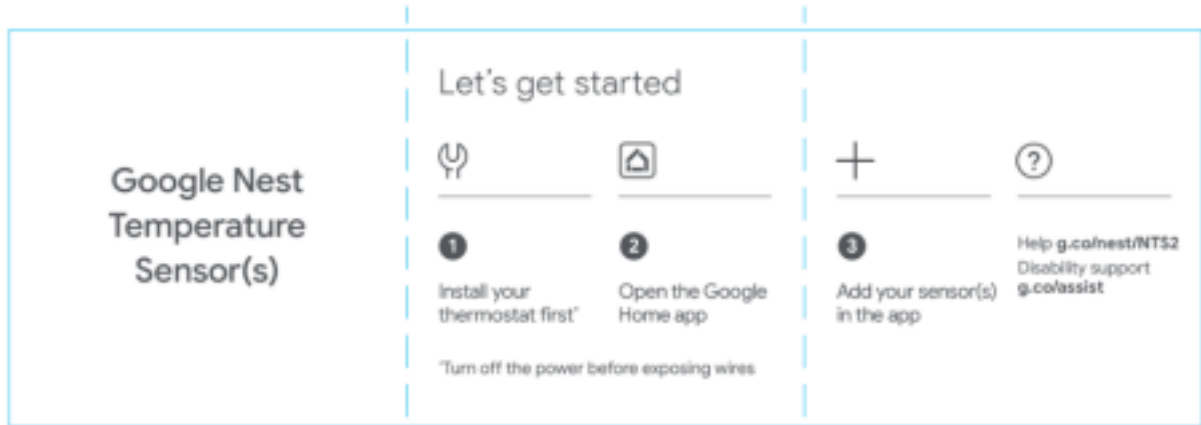

Regulatory Information

Regulatory information, certification, and compliance marks specific to Nest Temperature Sensor can be found under the battery compartment of your device. Additional regulatory and environmental information can be found at g.co/nest/support

Manufacturer address:

Google LLC, 1600 Amphitheatre Parkway, Mountain View, CA 94043.

EMC COMPLIANCE STATEMENT

Important: This device, and other in-box accessories have demonstrated Electromagnetic Compatibility (EMC) compliance under conditions that included the use of compliant peripheral devices.

RADIO FREQUENCY EXPOSURE

Maintain a distance of 20 cm (8 in) from your body to be consistent with how the device(s) is(are) tested for compliance with RF exposure requirements.

FCC & ISED CANADA REGULATORY COMPLIANCE

Regulatory Information: United States

FCC Regulatory Compliance

Note: This equipment has been tested and found to comply with the limits for a Class B digital device, pursuant to part 15 of the FCC Rules. These limits are designed to provide reasonable protection against harmful interference in a residential installation. This equipment generates, uses, and can radiate radio frequency energy and, if not installed and used in accordance with the instructions, may cause harmful interference to radio communications. However, there is no guarantee that interference will not occur in a particular installation. If this equipment does cause harmful interference to radio or television reception, which can be determined by turning the equipment off and on, the user is encouraged to try to correct the interference by one or more of the following measures:

- Reorient or relocate the receiving antenna.
- Increase the separation between the equipment and receiver.
- Connect the equipment into an outlet on a circuit different from that to which the receiver is connected.
- Consult the dealer or an experienced radio/TV technician for help.

Changes or modifications not expressly approved by Google could void your authority to operate the equipment.

This device complies with Part 15 of the FCC Rules. Operation is subject to the following 2 conditions:

1. These devices may not cause harmful interference.

2. These devices must accept any interference received, including interference that may cause undesired operation.

Model number: G5AJK

Product name: Google Nest Temperature Sensor

FCC ID: 2AQ68-G5AJK

The FCC ID is also located inside the battery compartment.

US Responsible Party

Google LLC

1600 Amphitheatre Parkway

Mountain View, CA 94043

Contact: g.co/nest/contact

Regulatory Information: Canada

Industry Canada, Class B

This device complies with ICES-003 Class B limits.

The device complies with ISSED license-exempt RSS standard(s). Operation is subject to the following two conditions: (1) this device may not cause interference, and (2) this device must accept any interference, including interference that may cause undesired operation of the device.

Le présent appareil est conforme aux CNR d'ISDE Canada applicables aux appareils radio exempts de licence. L'exploitation est autorisée aux deux conditions suivantes:

(1) l'appareil ne doit pas produire de brouillage, et

(2) l'appareil doit accepter tout brouillage radioélectrique subi, même si le brouillage est susceptible d'en compromettre le fonctionnement.

Model number: G5AJK

Product name: Google Nest Temperature Sensor

IC: 24374-G5AJK

The IC ID is also located inside the battery compartment.