

# **GT500V**

**5" Rugged Android™ Handheld  
Device with LTE solution**

## **User's Manual**

**Version 1.0**

---

This page is intentionally left blank.

---

---

## Revision History

| Version | Release Time | Description     |
|---------|--------------|-----------------|
| 1.0     | 2018.3       | Initial release |

---

## Copyright

Copyright © 2016 AMobile Intelligent Corp. All Rights Reserved.

This document contains proprietary information protected by copyright. No part of this manual may be reproduced by any mechanical, electronic, or other means in any form without prior written permission of the manufacturer.

## Disclaimer

The information in this document is subject to change without prior notice in order to improve the reliability, design and function. It does not represent a commitment on the part of the manufacturer.

Under no circumstances will the manufacturer be liable for any direct, indirect, special, incidental, or consequential damages arising from the use or inability to use the product or documentation, even if advised of the possibility of such damages.

## About This Manual

This user's manual provides the general information and installation instructions for the product. The manual is meant for the experienced users and integrators with hardware knowledge of personal computers. If you are not sure about any description in this manual, consult your vendor before further handling.

We recommend that you keep one copy of this manual for the quick reference for any necessary maintenance in the future. Thank you for choosing AMobile products.

|  |           |
|--|-----------|
| <b>Revision History .....</b>                            | <b>i</b>  |
| <b>Contents .....</b>                                    | <b>ii</b> |
| <b>Preface.....</b>                                      | <b>v</b>  |
| Declaration of Conformity.....                           | v         |
| CE .....   | v         |
| EU RED Directive.....                                    | v         |
| FCC Class B .....  | vi        |
| RoHS.....  | vi        |
| SVHC / REACH.....  | vii       |
| Symbols Description .....                                | viii      |
| Important Safety Instructions .....                      | viii      |
| Rechargeable Battery Pack Safety .....                   | x         |
| General Cleaning Tips.....                               | xi        |
| Cleaning Tools.....                                      | xii       |
| Recommended Cleaning Procedures .....                    | xii       |
| Disposing of the Equipment .....                         | xiii      |
| Additional Information & Technical Support .....         | xiii      |
| Warranty.....  | xiv       |
| <b>Chapter 1 - Introduction.....</b>                     | <b>1</b>  |
| 1.1. Product Highlights .....                            | 2         |
| 1.2 Package Contents.....                                | 2         |
| 1.3 Parts of the Device.....                             | 3         |
| 1.4 Dimensions .....                                     | 4         |
| 1.5 Specifications.....                                  | 5         |
| <b>Chapter 2. Getting Started .....</b>                  | <b>9</b>  |
| 2.1 Installing microSD and SIM Card .....                | 10        |
| 2.2 Charging the Battery .....                           | 13        |
| 2.2.1 Charging the Battery .....                         | 13        |
| 2.2.2 Checking the Battery Level .....                   | 13        |
| 2.3 Installing/Replacing the Battery.....                | 15        |
| 2.4 Optimizing Battery Life .....                        | 17        |
| <b>Chapter 3. Using the Rugged Handheld Device .....</b> | <b>19</b> |
| 3.1 Using Touch Screen .....                             | 20        |
| 3.1.1 Basic Operations.....                              | 20        |
| 3.1.2 Text Input.....                                    | 21        |
| 3.1.3 Sleep Mode.....                                    | 21        |

- 3.2 Home Screen .....22
  - 3.2.1 Extending Home Screen .....24
- 3.3 Using Cellular Network.....25
  - 3.3.1 Making/Receiving Calls.....25
  - 3.3.2 Configuring Your SIM Cards.....26
- 3.4 Using the Wi-Fi Feature .....26
  - 3.4.1 Enabling Wi-Fi and Connecting to a WLAN .....27
  - 3.4.2 Adding a Wi-Fi Network.....28
  - 3.4.3 Connecting to a Wi-Fi Network by WPS .....29
  - 3.4.4 Forgetting/Modifying a Wi-Fi Network.....30
  - 3.4.5 Making Your Device a Wi-Fi Hotspot.....31
- 3.5 Using the Bluetooth Feature .....32
  - 3.5.1 Enabling Bluetooth and Pairing with Bluetooth Device .....32
  - 3.5.2 Configuring Bluetooth Features to Use .....34
  - 3.5.3 Disconnect from a Bluetooth Device .....34
  - 3.5.4 Configuring Your Bluetooth Device .....34
- 3.6 Using the Location Feature .....35
  - 3.6.1 Enabling/Disabling Location Service.....35
  - 3.6.2 Location Mode.....36
- 3.7 Using the Camera .....37
- 3.8 Using the NFC Feature .....39
  - 3.8.1 Enabling/Disabling NFC .....39
  - 3.8.2 Configuring NFC Modes.....39
  - 3.8.3 Exchanging Data with NFC-Enabled Device.....40
  - 3.8.4 Using Tap & Pay.....41
- 3.9 Using the Barcode Scanner .....42
  - 3.9.1 Using the BarcodeScanWizard (Optional) .....42
  - 3.9.2 Supported Barcode Formats .....43

---

# Declaration of Conformity

## CE

The CE symbol on your product indicates that it is in compliance with the directives of the Union European (EU). A Certificate of Compliance is available by contacting Technical Support.

This product has passed the CE test for environmental specifications when shielded cables are used for external wiring. We recommend the use of shielded cables. This kind of cable is available from AMobile. Please contact your local supplier for ordering information.

## EU Directive

### 1. Health (Article 3.1.a of the RED Directive)

Applied standard(s): EN50566 July 2001+AC :2006+A1 :2012/EN62209-1 : 2006/EN62209-2 :2010/EN50566 :2013/EN62479 :2010

### 2.Safety (Article 3.1.a of the R&TTE Directive)

Applied standard(s): EN 60950-1:2006+A11:2009+A1:2010+A12:2011 +A2:2013

### 3.Electromagnetic compatibility (Article 3.1.b of the R&TTE Directive)

Applied standard(s): EN301489-1 V1.9.2(09-2011) / EN301489-3V1.6.1(06-2013)/ EN301489-7V1.3.1(11-2005)/EN301489-17 V2.2.1(09-2012)/EN301489-14V1.5.1(10-2010)

### 4.Efficient use of the radio frequency spectrum (Article 3.2 of the R&TTE Directive)

Applied standard(s): EN300328 V1.9.1(2015-02) / EN301893 V1.8.1(2015-03)

There are no restrictions to use the device in EU.

## **FCC Class B**

This device complies with Part 15 of the FCC Rules. Operation is subject to the following two conditions:

1. This device may not cause harmful interference, and
2. This device must accept any interference received, including interference that may cause undesired operation.

Any changes or modifications not expressly approved by the guarantee of this device could void the user's authority to operate the equipment.

This equipment has been tested and found to comply with the limits for a Class B digital device, pursuant to Part 15 of the FCC Rules. These limits are designed to provide reasonable protection against harmful interference in a residential installation. This equipment generates, uses and can radiate radio frequency energy and, if not installed and used in accordance with the instructions, may cause harmful interference to radio communications.

However, there is no guarantee that interference will not occur in a particular installation. If this equipment does cause harmful interference to radio or television reception, which can be determined by turning the equipment off and on, the user is encouraged to try to correct the interference by one or more of the following measures:

- Reorient or relocate the receiving antenna.
- Increase the separation between the equipment and receiver.
- Connect the equipment into an outlet on a circuit different from that to which the receiver is connected.
- Consult the dealer or an experienced radio/TV technician for help.

## **RoHS**

AMobile Intelligent Corporation certifies that all components in its products are in compliance and conform to the European Union's Restriction of Use of Hazardous Substances in Electrical and Electronic Equipment (RoHS) Directive 2002/95/EC.



The above mentioned directive was published on 2/13/2003. The main purpose of the directive is to prohibit the use of lead, mercury, cadmium, hexavalent chromium, polybrominated biphenyls (PBB), and polybrominated diphenyl ethers (PBDE) in electrical and electronic products. Member states of the EU are to enforce by 7/1/2006.

AMobile Intelligent Corporation hereby states that the listed products do not contain unintentional additions of lead, mercury, hex chrome, PBB or PBDB that exceed a maximum concentration value of 0.1% by weight or for cadmium exceed 0.01% by weight, per homogenous material. Homogenous material is defined as a substance or mixture of substances with uniform composition (such as solders, resins, plating, etc.). Lead-free solder is used for all terminations (Sn(96-96.5%), Ag(3.0-3.5%) and Cu(0.5%)).

## **SVHC / REACH**

To minimize the environmental impact and take more responsibility to the earth we live, AMobile hereby confirms all products comply with the restriction of SVHC (Substances of Very High Concern) in (EC) 1907/2006 (REACH --Registration, Evaluation, Authorization, and Restriction of Chemicals) regulated by the European Union.

All substances listed in SVHC < 0.1 % by weight (1000 ppm)

## Symbols Description



This symbol of “CAUTION” indicates that there is a danger of injury to the user or a risk of damage to the product, should warning notices be disregarded.



Battery Recycle



This symbol indicates electrical warning.

## Important Safety Instructions

Read these safety instructions carefully:

1. Read all cautions and warnings on the equipment.
2. Place this equipment on a reliable surface when installing. Dropping it or letting it fall may cause damage
3. Make sure the correct voltage is connected to the equipment.
4. For pluggable equipment, the socket outlet should be near the equipment and should be easily accessible.
5. Keep this equipment away from humidity.
6. Disconnect this equipment from the A/C outlet before cleaning it. Use a moist cloth. Do not use liquid or sprayed detergent for cleaning.
7. To fully disengage the power to the unit, please disconnect the power from the AC outlet.
8. Do not scratch or rub the screen with a hard object.
9. Never use any of the solvents, such as Thinner Spray-type cleaner, Wax, Benzene, Abrasive cleaner, Acid or Alkaline solvent, on the display. Harsh chemicals may cause damage to the cabinet and the touch sensor.
10. Remove dirt with a lightly moistened cloth and a mild solvent detergent. Then wipe the cabinet with a soft dry cloth.
11. The openings on the enclosure are for air convection and protect the equipment from overheating. **DO NOT COVER THE OPENINGS.**

12. Position the power cord so that people cannot step on it. Do not place anything over the power cord.
13. If the equipment will not be used for a long time, disconnect it from the power source to avoid damage by transient overvoltage.
14. Never pour any liquid into openings. This may cause fire or electrical shock.
15. Never open the equipment. For safety reasons, the equipment should be opened only by qualified service personnel.
16. If one of the following situations arises, get the equipment checked by service personnel:
  - a. The power cord or plug is damaged.
  - b. Liquid has penetrated into the equipment.
  - c. The equipment has been exposed to moisture.
  - d. The equipment does not work well, or you cannot get it to work according to the user's manual.
  - e. The equipment has been dropped or damaged.
  - f. The equipment has obvious signs of breakage.
17. The sound pressure level at the operator's position, according to IEC 704-1:1982, is no more than 70dB(A).
18. Keep this User's Manual for later reference.
19. **DO NOT LEAVE THIS EQUIPMENT IN AN UNCONTROLLED ENVIRONMENT WHERE THE STORAGE TEMPERATURE IS BELOW -20° C (-4° F) OR ABOVE 60° C (140° F). THIS MAY DAMAGE THE EQUIPMENT.**



Do not use the power adapter that isn't made for the equipment. Supplying the equipment with inappropriate voltage may cause harm to the battery or, even worse, burn the equipment.



To prevent possible hearing damage, do not listen at high volume levels for long periods

## Rechargeable Battery Pack Safety

With very little care, you can optimize the battery life and maximize the lifespan of the battery. Most importantly, use only the equipment in its ideal operating temperature (as described in [1.5 Specifications](#)) – do not leave it in a hot trunk during the summer.

- **Important Terms to Understand**

“Battery life” means the time the equipment will run before it must be recharged (sometimes this is also called “playtime” or “runtime”).

“Battery lifespan” means the total amount of time your battery will last before it must be replaced.

- **Using the Equipment for the First Time**

Be sure to fully charge the equipment when charging the equipment for the first time.

- **Long-Term Storage & Maintenance**

If you are putting away the battery for more than three months, it is recommended that the battery should be stored separately and fully charged, and get recharged every three months. If you store an uncharged battery, it could fall into a deep worn-out state which would render it incapable of holding any charge. Be sure to store the equipment and battery at the proper temperature (as described in [1.5 Specifications](#)).

- **Battery Lifespan**

The removable batteries for the equipment are designed to retain up to 80% of their original capacity after 300 charging and recharging cycles when properly maintained. You may choose to purchase new battery when it no longer holds the sufficient charge that meets your needs.

- The lithium-ion battery is currently one of the most popular battery packs. The best advantage is that it has no memory effect, so users needn't worry about that issue. Users can charge the battery anytime whether it is fully drained or not. However, it's recommended that users drain the battery until the system shows power shortage warning and then recharge the battery. Doing so is helpful to the reliability of your battery.
- Don't use the battery pack as a power supply for other equipment.
- Don't expose the battery to elevated heat situations such as under direct sunlight in a car or near fire.

- Don't disassemble the battery, or the battery leakage might cause skin or eye injury. If electrolyte leaking from the battery contacts your skin or clothing, immediately flush it with running water. If it splashes into eye, rinse the eye at least 15 minutes with clean water and then seek medical attention.
- To avoid battery leakage or explosion, don't discard the battery into water or fire, or put them near a heat source such as a gas stove or an oven.
- If you are putting away the battery for more than three months, it is recommended that the battery should be stored separately and fully charged, and get recharged every three months. If you store an uncharged battery, it could fall into a deep worn-out state which would render it incapable of holding any charge. Be sure to store your the equipment and battery at the proper temperature (as described in [1.5 Specifications](#)).
- Use the appropriate container to store the battery such as a paper box. Do not allow a metal object to touch the terminal of the battery.
- The battery consists of precise electrical components and cells. Do not drop or hit the battery.

## General Cleaning Tips

You may need the following precautions before you begin to clean the device. When you clean any single part or component for the device, please thoroughly read and understand the details below.

1. We strongly recommended that you should shut down the system before you start to clean any single components.
2. When you need to clean the device, please rub it with a piece of dry cloth.
3. Be cautious of the tiny removable components when you use a vacuum cleaner to absorb the dirt on the floor.
4. Never drop the components inside the device or get circuit board damp or wet.
5. Be cautious of all kinds of cleaning solvents or chemicals when you use it for the sake of cleaning. Some individuals may be allergic to the ingredients.
6. Try not to put any food, drink or cigarette around the device.

## Cleaning Tools

Although many companies have created products to help improve the process of cleaning your devices and peripherals, users can also use household items to clean their devices and peripherals. Below is a listing of items you may need or want to use while cleaning your devices or peripherals. Keep in mind that some components in your device may only be able to be cleaned using a product designed for cleaning that component, if this is the case it will be mentioned in the cleaning.

- **Cloth:** A piece of cloth is the best tool to use when rubbing up a component. Although paper towels or tissues can be used on most hardware as well, we still recommend you to rub it with a piece of cloth.
- **Water or rubbing alcohol:** You may moisten a piece of cloth a bit with some water or rubbing alcohol and rub it on the device. Unknown solvents may be harmful to the plastics parts.
- **Vacuum cleaner:** Absorb the dust, dirt, hair, cigarette particles, and other particles out of the device can be one of the best cleaning methods. Over time, these items can restrict the airflow in a device and cause circuitry to corrode.
- **Cotton swabs:** Cotton swaps moistened with rubbing alcohol or water are excellent tools for wiping hard to reach areas in your keyboard, mouse, and other locations.
- **Foam swabs:** Whenever possible, it is better to use lint-free swabs such as foam swabs.

## Recommended Cleaning Procedures

1. Close all application programs
2. Close operating software
3. Turn off the equipment
4. Remove all peripherals
5. Disconnect the power cable
6. Proceed to clean.

---

## Disposing of the Equipment

- **Within the European Union**



EU-wide legislation, as implemented in each Member State, requires that waste electrical and electronic products carrying the mark (left) must be disposed of separately from normal household waste.

This includes monitors and electrical accessories, such as signal cables or power cords. When you need to dispose of your display products, please follow the guidance of your local authority, or ask the shop where you purchased the product, or if applicable, follow any agreements made between yourself. The mark on electrical and electronic products only applies to the current European Union Member States.

- **Outside the European Union**

If you wish to dispose of used electrical and electronic products outside the European Union, please contact your local authority so as to comply with the correct disposal method.

## Additional Information & Technical Support

You can download the related technical documents such as datasheet and user's manual as well as driver on our website.

Please do not hesitate to call or e-mail our customer service when you still cannot get the information you need.

[http://amobile-solutions.com/web\\_en/contact.php](http://amobile-solutions.com/web_en/contact.php)

E-mail: [support@amobile.com.tw](mailto:support@amobile.com.tw)

Tel: +886-2-8226-8558

## Warranty

This product is warranted to be in good working order during the warranty period. Should this product fail to be in good working order at any time during this period, we will, at our option, replace or repair it at no additional charge except as set forth in the following terms. This warranty does not apply to products damaged by misuse, modifications, accident or disaster.

Vendor assumes no liability for any damages, lost profits, lost savings or any other incidental or consequential damage resulting from the use, misuse of, or inability to use this product. Vendor will not be liable for any claim made by any other related party.

Vendors disclaim all other warranties, either expressed or implied, including but not limited to implied warranties of merchantability and fitness for a particular purpose, with respect to the hardware, the accompanying product's manual(s) and written materials, and any accompanying hardware. This limited warranty gives you specific legal rights.

Return authorization must be obtained from the vendor before returned merchandise will be accepted. Authorization can be obtained by calling or faxing the vendor and requesting a Return Merchandise Authorization (RMA) number. Returned goods should always be accompanied by a clear problem description.



---

# Chapter 1

## Introduction

## 1.1. Product Highlights

- Support Android 7.0
- Quad-core ARM Cortex-A53 1.3GHz
- Multiple connectivity including WLAN, WWAN, Bluetooth, NFC and LTE
- WorldMode modem capability (Support FDD/TDD-LTE, WCDMA, CDMA2000 1xEV-DO and GSM/GPRS/EDGE)
- IP67 rated water and dust resistance
- Drop proof: Up to 1.5m
- Accelerometer, Magnetometer, Gyroscope, Light sensor, GPS & Barometer
- Built-in 1D/2D barcode reader



## 1.2 Package Contents

Upon opening the package, carefully inspect the contents. If any of the items is missing or appears damaged, contact your local dealer or distributor. The package should contain the following items:



1 x GT500V 5" rugged Android™ handheld device with LTE solution





Rechargeable Li-ion battery pack (Pre-installed into the device)



User manual

## 1.3 Parts of the Device



|    |   |    |  |
|----|---|----|--|
| 1  | Barcode scan window                     | 12 | (OS) Back button                  |
| 2  | Headset jack with hinged rubber cover   | 13 | (OS) Home button                  |
| 3  | GPS                                     | 14 | Microphone   |
| 4  | Barcode trigger                         | 15 | (OS) Wallpaper & Widget button   |
| 5  | Volume key                              | 16 | Pogo Pin   |
| 6  | micro USB port with hinged rubber cover | 17 | Barcode trigger  |
| 7  | 5MP front camera                        | 18 | Power key<br>* Press-and-hold this key to power on/off the device.<br>* Press this key to turn on/off the display. |
| 8  | Light sensor                            | 19 | 13MP autofocus rear camera   |
| 9  | Receiver                                | 20 | LED Flash  |
| 10 | LED Indicator                           | 21 | NFC detection area   |
| 11 | Projected Capacitive Multi-Touch Screen | 22 | Battery cover latch  |

## 1.4 Dimensions

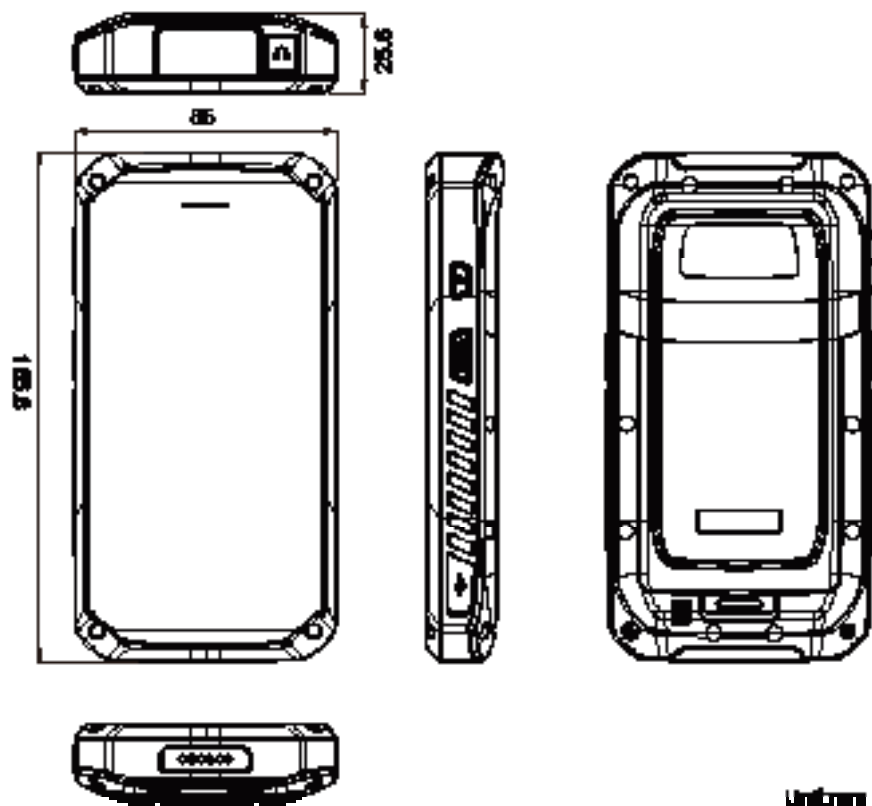

## 1.5 Specifications

| <b>System</b>                  |   |
|--------------------------------|---|
| CPU                            | Quad Core ARM Cortex-A53 1.3GHz                           |
| OS                             | Android 7.0   |
| Memory                         | 3GB LPDDR2  |
| Storage                        | 16 GB eMMC  |
| <b>Peripherals and Devices</b> |   |
| Camera                         | Front: 5.0 MP camera                                      |
|                                | Rear: 13.0 MP camera with Auto-Focus and Flashlight       |
| Sensor                         | Magnetometer (M-Sensor/E-Compass)                         |
|                                | Accelerometer (G-sensor)                                  |
|                                | Gyroscope   |
|                                | Barometer   |
|                                | Proximity sensor  |
|                                | Ambient light sensor                                      |
| Barcode Scanner                | 1D/2D barcode reader, either with physical trigger button |
| Audio & Vibrator               | 1 x built-in microphone                                   |
|                                | 1 x built-in speaker (0.5W)                               |
|                                | 1 x 3.5mm stereo headphone/microphone combo jack          |
|                                | 1 x vibrator  |
|                                | FM radio  |
| <b>Wireless</b>                |   |
| WLAN                           | Integrated IEEE 802.11a/b/g/n                             |
| Bluetooth                      | Bluetooth 4.1 (BLE, HS compliant)                         |
| WWAN                           | 4G LTE (Band2,4,13)                                       |
| GPS                            | GPS/Beidou  |
|                                | GPS/Glonass (optional)                                    |
| NFC                            | Yes   |
| <b>I/O Interface</b>           |   |
| USB Port                       | 1 x micro USB 2.0 port High Speed / OTG Compatible.       |
| SD Slot                        | 1 x microSD card slot (max 32G)                           |
| SIM Cart                       | 1 x micro-SIM (3FF) socket supporting 4G/LTE              |
| <b>LCD Display</b>             |   |
| Size/Type                      | 5" TFT LCD  |

|                                       |  |
|---------------------------------------|--|
| Resolution                            | 720(W) x 1280(H)                                     |
| Brightness (cd/m <sup>2</sup> )       | 500 cd/m <sup>2</sup>                                |
| Touch Screen                          | 5 points capacitive touch (PCT)                      |
| <b>Power Supply</b>                   |  |
| Battery Type                          | Lithium-ion rechargeable battery, field replaceable. |
| Battery Capacity                      | Typical 3.7V, 4800mAh                                |
| Battery Life                          | TBD  |
| Adapter Input                         | AC100~240C, 50~60 Hz                                 |
| Adapter Output                        | 5V/2A (10W)  |
| <b>Mechanical &amp; Environmental</b> |  |
| Ingress Protection                    | IP67, Up to 1.5m drop resistance.                    |
| Operating Temp.                       | -15°C ~ 55°C (5°F ~ 131°F )                          |
| Storage Temp.                         | -20°C ~ 60°C (-4°F ~ 140°F)                          |
| Operating Humidity                    | 5~95% RH   |
| Dimensions (mm)                       | 165.8(H) x 86(W) x 25.6(D)                           |
| Weight                                | under 385g (0.85lb) (with battery)                   |

### RF Mode Power Levels

| RF        | support band | power levels | Tolerance        |
|-----------|--------------|--------------|------------------|
| WLAN      | 802.11 b/g/n | ≤20dBm       | ---              |
| BlueTooth | BT 4.1 BLE   | ≤20dBm       | ---              |
| 4G-LTE    | Band 2       | 23dBm        | ±2.7dB           |
|           | Band 4       | 23dBm        | ±2.7dB(see note) |
|           | Band 13      | 23dBm        | ±2.7dB(see note) |
|           |              |              |                  |

**Note:** For transmission bandwidths (TS 136 521-1 [1], clause 5) confined within FUL\_low and FUL\_low + 4 MHz or FUL\_high - 4 MHz and FUL\_high, the maximum output power requirement is relaxed by reducing the lower tolerance limit by 1,5 dB (tolerance = +2,7/-4,2).



---

This page is intentionally left blank.



---

# Chapter 2

## Getting Started

## 2.1 Installing microSD and SIM Card

To install the microSD card and/or SIM card(s):

1. Pull the back cover release latch towards the bottom of the phone to unlock the latch.

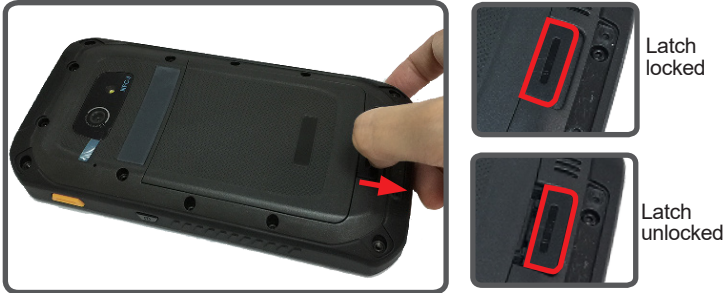

2. Use your finger or thumbnail to gently pry the cover.



3. Remove the battery, if inserted. The battery is secured by a red slider. Move the slider to the right so that you can remove the battery.



Move the slider to the right to unlock the battery.



4. Insert the SIM cards / microSD card following the direction as shown in the graphic.
  - **To insert SIM card(s):** The device comes with one SIM card slots, supports 4G
  - **To insert a microSD card:** Push the microSD card cover toward SIM slot 1 to lift it up. Insert a microSD card following the direction as shown in the graphic. Then push the microSD card cover back into its original position to lock it.

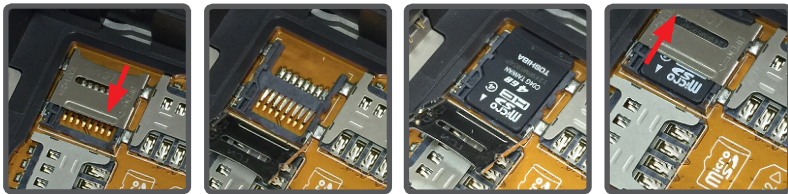

5. Insert the battery back to the compartment while ensuring gold contacts align with the device contacts. Then move the slider to the left to secure the battery.



Move the slider to the left to secure the battery.

6. Replace the back cover and push the latch towards the cover to lock it.



After the SIM card(s) are properly installed, the device is ready to use the cellular network. See [3.3 Using Cellular Network](#) to know how to use them.

## 2.2 Charging the Battery

Due to shipment, the battery is partially drained when the package is delivered to you. Be sure to charge the battery to full when you are charging it for the first time.

### 2.2.1 Charging the Battery

You can charge the GT500V via the provided power adapter or computer USB connection.

- To use the power adapter: Connect the power adapter to your power outlet and connect the USB end to the USB port on the device.
- To use a computer USB connection: Using a USB cable, connect small end to the USB port on the device and the other end to the USB port on a computer.

USB port for connecting to a power source



**Warning:** Use only the power adapter that comes with your device. Using a different power adapter may damage your device and may result in poor performance. It may also invalidate warranty applying to the device.

### 2.2.2 Checking the Battery Level

When you charge the GT500V, the LED indicator of the GT500V will show the charging status as below:

- Charging in progress: Red, solid
- Fully charged: Green, solid



## Getting Started

---

Also, a battery indicator will appear in the **Notification Area** showing the charging percentage. The remaining charging time will also be displayed.

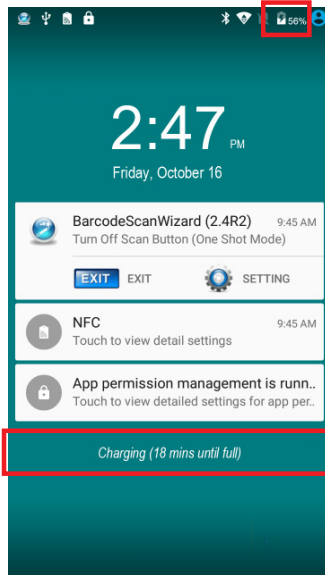

When the battery is fully charged, unplug the USB cable from the device

## 2.3 Installing/Replacing the Battery

In case you need to install or replace the battery, follow the steps below to access the battery chamber and replace the battery.

1. Pull the back cover release latch towards the bottom of the phone to unlock the latch.

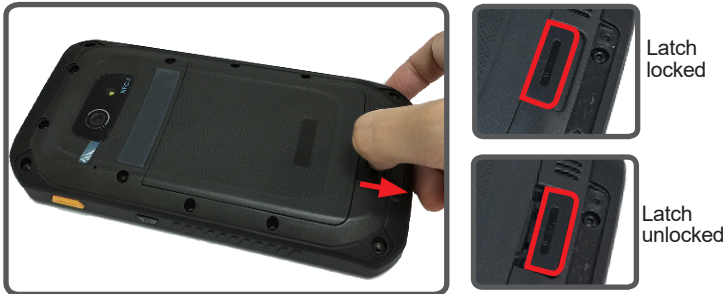

2. Use your finger or thumbnail to gently pry up the cover.



3. Remove the battery, if inserted. The battery is secured by a red slider. Move the slider to the right so that you can remove the battery.





4. Insert the battery back to the compartment while ensuring gold contacts align with the device contacts. Then move the slider to the left to secure the battery.



Move the slider to the left to secure the battery.

5. Replace the back cover and push the latch towards the cover to lock it.





---

## 2.4 Optimizing Battery Life

To optimize the operating time of the battery, it is recommended that you do the following:

- Decrease the LCD display brightness.
- Set a shorter timeout of inactivity to allow the screen enter sleep mode.
- Turn off the display if you are not using it.
- Always exit the applications if it is not in use.
- Disable the Wi-Fi, Bluetooth or GPS function if you are not using it.
- Disable the App that heavily drains the battery if you are not using it.

To view the battery usage by individual App, tap **Settings | Device | Battery**.

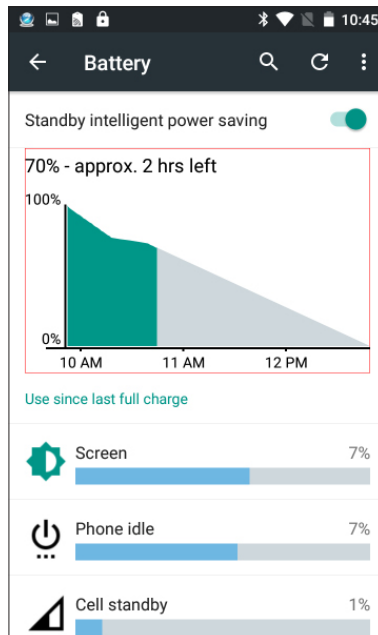

- Disconnect USB devices such as USB flash drive if it is not in use.

---

This page is intentionally left blank.

---

# Chapter 3

## Using the Rugged Handheld Device

## 3.1 Using Touch Screen

The GT500V comes with a projected capacitive multi-touch screen. Touch control is the main way to interact with the GT500V. Users are able to manipulate icons, graphic buttons, menus, the onscreen keyboard or any onscreen items with touch control. This chapter will walk you through the basic operations.

### 3.1.1 Basic Operations

The table below provides instructions on how to use the multi-touch screen:

| Operation     | Description   |
|---------------|---|
| Tap           | Tap an item and quickly release to select an item, launch an application, or open a menu.   |
| Tap and hold  | Tap and hold an item or a blank area on the screen for a few seconds until a menu opens or an option appears.   |
| Drag          | Tap and hold on an item, such as an image or an icon, then move it to the target position. While dragging, do not release until you have reached the target position. |
| Swipe         | Move your finger horizontally or vertically across the screen to scroll through the screen, App menu, pages, lists and so on.   |
| Zoom in / out | Move two fingers closer together on an item, such as a picture, web page, or map, to zoom out, or move two fingers apart to zoom in.                                  |
| Double Tap    | For some applications, quickly tap twice on an item to zoom in and double-tap again to zoom out.  |

---

### 3.1.2 Text Input

The GT500V doesn't have a physical keyboard to receive user's text input. To input text on the device, it relies on the "onscreen keyboard" featured by the operating system. An "onscreen keyboard" is a virtual keyboard with most of the standard keys.

To open the onscreen keyboard, simply tap a text input field and the keyboard appears.

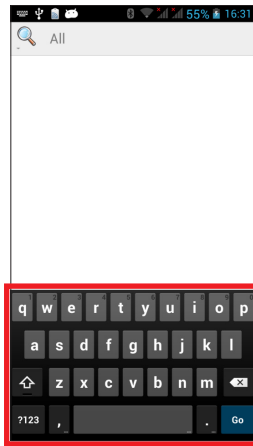

### 3.1.3 Sleep Mode

When the device suspends to sleep mode, it enters a low power state and the display is off to save the battery power. You can manually force the device to enter sleep mode or specify a period of inactivity before it automatically enters sleep mode. While the device is in sleep mode, it is still capable of receiving messages and calls and processing tasks like downloading.

To switch to sleep mode, press and hold the **Power** key until the screen is turned off.

To wake up the device from sleep mode, press and hold the **Power** key until the screen is turned on. If the screen is locked, swipe up to unlock the device.

To specify the period of inactivity, tap **Settings** | **Display** | **Sleep**. Then select a time of inactivity before the device enters sleep mode.

---

## 3.2 Home Screen

The **Home** screen provides you with an instant access to device status, notifications, application shortcuts, folders and widgets. Simply tap an item and you can launch the associated application. You can also add desired items to the **Home** screen, extend the **Home** screen or personalize the wallpaper to tailor it to your personal needs.

When you power on the device for the first time, a typical **Home** screen looks like the example below.

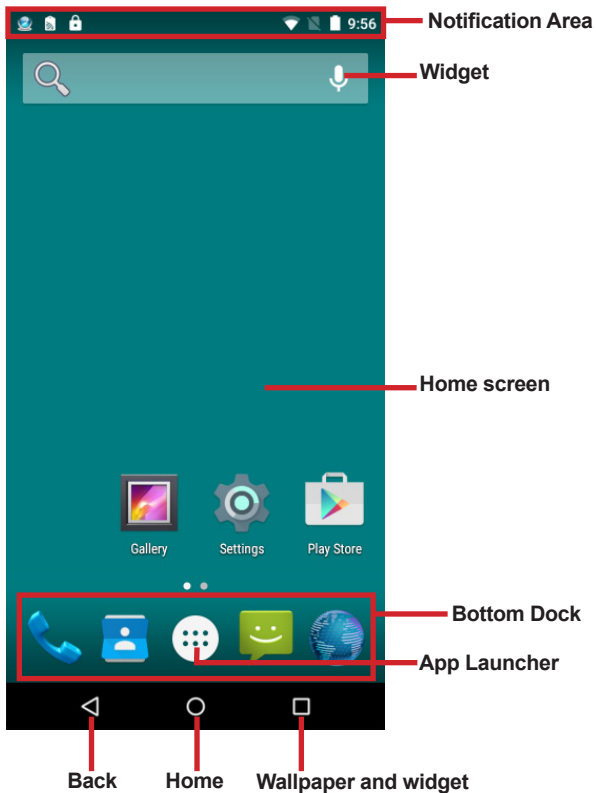

---

The table below describes the elements on a typical **Home** screen:

| Element                     | Descriptions   |
|-----------------------------|--|
| <b>Notification Area</b>    | <p>The <b>Notification Area</b> is visible across the <b>Home</b> screens. The icons on the left side inform you of new messages, events, alarms, and activities in progress, while the icons on the right side shows the time, signal strength, battery level and other information.</p> <p>Applications you install on your device may show their own icons in this area.</p> <p>You can access the notification panel to see more information by swiping down the <b>Notification Area</b>.</p> |
| <b>Home Screen</b>          | <ul style="list-style-type: none"><li>• Tap an item on this screen to launch that item.</li><li>• To delete an icon or widget, tap and hold that item until the <b>Remove</b> bar appears on the top of the screen. Then move the icon to the <b>Remove</b> bar.</li><li>• Tap and hold any empty spot on this screen to customize your home screen.</li></ul>   |
| <b>Widget</b>               | <p>The miniature of an application that functions directly on the <b>Home</b> screen.</p>  |
| <b>App Launcher</b>         | <p>Tap it to open the "<b>App Launcher</b>" where all applications installed on the GT500V can be viewed and launched.</p>   |
| <b>Bottom Dock</b>          | <p>The dock is visible across the home screens. It shows the most commonly used App icons for quick access. You can change the icons as needed.</p>  |
| <b>Back Button</b>          | <p>Tap to go to the previous screen.</p>   |
| <b>Home Button</b>          | <p>Tap to return to Home screen.</p> <p>Tap and hold the button to view current running Apps. You can touch an App to reopen it or swipe it left or right to close it.</p>   |
| <b>Wallpaper and widget</b> | <p>Tap to open wallpaper and widget settings screen, where you can select wallpaper and widgets.</p>   |

---

### 3.2.1 Extending Home Screen

The **Home** screen is extended beyond the screen width to provide more space for adding application shortcuts and widgets.

To access the extended **Home** screen, swipe on the **Home** screen to the left or right.

To add application icons or widgets to the extended **Home** screen:

1. Tap the **App Launcher** icon on the **Home** screen to locate the target application icon or widget.
2. Tap and hold the target icon or widget until the extended **Home** Screen appears.
3. Move the icon or widget to desired screen and then release.



---

## 3.3 Using Cellular Network

After you insert the SIM card(s) to the GT500V for the first time and power on the GT500V, depending on your mobile network carrier you might be guided to activate the account and connect to your mobile network. If you are asked for a PIN to unlock the SIM card when powering on the GT500V, contact your cellular network carrier for the default PIN.

When a new SIM card is detected by the GT500V, you will be prompted to configure its usage, including voice call, messaging and data connection. You can configure it now or change the settings later.

### 3.3.1 Making/Receiving Calls

After you activate your SIM card(s), the GT500V auto-connects to your cellular network when it powers on. You can start to use the phone service.

Using phone service, e.g., making or answering a call, is similar to the way you use a mobile phone.

To use the device for phone service, it is suggested that you connect a wired headset to the device's headset connector or use a wireless Bluetooth headset or car kit. For instructions on how to connect to a Bluetooth device, see [3.5 Using the Bluetooth Feature](#) for details.

### 3.3.2 Configuring Your SIM Cards

The GT500V supports one SIM cards.

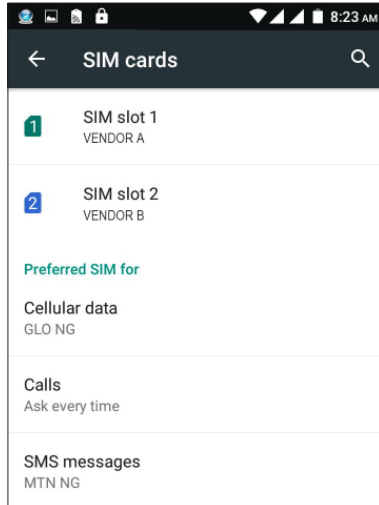

### 3.4 Using the Wi-Fi Feature

The GT500V is capable of Wi-Fi networking. Wi-Fi is a wireless networking technology that uses an access point, also known as the “hotspot”, to connect to an Internet service provider over the wireless local area network (WLAN). Some hotspots are open to connect while others request you to present a key to authenticate your connection. The GT500V needs to be configured including such key to connect to a hotspot.

Follow the steps below to connect the GT500V to your wireless local area network:

**Note:** Turn off Wi-Fi when it isn't used to extend battery life.

The **Notification Area** displays the following icons that shows Wi-Fi status.

| Icon | Description   |
|------|---|
|      | Notifies that an open Wi-Fi network is in range.                            |
|      | Notifies that a Wi-Fi network is connected. Waves indicate signal strength. |

---

### 3.4.1 Enabling Wi-Fi and Connecting to a WLAN

1. Tap **Settings** | **Wi-Fi** and turn on Wi-Fi if it isn't enabled yet.

2. The GT500V then proceeds to scan for available Wi-Fi networks in range and displays the names of those found. Secured networks are displayed with waves denoting signal strength plus a lock on them  while the open networks don't.

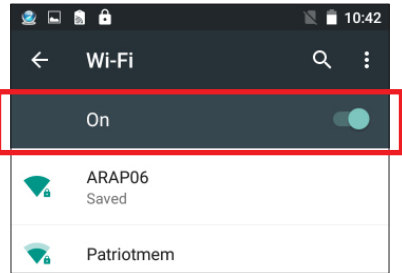

3. Tap a network to connect to it. To connect to a secured network, you're prompted to enter a password or other credentials. (Ask your network administrator for details.)

If the GT500V detects a network previously connected to, the GT500V auto-connects to it.

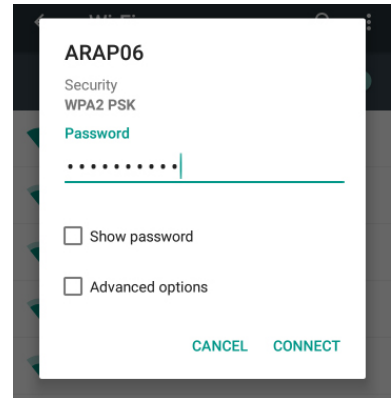

4. Once a Wi-Fi network is connected, it displays as "connected" on the Wi-Fi settings screen. You can tap it to see the details about the speed, security, address, and related info. With Wi-Fi connected, a Wi-Fi wave icon will also be displayed in the **Notification Area**.

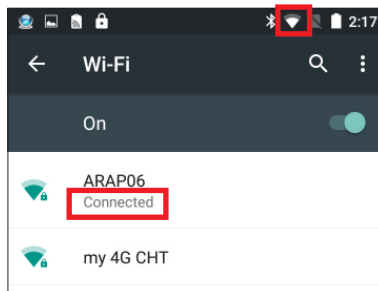

### 3.4.2 Adding a Wi-Fi Network

---

Under the following situations, you may need to manually add a Wi-Fi network:

- When a Wi-Fi network doesn't broadcast its name (SSID)
- When a Wi-Fi network is out of range and you want the GT500V to remember it and auto-connect to it as soon as it gets in range.

To add a Wi-Fi network:

1. Tap **Settings | Wi-Fi** and turn on Wi-Fi if it isn't enabled yet.
2. Tap the menu icon **⋮** to open the context menu and select **Add network**.

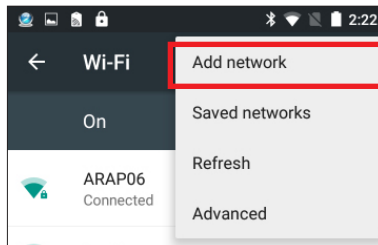

3. Enter the SSID (name) of the network. If the network is secured, tap the triangle at the right of the **Security** field to select the type of security deployed on the network and enter any required security credentials.

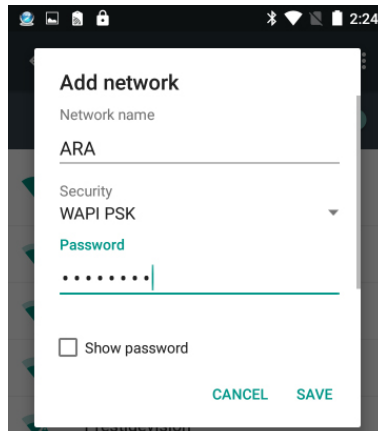

4. Tap **Save**.

The GT500V then proceeds to connect to the Wi-Fi network. Any credentials entered are saved so the GT500V automatically connects to it the next time the GT500V gets it within the range.

### 3.4.3 Connecting to a Wi-Fi Network by WPS

Wi-Fi Protected Setup (WPS) is a feature that allows WPS-compliant devices to connect to each other instantly in a secure way. As the WPS devices automatically configure the SSID and WPA security key, it eliminates the need for users to manually enter the SSID and password. WPS works in two methods: Push or personal identification number (PIN). To connect to a Wi-Fi network via WPS:

1. Tap **Settings** | **Wi-Fi** and turn on Wi-Fi if it isn't enabled yet.
2. Tap the menu icon **⋮** to open the context menu and select **Advanced**.
3. Use either of the following methods to make the connection:

To use Push button, tap **WPS Push Button** and a prompt message will appear. Then press the WPS button on your WPS router within two minutes.

To use PIN method, tap **WPS Pin Entry**. You will be prompted with a PIN. Enter that PIN on your Wi-Fi router within two minutes.

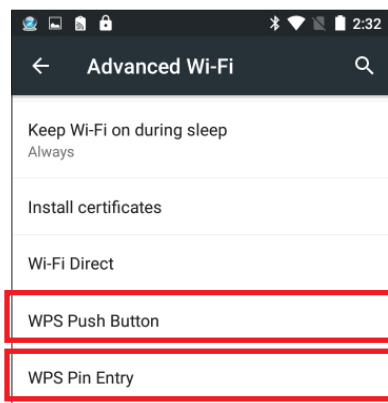

4. WPS authentication process will start. When the authentication is done, you will be prompted that connection is successful.

---

### 3.4.4 Forgetting/Modifying a Wi-Fi Network

When you don't want the GT500V to "auto" connect to a Wi-Fi network or when it is a network that you no longer use, remove the Wi-Fi network by the steps below:

1. Tap **Settings | Wi-Fi** and turn on Wi-Fi if it isn't enabled yet.
2. On the Wi-Fi settings screen, tap and hold the name of the network to forget. A context menu then opens.
3. Tap **Forget network**.

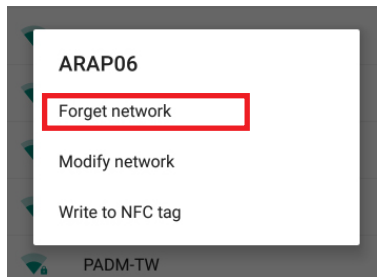

Some Wi-Fi networks may periodically change their passwords to enhance the network security. When this occurs, you need to change the saved login credentials. To change the password, follow the steps above to access the context menu of the intended network. Then tap **Modify network** to make the changes.

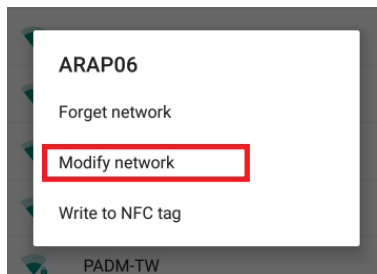

### 3.4.5 Making Your Device a Wi-Fi Hotspot

---

When the GT500V is connected to a 3G/4G network, you can share the connection with your laptop or other devices by making your GT500V a Wi-Fi hotspot. To do so:

1. Tap **Settings | Wireless & networks | More | Tethering & portable hotspot | Wi-Fi hotspot**.
2. Tap Wi-Fi hotspot slider to enable the hotspot function.
3. Tap **Set up Wi-Fi hotspot** to configure the settings as needed:
  - **Network SSID:** Enter a name to identify the wireless network created by the GT500V.
  - **Security & password:** To prevent your device from being accessed by unauthorized users, it is strongly recommended that you set up a password to protect your network.

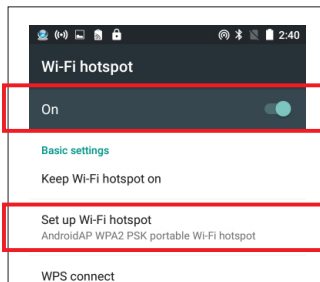

When Wi-Fi hotspot is enabled, a Wi-Fi hotspot icon  will appear in the **Notification Area**.

## 3.5 Using the Bluetooth Feature

Bluetooth enables the wireless connection over a short distance about 8 meters. It is specified as a "wireless personal area network" (WPAN). The GT500V is Bluetooth-capable to synchronize data with other Bluetooth-capable devices such as PCs, laptops, hands-free, headsets, printers, PDAs and cell phones.

Before the GT500V can connect a Bluetooth device, it needs to pair with that device. Such "pairing" involves the authentication between them to justify their accesses to each other. Once they are paired, they stay paired unless they are unpaired.

---

### 3.5.1 Enabling Bluetooth and Pairing with Bluetooth Device

To enable or disable the Bluetooth function:

1. Tap **Settings | Bluetooth** and turn on Bluetooth if it isn't enabled yet.

**Note:** When Bluetooth is enabled, then the GT500V is visible to nearby devices.

2. If the Bluetooth device you want to pair with is not displayed in the **Available devices** list, tap the menu icon  to open the context menu and select **Refresh**.

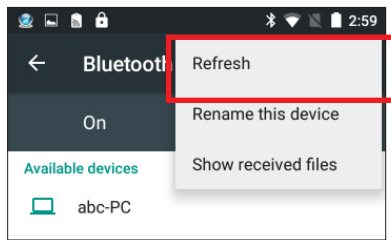

The GT500V proceeds to scan for any Bluetooth device in range. Then it displays the names of the device(s) found.

**Note:** If the device to pair with isn't displayed after the scan, check if it is configured to be discoverable.

3. Tap the device you want to pair with. When the **Bluetooth pairing request** dialog box appears, tap **Pair**. The GT500V will then send a connection request to the device you want to pair with.

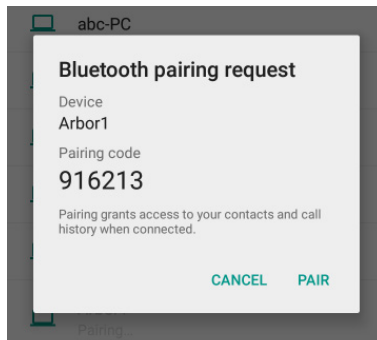



---

On the device to pair with, a dialog box appears requesting to enter or verify the pairing code. The passkey entered or shown on the GT500V and the Bluetooth device must be the same.

If you're prompted to enter a pin code, try entering 0000 or 1234 (the most common pin code), or look up in the documentation that came with the other Bluetooth device to learn its pin code.

Then the devices proceed to pair with each other.

---

## 3.5.2 Configuring Bluetooth Features to Use

A "Bluetooth profile" defines the features supported by a Bluetooth device. For two Bluetooth devices to share files with each other, they need to both support the right profile. A profile can provide the ability to transmit phone conversations, to play music in stereo, or to transfer files or other data. Some Bluetooth devices have multiple profiles. To select the profile to use, tap the paired Bluetooth device and then select the profile.

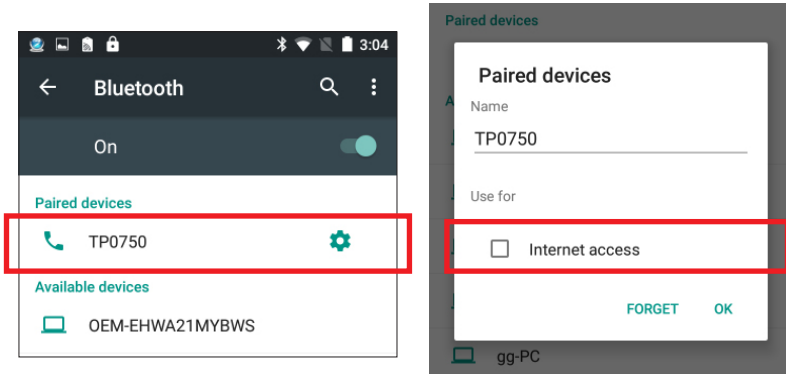

## 3.5.3 Disconnect from a Bluetooth Device

To disconnect the GT500V from a Bluetooth device:

1. Tap **Settings | Bluetooth**.
2. In the **Paired devices** list, find the device to disconnect and tap it.
3. Tap **FORGET** to unpair the device.

## 3.5.4 Configuring Your Bluetooth Device

When Bluetooth is enabled, then the GT500V is visible to nearby devices with the default name **ANDROID BT**. To rename the device,

1. Tap **Settings | Bluetooth** and turn on Bluetooth if it isn't enabled yet.
2. Tap the menu icon **⋮** to open the context menu and select **Rename the device** and then you can rename it.

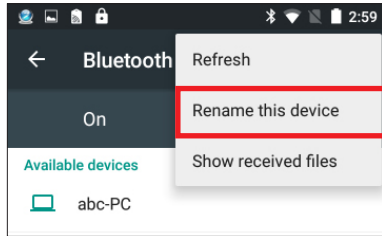

## 3.6 Using the Location Feature

The GT500V features positioning function to identify your location. It allows location-based Apps to collect and use your location information to provide location-related service. For example, a third-party App might want to pinpoint a vehicle's location so as to provide a more efficient route for the driver upon traffic congestion. For a location-based App, you can individually configure whether it is allowed to access to location services when the service is on.

**Note:** When you turn off the location service, you also turn it off for the Apps that use this service. That means location-based service will stop and not be available.

### 3.6.1 Enabling/Disabling Location Service

To turn on or off location service, tap **Settings | Personal | Location** to turn it on or off.

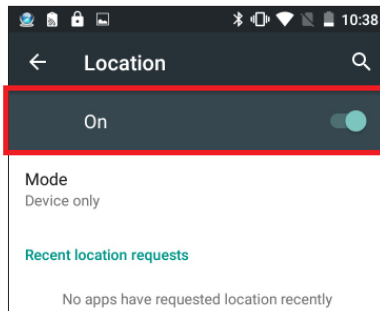

---

## 3.6.2 Location Mode

In addition to GPS satellite method, the GT500V is also capable of using Wi-Fi and cellular networks to speed up positioning performance. According to the position mode, the battery drain and position accuracy varies.

To select a location position mode when the location service is on,

1. Tap **Settings | Personal | Location | Mode**.
2. Tap **Mode** and select a mode:
  - **High accuracy:** This mode uses GPS, Wi-Fi and cellular networks to determine location. It drains the battery faster yet higher accuracy is achieved compared to the other two modes. Select this mode if precise location matters to you.
  - **Battery saving:** This mode uses Wi-Fi and cellular networks to determine your location. Select this mode if you need to extend the battery life.
  - **Device only:** This mode determines your location using GPS only. Without using Wi-Fi and cellular networks to improve the startup process, it takes longer to determine the location.

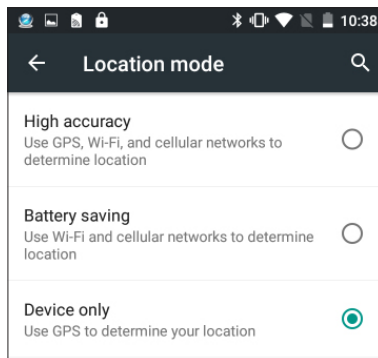

---

## 3.7 Using the Camera

The device is equipped with two cameras: a front-facing camera and a back-facing camera with LED flash. Using the native camera application that comes with the operation system, you can switch between the front and rear cameras and perform other camera operations.

To access the camera application, on the **Home** screen tap the camera icon



The camera application then opens.

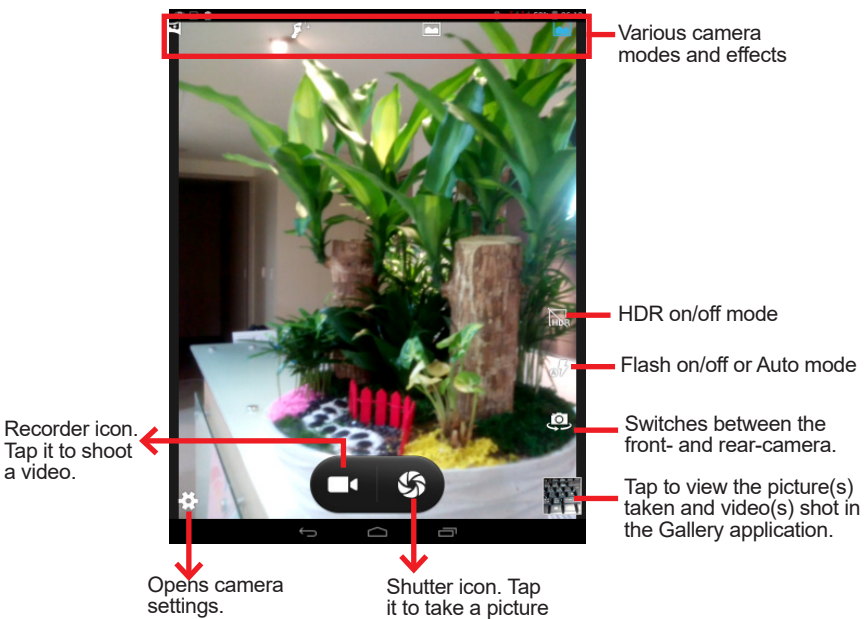

---

When taking a photo:

- To zoom in and out, place two fingers apart or together.
- When you frame your subject on the screen, the rear camera will auto focus on the center of the screen with a focus indicator. To manually make a focus, tap the target or area that you want to focus on.
- To take a photo, press the shutter icon.

When recording a video:

- To enable/disable the microphone, tap the Settings icon and then video icon.
- To start the recording, tap the Recorder icon and the timer starts.
- To stop the recording, tap the Recorder icon again.

---

## 3.8 Using the NFC Feature

Near Field Communication (NFC) is a short-range wireless communication technology that enables NFC-capable devices to exchange data such as contacts, photos, music, or web address over a short distance less than 4 centimeters.

The NFC detection area is at the back side of the GT500V. When you tap other NFC devices, tags, or readers, the NFC areas of both devices should be close to one another so that the connection can be established.



### 3.8.1 Enabling/Disabling NFC

To enable or disable the NFC function:

1. Tap **Settings | Wireless & networks | More | NFC** to turn on/off NFC.

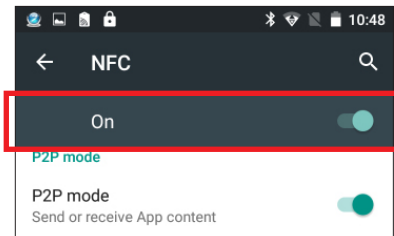

2. When NFC is enabled, its icon  will be displayed in the **Notification Area**.

### 3.8.2 Configuring NFC Modes

The GT500V supports two NFC modes: P2P and TAG modes.

To configure the NFC modes:

1. Tap **Settings | Wireless & networks | More | NFC** and turn on NFC if it isn't enabled yet.
2. Enable the modes as needed:
  - **P2P mode:** Peer-to-Peer mode utilizes Android Beam feature to exchange App contents such as contacts, photos, music, or web address as long as the App supports Android Beam function. To use this mode to exchange data, see [3.8.3 Exchanging Data with NFC-Enabled Device](#) for more information.
  - **Tag mode:** Allows the GT500V to read NFC tags. For example, working as a tag reader the GT500V can read the NFC tag of a smartposter to retrieve information like product or promotion information.

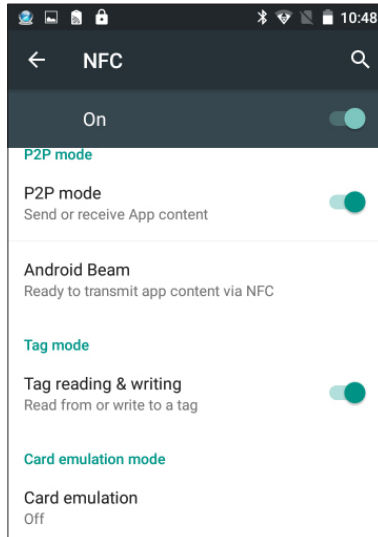

### 3.8.3 Exchanging Data with NFC-Enabled Device

To use NFC to exchange App contents, both sending and receiving devices must be NFC-enabled and unlocked. The following describes how to beam App content from the GT500V to another NFC device:

1. Make sure both devices are NFC-enabled. For your GT500V, enable NFC as described in [3.8.1 Enabling/Disabling NFC](#) if it isn't enabled yet.



- 
2. On the GT500V, access NFC settings page and make sure P2P mode check box is ticked.
  3. Open the content you want to exchange.
  4. Make sure the screen of both devices are unlocked, then touch the devices together, back to back.
  5. On the GT500V, you will hear a sound and be prompted a message "**Touch to beam**". Touch the screen of the GT500V to begin the beaming process.
  6. The content will appear on the other devices's screen.

### 3.8.4 Using Tap & Pay

You can tap and pay with the GT500V at the merchants that accept contact-less payments. To use the tap and pay on NFC:

1. Tap **Settings | Wireless & networks | More | NFC** and turn on NFC if it isn't enabled yet.
2. Enable the **Tap & Pay** option.

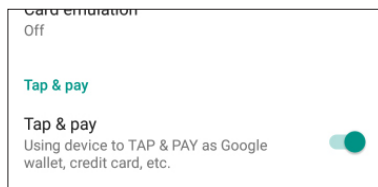

## 3.9 Using the Barcode Scanner

Barcode scanner is an optional feature on the GT500V. Depending on your models, your GT500V might be equipped with 1D/2D barcode scanner. This section will walk you through the basic operations. To get the information on supported barcode formats, see [3.9.2 Supported Barcode Formats](#) for details.

To use the barcode scanner, simply press the scan keys on either side of the GT500V to scan the barcode.



### 3.9.1 Using the BarcodeScanWizard (Optional)

Generally a third-party barcode application will be used to process the data read by the scanner. An optional **BarcodeScanWizard** is installed on the GT500V. The App provides on-screen buttons to activate the barcode scanner so that you don't need to press the triggers on either side of the GT500V.

To use the App:

1. Launch the **BarcodeScanWizard** App.
2. Swipe down the **Notification Area** and make sure to turn on the **Scan Button**.

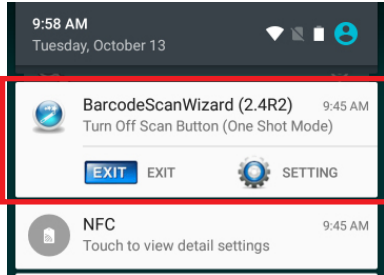

3. A green button shall appear on the screen. Press the button to scan. The button turns green when the scanner is activated.

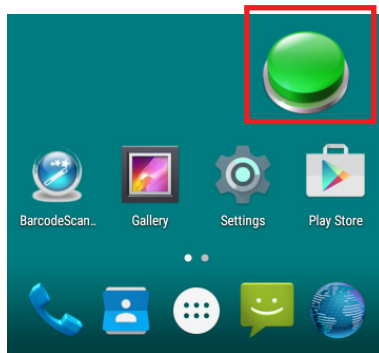

4. Press the red button to stop.

### 3.9.2 Supported Barcode Formats

| Type              | Formats  |
|-------------------|--|
| <b>Linear</b>     | UPC/EAN, Bookland EAN, UCC Coupon Code, ISSN EAN, Code 128, GS1-128, ISBT 128, Code 39, Trioptic Code 39, Code 32, Code 93, Code 11, Interleaved 2 of 5, Discrete 2 of 5, Codabar, MSI, Chinese 2 of 5, Matrix 2 of 5, Korean 3 of 5, Inverse 1D, GS1 DataBar, Composite Codes |
| <b>2D Stacked</b> | PDF417, MicroPDF417  |
| <b>2D Matrix</b>  | Data Matrix, Data Matrix Inverse, Maxicode, QR Code, MicroQR, QR Inverse, Aztec, Aztec Inverse   |
| <b>Postal</b>     | US Postnet, US Planet, UK Postal, Japan Postal, Australian Postal, Netherlands KIX Code, USPS 4CB/One Code/Intelligent Mail, UPU FICS Postal   |

- ◆ Do not drop your device or cause impacts to your device.

## warnings

### ◆ WARNING!! Read this information before using your phone

This device complies with part 15 of the FCC Rules. Operation is subject to the condition that this device does not cause harmful interference

Any changes or modifications not expressly approved by the party responsible for compliance could void the user's authority to operate the equipment.

NOTE: This equipment has been tested and found to comply with the limits for a Class B digital device, pursuant to Part 15 of the FCC Rules. These limits are designed to provide reasonable protection against harmful interference in a residential installation. This equipment generates, uses and can radiate radio frequency energy and, if not installed and used in accordance with the instructions, may cause harmful interference to radio communications. However, there is no guarantee that interference will not occur in a particular installation.

If this equipment does cause harmful interference to radio or television reception, which can be determined by turning the equipment off and on, the user is encouraged to try to correct the interference by one or more of the following measures:

- Reorient or relocate the receiving antenna.
- Increase the separation between the equipment and receiver.
- Connect the equipment into an outlet on a circuit different from that to which the receiver is connected.
- Consult the dealer or an experienced radio/TV technician for help.

Specific Absorption Rate (SAR) information:

This Mobile Phone meets the government's requirements for exposure to radio waves. The guidelines are based on standards that were developed by independent scientific organizations through periodic and thorough evaluation of scientific studies. The standards include a substantial safety margin designed to assure the safety of all persons regardless of age or health. FCC RF Exposure Information and Statement The SAR limit of USA (FCC) is 1.6 W/kg averaged over one gram of tissue. Device types: GT500V (FCC ID: 2AQ5W-GT500V) has also been tested against this SAR limit. The highest SAR value reported under this standard during product certification for use at the ear is 0.101W/kg and when properly worn on the body is 1.138W/kg. This device was tested for typical body-worn operations with the back of the handset kept 0mm from the body. To maintain compliance with FCC RF exposure requirements, use accessories that maintain a 10mm separation distance between the user's body and the back of the handset. The use of belt clips, holsters and similar accessories should not contain metallic components in its assembly. The use of accessories that do not satisfy these requirements may not comply with FCC RF exposure requirements, and should be avoided.

Body-worn Operation

This device was tested for typical body-worn operations. To comply with RF exposure requirements, a minimum separation distance of 10mm must be maintained between the user's body and the handset, including the antenna. Third-party belt-clips, holsters, and similar accessories used by this device should not contain any metallic components. Body-worn accessories that do not meet these requirements may not comply with RF exposure requirements and should be avoided. Use only the supplied or an approved antenna.

FCC ID:2AQ5W-GT500V