

E101 (Tuya WiFi)

智能锁使用说明书

使用前请仔细阅读本手册

注意：请务必将应急机械钥匙随身携带或置于室外安全之处

使用须知

温馨提示：安装前请准备好十字螺丝刀1把，7号电池4节。

1. 刚出厂的门锁经初始化后即为新锁，密码 '12345'+ '#' 可以打开。
2. 在开门时如门锁电压不足，锁会发出警告声，请即时更换电池。
3. 请不要用腐蚀性物质清洁锁面，以免破坏锁面保护层，影响锁表面光泽。
4. 当密码、APP无法开门时，可用机械钥匙开门，请妥善保管机械钥匙，并置于室外安全之处。
5. 适用门厚：35-55mm
6. 工作温度：-25度~55度。

产品特点

1. 系统提供总用户100个。
2. 密码(支持6-8位)/机械钥匙/APP都可开锁。
3. 低电压报警。
4. 声音可切换。

名称	性能参数
开锁方式	密码、钥匙、APP
存储容量	100个
验证时间	0.3s
供电电压	6V
低电警报电压	4.6V
待机电流	<=30uA

安装

1. 锁安装说明

- 建议专业人士安装，先看视频了解后再安装。
- 安装时请注意不能挤压、碰到连接线，造成线路故障。
- 安装时需一直使门体处于半开状态，直到调试完成。
- 安装完成后，测试密码12345+#、钥匙、内外把手开锁，是否正常。
- 如不能正常使用，请检查是否安装不当或电源线接头松动等现象。

2. 安装示意图

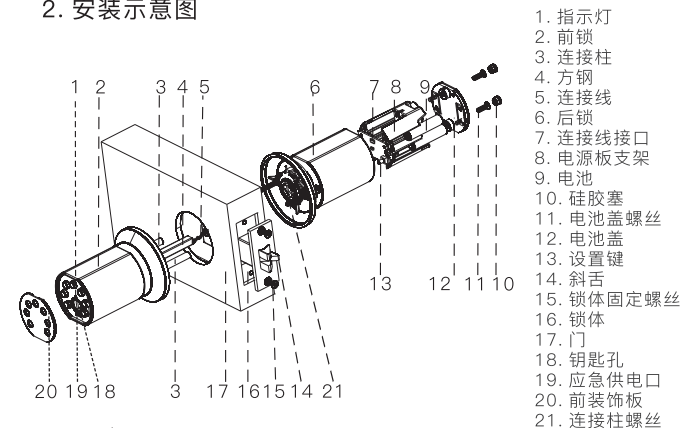

3. 开孔

按配的锁体，参考开孔图，在门上对应开孔。
(门边离锁中心的距离可开60mm或70mm)

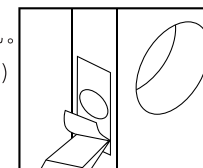

4. 锁拆卸

- 取出前锁和后锁。
- 用螺丝刀扭开后锁上2个电池盖螺丝，取出电池盖。
- 取出电源板支架，拆下连接线，注意不能扯坏连接线。
- 再用螺丝刀扭开后锁上2个连接柱螺丝，取出后锁。
- 拆下锁体，注意不能扯坏连接线。

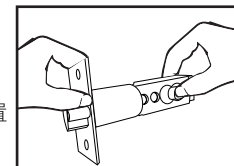

5. 锁体安装

5.1. 根据门的开孔位置调整锁体的位置
(60mm或者70mm)。

5.2. 确定门的方向

本产品适用于(左外开、左内开、右外开、右内开)四种开门方向。

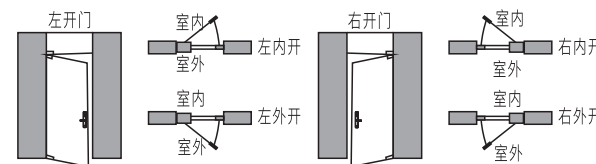

5.3. 根据门的方向选择锁体斜舌的安装方向。

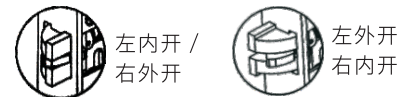

5.4. 根据开孔图，将锁体放入门框内，
扭紧锁体上的2个固定螺丝。

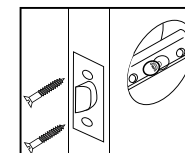

6. 锁安装

6.1. 固定前锁

- 连接导线穿过锁体上的方钢孔。
 - 将前锁对准锁体上的方钢孔和连接柱孔穿入，压紧方钢另一端，使方钢伸到底，固定前锁在门上。
- 注意：前锁不能放反，而导致数字键显示不正。

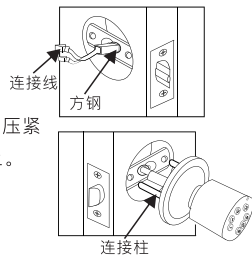

6.2. 固定后锁

- 将连接导线穿过锁体的方钢孔。
 - 将后锁对准方钢穿入，螺丝孔对齐连接柱。
 - 锁紧2个连接柱螺丝，晃动前后锁，确保前后锁固定偏紧。
 - 取电源板支架，对应扣上2个连接导线接口。
 - 理好连接导线，把后板装入后锁中。
 - 按电池装配方向，装入4个7号电池。
 - 装上电池盖，拧紧2个电池盖固定螺丝。
- 注意：电池盖跟后锁在一个面上，否则需检查连接导线是否有干涉。

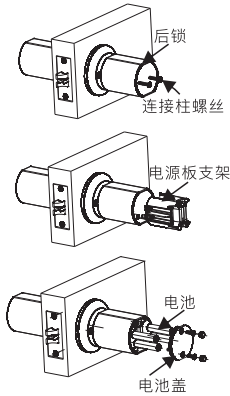

7. 侧扣板、侧扣盒安装

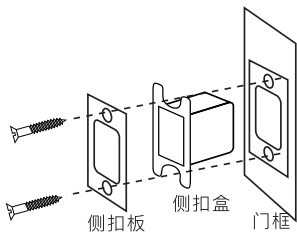

8. 调试

- 使门一直处于半开状态，进行调试。
- 密码未开锁时，前锁转动，确认锁舌不动，确认流畅性。
- 密码已开锁时，前锁转动，确认锁舌缩回，确认流畅性。
- 任何状态，后锁转动，确认锁舌缩回，确认流畅性。
- 验证其他功能(自锁、虚位密码、设置键、APP等)是否正常。

具体操作说明

添加管理员

- 短按“*”+“#”键，或短按后锁“设置键”，声音提示：长‘嘀’一声。
- 输入密码+“#”键(相同密码，2次)。
- 声音提示：‘哆来咪发唆’。

注：1，录入的前三次信息为管理员。

- 2，录入失败情况（‘嘀嘀’两声）
 - 2.1 密码过于简单。
 - 2.2 密码长度不在6-8位范围内。
 - 2.3 两次录入的密码不一致。

添加用户

- 短按“*”+“#”键，或短按后锁“设置键”，声音提示：‘唆发咪来哆’。
- 验证已添加的管理员，验证成功后，声音提示：长‘嘀’一声。
- 输入密码+“#”键(相同密码，2次)。
- 声音提示：‘哆来咪发唆’，即添加成功，可继续输入新密码添加用户。

删除用户

- 短按“5”+“#”键，声音提示：‘唆发咪来哆’。
- 验证已添加的管理员，验证成功后，声音提示：长‘嘀’一声。
- 输入要删除的密码+“#”键确认，声音提示：长‘嘀’一声。
- 再次输入要删除的密码+“#”键确认。
- 声音提示：‘哆来咪发唆’，即删除成功。

注：此操作不能删除管理员，管理员需通过恢复出厂设置删除。

恢复出厂设置

- 长按后锁设置键5秒，声音提示：‘唆发咪来哆’，验证已经添加的管理员。
- 系统自动恢复到出厂设置状态（初始密码：12345）。
- 声音提示：‘哆来咪发唆’，删除所有管理员和用户。

APP配网(前提：锁需先添加数字密码管理员)

- 手机先连上WiFi (APP配网仅支持2.4Ghz WiFi，且网络正常)。
- 在APP Store或应用商店搜索‘涂鸦智能’或微信扫描右边二维码，下载并安装。
- 打开APP，用手机号注册并登录，进入APP。
- 配网：
 - 4.1 进入APP，点击‘我的家’/‘添加设备’/‘安防传感’/‘门锁(Wi-Fi)’/‘确认指示灯在快闪’，选择手机已连接的Wi-Fi网络和输入密码。
 - 4.2 在智能锁上按“3”+“#”，验证管理员后，待智能锁LED面板上数字键闪烁时，APP点击‘确认’，进入配网状态，直到成功。
 - 4.3 配网成功：声音提示‘哆来咪发唆’。
 - 4.4 配网失败：声音提示‘嘀嘀’两声，请重新配网。

注：1. APP和手机需连接同一WiFi网络。

2. APP远程开锁：需先按门锁上的“4”+“#”键进行激活，数字键闪烁时，APP上出现‘点击远程开门’提示，点击后才能开锁。

其他功能

自锁：密码连续输错5次系统锁定180秒。
低电压警告：电池低于4.6V时，每次开门都会先提示‘滴滴’，同时指示灯显示红色，请及时更换新的电池（不同型号/品牌电池不要混用）。
虚位密码：在注册的密码前后输入任意密码（密码总数不超过20位），都可开锁。
声音切换：按“3”“3”“3”“#”键进行切换静音、响铃。

保修卡

- 产品出厂包装均配有此说明书及保修卡，用户安装好后请填写好保修卡内容并妥善保管，以作保修凭证。
- 本产品保修一年。
- 以下不属于保修范围：
 - A.意外因素、人为行为或外力（包括暴力撬坏，输入不适合的电压等）造成损坏。
 - B.自然灾害（如地震、火灾、水灾等）不可抗拒原因造成损坏。
 - C.自行安装或不符合安装说明书要求引起的损坏。
- 对于保修范围外，我们将收取相应费用。
- 产品出现故障时，请向当地经销商或致电售后寻求帮助，保修时请填写具体地址、姓名、电话及故障现象。

商品信息	产品名称	
	产品型号	
	购买价格	
	购买日期	
用户信息	用户姓名	
	联系电话	
	通讯地址	
	邮政编码	
销售信息	销售商名称	
	地址	
	联系电话	
	发票号码	
	销售商签章	

维修记录（由维修机构填写）

维修日期	故障情况	维修记录	授权维修签章

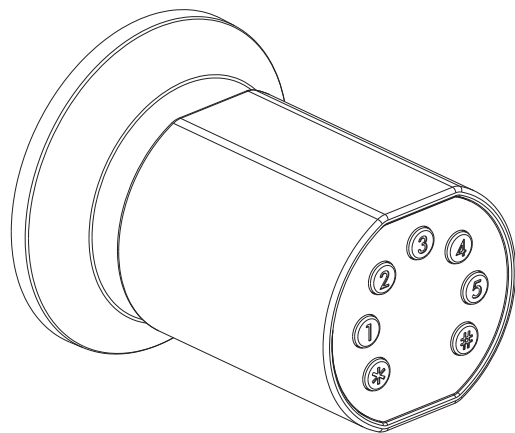

E101

(Tuya WiFi)

Smart Lock User Manual

Please read this manual carefully before use

Usage Notice

Note: Please prepare a Phillips screw driver and 4pcs AAA batteries before installation.

1. In default setting, it can be unlocked with original password 12345 ended with “#” or mechanical key.
2. There will be a low power alarm when voltage below 4.8V, please replace the batteries in time.
3. Please don't use any corrodent material to clean lock surface.
4. Please use mechanical key to unlock when password and APP not work. Make sure your mechanical keys kept in outdoors safe places.
5. Suitable door thickness: 35 ~ 55mm
6. Work temperature: -13°F ~ 131°F.

Features

1. The total capacity of system is 100, and the first three ones are administrators.
2. Three methods unlock: password(6-8 digits)/mechanical key/APP.
3. Support low power alarm.
4. Support Mute mode/Sound mode switch

Name	Parameter
Unlock Way	Password, Key and APP
System Capacity	100
Identify Time	0.3S
Supply Voltage	6V
Low Voltage Warning	4.6V
Standby Current	<=30uA

Installation

1. Installation Overview

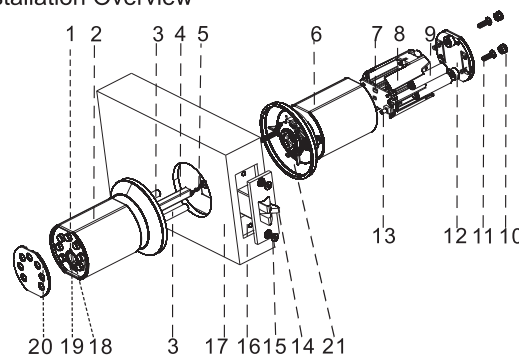

- | | | |
|------------------------------|--------------------------|-----------------------------------|
| 1. Indicator Light | 8. Battery Holder | 15. Deadbolt Screws |
| 2. Front Handle | 9. Batteries | 16. Deadbolt |
| 3. Connection Column | 10. Silicon Plug | 17. Door |
| 4. Square Steel | 11. Battery Cover screws | 18. Mechanical Key Hole |
| 5. Connection Wire | 12. Battery Cover | 19. Emergency Power Port |
| 6. Back Handle | 13. 'Set' Button | 20. Front handle Decoration Plate |
| 7. Connection Wire Interface | 14. Deadbolt Tongue | 21. Connection Column Screws |

2. Installation Instruction

- a. It is recommended professionals to install with reference installation video.
- b. Please note that the connection wire can't be pressed or folded during installation.
- c. Please make the door in half open status during the installation until all function tested OK.
- d. When installation finished, please check password `12345#` unlock, mechanical key unlock, handle twist OK or not.
- e. If it can not work normally, please check if any improper installation or problem of power cord loose.

3. Hole Punching

Please refer to the hole punching drawing to drill right holes on the door. (The distance between door edge and lock center can be 60mm or 70mm)

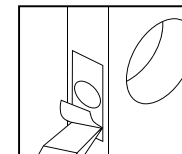

4. Disassembly

- a. Take out front handle and back handle from the package.
- b. Remove 2pcs screws on battery cover of back handle to disassemble battery cover.
- c. Take out the battery holder and disassemble the connection wires. Take care not pull the connection wire broken down.
- d. Remove 2pcs connection column screws on back handle and take out the back handle.
- e. Disassemble the deadbolt and take care not pull the connection wire broken down.

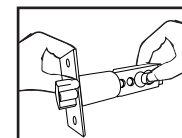

5. Deadbolt Installation

- 5.1 Adjust deadbolt length according to the punching hole position.(60mm or 70mm)
- 5.2 Confirm the door direction

The lock supports 4 directions: Left out, Left in, Right out, Right in

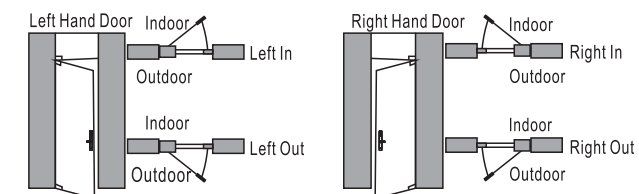

- 5.3 Choose the right installation direction of deadbolt tongue according to the door direction.



- 5.4 Insert the deadbolt into door frame and fix it 2 screws.

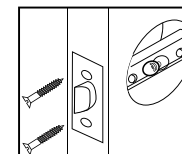

6. Lock Installation

6.1 Fixing front handle

- Make the connection wire go through the square steel hole.
- Make the connection column and square steel match with the correct holes on deadbolt, press the front handle and fix it on the door.

Note: Don't install the front handle in opposite direction, please keep the numbers recognizable.

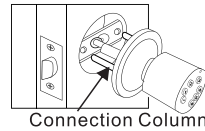
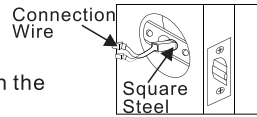

6.2 Fixing back handle

- Make the connection wire go through the square steel hole on back handle.
- Match the back handle square steel hole and screw holes with the square steel and connection column.
- Fix the back handle and front handle with connection column screws. Shake the handles and make sure them installed well.
- Take the battery holder and connect well 2 interfaces.
- Sort well the connection wire and put the battery holder into the back handle.
- Install 4 AAA batteries.
- Assemble the battery cover with 2 screws.

Note: Please make sure the battery cover and back handle on the same plane, otherwise please check the internal connection wires sorted well or not.

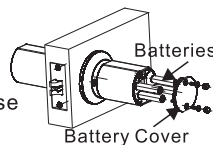
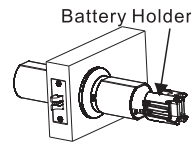
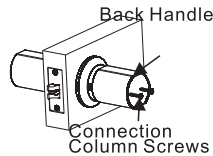

7. Install Buckle Plate and Buckle Box

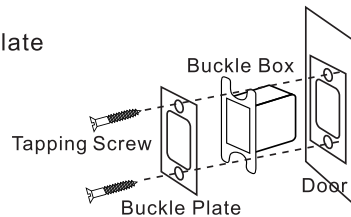

8. Debugging

- Please always keep the door in half open status when debugging.
- Check the following functions can be achieve or not.
In lock status, twist front handle, deadbolt remains.
In unlock status, twist front handle, deadbolt retract.
Both lock and unlock status, twist back handle, deadbolt retract.
- Verify other function includes Self lock, Anti-peeping password, "Set" button, APP work well or not.

Using The Lock

Add Administrator (The first three are administrator)

- Short press `set` button (on back handle) or press `*` and `#`, the lock will long beep.
- Add administrator password (6-8 digits) ended with `#` (The same password, 2 times)
- Melody `do,re,mi,fa,sol` will indicate it added successfully. Then you can continue to add the 2nd and 3rd administrator.

Note:

- The first three passwords are taken as administrators
- Add failure situation :The lock will make a sound of `Di,Di` (two times `Di`)
 - Password is too simple.
 - Password is less than 6 digits or exceed 8 digits.
 - Two times entered passwords are different.

Add User

- Short press `set` button or press `*` and `#`, the melody `sol,fa,mi,re,do` will indicate you to verify administrator.
- After verifying the administrator with password, the lock will long beep.
- Enter same user password (6-8 digits) ended with `#` 2 times.
- There will be a melody `do,re,mi,fa,sol` indicating it added successfully.

Delete User

- Short press `5` and `#`, the melody `sol,fa,mi,re,do` will indicate you to verify administrator.
 - After verifying the administrator with password, the lock will long beep.
 - Enter the user password need to be deleted ended with `#`, the lock will long beep.
 - Enter the user password to be deleted ended with `#` once again.
 - There will be a melody `do,re,mi,fa,sol` indicating it deleted successfully.
- Note: The operation can only delete users, can not delete administrators. Only resetting the lock can delete the administrators.

Reset Lock

- Long press the `set` button on back handle with 5 seconds, the melody `sol,fa,mi,re,do` will indicate you to verify administrator.
- After verifying the administrator with password, the lock will go back to the default setting. (Initial password 12345)
- There will be a melody `do,re,mi,fa,sol` indicating all administrators and users deleted successfully.

APP installation and network configuration

(Make sure you add administrator before network configuration)

- Make your cellphone connect with a 2.4Ghz WiFi.
(Network configuration only supports 2.4Ghz WiFi)
- Search and download `TuyaSmart` in APP store.
- Install and open the APP, register and login with cellphone number.
- Network configuration
 - Enter the APP, click `My family` / `Add Device` / `Security&Sensor` / `Lock(Wi-Fi)` Confirm indicator rapidly blink, then select WiFi network and enter WiFi password.
 - Short press `3` and `#` on the lock, verify the administrator, start make network configuration when lock numbers blinking.
 - There will be a melody `do,re,mi,fa,sol` indicating network configured successfully.
 - Otherwise, the lock will make a sound of `Di,Di` (two times `Di`) to indicate network configuration failure, please make configuration once again.

Notes:

- Make sure APP and cellphone should be connected with same WiFi.
- APP remote unlock: Press `4` and `#` to activate the lock, the numbers on lock will start to flicker and APP will receive a notification, click to confirm unlock remotely.

Other function

Self lock: The system will be locked 180 seconds when entering wrong password 5 times continuously.

Low power alarm: When the battery power is less than 4.6V, the lock will make a sound of `Di,Di` (two times `Di`) to alarm and the indicator light will turn red. Please change batteries in time. Please make sure not mix use different model/different brand batteries together.

Anti-peeping password: Random password added before or after the correct password, it also can unlock as long as the real password keep continuously correct. (Anti-peeping password can not exceed 20 digits)

Volume switch: Continuously press `3` three times followed by `#`, you can switch volume from mute mode to sound mode.

FCC Statement:

This device complies with Part 15 of the FCC Rules. Operation is subject to the following two conditions:

- This device may not cause harmful interference, and
- This device must accept any interference received, including interference that may cause undesired operation.

Warning: Changes or modifications not expressly approved by the party responsible for compliance could void the user's authority to operate the equipment.

Note: This equipment has been tested and found to comply with the limits for a Class B digital device, pursuant to Part 15 of the FCC Rules. These limits are designed to provide reasonable protection against harmful interference in a residential installation. This equipment generates uses and can radiate radio frequency energy and, if not installed and used in accordance with the instructions, may cause harmful interference to radio communications. However, there is no guarantee that interference will not occur in a particular installation. If this equipment does cause harmful interference to radio or television reception, which can be determined by turning the equipment off and on, the user is encouraged to try to correct the interference by one or more of the following measures:

- Reorient or relocate the receiving antenna.
- Increase the separation between the equipment and receiver.
- Connect the equipment into an outlet on a circuit different from that to which the receiver is connected.
- Consult the dealer or an experienced radio/TV technician for help.

FCC Radiation Exposure Statement:

This equipment complies with FCC radiation exposure limits set forth for an uncontrolled environment. This equipment should be installed and operated with minimum distance 20cm between the radiator & your body.



APP Download QR Code