

Introduction

Thank you for purchasing the AudioTechnica Turntable Hi-Fi System.

Read through this user manual before using the product to ensure its correct use. This manual contains important information on safety, correct use, and disposal. Use the product as described and keep this manual for future reference.

This product can be used only in countries where the product is sold. Make sure that the operating voltage on the label for this product is the same as the operating voltage in the country you live in.

Package contents

Make sure that you have all the instructions listed below before using this product. If you are missing any manual, please contact your official customer service email: support@audio-technica.com or Facebook: <https://www.facebook.com/AudioTechnicaOfficial>.

After assembly, we suggest that you use all packaging materials for possible future disassembly or shipping.

This Turntable is qualified with a factory preset and adjusted cartridge. The following requirements for adjusting the cartridge are provided to ensure the cartridge is adjusted to all future models of a later date.

Precautions Before Use

Keep these instructions in mind

- Do not touch the turntable or motor assembly or the motor cover when you are using the product.
- Do not touch the turntable or motor assembly when the device is on and the motor is running. When the device is on and the motor is running, do not touch the turntable or motor assembly.
- Do not touch the turntable or motor assembly when the device is on and the motor is running. When the device is on and the motor is running, do not touch the turntable or motor assembly.
- Do not touch the turntable or motor assembly when the device is on and the motor is running. When the device is on and the motor is running, do not touch the turntable or motor assembly.
- Do not touch the turntable or motor assembly when the device is on and the motor is running. When the device is on and the motor is running, do not touch the turntable or motor assembly.
- Do not touch the turntable or motor assembly when the device is on and the motor is running. When the device is on and the motor is running, do not touch the turntable or motor assembly.
- Do not touch the turntable or motor assembly when the device is on and the motor is running. When the device is on and the motor is running, do not touch the turntable or motor assembly.
- Do not touch the turntable or motor assembly when the device is on and the motor is running. When the device is on and the motor is running, do not touch the turntable or motor assembly.
- Do not touch the turntable or motor assembly when the device is on and the motor is running. When the device is on and the motor is running, do not touch the turntable or motor assembly.
- Do not touch the turntable or motor assembly when the device is on and the motor is running. When the device is on and the motor is running, do not touch the turntable or motor assembly.
- Do not touch the turntable or motor assembly when the device is on and the motor is running. When the device is on and the motor is running, do not touch the turntable or motor assembly.
- Do not touch the turntable or motor assembly when the device is on and the motor is running. When the device is on and the motor is running, do not touch the turntable or motor assembly.
- Do not touch the turntable or motor assembly when the device is on and the motor is running. When the device is on and the motor is running, do not touch the turntable or motor assembly.
- Do not touch the turntable or motor assembly when the device is on and the motor is running. When the device is on and the motor is running, do not touch the turntable or motor assembly.
- Do not touch the turntable or motor assembly when the device is on and the motor is running. When the device is on and the motor is running, do not touch the turntable or motor assembly.

Precautions Before Use

Keep these instructions in mind

- Do not touch the turntable or motor assembly or the motor cover when you are using the product.
- Do not touch the turntable or motor assembly when the device is on and the motor is running. When the device is on and the motor is running, do not touch the turntable or motor assembly.
- Do not touch the turntable or motor assembly when the device is on and the motor is running. When the device is on and the motor is running, do not touch the turntable or motor assembly.
- Do not touch the turntable or motor assembly when the device is on and the motor is running. When the device is on and the motor is running, do not touch the turntable or motor assembly.
- Do not touch the turntable or motor assembly when the device is on and the motor is running. When the device is on and the motor is running, do not touch the turntable or motor assembly.
- Do not touch the turntable or motor assembly when the device is on and the motor is running. When the device is on and the motor is running, do not touch the turntable or motor assembly.
- Do not touch the turntable or motor assembly when the device is on and the motor is running. When the device is on and the motor is running, do not touch the turntable or motor assembly.
- Do not touch the turntable or motor assembly when the device is on and the motor is running. When the device is on and the motor is running, do not touch the turntable or motor assembly.
- Do not touch the turntable or motor assembly when the device is on and the motor is running. When the device is on and the motor is running, do not touch the turntable or motor assembly.
- Do not touch the turntable or motor assembly when the device is on and the motor is running. When the device is on and the motor is running, do not touch the turntable or motor assembly.
- Do not touch the turntable or motor assembly when the device is on and the motor is running. When the device is on and the motor is running, do not touch the turntable or motor assembly.
- Do not touch the turntable or motor assembly when the device is on and the motor is running. When the device is on and the motor is running, do not touch the turntable or motor assembly.
- Do not touch the turntable or motor assembly when the device is on and the motor is running. When the device is on and the motor is running, do not touch the turntable or motor assembly.
- Do not touch the turntable or motor assembly when the device is on and the motor is running. When the device is on and the motor is running, do not touch the turntable or motor assembly.
- Do not touch the turntable or motor assembly when the device is on and the motor is running. When the device is on and the motor is running, do not touch the turntable or motor assembly.

Precautions Before Use

Keep these instructions in mind

- Do not touch the turntable or motor assembly or the motor cover when you are using the product.
- Do not touch the turntable or motor assembly when the device is on and the motor is running. When the device is on and the motor is running, do not touch the turntable or motor assembly.
- Do not touch the turntable or motor assembly when the device is on and the motor is running. When the device is on and the motor is running, do not touch the turntable or motor assembly.
- Do not touch the turntable or motor assembly when the device is on and the motor is running. When the device is on and the motor is running, do not touch the turntable or motor assembly.
- Do not touch the turntable or motor assembly when the device is on and the motor is running. When the device is on and the motor is running, do not touch the turntable or motor assembly.
- Do not touch the turntable or motor assembly when the device is on and the motor is running. When the device is on and the motor is running, do not touch the turntable or motor assembly.
- Do not touch the turntable or motor assembly when the device is on and the motor is running. When the device is on and the motor is running, do not touch the turntable or motor assembly.
- Do not touch the turntable or motor assembly when the device is on and the motor is running. When the device is on and the motor is running, do not touch the turntable or motor assembly.
- Do not touch the turntable or motor assembly when the device is on and the motor is running. When the device is on and the motor is running, do not touch the turntable or motor assembly.
- Do not touch the turntable or motor assembly when the device is on and the motor is running. When the device is on and the motor is running, do not touch the turntable or motor assembly.
- Do not touch the turntable or motor assembly when the device is on and the motor is running. When the device is on and the motor is running, do not touch the turntable or motor assembly.
- Do not touch the turntable or motor assembly when the device is on and the motor is running. When the device is on and the motor is running, do not touch the turntable or motor assembly.
- Do not touch the turntable or motor assembly when the device is on and the motor is running. When the device is on and the motor is running, do not touch the turntable or motor assembly.
- Do not touch the turntable or motor assembly when the device is on and the motor is running. When the device is on and the motor is running, do not touch the turntable or motor assembly.
- Do not touch the turntable or motor assembly when the device is on and the motor is running. When the device is on and the motor is running, do not touch the turntable or motor assembly.

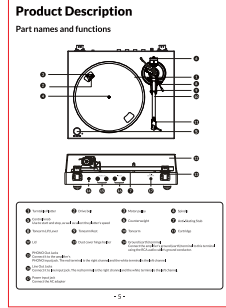

Product Description

Technical Specifications

Model Number	SP 15G 4080M
Speed Rotation	33 1/3 RPM
Wow & Flutter	0.15%
Signal Noise	18dB
Output Level	1.5V
Output Impedance	150Ω
Output Frequency	20 Hz - 20 kHz
Output Voltage	1.5V
Output Power	100mW (100Ω)
Dimensions (W x H x D)	115 x 142 x 113 mm
Weight	1.75kg
Power Source	100V/120V/220V/230VAC

Frequency response	20Hz-20kHz
Frequency response (with tonearm)	20Hz-20kHz
Channel separation	20dB
Channel crosstalk	15dB
Signal to noise	18dB
Output level	1.5V
Output impedance	150Ω
Output frequency	20 Hz - 20 kHz
Output voltage	1.5V
Output power	100mW (100Ω)
Dimensions (W x H x D)	115 x 142 x 113 mm
Weight	1.75kg
Power source	100V/120V/220V/230VAC

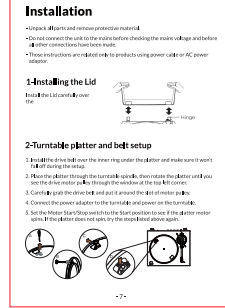

Installation

3-Cartridge tracking force adjustment

The counterweight has been adjusted for cartridge weight between 3.0-4.0g.

- Remove the counterweight cap. Push the counterweight down to the desired level.
- Adjust the counterweight to the desired level.

NOTE: The cartridge weight is 3.0g. The counterweight should be adjusted to 3.0g.

Installation

3-Cartridge tracking force adjustment

The counterweight has been adjusted for cartridge weight between 3.0-4.0g.

- Remove the counterweight cap. Push the counterweight down to the desired level.
- Adjust the counterweight to the desired level.

NOTE: The cartridge weight is 3.0g. The counterweight should be adjusted to 3.0g.

Installation

5-Connection to the Amplifier

The turntable has a moving magnet cartridge.

Connect the positive (+) lead to the amplifier input and the negative (-) lead to the amplifier ground.

NOTE: The amplifier input is 100mV. The turntable output is 1.5V.

Installation

7-Main Power Connection

The power adaptor is the main power input. Connect the power adaptor and plug the power cord into the power outlet.

NOTE: The power adaptor is 100V/120V/220V/230VAC. The power cord is 1.5m.

Operation

Bluetooth Operation

The unit has a Bluetooth transmitter to send audio to a Bluetooth speaker wirelessly.

- Power on the Bluetooth speaker and ensure it is in pairing mode.
- Press the Bluetooth button on the turntable to enter Bluetooth pairing mode.
- When pairing is successful, the Bluetooth speaker will connect to the turntable.

NOTE: The Bluetooth speaker must be within 10m of the turntable.

Cartridge Replacement

- Before replacing the cartridge, turn off the power to the turntable to prevent damage to the motor.
- Remove the counterweight cap and push the counterweight down to the desired level.
- Remove the counterweight cap and push the counterweight down to the desired level.
- Remove the counterweight cap and push the counterweight down to the desired level.
- Remove the counterweight cap and push the counterweight down to the desired level.

Troubleshooting

Potential Incorrect Use and Fault Conditions

Condition	Symptom
Incorrect use of the turntable	No sound or distorted sound
Incorrect use of the turntable	No sound or distorted sound
Incorrect use of the turntable	No sound or distorted sound
Incorrect use of the turntable	No sound or distorted sound
Incorrect use of the turntable	No sound or distorted sound
Incorrect use of the turntable	No sound or distorted sound
Incorrect use of the turntable	No sound or distorted sound
Incorrect use of the turntable	No sound or distorted sound
Incorrect use of the turntable	No sound or distorted sound
Incorrect use of the turntable	No sound or distorted sound

NOTE: This equipment has been tested and found to comply with the limits for a Class B digital device, pursuant to part 15 of the FCC Rules. These limits are designed to provide reasonable protection against harmful interference in a residential installation. This equipment generates and can receive radio frequency energy and, if not installed and used in accordance with the instructions, may cause harmful interference to radio communications. However, there is no guarantee that interference will not occur in a particular installation. If this equipment does cause harmful interference to radio or television reception, which can be determined by turning the equipment off and on, the user is encouraged to try to correct the interference by one or more of the following measures:

- Reorient or relocate the receiving antenna.
- Increase the separation between the equipment and receiver.
- Connect the equipment to a different power outlet or a circuit different from that to which the receiver is connected.
- Consult the dealer or an experienced radio/TV technician for help.

Changes or modifications not expressly approved by the party responsible for compliance may void the user's authority to operate the equipment.

This device complies with Part 15 of the FCC Rules. Operation is subject to the following two conditions:

- This device may not cause harmful interference.
- This device must accept any interference received, including interference that may cause unintended operation.

148.5*210mm