

HOW TO USE

- Pairing: Press the ON/OFF button for about 5 seconds until the LED light slow flashes from blue to red.
- Open the Bluetooth in your phone and pair with the beanie
- After pair successfully, open the music in your phone and enjoy the music
- Press the "Play" button to pause/play the music
- Answer a phone call by pressing ON/OFF button
- Long press the "+" button for volume up
- Long press the "-" button for volume down
- Device can be charged using a micro USB cable - when charging the LED light will turn red, when the LED light is off, it means the headset is fully charged
- Hand wash only - use cold water, and air-dry

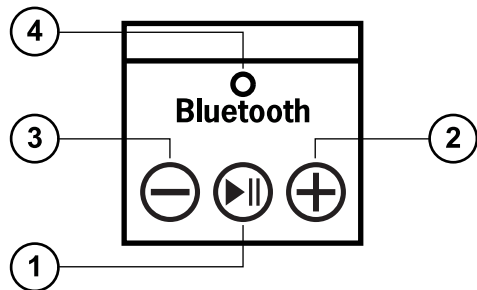

1. On/Off Power; Play/Pause; Answering/Dialing
2. Volume Up/ Next Track
3. Volume Down/ Previous Track
4. Charging Light

WASHING INSTRUCTIONS

Remove the electronics before washing.

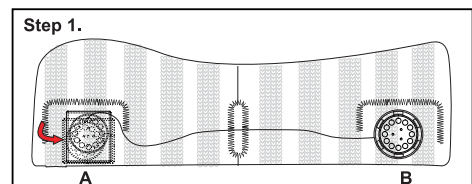

STEP 1. Turn beanie inside out and locate the control module (A) it is held in a pocket between a double layer inside the beanie.

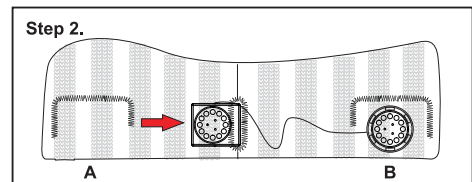

STEP 2. Gently push the control module towards the opening in the rear of the beanie and ease it out.

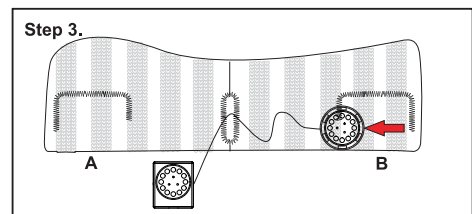

STEP 3. Repeat the above steps for the additional speaker (B) located at the opposite side of the beanie.



MTCBTBEANIE

GORRO DE BLUETOOTH BLUETOOTH BEANIE

USER MANUAL



Built-in
Microphone



Compatible with
most Smart phones



Rechargeable
Li-polymer Battery



Bluetooth
Technology



Made in China

CAUTION! WARNINGS/SAFETY

This product contains a non-changeable internal rechargeable Lithium-Ion battery.

Please handle with care.

- DO NOT expose product to liquids or moisture
- DO NOT use the hat in the rain
- DO NOT attempt to tamper with product by piercing, disassembling, opening or removing the battery, etc.
- DO NOT put, store, or leave your product in or near sources of heat, fire, in a pressurized container or in a microwave oven
- DO NOT leave the product in an unventilated vehicle under direct sunlight
- DO NOT store the product near acidic or alkaline material
- DO NOT expose product to temperatures over 60 °C (140 °F)
- ALWAYS take out the Bluetooth module and speaker before washing
- ALWAYS keep the electronics and battery out of the reach of infants and small children

DISPOSAL OF THE PRODUCT

Information on Waste Disposal for Consumers of Electrical & Electronic Equipment. This mark on a product and/or accompanying documents indicates that when it is to be disposed of, it must be treated as Waste Electrical & Electronic Equipment (WEEE). Any WEEE marked waste products must not be mixed with general household waste, but kept separate for the treatment, recovery and recycling of the materials used. For proper treatment, recovery and recycling; please take all WEEE marked waste to your Local Authority Civic waste site, where it will be accepted free of charge. If all consumers dispose of Waste Electrical & Electronic Equipment correctly, they will be helping to save valuable resources and preventing any potential negative effects upon human health and the environment, of any hazardous materials that the waste may contain.

FCC Statement

This device complies with part 15 of the FCC rules. Operation is subject to the following two conditions: (1) this device may not cause harmful interference, and (2) this device must accept any interference received, including interference that may cause undesired operation.

Changes or modifications not expressly approved by the party responsible for compliance could void the user's authority to operate the equipment.

NOTE: This equipment has been tested and found to comply with the limits for a Class B digital device, pursuant to part 15 of the FCC Rules. These limits are designed to provide reasonable protection against harmful interference in a residential installation. This equipment generates uses and can radiate radio frequency energy and, if not installed and used in accordance with the instructions, may cause harmful interference to radio communications. However, there is no guarantee that interference will not occur in a particular installation. If this equipment does cause harmful interference to radio or television reception, which can be determined by turning the equipment off and on, the user is encouraged to try to correct the interference by one or more of the following measures:

- 1) Reorient or relocate the receiving antenna.
- 2) Increase the separation between the equipment and receiver.
- 3) Connect the equipment into an outlet on a circuit different from that to which the receiver is connected.
- 4) Consult the dealer or an experienced radio/TV technician for help.

The device has been evaluated to meet general RF exposure requirement. The device can be used in portable exposure condition without restriction.