



Product Name: Real-time Wearable Translator

Brand Name: Timekettle, WT2 Plus

Model Name: WT2 Plus, WT2 S, WT2 X, WT2 Premium

We, as people, are constantly innovating, improving, and exploring,
We are enlightened by communication.
For long, language barrier has kept us in silent, in fear, and missing the opportunities.
With the creation of WT2 Plus,
Welcome to new era of foreign communication.

Product



01-Host



02-Guest



03-Charging Case



04-Charging Cable

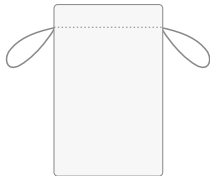

05-Carrying Bag



06-Ear-Hook



07-Earmuff



08-Manual

Step 1: Download App

Please scan the QR code below, or search "WT2 Plus" in "App Store / Google Play" to download our App.
The App requires network to work.



Scan QR code to download our App.

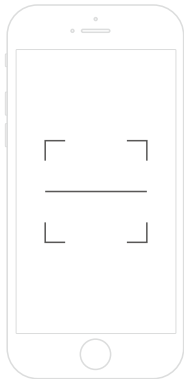

Step 2: Take out Earphones

Open the charging case, take out the Earphones (01 Host, 02 Guest)

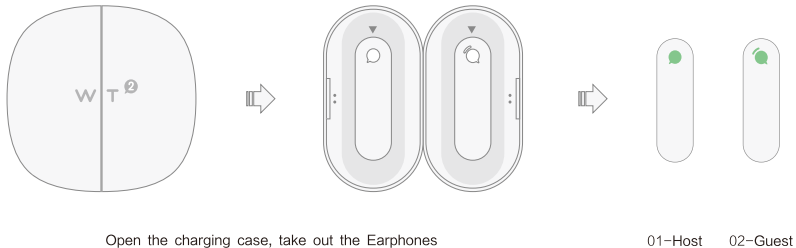

Step 3: Connect to App

After you take out the earphones, LED indicators on both Earphones will flash green light, now go to "Device" page on App, and connect Earphones.

When the connection completes, the LED indicators on both Earphones display solid green.

(WT2 Plus will automatically reconnect in your next use with its Connection-Memory function)



Click "01","02" to connect

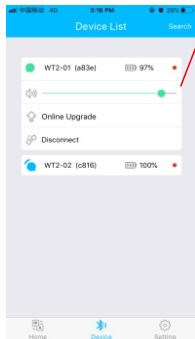

Adjust
Earphone volume

Connection Succeed

Step 4: Share & Select Mode

Share Earphone (Guest) with the person you need to communicate, wear Earphone (Host) yourself.

Our App has three different communication modes to suit your needs.

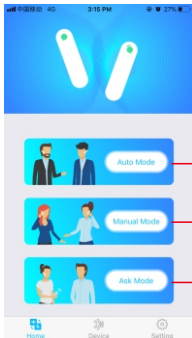

Absolutely Hands-Free

Control of Voice pick-up

Translation on the phone speaker!

Home Page

Step 5: Set Language & Start

Ex. In Auto mode, choose the languages on the top of the page for both Earphones.

"01-Host" Language



"02-Guest" Language

Choose "01" Language

Choose "02" Language

Auto Mode Page

Step 6: Say Something & Translate

When you start speaking, “bubbles” will appear, indicating recording has began.

When you finish speaking, a “beep” will sound, indicating recording has ended.

The translation result will display on the App, and play to both Earphones.

Once you press the “Pause”, your sentences will not be translated until you press “Start” to start again.

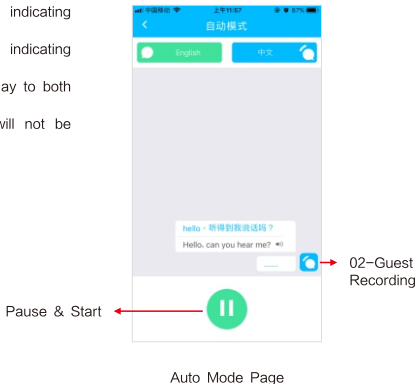

Touch Mode

In noisy environments, hold the “Touch Bar”, a “beep” will sound indicating the recording has activated, you can start speaking, when you release, a “beep” will sound again indicating the recording has ended.

Reminder

If you don't hold the Touch Bar, recording will not activate and your sentences will not be translated. This way you can control which sentences to be translated and played to both Earphones.

Speaker Mode

You wear one Earphone, hold the Touch Bar to speak. The translation will be played out through the phone speaker. When the other person wants to reply, hold the “Phone” icon on the screen, the phone will start recording, and translate back to your Earphone. This mode is suitable to communicate with strangers, or in a group of people.

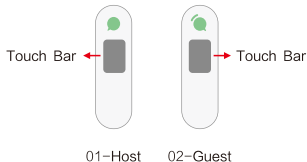

Charging

Earphones will automatically shutdown when put back into charging case, charging will begin when LED indicator flash white light. At full charge, white light will disappear.

It will take approximately 90 minutes for both the charging case and the Earphones to be fully charged.

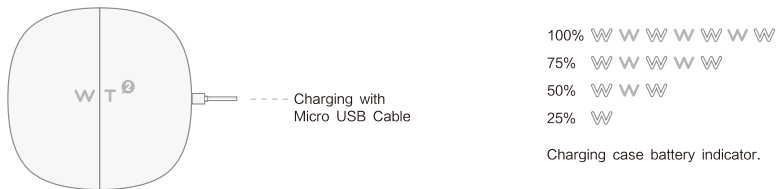

Troubleshooting

What if there is a lag in translation?

Check your network.

Make sure Earphones are 3 meters within the phone in range, and no obstacles are in between to prevent transmission interference.

What if translation is inaccurate?

Make sure the App Version is most-updated. Phone system is iOS11 / Android 7.0 or above.

Speak slower, and slightly louder

Make sure the bottom of the Earphone is pointed directly to the mouth.

Do not pause TOO often when you speak, avoid SLANGS!

Complete your sentence, if incorrect, try using another word.

Ex.

If "Two nights hotel." seems wrong

Try "I'd like to reserve a room for two nights."

What if the Earphone is too loss?

Mount the ear-hook to WT2 Plus for more substantial use.



Ear Hook Wearing

Troubleshooting (continued)

What if you can't connect WT2 Plus?

Check the battery through LED indicator.

If WT2 Plus is on Sleep Mode, use the "Touch Bar" to wake it up.

Make sure Bluetooth is ON, and not connected to other devices.

Restart Bluetooth, search the device again.

Make sure the App Version is most-updated. Phone system is iOS11 / Android 7.0 or above.

If connection failure continues, disable Bluetooth, close the App, put the Earphones back to charging case for 5 seconds, then take it out and try again.

LED Indicator	What it means
No light	Sleep Mode
Green light flashing	Connect to App
Green light remain solid	Ready to use
Red light flashing / remain solid	Low battery
Blue light remain solid	Upgrading
White light remain solid	Charging

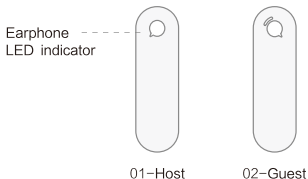

Safety

[Warning] Before you use, read the following:

1. Please do not break, burn, penetrate, squeeze or expose to moisture.
2. Do not use unauthorized modification of circuits, and mismatch of the battery and charger.
3. Use manufacturer-authorized and matched accessories only. If you use other unauthorized and mismatched accessories may result in violation of the Warranty. Please contact us if you lose any accessories.
4. In order to prevent hearing impairment, do not often use the device in high-volume.
5. Please use the device between 0°C to 35°C, and keep storage temperature between -20°C to 45°C. Malfunction may occur with extreme temperatures.
6. Please keep the device away from high temperature or heating electronics such as, microwave and oven.
7. Do not replace the battery yourself.

Official Website: www.timekettle.co

Customer Service: support@timekettle.co

Manufacturer: Shenzhen Timekettle Technologies Co., Ltd

Address: Building 3, Minqi Science Park, Xili Street, Nanshan District, Shenzhen, Guangdong, China.

All copyrights reserved by Shenzhen Timekettle Technologies Co., Ltd.

This manual is for reference only, do not constitute any form of commitment.

FCC Warning

This device complies with part 15 of the FCC Rules. Operation is subject to the following two conditions:

(1) This device may not cause harmful interference, and (2) this device must accept any interference received, including interference that may cause undesired operation.

Any Changes or modifications not expressly approved by the party responsible for compliance could void the user's authority to operate the equipment.

Note: This equipment has been tested and found to comply with the limits for a Class B digital device, pursuant to part 15 of the FCC Rules. These limits are designed to provide reasonable protection against harmful interference in a residential installation. This equipment generates uses and can radiate radio frequency energy and, if not installed and used in accordance with the instructions, may cause harmful interference to radio communications. However, there is no guarantee that interference will not occur in a particular installation. If this equipment does cause harmful interference to radio or television reception, which can be determined by turning the equipment off and on, the user is encouraged to try to correct the interference by one or more of the following measures:

- Reorient or relocate the receiving antenna.
- Increase the separation between the equipment and receiver.
- Connect the equipment into an outlet on a circuit different from that to which the receiver is connected.
- Consult the dealer or an experienced radio/TV technician for help.

The device has been evaluated to meet general RF exposure requirement. The device can be used in portable exposure condition without restriction.