

Product Manual

Packing list

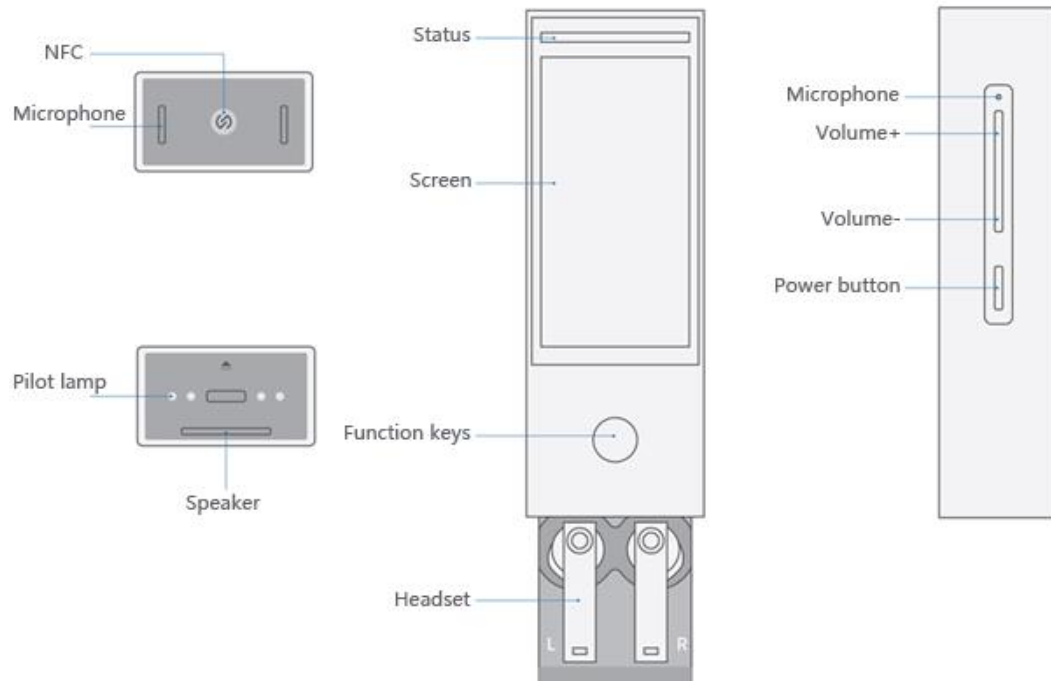

Basic Operations

Power on/off/restart

In the shutdown state, press and hold the power button for 3 seconds, and the device will automatically turn on;

When turned on, press and hold the power button for 3 seconds to choose to shut down/restart the device.

Connect WiFi

The online translation function of the device requires a network connection to use, and your device can be connected to WiFi or mobile hotspots for a long time. You can add and remove WiFi in [Settings>WiFi].



Shortcut keys

[Handheld translator]

In non translation mode, long press and hold the "return button" for 3S, and it will automatically enter the [handheld translation] function mode. You can press and hold the 'return button' to speak, and releasing it will automatically translate.

[Multi person Meeting]

In non translation mode, double-click the power button, and the system will automatically form a meeting. If it collides with the top of other devices, it will automatically form a multiplayer meeting* Multi person meetings support up to 20 people and 5 languages for multi person communication.

Device charging

Use a standard power adapter and connect the Type-C data cable to charge the device. The device supports charging protocols of 5V1A and 5V2A.

Volume increase/decrease

Click the volume button, and the system will adjust the playback volume of the host by default.

The device interface will display the volume of both the headphones and the device prompt tone, and you can adjust the volume by sliding it on the screen.

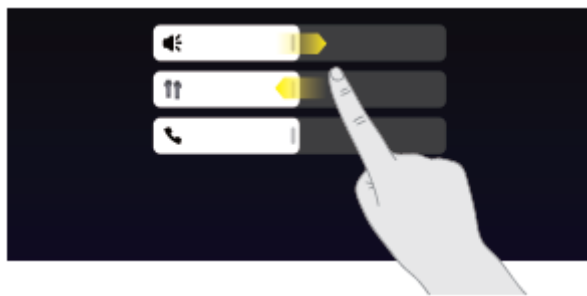

Return to the previous level

Click the return button, and the interface will automatically return to the previous menu level.



Using Headphones

Press the bottom of the device to automatically pop up the earphone compartment. Once the earphones are removed, they can be worn and used normally; After being placed back in the earphone compartment, the earphones will automatically charge and pair with the device host;

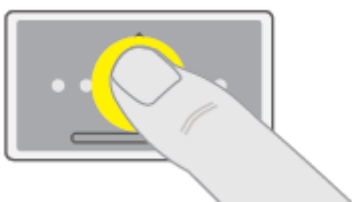

Function Introduction

Two person dialogue

You and the other party each wear one earphone, select the language corresponding to the left/right earphone user (L/R), and click the start button to start a free conversation.

*Attention: Do not choose the wrong language (L/R), as this will result in a serious decrease in translation accuracy or inability to translate.



Audience translation

Please place the microphone of the host closer to the speaker and set the speaker's language and your own language separately. Click [Start] to record and translate in real time, and wear headphones to listen to the translation in real time.



Remote Voice

This function requires communication that both parties hold one X1. You can remember and dial the other party's number, and after connecting, you can have remote voice bilingual simultaneous conversation.



Handheld translation

After entering the handheld translation function, please select the language you and the other person are speaking, and the system will automatically recognize both languages. Press and hold the 'return button' to start speaking to the device. After releasing the 'return button', it will automatically translate and play the sound. Quick entry: In non translation mode, press and hold the "Return" button for 3 seconds, and the system will automatically enter the handheld translation function.



Multi person meeting

This function needs to be used in conjunction with multiple X1 devices. You can create a meeting room, enter a meeting ID, and add the meeting to that room. You can switch your language during the meeting.

Note: To ensure a translation experience for multi person communication, this feature supports up to 5 languages and 20 people communicating online simultaneously.

Quick entry: Touch to quickly form a meeting. Double click the power button, and the device can quickly complete the conference formation by touching other devices.



Translation Settings

Show original text

After turning off [Display Original Text], the original text of the speaker will not be displayed in translation mode, only the translated text will be displayed.

[Translation Voice]

After turning off [Translation Voice], the translated sound will not be played in translation mode. If you cannot hear the translated voice, it is recommended to check

if the function is enabled properly.

[Font size]

You can choose the appropriate translation font size based on your reading habits.

[Pause duration]

You can set appropriate pause intervals based on your speaking speed habits. This will help improve the accuracy of translation.

Frequently Asked Questions

1. Is the translation accuracy not ideal?

Please check if your language and accent are selected correctly and correspond correctly to the language used in the left and right (L/R) earphones;

Please check if your headphones are worn correctly; When recording with the host, the direction of the host microphone should be towards and close to the sound source;

Your speaking voice is too low or used in a noisy environment, which may affect translation accuracy. We suggest that you adjust it according to the situation;

Your speaking speed is too fast or too slow, which may also affect translation accuracy. It is recommended to make adjustments in the translation settings.

2. Unable to use the translation function normally, or severely inaccurate translation?

Please check that the WiFi connected to your device is functioning properly and the network is available.

3. Can't the headphones hear sound?

Please check if the earphones are connected properly. When connected normally, the earphones will have a long green light;

Please check if the earphone volume is normal. After clicking the volume button on the host, you can adjust the earphone volume window on the screen;

Please check if [Translation Voice] is turned on correctly in the translation settings.

4. Can't the headphones connect to the host?

The earphones cannot be turned on without power. Please keep the host in a fully

charged state and return the earphones to the compartment for charging;

The earphones cannot be connected to the host. Please put them back in the earphone compartment and take them out again. The system will pair and connect again.

5. Is the host system stuck?

Restart the device: Long press the power button and select Restart Device.

Force factory reset: Press and hold the power button for 20 seconds, and the system will automatically restore the factory settings.

*Please operate with caution. After restoring the factory settings, all usage data (including translation records) in the device will be cleared.

Specification parameters

Product Name: Simultaneous Interpreter

Product model: Timekettle X1

Product size: 128 * 45 * 30mm

Processor: 4-core ARM 12nm

Storage space: Ram (3G)/Rom (32G)

Operating system: XOS is based on Android

Communication method: BT/2.4G WIFI/5G WIFI

Host specification parameters

Product Name: Simultaneous Interpreter(Host)

Product model: TMK007-01

Product size: 128 * 45 * 30mm

Charging: DC 5V, 1A and DC 5V, 2A (Type-c)

Battery capacity: 3200mAh

Wireless function: Bluetooth 5.0 dual mode (BR+EDR/BLE)/2.4G WIFI/5G WIFI

Frequency range:

2.4G: 2400-2483.5MHz

5.1G: 5150-5350MHz

5.8G: 5725-5850MHz

Occupied bandwidth:

BT1 ≤ 3MHz (MTK)

BT2 ≤ 2MHz (BT8922F2)

2.4 WLAN ≤ 40MHz

5.1 WLAN ≤ 80MHz

5.8 WLAN ≤ 80MHz

Transmitting power:

- BT ≤ 20dBm (EIRP)
- 2.4GHz WLAN ≤ 20dBm (EIRP)
- 5.1GHz WLAN ≤ 23dBm (EIRP)
- 5.8GHz WLAN ≤ 33dBm (EIRP)

Headphone specifications

Product Name: Headset
Product model: TMK007-02
Charging: DC 5V, 2A
Earphone battery capacity: 45mAh
Wireless function: Bluetooth BLE 5.0
Frequency range: 2400-2483.5MHz
Bandwidth occupied: ≤ 3MHz
Transmission power: ≤ 20dBm (EIRP)

Contact us

Enterprise official website: www.timekettle.com
Customer service email: support@timekettle.co
Contact information: (+86) 0755-86725036 (Chinese)
+1 (833) 491-1328 (English/Espanol)
Manufacturer: Shenzhen Spacetime Pot Technology Co., Ltd
Address: Room 612, Building 4, Private Enterprise Science and Technology Park,
Pingshan 1st Road, Nanshan District, Shenzhen, Guangdong Province

Security information

Please read the following safety information before using this product.

1. Do not use unofficial recommended charging methods to avoid fire, explosion, or other hazards;
2. Please avoid dropping, burning, squeezing or immersing the product in liquid to avoid equipment damage;
3. Do not expose the product to high temperatures or around heating equipment such as ovens, microwaves, etc;
4. Please use this product within the range of 0~35C and store it in the range of -20~45 °C. If the temperature is too high or too low, it may cause equipment malfunction;
5. Our company is not responsible for any quality issues, equipment malfunctions, or safety accidents caused by the use of unofficially recognized accessories.

Warranty Card

User Name.....
Purchase location.....
Purchase date.....
Contact number.....

E-mail.....
Mailing Address.....
Zip code.....

Warranty Regulations

1. When purchasing a machine, please keep the purchase evidence and warranty card as proof of warranty.
2. From the date of purchase, if there are quality issues with the product during normal use within one year or six months for accessories, free repair services can be provided with the purchase certificate and warranty card. Products purchased through authorized channels in Chinese Mainland are suitable for the three guarantees policy of the state.
3. Not covered by warranty:
 - A. Normal wear and tear of the machine;
 - B. Damage caused by not following the instructions;
 - C. Damage caused by uncontrollable human factors;
4. For faults caused by human factors, exceeding the warranty period, and uncontrollable factors, we will charge an appropriate repair fee. Please contact us.

*If there are any changes to the above information, please refer to the official website announcement.

FCC Caution.

a、 § 15.19 Labeling requirements.

This device complies with part 15 of the FCC Rules. Operation is subject to the following two conditions:

- (1) This device may not cause harmful interference, and
- (2) this device must accept any interference received, including interference that may cause undesired operation.

b、 § 15.21 Changes or modification warning.

Any Changes or modifications not expressly approved by the party responsible for compliance could void the user's authority to operate the equipment.

c、 § 15.105 Information to the user.

Note: This equipment has been tested and found to comply with the limits for a Class B digital device, pursuant to part 15 of the FCC Rules. These limits are designed to provide reasonable protection against harmful interference in a residential installation. This equipment generates uses and can radiate radio frequency energy and, if not installed and used in accordance with the instructions, may cause harmful interference to radio communications. However, there is no guarantee that interference will not occur in a particular installation. If this equipment does cause harmful interference to radio or television reception, which can be determined by turning the equipment off and on, the user is encouraged to try to correct the interference by one or more of the following measures:

- Reorient or relocate the receiving antenna.
- Increase the separation between the equipment and receiver.

-Connect the equipment into an outlet on a circuit different from that to which the receiver is connected.

-Consult the dealer or an experienced radio/TV technician for help.

d、 Specific Absorption Rate (SAR) information:

This Main unit meets the government's requirements for exposure to radio waves. The guidelines are based on standards that were developed by independent scientific organizations through periodic and thorough evaluation of scientific studies. The standards include a substantial safety margin designed to assure the safety of all persons regardless of age or health.

e、 FCC RF Exposure Information and Statement

The SAR limit of USA (FCC) is 1.6 W/kg averaged over one gram of tissue. Device types: Main unit (FCC ID: 2AQ2G-TMK00701) has also been tested against this SAR limit. The highest SAR value reported under this standard during product certification for properly worn on the body is 0.654W/kg. This device was tested for typical body-worn operations with the back of the handset kept 10mm from the body. To maintain compliance with FCC RF exposure requirements, use accessories that maintain a 10mm separation distance between the user's body and the back of the handset. The use of belt clips, holsters and similar accessories should not contain metallic components in its assembly. The use of accessories that do not satisfy these requirements may not comply with FCC RF exposure requirements, and should be avoided.

Body-worn Operation

This device was tested for typical body-worn operations. To comply with RF exposure requirements, a minimum separation distance of 10mm must be maintained between the user's body and the handset, including the antenna. Third-party belt-clips, holsters, and similar accessories used by this device should not contain any metallic components. Body-worn accessories that do not meet these requirements may not comply with RF exposure requirements and should be avoided. Use only the supplied or an approved antenna.

IC Warning

This device complies with Industry Canada licence-exempt RSS standard(s). Operation is subject to the following two conditions:

- (1) This device may not cause interference, and
- (2) This device must accept any interference, including interference that may cause undesired operation of the device.

RF Exposure Information and Statement

The SAR limit of USA is 1.6 W/kg averaged over one gram of tissue. Device types: Main unit (IC: 26483-TMK00701) has also been tested against this SAR limit. The highest SAR value reported under this standard during product certification for properly worn on the body is 0.654W/kg. This device was tested for typical body-worn operations with the back of the handset kept 10mm from the body. To maintain compliance with IC RF exposure requirements, use accessories that maintain a 10mm separation distance between the user's body and the back of the handset. The use of belt clips, holsters and similar accessories should not contain metallic components in its assembly. The use of accessories that do not satisfy these requirements may not comply with IC RF exposure requirements, and should be avoided.

Body-worn Operation

This device was tested for typical body-worn operations. To comply with RF exposure

requirements, a minimum separation distance of 10mm must be maintained between the user's body and the handset, including the antenna. Third-party belt-clips, holsters, and similar accessories used by this device should not contain any metallic components. Body-worn accessories that do not meet these requirements may not comply with RF exposure requirements and should be avoided. Use only the supplied or an approved antenna.

Le présent appareil est conforme aux CNR d'Industrie Canada applicables aux appareils radio exempts de licence. L'exploitation est autorisée aux deux conditions suivantes:

(1) l'appareil ne doit pas produire de brouillage, et

(2) l'utilisateur de l'appareil doit accepter tout brouillage radioélectrique subi, même si le brouillage est susceptible d'en compromettre le fonctionnement

RF exposition Information et Déclaration

La limite de das aux États - Unis est de 1,6 W / kg, avec une moyenne de 1 gramme de tissu. Type d'appareil: hôte (IC: 26483-TMK00701) a également été testé pour cette limite SAR. Lors de la certification du produit, la valeur SAR la plus élevée rapportée pour un port correct sur le fuselage conformément à cette norme était de 0654 W / kg. L'appareil a été testé pour une utilisation typique du fuselage avec l'arrière du téléphone à une distance de 10 mm du fuselage. Pour rester conforme aux exigences d'exposition aux RF IC, utilisez un accessoire qui maintient une distance de 10 mm entre le corps de l'utilisateur et l'arrière du téléphone. Lorsque vous utilisez des clips de ceinture, des étuis et des accessoires similaires, aucune pièce métallique ne doit être incluse dans leur assemblage. L'utilisation d'accessoires qui ne satisfont pas à ces exigences peut ne pas répondre aux exigences d'exposition aux RF IC et doit être évitée. Porté au corps Opération

Porté au corps Opération

Ce dispositif a été testé pour les opérations typiques portés sur le corps. Pour se conformer aux exigences d'exposition aux radiofréquences, une distance de séparation minimale de 10mm doit être maintenue entre le corps de l'utilisateur et le combiné, y compris l'antenne. Tiers pinces de ceinture, étuis et autres accessoires similaires utilisés par ce dispositif ne doit pas contenir de composants métalliques. accessoires qui ne répondent pas à ces exigences peut ne pas se conformer aux exigences d'exposition RF et doit être évité Body-porté. Utilisez uniquement l'antenne fournie ou une approbation.