

## TWS Bluetooth headset

### User manual

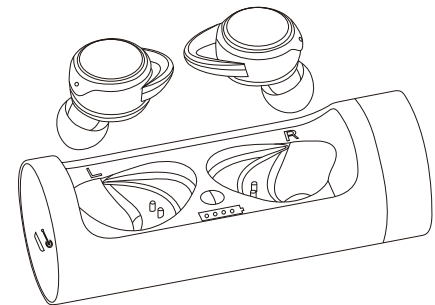

### Compatibility:

This product is compatible with all Bluetooth-enabled mobile phones (iOS/Android/Windows Phone), tablet PCs, smart watches, notebooks and desktop computers.

### Product details:

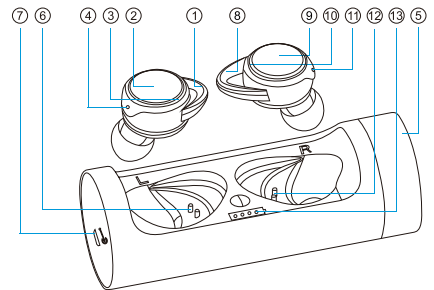

- ① ⑧ Earhook
- ② ⑨ Touch button
- ⑥ ⑫ Charging pins
- ⑦ USB charging port
- ③ ⑩ Status indicator
- ④ ⑪ Microphone
- ⑤ Rotation switch
- ⑬ Battery charge indicator

### Usage:

- 1 Rotate to open the charger case and remove the earphones.

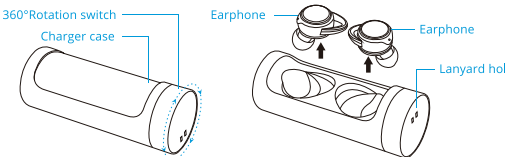

1

- 2 Put on R/L earphones and make it fit securely in your ears.

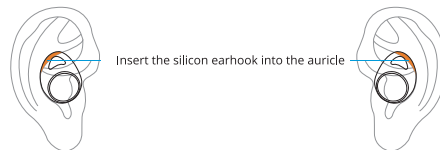

### Powering ON:

**Method 1:** Take out the earphones from the charger case, and they will power on. The left earphone will glow in blue and the red light will flash alternately.

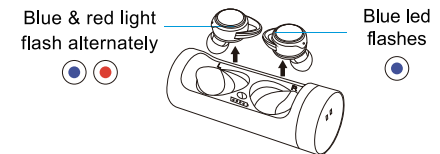

**Method 2:** When the earphones are OFF, touch and hold both earphones for 2 seconds. The LED indicator will flash with a sound prompt: "power on".



2

**Method 2:** The earphones will switch off when put into the charger case.

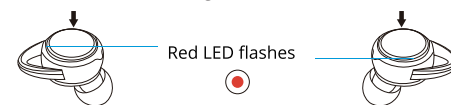

**Note:** Both earphones will be turned off if one of them is switched off via any of the two methods described before.

### Pairing:

- 1 Power on the earphones via any of the methods and wait for the red and blue light to start flashing on the left earphone. If the red and blue light is not flashing it means that they are connected to another master device. In this case, keep the touch button pressed on both earphones for 2 seconds to enter pairing mode.



**Note:** Do not perform a long press at the same time of the power on, otherwise both earphones will be flashing in red and blue. If this happens, place them into the charger case to reset them back to normal operating mode.

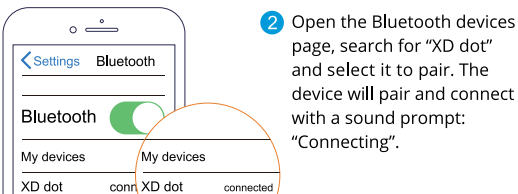

- 2 Open the Bluetooth devices page, search for "XD dot" and select it to pair. The device will pair and connect with a sound prompt: "Connecting".

3

### If both earphones are flashing in red and blue, follow these steps:

- 1 Make sure that both earphones are off, then keep pressed both touch buttons for more than 15 seconds until hearing the sound prompt: "Den Den Den Den" twice.
- 2 Power on both earphones to restart, and pairing mode should return back to normal. The left earphone flashes alternately in blue and red light. The right earphone will flash in blue only.

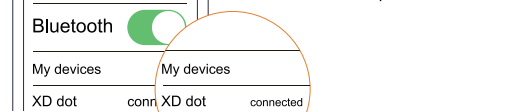
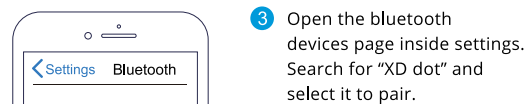
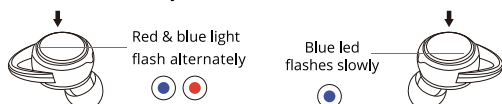

**After the earphones have been paired with the master device (phone, smart watch, laptop, etc.), it will connect everytime automatically after power on. Pairing is only required before the first usage or if earphones were previously paired with a different master device.**

4

### Calling:

- 1 Phone calls can be made or answered when connected successfully. Both earphones work during phone calls.
- 2 When a call comes in, short press one of the touch buttons in order to answer the call or long press it to reject it.
- 3 During a phone call, short press the earphone button to end the call and the earphone will resume its previous working state.
- 4 During a call, the volume can be controlled via the mobile phone.

### Listening to music:

- 1 After a successful connection, simply open any music app to enjoy a fantastic sound.
- 2 In order to play/pause, short press any touch button.
- 3 Long press the left earphone for two seconds to return to the previous song. Long press the right earphone to advance to the next song.
- 4 In order to decrease the volume, double tap the left earphone. To increase the volume double tap the right earphone instead (not possible on some devices).

### Charging:

- 1 Charge the earphone case through the USB cable. When the battery is fully charged the red indicator becomes blue.
- 2 Place the earphones into the charger case, and charging will start automatically. When fully charged the light turns off.
- 3 The earphones will enter stand by mode automatically when put into the charger case.

5

### Indicators description:

Disconnected: Red light flashes slowly.  
Connected: Blue light flashes once every 3-5 seconds.  
Low battery: Red light flashes continuously.  
Pairing: Blue and red light flashes alternately.

### Voice prompts:

Switch on: "Power On"  
Switch off: "Power Off"  
Bluetooth in pairing mode: "Pairing"  
Bluetooth connected: "TWS Connected"  
Bluetooth disconnected: "Disconnected"  
Low battery: "Low Power"  
Automatic switch off: "Power Off"  
Factory settings restoring: "Den Den Den Den"

### Earphones specifications:

Bluetooth version: v5.0.  
Unit weight: 4.9g.  
Battery capacity: 2x3.7V/50mAh.  
Charge time: Around 1 hour.  
Music playback time: 4-5 hours x 4 times.  
Bluetooth profiles supported: FP/AIDP/AVRCP.  
Operating frequency: 2.40-2.48GHz.  
RF Sensitivity: -92dBm.  
Working temperature range: -10-50 °C.  
Maximum transmission range: 10m (with line of sight).

6

### Charger case specifications:

Voltage rating and energy capacity: 3.7V/450mAh.  
Power input: 5V.  
Full charging time: around 2 hours.  
Capacity for recharging the earphones: 3 full charges.  
Size: 33x88mm.  
Weight: 46g.

### Packing list:

Earphones: 2x USB cable: 1x User manual: 1x Sticker: 1x  
Earhooks: 4x Charging case: 1x Earcaps: 6x (S/M/L)

### Important:

- 1 In case of misuse of the earphones or confusion during pairing (e.g. only one earphone is working), please follow the steps on page 4 or put the earphones back into the charger case to reset them back to normal.
- 2 The earphones can be used separately. When each earphone is to be used alone, both must be long pressed until each one is blinking in red and blue. At this point they can be paired separately.
- 3 The left earphone is set as the main one in factory.
- 5 When not connected to any device, the earphones will power off automatically after 5 minutes.
- 6 On iPhones the battery level of the earphones will be displayed in real time.
- 7 When the earphones and the charger case are not used for long periods of time, it is recommended to keep them in a dry place and to recharge them at least every 2 months.
- 8 The waterproof level of the earphones is IPX6, but it is not recommended to submerge them under water or other liquids substances for extended periods.

7

### Warranty card

Warranty period:  
12 months from the date of purchase.

Free of charge service:  
During the warranty period, if there is any breakdown caused by the products's build quality please contact the seller and provide this warranty card together with the sales invoice. The product will be repaired or replaced by a new one.

The warranty does not apply under the following circumstances:

1. The product label is broken.
2. Damage caused due to the product being disassembled by a non-authorized repair agent.
3. Damage caused by external force or when there is visible deformation of any of the external parts.
4. The product has been improperly used or stored.
5. Damage or breakdown caused by force majeure.

Customer service information:

Customer Name	
Customer Phone	
Customer Address	
Model Number	
Purchase Date	
Dealer	
Invoice number	

8

NOTE: This equipment has been tested and found to comply with the limits for a Class B digital device, pursuant to part 15 of the FCC Rules. These limits are designed to provide reasonable protection against harmful interference in a residential installation. This equipment generates uses and can radiate radio frequency energy and, if not installed and used in accordance with the instructions, may cause harmful interference to radio communications. However, there is no guarantee that interference will not occur in a particular installation. If this equipment does cause harmful interference to radio or television reception, which can be determined by turning the equipment off and on, the user is encouraged to try to correct the interference by one or more of the following measures:

- Reorient or relocate the receiving antenna.
- Increase the separation between the equipment and receiver.
- Connect the equipment into an outlet on a circuit different from that to which the receiver is connected.
- Consult the dealer or an experienced radio/TV technician for help

Changes or modifications not expressly approved by the party responsible for compliance

could void the user's authority to operate the equipment.

This device complies with Part 15 of the FCC Rules. Operation is subject to the following two conditions:

- (1) this device may not cause harmful interference, and
- (2) this device must accept any interference received, including interference that may cause undesired operation.