

Use and Care Guide

2-Pack Connected Solar Deck Lights

TOOLS REQUIRED



Phillips screwdriver

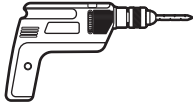

Electric drill

HARDWARE INCLUDED

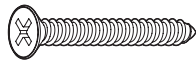

AA - Wood Screw x 4

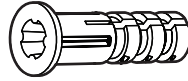

BB - Plastic Anchor x 4



CC - Template x 1

Installation



NOTE: The solar light is equipped with a photosensor that turns the unit on at dusk and off at dawn. Ambient light can affect the operation of the photosensor.



IMPORTANT: Prior to use, set the ON/OFF switch located on the back plate of the solar light to the ON position and allow it to charge for a full sunny day.



IMPORTANT: Ensure the mounting location for your solar light allows the solar panel to receive direct sunlight. Do not locate the product in shaded areas as this will significantly reduce performance.

1 WOOD POST/FENCE MOUNTING

- To mount the solar light to a wood post or fence, use the template (CC) to mark the mounting screw locations. Alternatively, measure and mark the installation locations for the mounting screws 3.86 in. (98 mm) on-center.
- Insert the mounting screws (AA) into the wood post or fence at the marked locations, leaving about 1/4 in. of the screws (AA) sticking out of the wood surface.
- Align and place the two mounting holes on the back plate of the solar light over the mounting screws (AA).

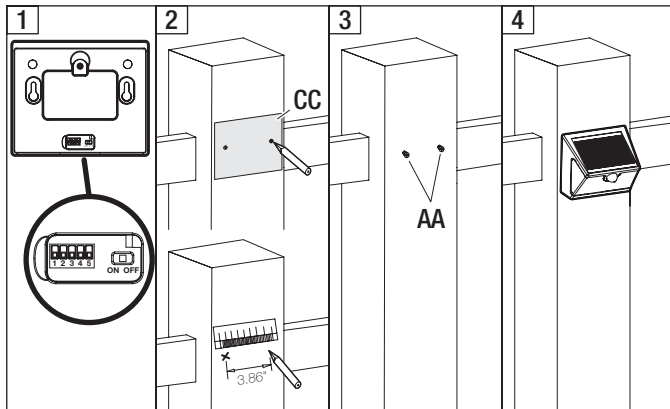

2 WALL MOUNTING

- To mount the solar light to a concrete or brick wall, use the template (CC) to mark the mounting screw locations. Alternatively, measure and mark the installation locations for the mounting screws 3.86 in. (98 mm) on-center.
- Drill two holes on the wall at the marked locations.
- Insert the plastic anchors (BB) into the holes. Insert the mounting screws (AA) into the anchors (BB), leaving about 1/4 in. of the screws (AA) sticking out of the wall surface.
- Align and place the two mounting holes on the back plate of the solar light over the mounting screws (AA).

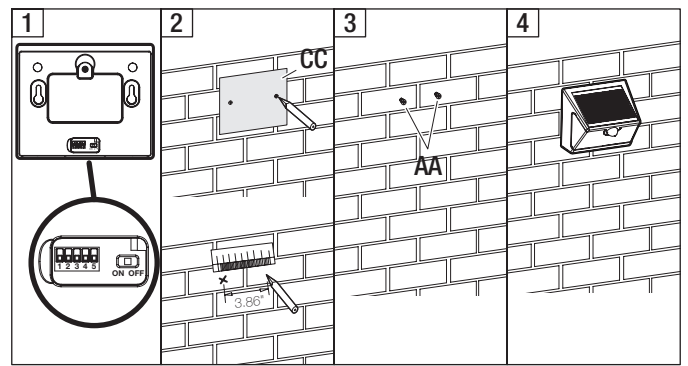

Synchronizing, Turning ON, and Testing the Deck Lights

These two deck lights come with the Device Address switch (1) preset to be synched upon initial use. When one light detects motion, both lights turn on.

To connect additional lights to this set, ensure the Device Address switches (1) are all set to the same setting.

To turn the lights ON, set the Power switches (2) to the ON position.

When turned ON, the lights will begin a 30 second TEST mode, where they will light-up for 5 seconds when motion is detected (regardless of time of day). After the 30 seconds, the lights will enter normal operation and only light-up when motion is detected.

In normal operation, when motion is detected, the lights will activate simultaneously, and stay on for 30 seconds.

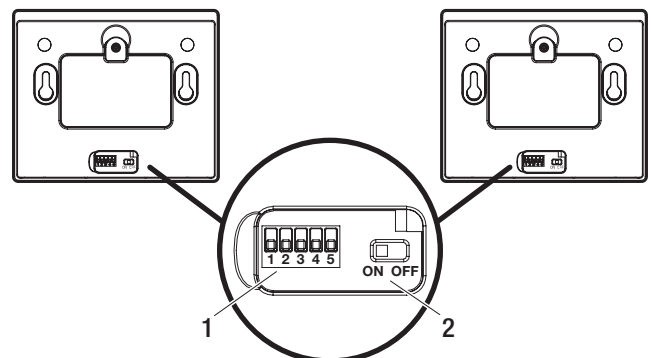

Safety Information

FCC STATEMENT

NOTE: This equipment has been tested and found to comply with the limits for a Class B digital device, pursuant to part 15 of the FCC Rules. These limits are designed to provide reasonable protection against harmful interference in a residential installation. This equipment generates uses and can radiate radio frequency energy and, if not installed and used in accordance with the instructions, may cause harmful interference to radio communications. However, there is no guarantee that interference will not occur in a particular installation. If this equipment does cause harmful interference to radio or television reception, which can be determined by turning the equipment off and on, the user is encouraged to try to correct the interference by one or more of the following measures:

- Reorient or relocate the receiving antenna.
- Increase the separation between the equipment and receiver.
- Connect the equipment into an outlet on a circuit different from that to which the receiver is connected.
- Consult the dealer or an experienced radio/TV technician for help.

Changes or modifications not expressly approved by the party responsible for compliance could void the user's authority to operate the equipment. This device complies with Part 15 of the FCC Rules. Operation is subject to the following two conditions: (1) this device may not cause harmful interference, and (2) this device must accept any interference received, including interference that may cause undesired operation.

 **WARNING:** Your solar light may not function in temperatures below -14°F (-10°C) or above 122°F (50°C).

 **CAUTION:** Use rechargeable batteries only. Recycle or dispose of batteries properly.

 **CAUTION:** Do not open, short circuit, or mutilate batteries as injury may occur.

Troubleshooting

Problem	Possible Cause	Solution
The nightly run time is shorter.	The batteries are not fully charged.	Ensure the solar light is located in an area where it can receive the maximum amount of full, direct sunlight every day. Keeping the solar panel clean is equally important to ensure the maximum charging performance.
	The batteries are reaching the end of their useful life.	Replace the old batteries with Nickel Metal Hydride rechargeable batteries.
The solar light does not turn on at night.	Your solar light is equipped with an ON/OFF switch on the back plate of the light. This switch must be set to ON prior to use.	Prior to use, check that the unit has been set to the ON position and allowed to charge a full sunny day.
	The solar light is installed close to other light sources, which may keep the solar light from turning on at night automatically.	Relocate the fixture or eliminate other light sources.

Maintenance

REPLACING THE BATTERY



NOTE: Use three AA size, 1000mAh, 1.2V Nickel Metal Hydride rechargeable batteries. For best performance, replace with Nickel Metal Hydride rechargeable batteries annually.



IMPORTANT: Dispose of the batteries in accordance with local, state, and federal regulations.



IMPORTANT: When storing any solar product for an extended period of time, remove the batteries. Storing any solar product without regular recharge or removal of batteries could cause permanent damage to the rechargeable batteries.

- Unscrew the battery cover (C) from the back of the solar light (A) and remove it.
- Remove the old batteries (B). Replace with three new Nickel Metal Hydride rechargeable batteries – The recommended replacement battery capacity should be 1000mAh.
- Replace the battery cover (C).

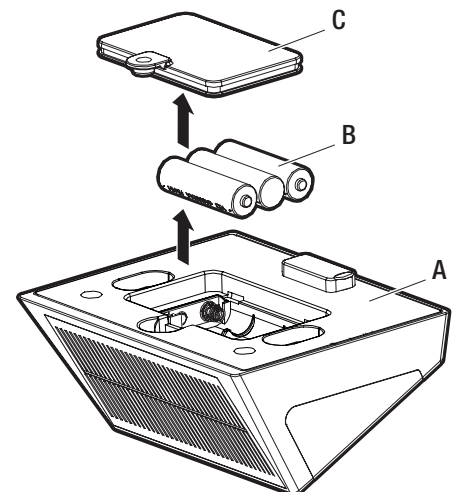

Care and Cleaning

- The solar panel should be cleaned periodically with a damp cloth to help maintain optimum performance.
- Do not use any cleaners with chemicals, solvents, or harsh abrasives.

Warranty

TWO YEAR LIMITED WARRANTY

WHAT IS COVERED

The manufacturer warrants this product to be free of defects in material and workmanship for a period of two (2) years from the date of purchase. This warranty only applies to the original consumer purchaser and only to products used in normal use and service. The manufacturer's only obligation and your exclusive remedy, is the repair or replacement of the product at the manufacturer's discretion, provided that the product has not been damaged through misuse, abuse, accident, modification, alteration, neglect, or mishandling. Proof of purchase and evidence of manufacturer's date coding must accompany all warranty claims. Manufacturer's date coding is printed and adhered to each product.

WHAT IS NOT COVERED

This warranty does not apply to products that are found to have been improperly installed, set-up, or used in any way not in accordance with the instructions supplied with the product. This warranty does not apply to a failure of the product as a result of an accident, misuse, abuse, negligence, alteration, or faulty installation. Batteries supplied with this product are not included in this warranty. This warranty shall not apply to the finish on any portion of the product, such as surface and/or weathering, as this is considered normal wear and tear. The manufacturer does not warrant and specially disclaims any warranty, whether express or implied, of fitness for a particular purpose, other than the warranty contained herein. This warranty does not cover consequential or incidental loss or damage, including but not limited to any labor/expense costs involved in the replacement or repair of the product.

Contact the Customer Service Team at 1-800-841-1350 or visit HAMPTONBAY.com.