

FCC RF RADIATION EXPOSURE STATEMENT: This equipment complies with FCC radiation exposure limits set forth for an uncontrolled environment. This equipment should be installed and operated with a minimum distance of 20cm between the radiator and any part of your body.

TROUBLESHOOTING

Table with 3 columns: PROBLEM, POSSIBLE CAUSE, SOLUTION. Issues include Game Console not turning on, Control Deck not turning on, Game will turn ON but no sound, Game screen is frozen, One of the buttons on the Control Deck is stuck, etc.

COLLECT THEM ALL



visit Arcade1up.com TO SIGN UP FOR OUR MAILING LIST AND SEE A COMPLETE LIST OF GAMES

visit us at ARCADE1UP.COM TASTEMAKERS, L.L.C. 347 Fifth Avenue, Suite 1402-199, New York, NY 10016 MADE IN CHINA REV 11.11.21

COUCH CADE WIRELESS GAMING

- INCLUDES: • Wireless Control Deck • Game Console • HDMI Cable • Micro USB Power Cable



WARNING To ensure safe operation of the product, be sure to read this Owners Manual before use. Keep this Owners Manual in a safe place for easy reference when needed.

AGES 14+ OWNERS MANUAL

CONTROL DECK SET UP

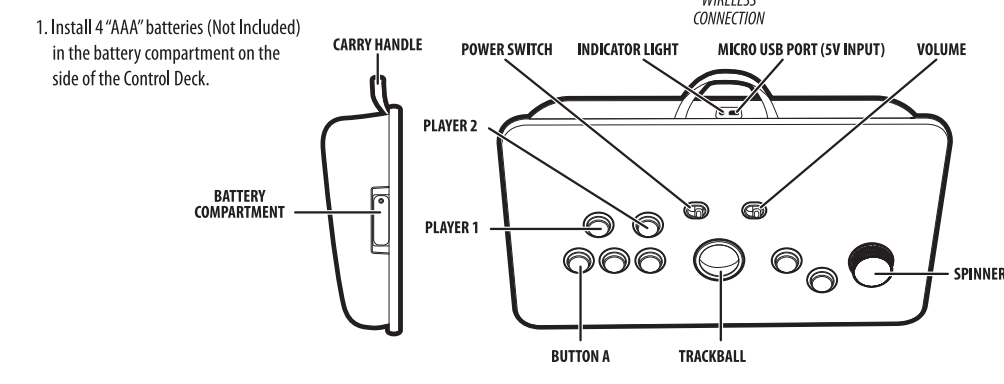

- 1. Install 4 "AAA" batteries (Not Included) in the battery compartment on the side of the Control Deck.
- 2. REMOVE BATTERY BOX COVER BY PHILLIPS HEAD SCREWDRIVER
- 3. INSERT 4 AAA ALKALINE BATTERIES IN THE BATTERY BOX AS ILLUSTRATED MAKING CERTAIN THAT NEGATIVE (-) AND POSITIVE (+) POLES ARE POSITIONED PROPERLY
- 4. REPLACE BATTERY BOX COVER - BE SURE NOT TO OVER-TIGHTEN THE SCREW

WARNING - BATTERY-OPERATED BATTERY SAFETY NOTICE 1. Non-rechargeable batteries are not to be recharged. 2. Rechargeable batteries are to be removed from the device before being charged (if removable).

CONNECTING GAME CONSOLE TO TV

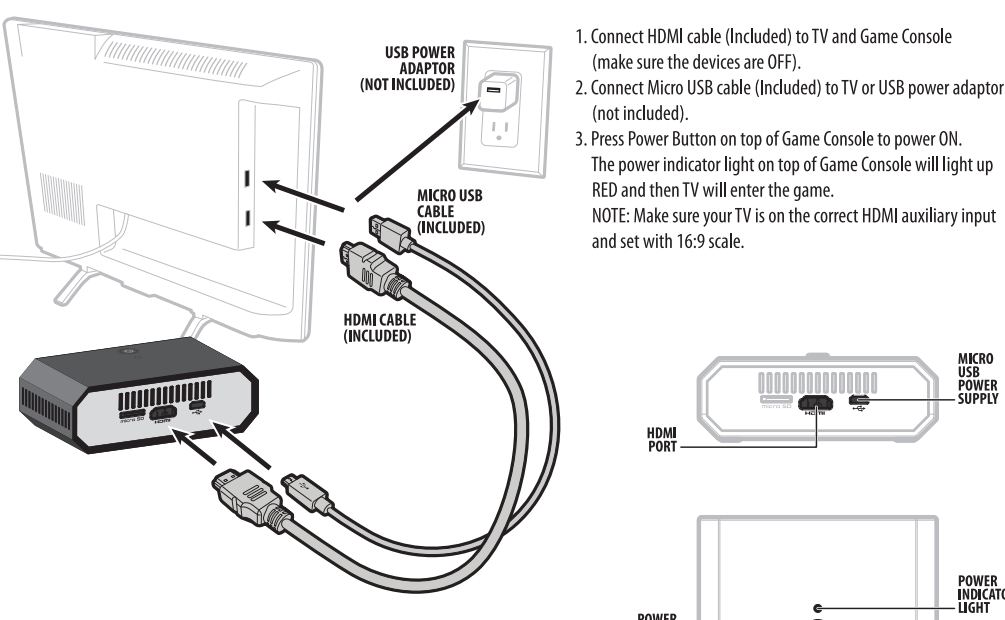

This device contains licence-exempt transmitter(s)/receiver(s) that comply with Innovation, Science and Economic Development Canada's licence-exempt RSS(s). Operation is subject to the following two conditions:

FCC/ISED STATEMENT This device complies with part 15 of the FCC rules / Innovation, Science and Economic Development Canada's licence-exempt RSS(s). Operation is subject to the following two conditions:

EPILEPSY WARNING A very small percentage of individuals may experience epileptic seizures or blackouts when exposed to certain light patterns or flashing lights.

PAIRING YOUR CONTROL DECK TO GAME CONSOLE

- 1. Turn ON the power switch on the Control Deck.
- 2. Press Power Button on top of Game Console to power ON. The power indicator light on top of Game Console will light up RED and then TV will enter the game.

LED LIGHT INDICATION

Table with 3 columns: LED Light, Game Console, Control Deck. Rows include Solid Light Up, Slow Flashing, Fast Flashing, and Light Off.

Pairing Mode: If Game Console & Control Deck cannot be paired, please hold Player 1 & 2 buttons at the same time then turn ON the power switch of Control Deck.

ASSISTANCE OR SERVICE

If you have questions regarding your Arcade1up product or require technical support, contact Arcade1up Customer Service at www.Arcade1up.com and click on "Support".

CAUTION Servicing instructions are for use by qualified service personnel only. To reduce the risk of electric shock, do not perform any servicing other than that contained in the operating instructions unless you are qualified to do so.

GAME CONTROLS

- *ARCADE MAY TAKE 10-15 SECONDS TO POWER ON AFTER SWITCHING ON
- 1. ROLL TRACKBALL UP AND DOWN TO SCROLL THROUGH GAME LIST
- 2. PRESS A BUTTON TO CHOOSE GAME
- 3. FOLLOW GAME CONTROLS BELOW FOR EACH GAME
- 4. HOLD PLAYER 1 (5 SECONDS) TO RETURN TO MENU AND TO SAVE A HIGH SCORE
- 5. HOLD PLAYER 2 (5 SECONDS) TO RESET GAME

