



1. Add device

1.1. Download 4NBSU-JGf11



Please scan the QR Code, or get Smart Life downloaded from App Store or Android Market.

1.2. Register an account in 4NBSU-JGf

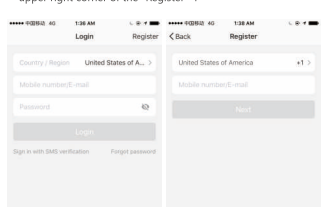

1.3. Add devices(for example, Smart Bulb)

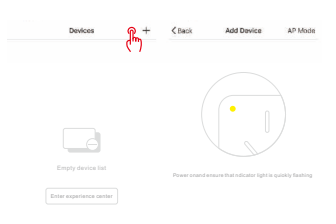

- Smart LifeAPP supports two types of distribution network modes: EZ mode and AP mode. EZ mode is default.
- EZ Mode: The indicator light flashes rapidly (two times a second).
- AP Mode: The indicator light flash slowly.

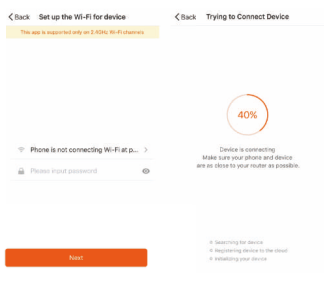

- Select the WiFi you are using and input the password. Click "next" to connect the device.

1.4. Rename the device

After the device is added successfully, click the device description text to modify device name. The name of the device is recommended to use easy pronunciation of the English words. (Amazon Echo only supports English temporarily)

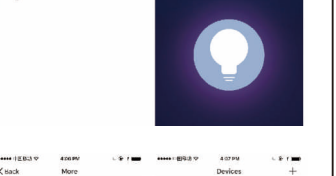

Multiple devices can be added and renamed according to the above procedures.

2. Enable 4NBSU-JGf in Alexa APP

Choose "Smart" in the option bar, and then search "Smart Life" in the input box.

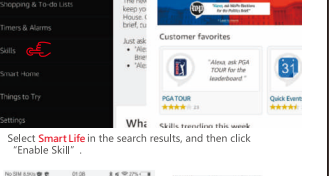

Then input the user name and password that you had previously registered. Only support the account in the United States.

3. Control Smart Bulb by Voice

After the above operation is successful, you can control the bulb via Echo.

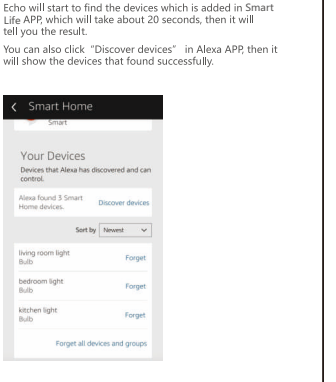

3.2. Control devices by voice

Attention: The name of the device must be consistent with the addition of Smart Life app.

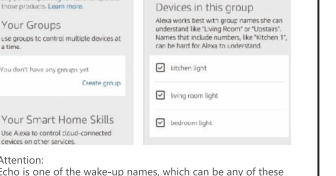

- You can control devices by instructions like these:
 - Alexa echo, turn on [bedroom light]
 - Alexa echo, turn off [bedroom light]
 - Alexa echo, set [bedroom light] to 50 percent
 - Alexa echo, increase [bedroom light] to 50 percent
 - Alexa echo, decrease [bedroom light] to 50 percent
 - Alexa echo, set [smart heater] to 34
 - Alexa echo, raise [smart heater] by 4
 - Alexa echo, lower [smart heater] by 2

4. Bluetooth function operation instructions

4.1. Please connect the bulb to the power,

turn on-off-on-off-on and then the bulb will flash and enter the state and network match.

4.2.

Connect the phone to wifi and turn on the Bluetooth, ensure that the phone network is smooth

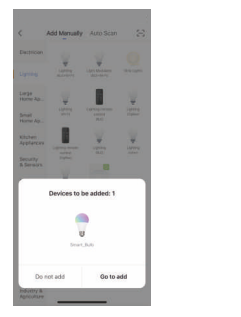

4.3.

After opening and logging in to the "SmartLife" APP "click" the "Add" button, the dual-mode bulb lamp will automatically pop up the connection window, click "Connect", after it is successful, the smart control can be realized, and the smart bulb lamp can be controlled through the mobile phone APP.

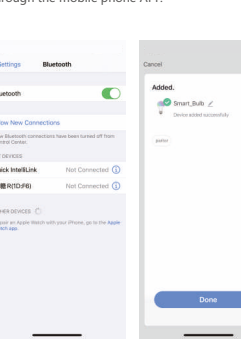

4.4.

After opening and logging in to the "SmartLife" APP, click the "Add" button, the dual-mode bulb lamp will automatically pop up the connection window, click "Connect", after it is successful, the smart control can be realized, and the smart bulb lamp can be controlled through the mobile phone APP.

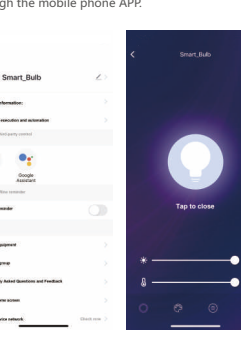

FCC Warning: This device complies with part 15 of the FCC rules. Operation is subject to the following two conditions: (1) this device may not cause harmful interference, and (2) if this device does cause interference, you must stop using it immediately.

Changes or modifications not approved by the party responsible for compliance could void the user's authority to operate this equipment.

NOTE: This equipment may generate and be affected by radio frequency interference. It is recommended that you use a Class B digital device, as permitted by part 15 of the FCC rules. These devices are designed to provide reasonable protection against harmful interference to nearby electronic equipment. This equipment generates, uses, and can be affected by radio frequency interference. However, there is no guarantee that interference will not occur in certain situations. If you experience any interference, you may wish to take the following steps: (1) reorient or relocate the receiving antenna; (2) increase the distance between the equipment and the receiving antenna; (3) consult the manufacturer of the receiving antenna for suggestions; (4) consult the manufacturer of the equipment for suggestions.

Copyright © 2018 NBSU. All rights reserved. This equipment is not intended for use in a controlled environment. Contact the manufacturer for more information.

Bluetooth: Bluetooth is an international radio frequency technology. The equipment complies with FCC radio frequency rules for safe use of unlicensed frequencies. The equipment should be installed and operated at minimum distance 20cm between the antenna and your body.