



Model: JM-II

Wireless Remote Controller

Product User Manual



Thank you for purchasing **JJC JM-II series** wireless remote controller. For the best performance, please read this instruction carefully before using. You must read it thoroughly and fully understand this manual to avoid improper operation which may result in damage to the product.

JJC JM-II Series Radio Frequency Wireless Shutter is designed for most DSLR and SLR cameras that have a remote socket on the camera body. The system works at 433MHZ frequency and has 16 available channels. What's more, this wireless remote system adopts a technology to allow the transmitter to trigger the receiver without direct line of sight up to 30 meters. The JM-II receiver simply attaches to a compatible camera's accessory shoe, and then just connect the supplied JJC receiver cable to the camera's remote socket. The receiver is powered by one piece of CR-2 lithium battery while the transmitter is powered by one piece of 23A battery. JM-II transmitter can trigger the camera shutter at five modes: single shot, 5 seconds delay shot, 3 continuous shots, unlimited continuous shots and bulb shot. The receiver has a 1/4"-20 tripod mount socket on the bottom, so you can even mount the receiver onto a tripod. Most importantly, our JM-II transmitter is able to fire multiple receivers at the same time. All these features make it good for eliminating camera shake in long exposure photography.

Package Contains



- JM II transmitter x 1
- JM II receiver x 1
- CR-2 battery x 1
- 23A battery x 1
- Connecting cord x 1
- This manual instruction x 1

Features

JM Receiver:

- Battery type: CR-2 3V lithium battery × 1
- Operating temperature: 5 °C to 40 °C (40 °F to 105 °F)
- Net weight : Approx. 19g
- Dimensions: 48 × 38 × 29mm

JM Transmitter:

- Battery type: 23A 12V battery × 1
- Operating temperature: 5 °C to 40 °C (40 °F to 105 °F)
- Net weight : Approx. 18g
- Dimensions: 82 × 27 × 14.7mm

Identifying the Transmitter and Receiver

● Transmitter



● Receiver

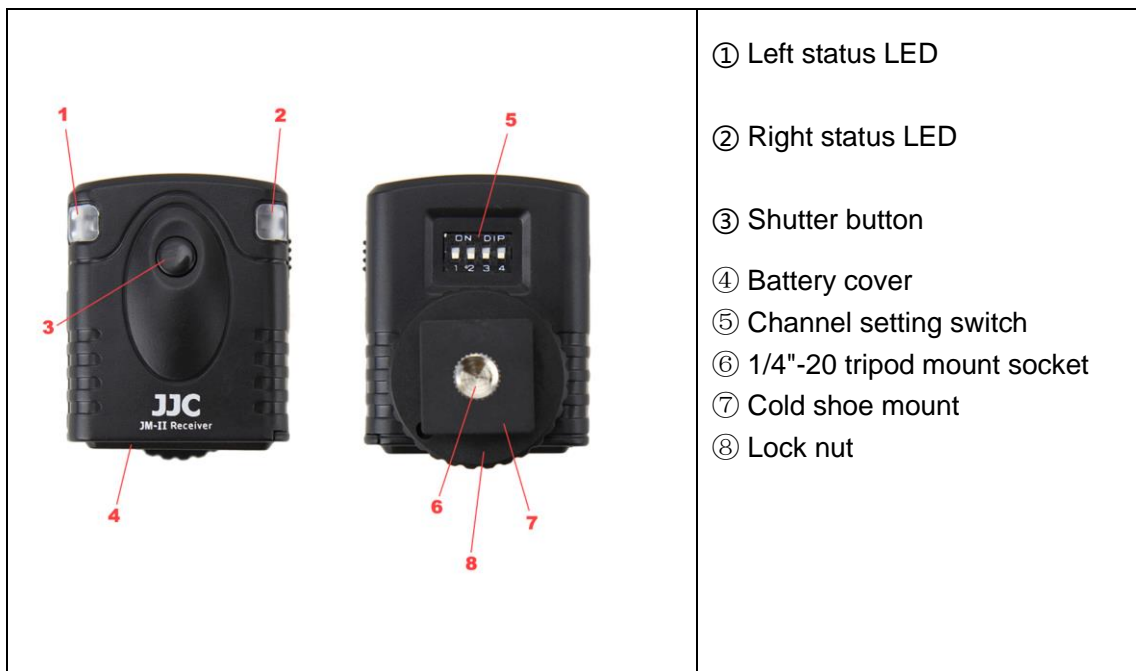



Replace Batteries

1. Tear off the plastic protector of the batteries if your batteries have. Then just slide to remove the covers toward the direction of the arrow sign on the battery covers .



2. Insert the fresh battery, please ensure the batteries are put into a correct direction. Do not install batteries in the reverse direction as this could cause the batteries to leak corrosive liquids, generate heat or explode.



3. Put the battery covers back toward the opposite direction of the arrow sign on the battery covers.



Attaching the Set to a Camera

1. Turn OFF the camera before attaching the receiver to camera.
2. Please make sure the transmitter and receiver are at the same code setting. There are 16 channels available.

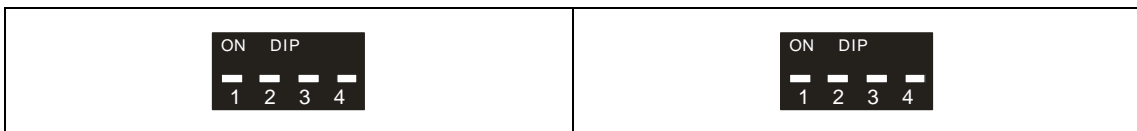

3. Slide the receiver gently into your camera hot shoe as the picture shown below. Then rotate the hot shoe lock nut clockwise to tight the receiver on your camera hot shoe.



4. Plug the end of the connecting cord as the picture shown left into the receiver, then plug the other end to the camera remote socket (the appearance of this end for different cameras may vary).





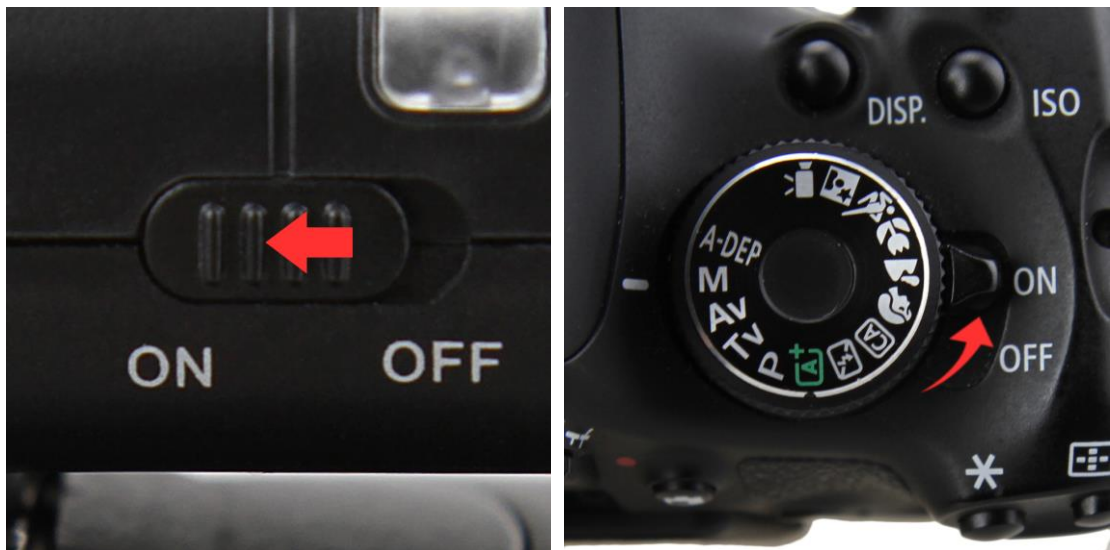

Note: Please remember not to connect the cable round the wrong way. For any JJC connecting cord, please always keep in mind that the end as the picture shown left should be plugged to receiver while the other end is for the camera remote socket.

5. Turn ON the receiver and the camera.



Using the JM-II to Take Photos in 5 Modes

Transmitter Mode Dial	Function	Camera Drive Mode
	Single shot	 Single shooting
	Unlimited continuous shots	 Continuous shots
	Wireless bulb	Manual Mode Shutter Speed: BULB

	5s Delay shot	 Single shooting
	3 continuous shots	 Single shooting

- **Single shot**

1. Shift mode dial to single shot section while select the camera to single shot mode. Half press the shutter button of transmitter to focus.



2. Then fully press the shutter button, the camera will take a picture instantly.



- **Unlimited continuous shots**

1. Shift mode dial to single shot section while select the camera to continuous shot mode. Half press the shutter button of transmitter to focus.



2. Then fully press while holding the shutter button of transmitter until the transmitter LED light OFF, and the receiver will now lock the shutter for continuous shot.



3. To release the shutter lock, press the shutter button of the transmitter again, and the receiver will unlock the shutter. Then you will get plenty of pictures.



- **Bulb shutter function**

1. Shift the mode dial of the transmitter to single shot section while select the camera to BULB mode. Half press the shutter button of transmitter to focus.



2. Then fully press while holding the shutter button of transmitter until the transmitter LED light OFF, and the receiver will now lock the shutter for BULB.



3. To release the shutter lock, press the shutter button of the transmitter again, and the receiver will unlock the shutter. Then you will get a long exposure photo as the picture shown below.



- **5S Delay shot**

1. Shift the mode dial of the transmitter to delay shot section while select the camera to single shot mode. Half press the shutter button of transmitter to focus.



2. Then fully press the shutter button, and the camera will take a picture after 5 seconds count down. You will get a delay shot photo.



- **3 continuous shots**

1. Shift the mode dial of the transmitter to 3 continuous shot section while select the camera to single shot mode. Half press the shutter button of transmitter to focus.



2. Then fully press the shutter button, and the camera will continuously take 3 pictures at an interval of 1s.



In addition, our JM-II transmitter is designed to trigger multiple JM-II receivers at the same time. This is perfect for those who own several cameras.



Use the Receiver as a Wired Remote Switch

The receiver is designed to be used as a shutter release button. Half press to focus, and fully press to take a photo.



- All specifications above are based on JJC's testing standards.
- Product specifications and external appearance are subject to change without notice.

ONE YEAR GUARANTEE

If for quality factor, this JJC product fails within ONE YEAR of the date of purchase, return this product to your JJC dealer or contact service@jic.cc and it will be exchanged for you at no charge (not including shipping cost). JJC products are guaranteed for ONE FULL YEAR against defects in workmanship and materials. If at any time after one year, your JJC product fails under normal use, we invite you to return it to JJC for evaluation.

About trademark

- JJC is a trademark of JJC Company

Shenzhen JinJiaCheng Photography Equipment Co., Ltd.
Office TEL: +86 755 82369905

Website: www.jjc.cc

Email: sales@jjc.cc / service@jjc.cc

Address: RM1305 East Block, Tian'an High-Tech Plaza Phase II, Tian'an Cyber Park, Futian District, Shenzhen, Guangdong, China

FCC Statement

This equipment has been tested and found to comply with the limits for a Class B digital device, pursuant to part 15 of the FCC Rules. These limits are designed to provide reasonable protection against harmful interference in a residential installation. This equipment generates, uses and can radiate radio frequency energy and, if not installed and used in accordance with the instructions, may cause harmful interference to radio communications. However, there is no guarantee that interference will not occur in a particular installation. If this equipment does cause harmful interference to radio or television reception, which can be determined by turning the equipment off and on, the user is encouraged to try to correct the interference by one or more of the following measures:

- Reorient or relocate the receiving antenna.
- Increase the separation between the equipment and receiver.
- Connect the equipment into an outlet on a circuit different from that to which the receiver is connected.
- Consult the dealer or an experienced radio/TV technician for help.

Caution: Any changes or modifications to this device not explicitly approved by manufacturer could void your authority to operate this equipment.

This device complies with part 15 of the FCC Rules. Operation is subject to the following two conditions: (1) This device may not cause harmful interference, and (2) this device must accept any interference received, including interference that may cause undesired operation.

RF Exposure Information

The device has been evaluated to meet general RF exposure requirement. The device can be used in portable exposure condition without restriction.