

Exway Wave Hub/Riot User Manual

Riot

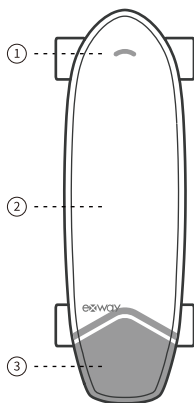

Hub

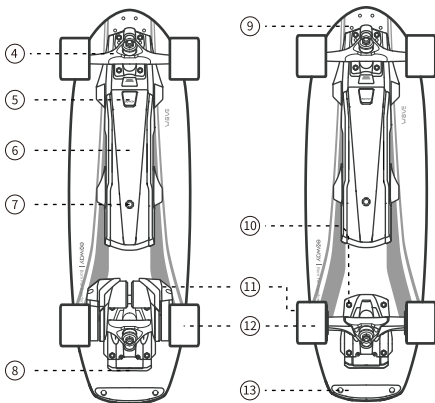

- ① Front of the Board
- ② Grip Tape
- ③ Kicktail
- ④ Truck
- ⑤ Charging Port
- ⑥ Battery
- ⑦ Status Indicator/Power Button
- ⑧ Taillight
- ⑨ Front light Auxiliary Port
- ⑩ Motor Controller (ESC)
- ⑪ Brushless Motors
- ⑫ Rear Drive Wheel
- ⑬ Tail Puck

Top Speed: 23mph / 38kph

Hill Climbing: Up to 25% Grade

Range: 15miles / 24km

(Actual data varies depending on rider weight and riding conditions.)

Weight: Riot 7.3kg / Hub 6.9kg

Torque: Riot 4.3Nm×2 / Hub 3.8Nm×2

Max. Power: 1000W×2

Rated Motor Power: 430W×2

Max Amperage: 4A

Input Voltage: 100-240VAC,50 / 60Hz

Battery Capacity: 216Wh

Charging Time: 3.5 hours (1h30mins with the fast charger)

Trucks: Exway Trist 45° 7"

Brakes: Regenerative Braking

Recommended Age Range: 16-50 Years

Max Load: 100kg / 220lbs

Waterproof Level: IP53

Battery Swap:

② Slide Battery Forward to Install

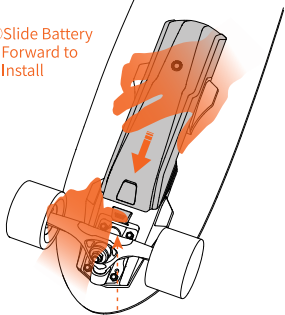

② Slide Battery Backward to Remove

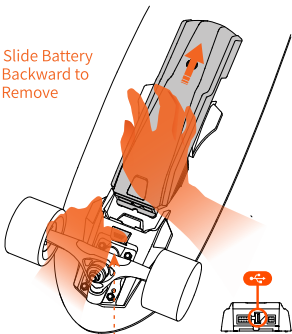

① Press and Hold Down the Battery Release Button

The battery is also equipped with a USB port with 5V-2.1A to charge your devices like remote/ cell phone.

Battery Installation: Align both the ports from the battery and deck. Slide the battery into place, ensuring that it's securely mounted. (Otherwise, it may fall out while riding and cause danger or injury)

Battery Removal: Press and hold down the battery release button, meanwhile slide the battery towards the rear truck to lift it away from the board.

Install the front lights

Install the lights on the front of the board and ensure that the four screws are fully tightened. Turn on the board and then double tap the multi-button on the remote to switch on the lights.

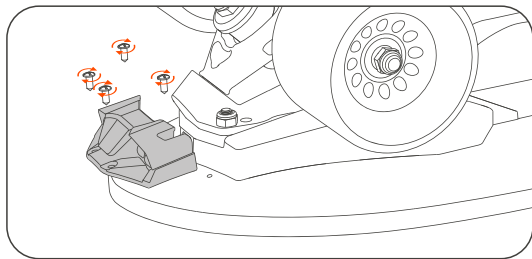

Operations & The state of the indicator lights:



Show the Remaining Battery

Single tap while the board is powered off.



Charging

Light flashes continuously.



Power On

Long press for 2 seconds.



Pairing Mode

Long press for 8 seconds while the board is powered off.



Power Off

Long press for 3 seconds while the board is turned on.



Brick Recovery/ Firmware Upgrade Mode

Fast tap 7 times while the board is powered off.

CAUTION:

1. When the skateboard battery has 5% left, the power output will be cut off to better protect the battery. (In free mode, both the power output and brakes will be restricted)
2. Connect the charger to the power button on the board before plugging into the wall outlet. (Only use an original Exway Wave charger)

BY THE WAY:

1. The board will charge for around 3.5h with the standard charger. The indicator on the charger will turn green when the battery is full.
2. This version of the user manual may not be updated, check out the Exway App or www.exwayboard.com to read the most up-to-date version.

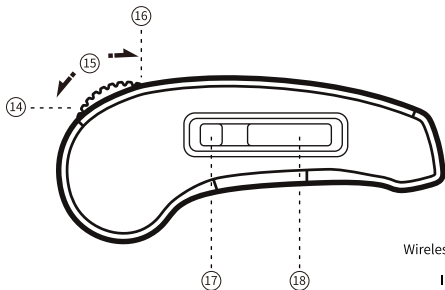

⑭ Acceleration (roll the throttle forward)

⑮ Throttle Wheel

⑯ Breaking (roll the throttle back)

⑰ Multi-Button

⑱ OLED screen

Screen : OLED 0.9"

Wireless Frequency : 2.4GHz

Input Voltage : 5V  1A

Remote Control Operation:



Switch Off (Standby Mode)

Press the Multi-Button for 3 seconds.



Switch Gears

Short press the Multi-Button.

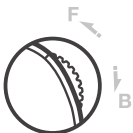

Accelerate/Break

Roll the throttle wheel forward/back.



Change Direction

Triple-tap the Multi-Button.



Turn on/off the Headlight

Double-tap the Multi-Button.

Pairing Remote to Board:



Pairing Mode

Completely turn off the board and long press 8 sec on the board to turn on pair mode.



Setting Mode

Long press the Multi-Button on the remote for 5 seconds to get into setting mode.



Choose the first option “Re-Pair” by tapping on the Multi- Button.



Choose your board and click “YES”.

Remote Control Calibration



Push the roller forward to the bottom without letting go, press multi-button to Confirm.



Calibrate the neutral position, release the roller to make it free, press multi-button to confirm.



Press multi-button to confirm when calibration is completed and the calibration interface is automatically exited.

WARNINGS



LOW TEMPERATURE

LOW TEMPERATURE

Temperature is below 0°C (Caution frost).



BATTERY(55°)

BATTERY TEMPERATURE WARNING

Battery temperature is over 55°C



ESC OVERHEAT

ESC HIGH TEMPERATURE WARNING



ESC OVERHEAT

ESC OVERHEATING WARNING

ESC temperature is over 120°C.

(Stop using your board immediately to allow it to cool)



MOTOR OVERHEAT

MOTOR HIGH TEMPERATURE WARNING

Motor temperature is over 100°C.



MOTOR OVERHEAT

MOTOR OVERHEATING WARNING

Motor temperature is over 120°C. (Stop using your board immediately allow it to cool)



MOTOR BREAKDOWN

MOTOR BREAKDOWN

Motor Seizing



HIGH VOLTAGE (I)

HIGH VOLTAGE (I)

Voltage is too high



HIGH VOLTAGE (II)

HIGH VOLTAGE (II)

Voltage is too high (Danger risk ! Discharge it Before use)



LOW TEMPERATURE

Low Charge temperature



BATTERY OVERHEAT

Battery is overheating while charging.



REMOTE DISCONNECTED

Remote is not connected to board.



BMS ERROR

BMS error or connection issue at battery communication port.

In the box:



①



②



③



④



⑤



⑥



⑦

- ① Exway Wave
- ② Remote
- ③ Standard charger
- ④ Remote Charging Cable
- ⑤ Skate Tool
- ⑥ User Manual
- ⑦ 2.0 mm L Wrench
2.5 mm L Wrench
5.0mm L Wrench

Warnings & Safety Information:

1. Whenever you ride an Exway board, you risk death or serious injury from loss of control, collisions, and falls. To ride safely, you must read and follow all warnings and instructions in this manual.
2. Always wear a helmet when riding. Never ride in water, wet surfaces, in the rain, slippery or uneven surfaces, steep hills, traffic, cracks, train tracks, gravel, rocks, or any obstacles that could cause a loss of traction. Avoid night riding, areas with poor visibility, and narrow spaces.
3. Do not ride an Exway board in environments, on inclines, or at speeds where you would not be safely in control of an unpowered skateboard. In the event of wireless interference or battery fault, you may need to rely on skating techniques like foot-braking or sliding to stop. The Exway electric skateboard is not a toy and is not intended for Children under 16.
4. Please ride responsibly and respect those around you. How you ride will determine how people view this new mode of transportation.
5. The version of the user manual may not be up to date, check out the Exway App or www.exwayboard.com to read the most up to date version.
6. If you do not use your board for long periods of time, please discharge and recharge your board every 30 days.
7. Scan QR code to download the App and get the most up to date version of the user manual.
8. Do not store board at 100% battery charge for extended periods of time, doing so will permanently damage the battery. Maintain around 60% charge when storing for a long time and do not allow battery charge to go below 40%.



iOS



Android



- Scan the QR code to download the APP to get the electronic version of the manual
- 扫描二维码下载APP获得电子版说明书
- 掃描二維碼下載APP獲得電子版說明書
- QRコードをスキャンしてAPPをダウンロードし、電子版のマニュアルを取得します
- QR 코드를 스캔하여 전자 버전의 설명서를 받으려면 APP를 다운로드하십시오.
- Scannen Sie den QR-Code, um die APP herunterzuladen und die elektronische Version des Handbuchs zu erhalten.
- Scannez le code QR pour télécharger l'application pour obtenir la version électronique du manuel.

FCC Caution:

This device complies with part 15 of the FCC Rules. Operation is subject to the following two conditions: (1) This device may not cause harmful interference, and (2) this device must accept any interference received, including interference that may cause undesired operation.

Any Changes or modifications not expressly approved by the party responsible for compliance could void the user's authority to operate the equipment.

Note: This equipment has been tested and found to comply with the limits for a Class B digital device, pursuant to part 15 of the FCC Rules. These limits are designed to provide reasonable protection against harmful interference in a residential installation. This equipment generates uses and can radiate radio frequency energy and, if not installed and used in accordance with the instructions, may cause harmful interference to radio communications. However, there is no guarantee that interference will not occur in a particular installation. If this equipment does cause harmful interference to radio or television reception, which can be determined by turning the equipment off and on, the user is encouraged to try to correct the interference by one or more of the following measures:

- Reorient or relocate the receiving antenna.
- Increase the separation between the equipment and receiver.
- Connect the equipment into an outlet on a circuit different from that to which the receiver is connected.
- Consult the dealer or an experienced radio/TV technician for help.

The device has been evaluated to meet general RF exposure requirement. The device can be used in portable exposure condition without restriction.