

X6

USER GUIDE

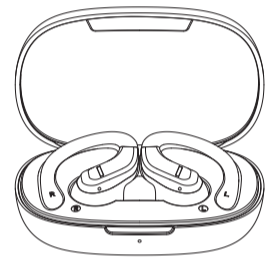

TRULY WIRELESS EARBUDS

- Inside the Box:**
- 1.X6 Wireless Earbud x2PCS
 - 2.On-the-go charging Case x1PCS
 - 3.Type C charging Cable x1PCS
 - 4.Eartips(Size S/M/L) x3Pairs
 - 5.User Manual x1PCS

Specification:
 Bluetooth Version:BT5.2+EDR
 Earbud charging time:1.5 hours
 Charging case Charging time:2.5 hours
 Earbud Battery:3.7V/50mAh
 Charging Case Battery:3.7V/650mAh

Safety precautions:
 The Earbuds are excellent quality,in order to extent the earbuds, please make sure of the following instruction
 1.Please keep away the device away from extreme heat, humidity of corrosive environment.
 2.Please don't over-charing the earbuds or charging case for a long time,as they will decrease the battery service life.
 3.Use a dry cloth to wipe the earbud charging part after using the earbuds.

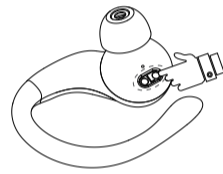

01

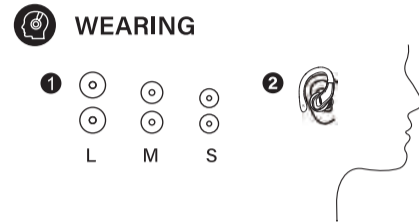

Wearing:Choose the silicone eartips that are most suitable for your ears.

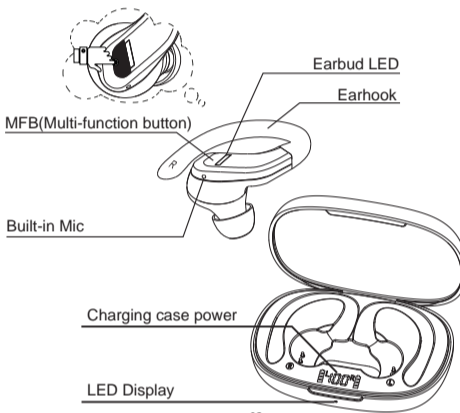

02

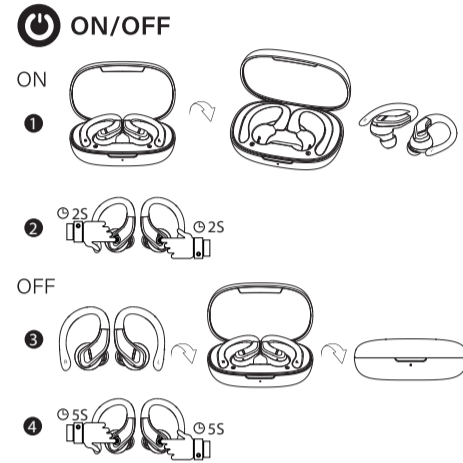

ON/OFF:When the charging case battery level is sufficient,open the charging case and remove the earbuds from the case,the earbuds will automatically turn on;put them into the case and close the cover,the earbuds will automatically turn off.
Note:You can also turn on or turn off the earbuds manually,That is,press and hold the MFB on L/R for 2 seconds to turn on the earbuds; press and hold the MFB on L/R for 5 seconds to turn off the earbuds when they are in the non-playing state.

03

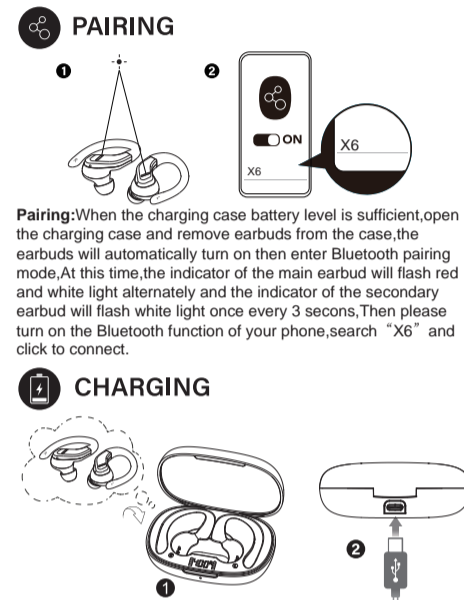

04

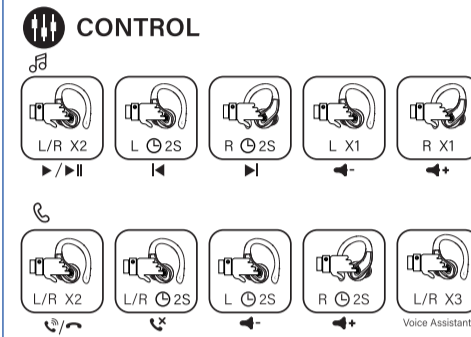

Play/pause:Double-tap the MFB on L/R.
Previous song:press and hold the MFB on L.
Note:In mono mode,Press and hold the MFB on L will trigger next song function.
Next song:Press and hold the MFB on R.
Volume down:Tap the MFB on L to decrease the volume continuously.
Note:In mono mode,volume adjustment is unavailable.
Volume up:Tap the MFB on R to increase the volume continuously.
Note:In mono mode,volume adjustment is unavailable.
Answer/hang up a call:Double-tap the MFB on L/R.
Reject a call:Press and hold the MFB on L/R for 2 seconds.
Activate voice assistant:Triple-tap the MFB on L/R.
Note:In mono mode,tapping the MFB on L/R three times will turn on the voice assistant.

05

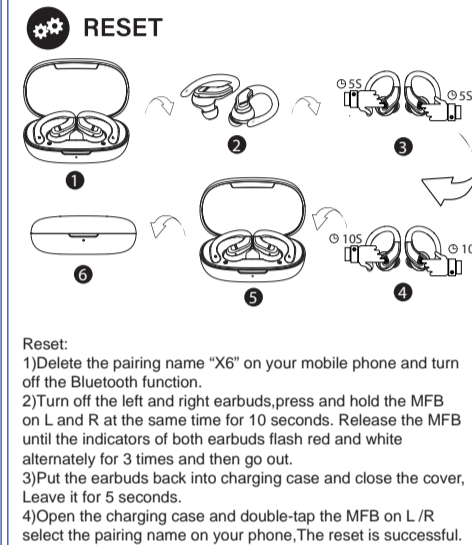

WARNING

Do not listen at high volume levels for long periods.

06

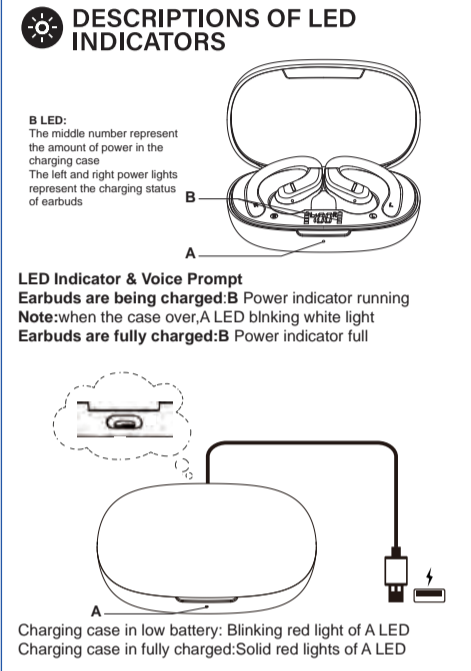

07

FCC Statement

This device complies with part 15 of the FCC rules. Operation is subject to the following two conditions: (1) this device may not cause harmful interference, and (2) this device must accept any interference received, including interference that may cause undesired operation.

Changes or modifications not expressly approved by the party responsible for compliance could void the user's authority to operate the equipment.

NOTE: This equipment has been tested and found to comply with the limits for a Class B digital device, pursuant to part 15 of the FCC Rules. These limits are designed to provide reasonable protection against harmful interference in a residential installation. This equipment generates uses and can radiate radio frequency energy and, if not installed and used in accordance with the instructions, may cause harmful interference to radio communications. However, there is no guarantee that interference will not occur in a particular installation. If this equipment does cause harmful interference to radio or television reception, which can be determined by turning the equipment off and on, the user is encouraged to try to correct the interference by one or more of the following measures:

- Reorient or relocate the receiving antenna.
- Increase the separation between the equipment and receiver.
- Connect the equipment into an outlet on a circuit different from that to which the receiver is connected.
- Consult the dealer or an experienced radio/TV technician for help.

The device has been evaluated to meet general RF exposure requirement. The device can be used in portable exposure condition without restriction.