

# USER GUIDE



## TABLE OF CONTENTS

Product Overview.....	1
Putting in Earbuds.....	2
Chin-Mic & Connectivity.....	3
Charging.....	4
Adjusting Chin-Mic.....	5-6
Package Contents.....	7-8
Learning More.....	10

# SLIMBUDS

WIRELESS EARBUDS FOR HELMETS

# PRODUCT OVERVIEW

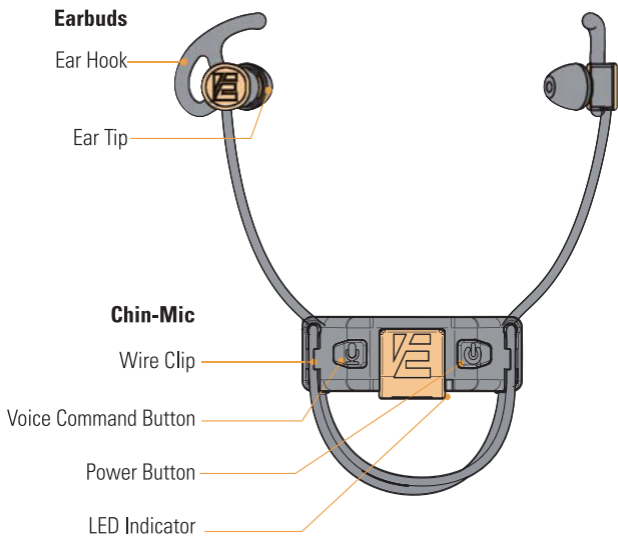

To turn on Slimbuds, hold down **Power Button** until LED begins to flash



## PUTTING IN EARBUDS

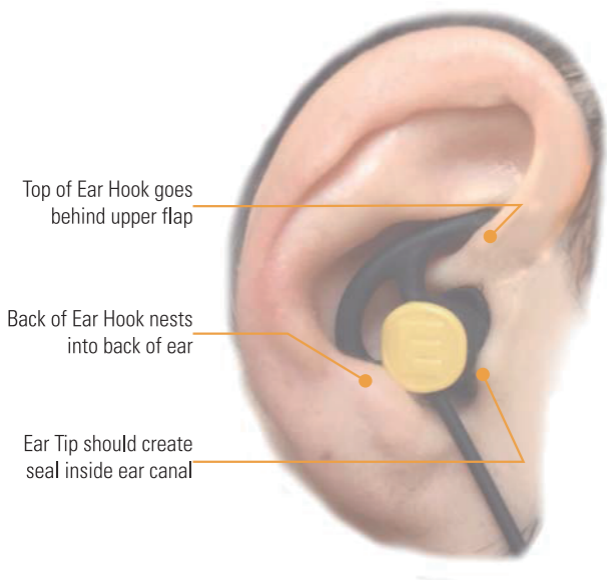

Make sure you have the correct Ear Tip and Ear Hook sizes. The fit should be snug, but not tight or painful.



# CHIN-MIC BUTTONS & CONNECTIVITY

## Steps to connect bluetooth headset

1) With SlimBuds off, hold down **Power Button** until LED is flashing red and blue.

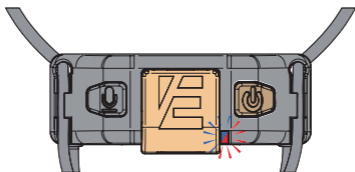

2) Enable Bluetooth on your device and scan for devices

3) Select "SlimBuds" from devices to pair. If successful, LED will flash blue.

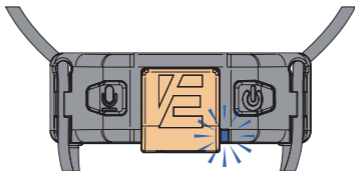

## Activate Voice Command

Hold down **Voice Command Button** and say command into mic

## Pause and Play Music

While music is playing and SlimBuds are connected, press **Power Button** to toggle music



## CHARGING

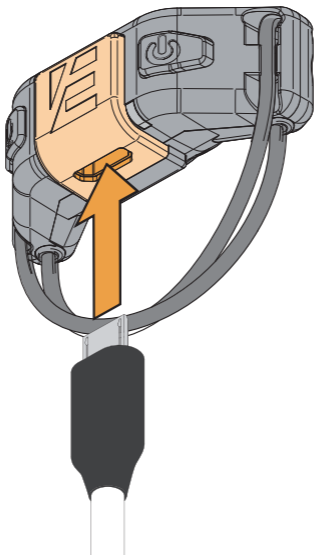

Insert USB charging cable into USB port located on bottom side of the Chin-Mic to charge Slimbuds.

When charging Slimbuds, connect other end of the USB cable into 5V DC charger (USB ports on computer also works). It may take up to 2 hours to fully charge.

## ADJUSTING CHIN-MIC



1) Find wires to adjust

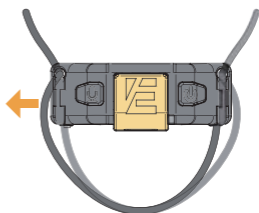

2) Detach wire by unclipping it from SlimBuds body

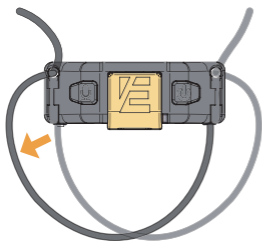

3) Thread wire through, while adjusting Chin-Mic until it is at desired location

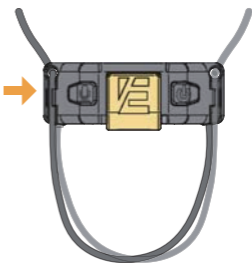

4) Reattach wire into Chin-Mic wire clip by pressing into the groove.

## ADJUSTING CHIN-MIC (CONT'D)

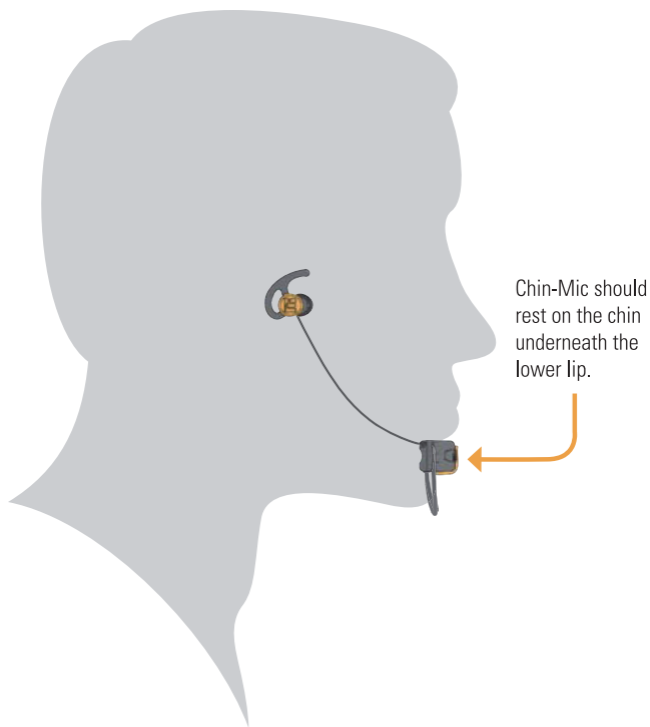

## PACKAGE CONTENTS

- SLIMBUDS
- CARRYING POUCH
- USB CHARGING CABLE
- SET OF SILICONE EAR TIPS (S, M & L)
- SET OF FOAM EAR TIPS (S, M & L)
- SET OF EAR HOOKS (S, M & L)
- USER MANUAL
- EOAS DECAL
- THANK YOU NOTE
- DISCLAIMER





## PACKAGE CONTENTS (CONT'D)



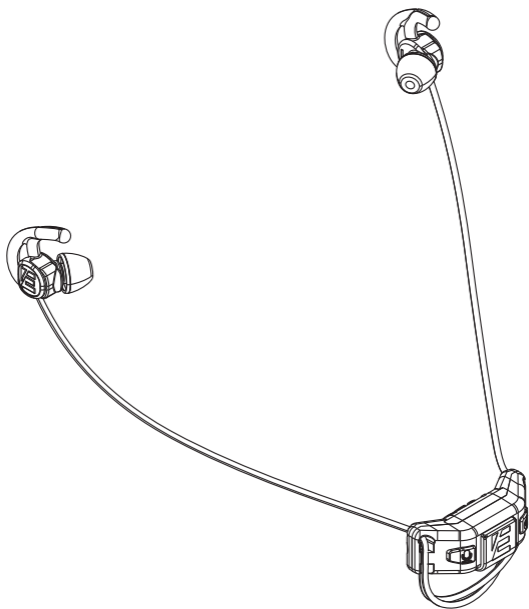

## TO LEARN MORE

For video instructions on SlimBuds  
or to contact us, visit:

**<https://www.byeaos.com/pages/support>**

Connect with us on  
Instagram and Twitter:

**@byeaos**

IC ID:23850-EAOS001

FCC ID:2APROEAOS001



This device complies with Industry Canada license-exempt RSS standard(s). Operation is subject to the following two conditions: (1) this device may not cause interference, and (2) this device must accept any interference, including interference that may cause undesired operation of the device.

Cet appareil est conforme aux CNR exempts de licence d'Industrie Canada. Le fonctionnement est soumis aux deux conditions suivantes:

- (1) Cet dispositif ne peut causer des interférences; et
- (2) Cet appareil doit accepter toute interférence, y compris les interférences qui peuvent causer un mauvais fonctionnement de l'appareil.

changes or modifications not expressly approved by the party responsible for compliance could void the user's authority to operate the equipment.

This device complies with Part 15 of the FCC Rules. Operation is subject to the following two conditions:

- (1) this device may not cause harmful interference, and
- (2) this device must accept any interference received, including interference that may cause undesired operation.

Note: This equipment has been tested and found to comply with the limits for a Class B digital device, pursuant to Part 15 of the FCC Rules. These limits are designed to provide reasonable protection against harmful interference in a residential installation. This equipment generates, uses, and can radiate radio frequency energy, and if not installed and used in accordance with the instructions, may cause harmful interference to radio communications. However, there is no guarantee that interference will not occur in a particular installation. If this equipment does cause harmful interference to radio or television reception, which can be determined by turning the equipment off and on, the user is encouraged to try to correct the interference by one or more of the following measures:

- Reorient or relocate the receiving antenna.
- Increase the separation between the equipment and receiver.
- Connect the equipment into an outlet on a circuit different from that to which the receiver is connected.
- Consult the dealer or an experienced radio/TV technician for help.



