

Headphone Screen

MODEL : JH-ANC930PLUS Screen

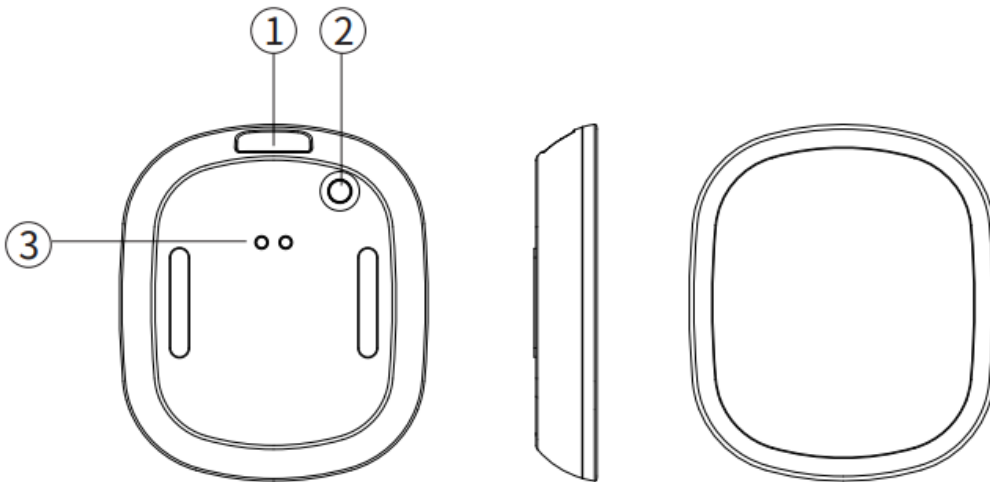

Function Instruction:



①Type-C charging port

②Power button

③Communication pin

Power on/off Instruction:

Power on:

In power-off mode,click the power button

Power off:

In power-on mode,press and hold the power button around 4 seconds

Screen on/off :

1. After power on, the screen will be off automatically if no any operation action on the screen within 30 seconds;
2. In power-on mode, the screen will be off automatically when put back on the headset; and will be on automatically when take it out;
3. In power-on mode, the screen will be off if click the power button, and will be on if click the power button again.

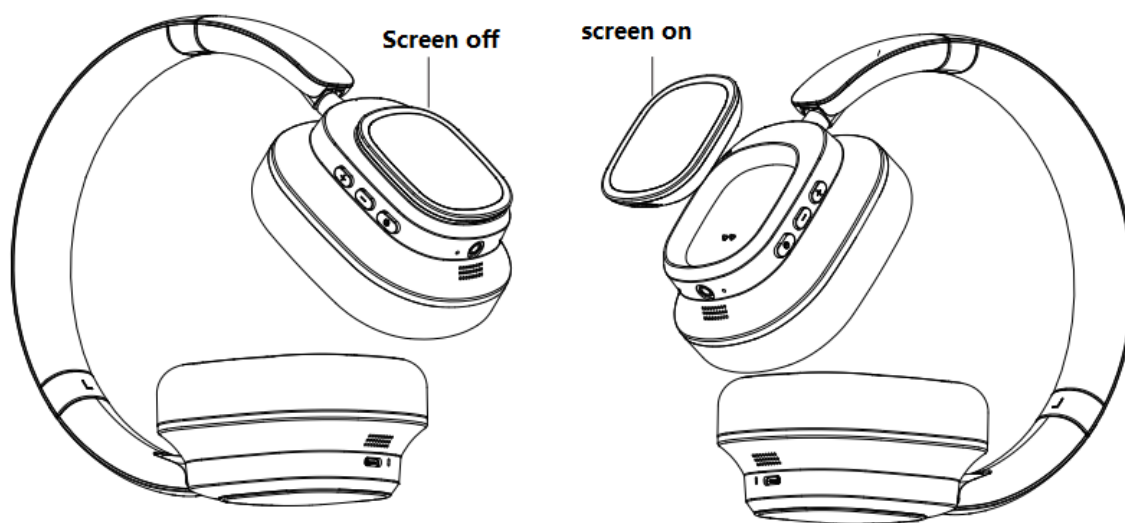

The pairing between headset and screen

1. Turn on the headset and the screen;
2. Put the screen on the headset;
3. Triple-click the power button of headset;
4. After connect successfully, the bluetooth icon of the screen will be white color;

Note:

1. If connect unsuccessfully, the bluetooth icon of the screen is red color;
2. If connect unsuccessfully, please try again by triple-click

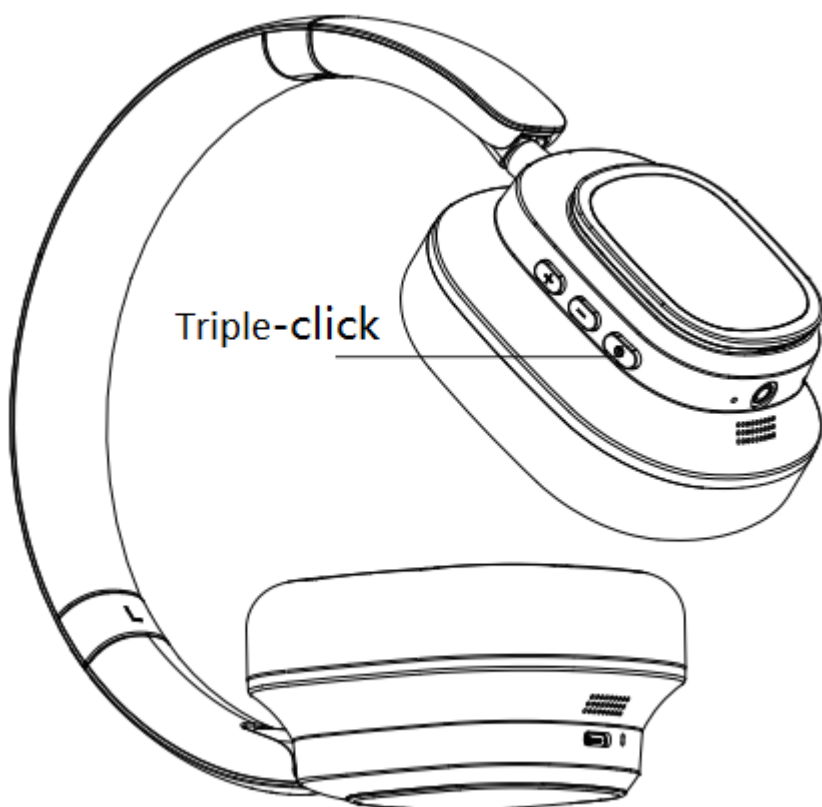

The interface introduction:

1. Music play

Previous song/next song, music play/pause,display Lyrics

2. Volume adjustment

Volume up/down

3. ANC mode

ANC mode,normal mode,transparency mode

4. EQ adjustment(5 different EQ choice)

Normal,rock,pop,classic,jazz mode

5. Alarm

Can be user-defined

6. Brightness of screen

Can adjust the degreeen of brightness

7. Language switch

There are 18 diffeent Languages for choice

8. Lock screen Wallpaper

Can be user-defined

9. Light

Can turn on the light or turn off the light by touch the screen

10.Date&Time setting

Can be user-defined

11.Take photos

If the headset is connected to mobile by bluetooth,and turn on the camera of mobile,then can take photos by click

12.Give a like

If the headset is connected to mobile by bluetooth and play some vedios on the app of mobile,then can click the screen to give a like

Charging:

Connect the screen to the adaptor by Type-C charging cable

Note:Please notice the direction when put the screen to the headset

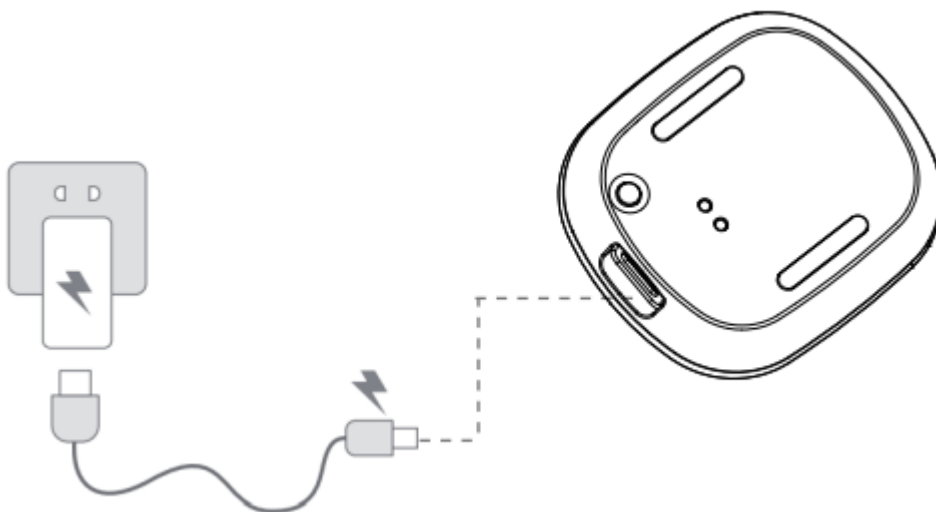

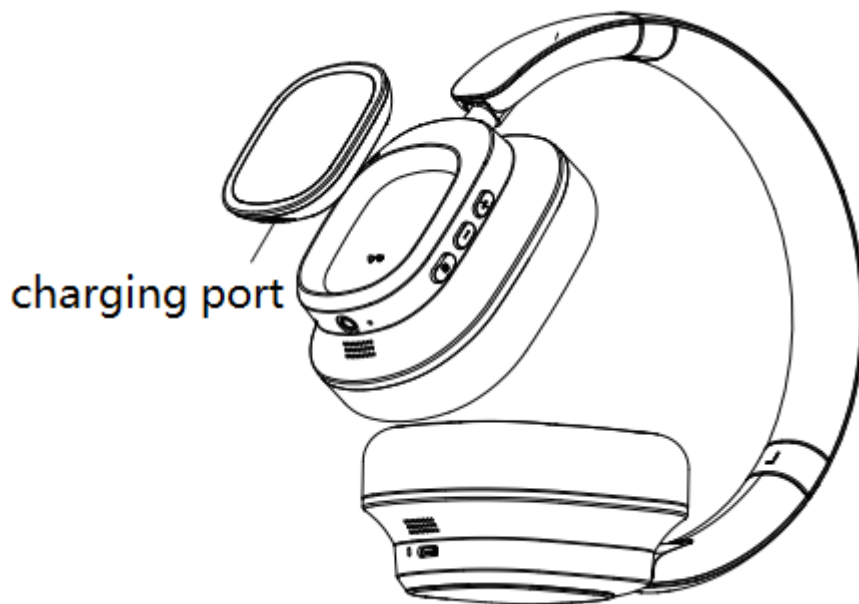

Technical parameter

Bluetooth chipset	JL7012,V5.3
Bluetooth distance	>10m
Frequency range	2402--2480MHz
Input	DC5V,1A
Charging time	Around 1.5H
Charging port	Type-C
Battery capacity	200 mAh

FCC Statement

1. This device complies with Part 15 of the FCC Rules. Operation is subject to the following two conditions:

(1) This device may not cause harmful interference.

(2) This device must accept any interference received, including interference that may cause undesired operation.

2. Changes or modifications not expressly approved by the party responsible for compliance could void the user's authority to operate the equipment.

Note: This equipment has been tested and found to comply with the limits for a class B digital device, pursuant to Part 15 of the FCC Rules. These limits are designed to provide reasonable protection against harmful interference in a residential installation.

This equipment generates uses and can radiate radio frequency energy and, if not installed and used in accordance with the instructions, may cause harmful interference to radio communications. However, there is no guarantee that interference will not occur in a particular installation. If this equipment does cause harmful interference to radio or television reception, which can be determined by turning the equipment off and on, the user is encouraged to try to correct the interference by one or more of the following measures:

- Reorient or relocate the receiving antenna.
- Increase the separation between the equipment and receiver.
- Connect the equipment into an outlet on a circuit different from that to which the receiver is connected.
- Consult the dealer or an experienced radio/TV technician for help.

The device has been evaluated to meet general RF exposure requirement.
The device can be used in portable exposure condition without restriction.