

The image features a blue background with abstract light patterns and bokeh effects. The logo 'Brushlink' is centered in white, with a stylized 'B' that has three horizontal bars. A registered trademark symbol (®) is positioned to the upper right of the 'k'. Below the logo, the tagline 'YOUR PERSONAL DENTAL COACH' is written in a clean, white, sans-serif font.

Brushlink[®]

YOUR PERSONAL DENTAL COACH

Getting Started	1
Band Sizes	2
Attaching Brushlink	3
Brushlink App	4
Switching Brushlink on	5
Using Brushlink Without the App	6
How to Achieve a High Score	7
Overview	8
How to Brush Effectively	9
What if Brushlink is not Working?	10
Replacing the Batteries	11
Safeguards & Warnings	12
Limited Warranty	13

GETTING STARTED

YOU WILL NEED:

Included: Brushlink® device • 2 x LR44 batteries • Silicon band

Not included: Toothbrush (manual or electric) • Smartphone

1

Remove the lower blue-coloured casing.



2

Insert the two LR44 batteries provided. Ensure that the batteries have been inserted as per the image below:



3

Place the white-coloured upper casing on top of the lower casing to close the device.



BAND SIZES



Wrap the silicon band around the toothbrush handle to secure Brushlink into place.

For manual toothbrushes use the small or medium size blue band.

Electric toothbrushes should be used with the medium, large or X-large size blue band.

ATTACHING BRUSHLINK®

Align Brushlink on the back of the toothbrush handle, with the light facing up.



BRUSHLINK® APP

DOWNLOADING THE APP

The award winning Brushlink app is available on both Android and Apple iOS mobile devices.

Search '**Brushlink**' on the Apple App Store or Google Play Store and download the Brushlink app.



SWITCHING BRUSHLINK® ON

1. Once you have **attached Brushlink** to your toothbrush, press the **blue button** to activate your device and connect it to the **Brushlink app**.

2. Ensure the **app is open** on your smartphone and **Bluetooth™ is turned on** to allow the app to automatically **connect to your device**.

There are two ways to switch Brushlink off:

1. Pushing the button again, or

2. Place your toothbrush down and Brushlink will automatically switch-off after 15 seconds



GREEN LIGHT

The Brushlink device is switched on.



BLUE LIGHT

Brushlink is connected to the app, via Bluetooth.



RED LIGHT

Deleting data from the Brushlink device or low battery.

USING BRUSHLINK® WITHOUT THE APP

1 Before you start brushing, push the blue button to switch Brushlink on and then start brushing your teeth.

2 Once you have finished brushing, push the blue button again, or place your toothbrush down and Brushlink will automatically switch-off after 15 seconds.

	BRUSHLINK WITH APP	BRUSHLINK WITHOUT APP
Maximum points achievable	100	60
Live angulation feedback	YES	NO
Real-time visual guidance	YES	NO

HOW TO ACHIEVE A HIGH SCORE

How does Brushlink scoring work?

Using our unique evidence based algorithm, Brushlink is able to calculate a score out of 100 on how well you brush your teeth.

The Brushlink score takes into consideration key parts of good toothbrushing.

The better you brush, using the correct ethos and Brushlink app, the closer your score will be to 100.

The performance of your brushing session consists of 3 key parts:



Time

Brush your teeth for the recommended amount of time on the Brushlink app - normally 2 minutes.



Correct technique

Ensure you brush your teeth and gums at a 45° angle in circular motions.



All surfaces of your teeth

Don't miss brushing certain areas of your teeth. Follow the tooth model on the app to know where to brush.

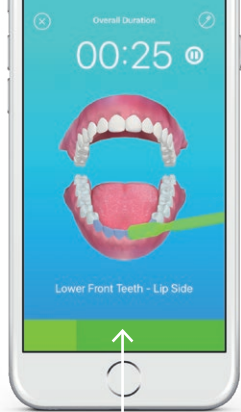

OVERVIEW



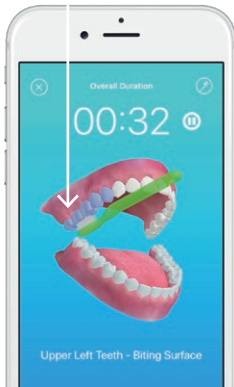

Follow the **highlighted** part on the teeth model to know where to brush.

02:00



The bar at the bottom of the screen shows how **well** you are brushing.

-  Correct angle
-  Improvement needed
-  Incorrect angle

Make sure you brush for at least **two minutes**.

To get the best brushing angle, the bar should **always be green**.

HOW TO BRUSH EFFECTIVELY

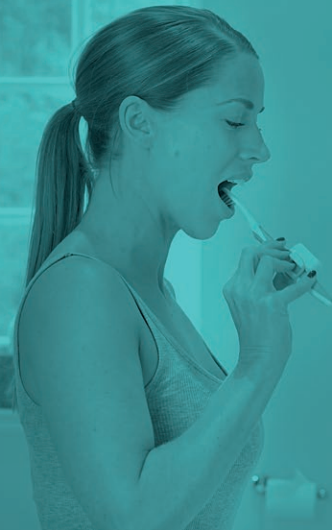

Ensure your toothbrush is at a 45° angle to your teeth and gums.



WHAT IF BRUSHLINK® IS NOT WORKING?

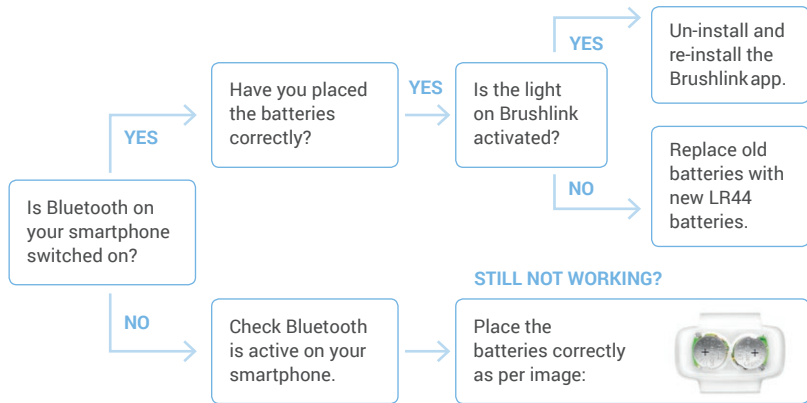

REPLACING THE BATTERIES

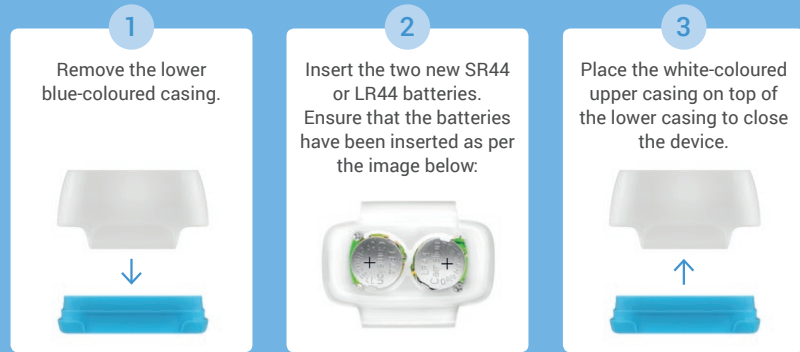

SAFEGUARDS & WARNINGS

- WARNING! Not suitable for children under 36 months due to small parts. Choking hazard.
- When undergoing treatment of any oral condition consult your dental professional prior to use.
- If damaged, do not attempt to repair/modify.
- Use only for intended use.
- Avoid water contact when opening to replace batteries.
- Avoid strong magnetic fields, which could lead to malfunctions or damage.

CAUTION

RISK OF EXPLOSION IF BATTERY IS REPLACED BY AN INCORRECT TYPE. DISPOSE OF USED BATTERIES ACCORDING TO THE INSTRUCTIONS.

CERTIFICATIONS

Brushlink® passed all relevant tests for Europe (EN 60950-1, REACH, Wireless Regulatory R&TTE Europe, EMC for CE, Bluetooth SIG).

DECLARATION OF CONFORMITY

Hereby, DNC Technologies Limited, declares that Brushlink is in compliance with the essential requirements and other relevant provision of the directives RoHS 2011/65/EU and RED 2014/53/EU. The declaration of conformity may be consulted by contacting support@brushlink.com.

This equipment has been tested and found to comply with the limits for a Class B digital device, pursuant to part 15 of the FCC Rules. These limits are designed to provide reasonable protection against harmful interference in a residential installation. This equipment generates, uses and can radiate radio frequency energy and, if not installed and used in accordance with the instructions, may cause harmful interference to radio communications. However, there is no guarantee that interference will not occur in a particular installation. If this equipment does cause harmful interference to radio or television reception, which can be determined by turning the equipment off and on, the user is encouraged to try to correct the interference by one or more of the following measures:

- Reorient or relocate the receiving antenna.
- Increase the separation between the equipment and receiver.

RECYCLING DISPOSAL

This product contains non-rechargeable batteries. In the interest of protecting the environment, please do not dispose the product in the household waste at the end of its useful life. This product was produced after 1 Jan 2016.



LIMITED WARRANTY

Manufacturer and DNC Technologies warrant this device to be free from defects in workmanship or material under normal use for one year from the date of purchase. Manufacturer's obligations under this limited warranty are limited to replacing, adjusting, or repairing the unit if returned along with the proof of purchase.

This warranty is void if the unit has been tampered with, maliciously damaged, or physically abused. The enforceability of this warranty is limited to the original consumer purchaser and is not transferable to, or enforceable by, any subsequent owner. In the event of a defect, malfunction or other failure to conform to this warranty, DNC Technologies will, at its sole discretion, repair or replace the unit at no charge. You are responsible for all shipping cost in connection with warranty service. This warranty commences on the date of retail purchase and shall be effective for a period of one year.

THERE ARE NO EXPRESS WARRANTIES COVERING THE UNIT OTHER THAN THOSE SET FORTH IN THIS WARRANTY. ALL IMPLIED WARRANTIES ARE LIMITED TO THE PERIOD OF THIS WARRANTY AND NO WARRANTIES, EXPRESS OR IMPLIED, EXTEND BEYOND THIS PERIOD. SOME STATES DO NOT ALLOW LIMITATIONS ON HOW LONG AN IMPLIED WARRANTY LASTS, SO THE ABOVE LIMITATION MAY NOT APPLY TO YOU.

Manufacturer and DNC Technologies will in no event be liable for any consequential, incidental, indirect or special damages (including, but not limited to, lost profits) arising out of or in connection with the use, misuse or function of the unit.

If you feel the device is not functioning properly, please review this manual. If you still feel warranty service is required, please follow the below instructions:

To obtain service during the warranty period, please email support@brushlink.com

You must enclose with the unit the following information:

- 1 Your name, complete return address and written description of the problem.
- 2 A telephone number where you can be reached during normal business hours.
- 3 A copy of your dated sales receipt or invoice.

This device complies with Part 15 of the FCC Rules. Operation is subject to the following two conditions: (1) this device may not cause harmful interference, and (2) this device must accept any interference received, including interference that may cause undesired operation.

changes or modifications not expressly approved by the party responsible for compliance could void the user's authority to operate the equipment.

This equipment has been tested and found to comply with the limits for a Class B digital device, pursuant to Part 15 of the FCC Rules. These limits are designed to provide reasonable protection against harmful interference in a residential installation. This equipment generates, uses and can radiate radio frequency energy and, if not installed and used in accordance with the instructions, may cause harmful interference to radio communications. However, there is no guarantee that interference will not occur in a particular installation.

If this equipment does cause harmful interference to radio or television reception, which can be determined by turning the equipment off and on, the user is encouraged to try to correct the interference by one or more of the following measures:

- Reorient or relocate the receiving antenna.
- Increase the separation between the equipment and receiver.
- Connect the equipment into an outlet on a circuit different from that to which the receiver is connected.
- Consult the dealer or an experienced radio/TV technician for help.

This equipment complies with FCC radiation exposure limits set forth for an uncontrolled environment. This transmitter must not be co-located or operating in conjunction with any other antenna or transmitter.

FCC ID: 2APQT-DNC-BR020-F

brushlink.com

© DNC Technologies Limited. All rights reserved.

