

User Manual

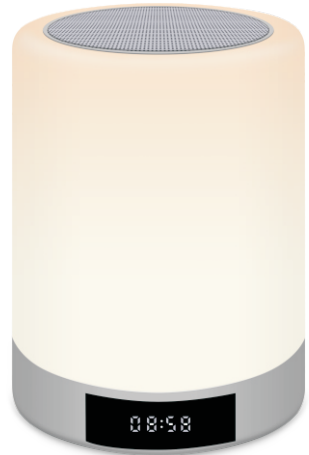

Smart Touch Lighting Speaker

Please read the user manual carefully before using the device

Specifications:

Product name: Smart touch lighting speaker
 Charging input: DC5V=1A
 Battery: 3.7V
 Charging time: about 3 hours
 Speaker unite:4 Ω 3W
 Lighting power:1.6W
 Frequency range:50Hz~20KHz
 Distortion:<0.5%
 SNR: ≥65dB
 Bluetooth Frequency:2.4GHz~2.8GHz
 Bluetooth protocol:A2DP1.2
 Bluetooth version:V4.2+EDR
 Bluetooth distance:10m
 Material:ABS、PP、Metal panel
 Products size:Φ95 X 122 mm

Button explanation:

ON/OFF	Power switch (left and right move)	M	Mode switch
▶	Play/Pause Radio station search	RESET	Reset
⌚	Clock and alarm clock set		
⏮	Previous song/Previous radio station		
⏭	Next song/Next radio station		
+	Volume increase Time and alarm clock adjustment increase		
-	Volume decrease Time and alarm clock adjustment decrease		

Key function indication

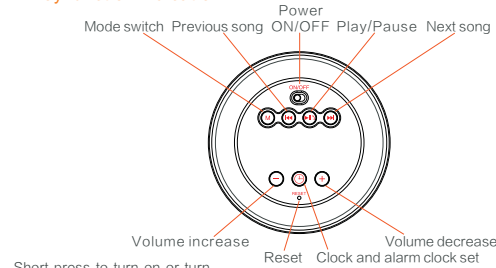

Short press to turn on or turn off the light. Adjust the bright of warm light and colorful light.
 Long press to switch the warm light and colorful light mode.
 Answer or end up the calling.
 Stop alarm clock.

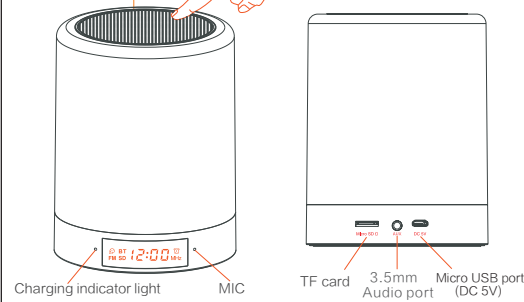

Display screen function explanation

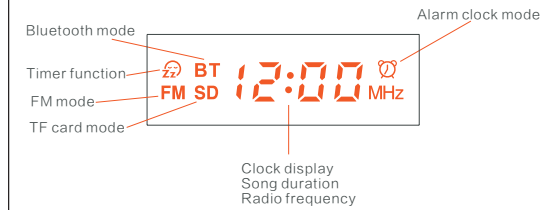

Charging

Please make sure the speaker is fully charged for using first time. When the light on the display flashing and voice prompt saying "low battery, please charge", then please charge the device in time when the power is low.
 Connect the USB cable and power adaptor (cell phone charging adaptor and other usb output 5v adaptor is suggested to charge the devices) to charge the device, plug and play.
 The charge indicator light will be on while charging, when it is fully charged, it will be off.

ON/OFF Switch

Move the ON/OFF switch to the "ON", the device will be open, move to "OFF", the device will be off.

Reset

When there is no reaction of the key operation such as lamp or bluetooth play, press the "RESET" on the side with a small sharp needle to release. Restart the system and resume normal operation.

Table lamp application

Open the table lamp with the touch of your finger on the metal panel when the device is open, there are 3 level light, micro, medium, and high bright. The brightness will rotate until to off by simply touching the metal panel.
 Long touch the panel will convert between the table lamp and color lighting, the color lighting will be orange red, dark blue, green, pink, light blue, color breathing light, music rhythm light (the light will dance with the music when playing music) in order with the touch of your finger when in the color light mode.

Clock setting

Click the clock setting button "⌚" on the bottom to active the clock settings. The display will flash indicating the current option being set in the clock: hour and minute setting in order, press "+" "-" button to set the right hour numbers, press to stop the the hour setting and move to minute setting automatically, press "+" "-" button to set the right minute numbers, then press the "⌚" to finish and exit the setting.



Alarm clock setting

Long press the alarm setting button "⌚" on the bottom to active the alarm setting. The alarm icon "🔔" will be on and flash to show the hours and minute to be set. Press "+" "-" to set the wanted hour and minute numbers, then press "⌚" to finish and exit the setting. If you want to cancel the alarm clock, please Long press the alarm clock button "⌚" when setting the alarm and in the flashing status. When the alarm clock rings, touch the top touch key or press any key to stop the alarm.



Timer Function

Press the "M" button to timer function, timer mode will be 20 minute, 40 minute and 60 minute, press "⏮" "⏭" to chose the wanted minute. The speaker will turn off itself when set time is finished. Timer function is for the sleep of speaker intelligently, please switch on the open button on the bottom to turn on the speaker if needed.



Mode Choose

Click the mode button from the bottom in order to switch Bluetooth mode, TF card mode, FM mode, timer function, Clock mode. When inserted 3.5mm audio in cable, the speaker self identified and automatically switch to audio in input mode.

Clock Mode

If the machine without use the speaker function in the status of long standby. This mode can be selected only when the clock alarm function is used. If the TF card is not inserted in the speaker after power on, the default is the clock mode. If in other modes, the mode button "M" at the bottom can be switched to the clock mode.

Bluetooth Mode:

Bluetooth paring and connection

Turn on the speaker and press the "M" button to bluetooth mode, there will be voice prompt saying "bluetooth mode, waiting for connection" and "BT" flash when in bluetooth statuses, it is time only when it is ready for connection and connection will be successful.

- Step 1: Open the Bluetooth setting on your phone or tablet and click "search device". iPhones will search for Bluetooth devices automatically.
- Step 2: When you find the mode "M6 Mini" on you screen display, click and pairing.
- Step 3: Enter "0000" and click OK if there's a prompt that requires you to enter a password.
- Step 4: The "BT" on the speaker will stop flashing and light on when paring is successful with you devices.

Bluetooth connection notification:

1. If the speak has been connected with Bluetooth devices before, it will connect with the last Bluetooth device automatically once it is turned on.
2. Other phones or tablets can not be connected with the Bluetooth speaker when the speaker is being connected with a phone or tablet.
3. The phone or tablet can not be connected with the Bluetooth speaker if it is connected with other Bluetooth devices. You should turn off your Bluetooth connection and connect your phone with the Bluetooth speaker again.

Bluetooth Music Playing

Open the player device when the connection is successful. Click to play music, and the Bluetooth speaker will play the music.

You can operate the bottom buttons on the Bluetooth speaker to control the player

- Short press "▶||" to play/pause.
 Press "⏮" button to previous song.
 Press "⏭" button to next song.
 Press and hold "+" to increase volume.
 Press and hold "-" to decrease volume.

Bluetooth Hands free Call

Answer and hang up the phone:
 There will be an alert sound from the speaker when there is a phone call. Click the bottom "▶||" to answer the phone, and click again to hang up the phone.

TF Card Mode

Insert the TF card when the speaker is turned on. Press the "M" button to TF card mode or the speaker will enter itself into the TF card mode when inserting the TF card. It can play the music (MP3/WMA format) from your TF card. You can operate the player with the buttons under the Bluetooth speaker:

- Short press "▶||" to play/pause.
 Press "⏮" button to previous song.
 Press "⏭" button to next song.
 Press and hold "+" to increase volume.
 Press and hold "-" to decrease volume.
 In TF mode, the display can only show the playing time of songs but not the clock.

FM radio function

Press the "M" button to FM mode, the display will show the frequency of the radio played. Long press "▶||" button to search the radio automatically, please do not press any button during the search, the radio will be numbered and stored.

- Long press "▶||" button to search the radio.
 Press "⏮" button to previous radio.
 Press "⏭" button to next radio.
 Press and hold "+" to increase volume.
 Press and hold "-" to decrease volume.

Under the FM mode, the screen will display the radio frequency only but not the clock.

AUX in audio input mode

When inserted 3.5mm audio in cable, the speaker self identified and automatically switch to audio in input mode.

Timer Function

Press the "M" button to timer function, timer mode will be 20 minute, 40 minute and 60 minute, press "⏮" "⏭" to chose the wanted minute.
 The speaker will turn off itself when set time is finished. Timer function is for the sleep of speaker intelligently, please switch on the open button on the bottom to turn on the speaker if needed.

Frequently Asked Questions

Unsuccessful pairing and connection repeatedly

1. Check the speaker and make sure it is in the searching state or reboot the speaker.
2. Connection is difficult when there are too many Bluetooth devices nearby. Turn off other Bluetooth devices.
3. Turn off the Bluetooth device that was connected with the Bluetooth speaker last time, and reconnect the speaker.

Muted or distorted sound

1. Check the volume of your phone or the speaker, and adjust the volume.
2. The battery is low. Please charge it.

Choppy music play

1. Check if the device is beyond the effective connection distance.
2. Check if there is any obstacle between the speaker and your device.

The indicator not shining in Bluetooth mode

1. The battery is low. Please charge it.
2. Please reboot the speaker.

Precautions

1. Please store and use the product in room temperature environment.
2. Do not expose this product in rain or wet conditions.
3. Do not drop or bump this product.
4. Do not disassemble, repair, or modify the product in private.
5. Please use the power charge with rated voltage for the speaker.
6. It may cause hearing damage if playing music in high volume for a long time. Avoiding excessively high volume when playing music for a long time.
7. Disassemble this product will invalidate the warranty.

Federal Communications Commission (FCC) Statement. This device complies with part 15 of the FCC Rules. Operation is subject to the following two conditions:

- (1) This device may not cause harmful interference, and
- (2) this device must accept any interference received,

including interference that may cause undesired operation. Note: This equipment has been tested and found to comply with the limits for a Class B digital device, pursuant to part 15 of the FCC Rules. These limits are designed to provide Reasonable protection against harmful interference in a residential installation. This equipment generates, uses and can radiate radio frequency energy and, if not installed and used in accordance with the instructions, may cause harmful interference to radio communications. However, there is no guarantee that interference will not occur in a particular installation. If this equipment does cause harmful interference to radio or television reception, which can be determined by turning the equipment off and on, the user is encouraged to try to correct the interference by one or more of the following measures:

- Reorient or relocate the receiving antenna.
- Increase the separation between the equipment and receiver.
- Connect the equipment into an outlet on a circuit different from that to which the receiver is connected.
- Consult the dealer or an experienced radio/TV technician for help.

Warning: Changes or modifications made to this device not expressly approved by **Shenzhen Pythagorean Smart Technology Co., Ltd** may void the FCC authorization to operate this device. Note: The manufacturer is not responsible for any radio or TV interference caused by unauthorized modifications to this equipment. Such modifications could void the user's authority to operate the equipment.

RF exposure statement:

The device complies RF exposure requirement and can be installed and used without restriction