

L9 lite

3 Axis Foldable Gimbal

User Manual

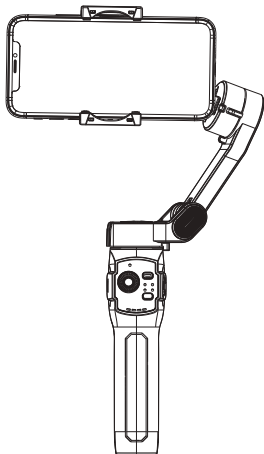

* Smartphone is not included

CONTENT

About APP	01
Quick Start	03
Power On/Off	04
Gimbal Overview	05
Operate Modes	07
Other Functions	09
Charging	10
Product Specification	11
Caution	12
Storage & Maintenance	12

About APP

This gimbal support capturing pictures/taking videos by native camera when connect to the bluetooth. Any special photography request like Inception, Dolly zoom, Panoramic need be used in APP.

Download the APP

Way 1:

iOS smartphone search the "Gimbal pro" on Apple Store;

Android smartphone search the "Gimbal pro2" on Play Store;

Way 2:

Scan below QR code to download and install.



(Support both iOS and Android)

Tips: The app supports iOS 12.0 and higher or Android 8.0 and higher.

Connect with the smartphone

1. Activate bluetooth on your smartphone;
2. Switch on gimbal;
3. Go to the app and search for available bluetooth devices, select the device named "GP9_XX", the connection will be established automatically.

App interface overview



1. Video/Photo/Vlog mode
2. Shooting function select
3. Shoot button
4. Front/Rear camera switch
5. Album
6. Bluetooth icon
7. Face/object tracking
8. Gimbal condition display

9. Gimbal power display
10. Flash
11. Phone power display
12. Home page
13. Camera parameters
14. Gimbal mode adjust
15. Settings
16. Gesture control
(* only works in iOS system)

Quick Start

This product supports powering on without a smartphone, and allows the phone to be removed even during use when you receive a call.

1. Install the tripod to gimbal.

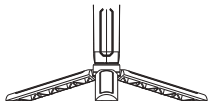

2. Insert the smartphone on gimbal according to the direction of the red arrow, remove the smartphone case before inserting, make sure the holder is at the middle of smartphone.

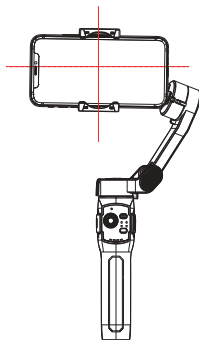
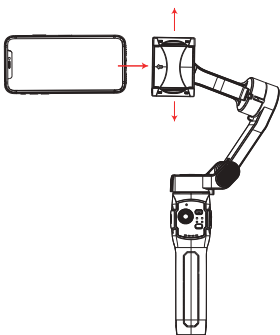

Power On/Off

Press and hold the power button to power on and off.

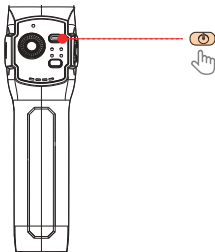

Note:

Please make sure that smartphone is firmly attached to prevent vibration or jerking of the gimbal.

Gimbal Overview

Bluetooth Indicator

Slow flashing: bluetooth is not connected

Fast flashing: bluetooth is connecting

Light is on: bluetooth is connected

Joystick

Control smartphone up/down
right/left movement

LF: Lock Full

Tilt/Pan/Roll lock

Battery Indicator

One light: 1%-24% battery

Two lights: 25%-49% battery

Three lights: 50%-74% battery

Four lights: 75-100% battery

Power Button

Long press: power on/off

Single press: switch between portrait/landscape mode

Press 2 times: switch between photo/video mode (work in App)

Press 3 times: switch between front/rear camera (work in App)

FPV(First Person View)

Tilt/Pan/Roll axis follow

AF: All Follow

Tilt/Pan follows, Roll lock

HF: Half Follow

Pan follow, Tilt/Roll lock

Mode Button

Single press: switch operation modes

Press 2 times: center the phone

Press 3 times: activate face and object tracking icon(work in App)



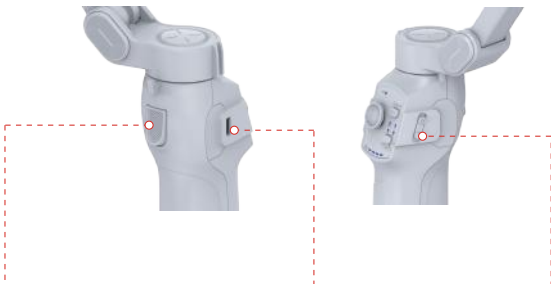

Shutter Button

Picture mode

Single press: take photo

Long press: continuous photography
(work in APP)

Video mode

Single press: start/stop recording

Twice press: pause video shooting,
twice press again to recover
(work in APP)

Triple press: capture photos during
recording (work in APP)

Type-C port

Charge for gimbal

Zoom

Zoom in/out

Tips: press the shutter button and power button at the same time to reset the bluetooth name, unpair with previous smartphone, then can pair with another smartphone

Operation Modes

All Follow(AF): The Roll axis is locked, the Pan (left/right) and Tilt (up/down) axes will follow the movement of handle.

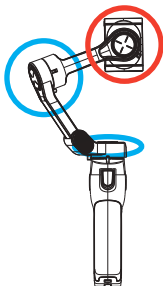

Half Follow(HF): Tilt & Roll axes are locked. Pan axis rotates (left/right) smoothly with the handle.

※ Default mode upon powering on

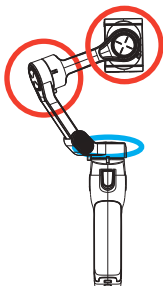

Lock Full(LF): Pan,Tilt, Roll axes are all locked. The camera remains still and stable, which means the camera cannot follow the movement of the handle.

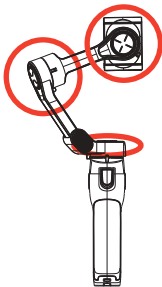

First person view(FPV): Pan, Tilt, Roll axes follow the movement of the handle.

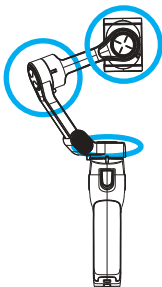

Others Functions

Work mode

Works with both landscape and portrait modes

Underslung mode

Hold the gimbal upside down to enter underslung mode, in order to capture images from low position

Side Grip mode

Rotate gimbal to the right or left by 90° to go from upright to side grip mode, works in both landscape and portrait modes

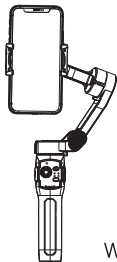

Work mode-portrait

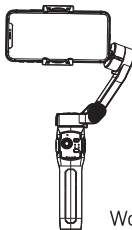

Work mode-landscape

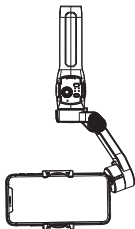

Underslung mode

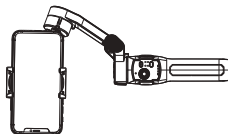

Side grip mode

Charging

This product supports fast charging, suggest to use 5V/2A adapter to charge for the gimbal

※ Support working during charging

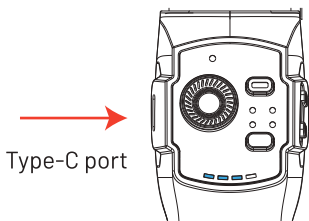

Charging

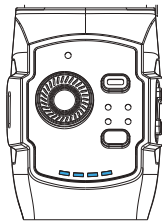

Charging is completed

Specification

Pitch Angle	160°
Roll Angle	325°
Pan Angle	340°
Controllable Tilt Angle	+45°/-45°
Controllable Roll Angle	+100°/-220°
Controllable Pan Angle	+220°/-100°
Net Weight	378g
Dimension	Unfold: 275x135x79mm Folded: 173x100x42mm
Support Smartphones	Diagonal: 192mm or < 7.72inch Width: 55-90mm Thickness: 7-12mm
Input Voltage	5V
Input Currency	2A
Working Temperature	0℃-40℃

Caution

1. Ensure the motor rotation is not blocked by external force during and after the stabilizer is powered on;
2. Please do not contact with sea water or corrosive liquid;
3. Please do not disassemble the stabilizer (except for the detachable accessories in the manual);
4. If the motor works continuously for a long time, the surface temperature of the motor may be too high.
5. It is strictly forbidden to drop or collide with the stabilizer, which may damage it and cause abnormal operation;

Storage and maintenance

1. Please keep this product away from children and pets;
2. It is forbidden to put the product near the heat source (furnace or heater, etc.) and in the car at hot weather;
3. Please store the product in a dry environment;
4. Do not overcharge or discharge the battery, otherwise the battery cell will be damaged;
5. Do not use the product in the environment with too high or too low temperature;

FCC Warning Statement

Changes or modifications not expressly approved by the party responsible for compliance could void the user's authority to operate the equipment. This equipment has been tested and found to comply with the limits for a Class B digital device, pursuant to Part 15 of the FCC Rules. These limits are designed to provide reasonable protection against harmful interference in a residential installation. This equipment generates uses and can radiate radio frequency energy and, if not installed and used in accordance with the instructions, may cause harmful interference to radio communications. However, there is no guarantee that interference will not occur in a particular installation. If this equipment does cause harmful interference to radio or television reception, which can be determined by turning the equipment off and on, the user is encouraged to try to correct the interference by one or more of the following measures:

- Reorient or relocate the receiving antenna.
- Increase the separation between the equipment and receiver.
- Connect the equipment into an outlet on a circuit different from that to which the receiver is connected.
- Consult the dealer or an experienced radio/TV technician for help.

FCC Radiation Exposure Statement

The device has been evaluated to meet general RF exposure requirement. The device can be used in portable exposure condition without restriction.

This device complies with Part 15 of the FCC Rules. Operation is subject to the following two conditions:

- (1) This device may not cause harmful interference, and
- (2) This device must accept any interference received, including interference that may cause undesired operation.