

SMART PLUG

INSTRUCTION



US 15A Smart Plug instruction

1、Product characteristic:

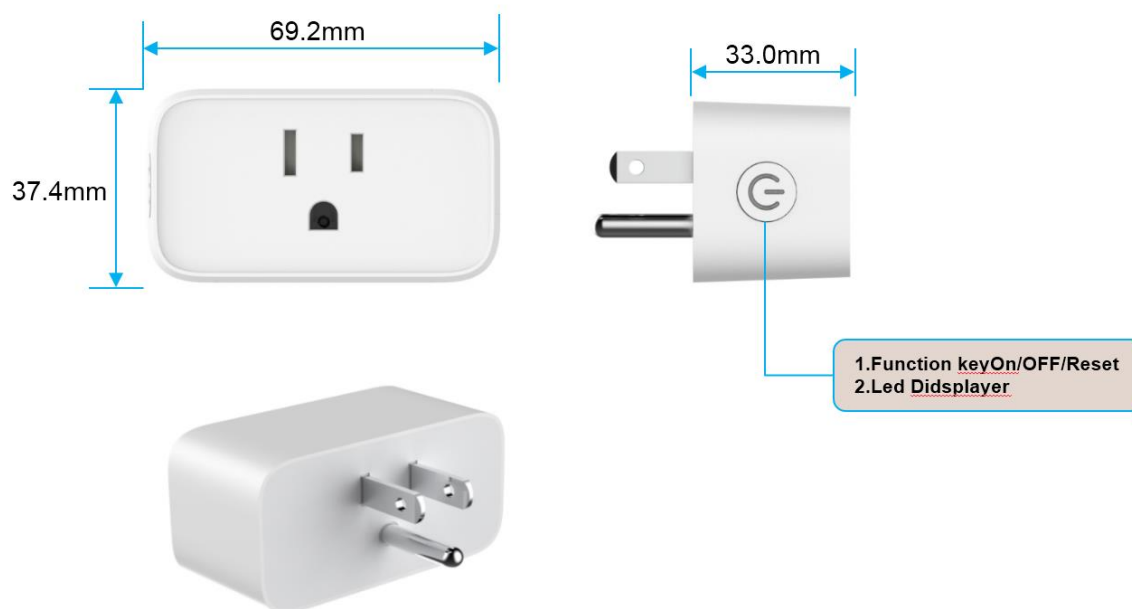

2、Intended use:

The product is Smart plug, output socket voltage is consistent with the input voltage, and Max. output load is 1800W or 15A under using of resistive load conditions, the Smart plug like a switch that can be operated remote control, countdown on/off and turn on / off device function regularly; It can also measure electrical parameters of current, voltage, power and daily power usage.

3、Key parameters:

- 【Product Name】 : Smart plug
- 【Model】 : P05-WBN-TYS, P05-WBN-TYP
- 【input】 : AC 120V \pm 10%, 60HZ, Max load :15A (resistive);
- 【output】 : AC 120V \pm 10%, 60HZ, MAX1800W@120V
- 【Wireless Standard】 : Wifi 2.4Ghz IEEE 802.11 b/g/n;
- 【Static power】 : <0.7W

【Laser】 : As below for reference, different customers will have different content

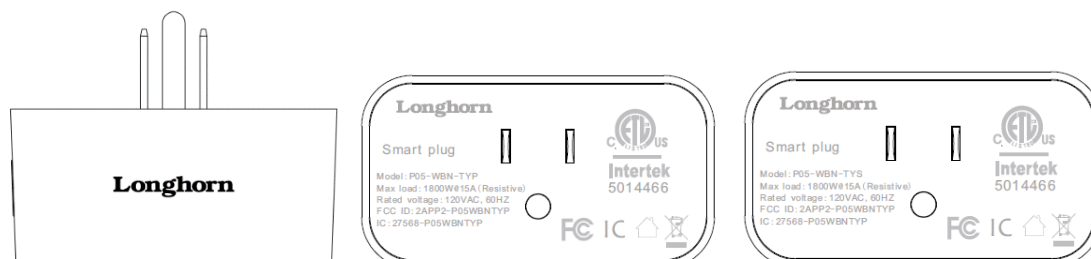

US 15A Smart Plug instruction



Indoor use only



Complies with Part 15 of the FCC Rules



Complies with ICES 003 and RSS-247 Issue 2



Conforms to UL STD 60730-1, 61010-1, 61010-2-030, 498,
Certified to CSA STD C22.2 No. 61010-1, 61010-2-030, 60730-1, C22.2 #42.



Do Not Place equipment and its accessories in the trash. Items must be properly disposed of in accordance with local regulations.

【Working Temperatura / humidity】 : 0~+40°C;20%~85%

【Working altitude】 :2000m

【POLLUTION DEGREE】 : 2

【Storage Temperatura / humidity】 : -20°C~+70°C;0%~90%

【Outline】 : 69.2*37.4*33.0mm;

【Protection】 :IP20, 750°C High temperature flame retardant material

4、Specifications:

【protect shutters】 : Include protect shutters

【Indication】 : RED and Blue LED Indication

【OTA】 : Support

【wireless Access】 : Support SmartConfig and AP network configuration;

【Function】 :On/off switch, Remote on-off control, countdown on/off, Turn on / off device function regularly , electricity meter (current, voltage, power, daily power usage)

4、Warning and Announcements (Avertissement et Précautions à prendre):

①、Only to be used indoor.

Seulement à utiliser à l'intérieur.

②、Only to be used in dry condition.

Uniquement à utiliser à l'état sec.

③、Only to be used within max. load.

Uniquement à utiliser dans les limites de max.Chargez.

④、Do not connect in series.

Ne pas se connecter en série.

if the equipment is used in a manner not specified by the manufacturer, the protection provided by the equipment may be impaired.

⑤、Only connect to outlet with reliable earth.

Connecte-toi à la prise avec une terre fiable.

⑥、Do not connect after each other.

You imagine we create

Longhorn

US 15A Smart Plug instruction

Ne pas se connecter les uns après les autres.

⑦、 This device contains licence-exempt transmitter(s)/receiver(s) that comply with Innovation, Science and Economic Development Canada's licence-exempt RSS(s). Operation is subject to the following two conditions:

(1) This device may not cause interference.

(2) This device must accept any interference, including interference that may cause undesired operation of the device.

L'émetteur/récepteur exempt de licence contenu dans le présent appareil est conforme aux CNR d'Innovation, Sciences et Développement économique Canada applicables aux appareils radio exempts de licence. L'exploitation est autorisée aux deux conditions suivantes :

(1) L'appareil ne doit pas produire de brouillage;

(2) L'appareil doit accepter tout brouillage radioélectrique subi, même si le brouillage est susceptible d'en compromettre le fonctionnement.

⑧、 This equipment complies with FCC's and IC's RF radiation exposure limits set forth for an uncontrolled environment. The antenna(s) used for this transmitter must be installed and operated to provide a separation distance of at least 20 cm from all persons and must not be collocated or operating in conjunction with any other antenna or transmitter. Installers must ensure that 20cm separation distance will be maintained between the device (excluding its handset) and users.

Cet appareil est conforme aux limites d'exposition au rayonnement RF stipulées par la FCC et l'IC pour une utilisation dans un environnement non contrôlé. Les antennes utilisées pour cet émetteur doivent être installées et doivent fonctionner à au moins 20 cm de distance des utilisateurs et ne doivent pas être placées près d'autres antennes ou émetteurs ou fonctionner avec ceux-ci. Les installateurs doivent s'assurer qu'une distance de 20 cm sépare l'appareil (à l'exception du combiné) des utilisateurs.

⑨、 This device complies with Part 15 of the FCC Rules. Operation is subject to the following two conditions:

(1) this device may not cause harmful interference,

(2) this device must accept any interference received, including interference that may cause undesired operation.

⑩、 Changes or modifications to this unit not expressly approved by the party responsible for compliance could void the user's authority to operate the equipment.

NOTE: This equipment has been tested and found to comply with the limits for a Class B digital device, pursuant to Part 15 of the FCC Rules. These limits are designed to provide reasonable protection against harmful interference in a residential installation. This equipment generates uses and can radiate radio frequency energy and, if not installed and used in accordance with the instructions, may cause harmful interference to radio communications.

However, there is no guarantee that interference will not occur in a particular installation. If this equipment does cause harmful interference to radio or television reception, which can be determined by turning the equipment off and on, the user is encouraged to try to correct the interference by one or more of the following measures:

☐ Reorient or relocate the receiving antenna.

☐ Increase the separation between the equipment and receiver.

US 15A Smart Plug instruction

- ❑ Connect the equipment into an outlet on a circuit different from that to which the receiver is connected.
- ❑ Consult the dealer or an experienced radio/TV technician for help.

This equipment complies with FCC radiation exposure limits set forth for an uncontrolled environment. This equipment should be installed and operated with a minimum distance of 20cm between the radiator & your body. This transmitter must not be co-located or operating in conjunction with any other antenna or transmitter.

(11)、When the apparatus needs a cleaning, you can blow off dust from the apparatus with a blower or clean with rag etc. Don't use solvents such as benzol, alcohol, or other fluids with very strong volatility and flammability for cleaning the apparatus body. Clean only with dry cloth.

(12)、Maintenance and service

Please do not continue to use the product if there is any problem and send it back to us

US 15A Smart Plug instruction

5、Installation:

a. Portable, installation-free, do not install the product at the difficult to operate disconnecting device position

b. when you installate plug on the wall socket, plug Switch button should be in the left, the wall sockets shall be $120V \pm 10\%$ and well grounded



6、APP Installation

Use your phone to scan the QR code below or search “Smart Life” in application market to download and install the App



IOS /Android QR Code

7、Register/Login/Forgot password

Register:

If you don't have an App account, register an account or sign in with verification code by SMS, registration process as follows:

a. Open APP enter main interface, tap the 'sign up', agree the Notice

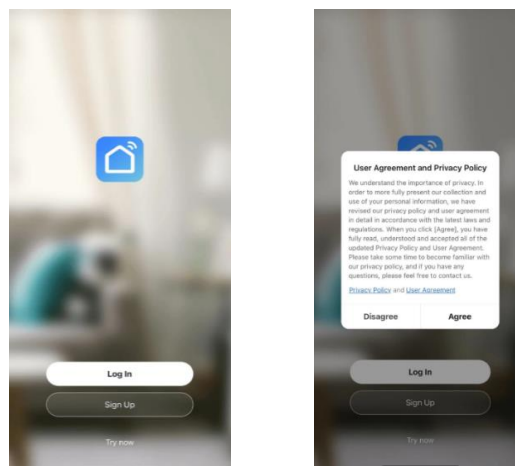

You imagine we create

Longhorn

US 15A Smart Plug instruction

b. The system automatically recognizes your country / area; you can also select your country code. Enter the mobile number or E-mail address to 'get verification code', If you enter the mobile number, you will get the verification code in your phone verification message , If you enter the E-mail, you will get the verification code in your Email content, tap "Confirm" to finish your registration.

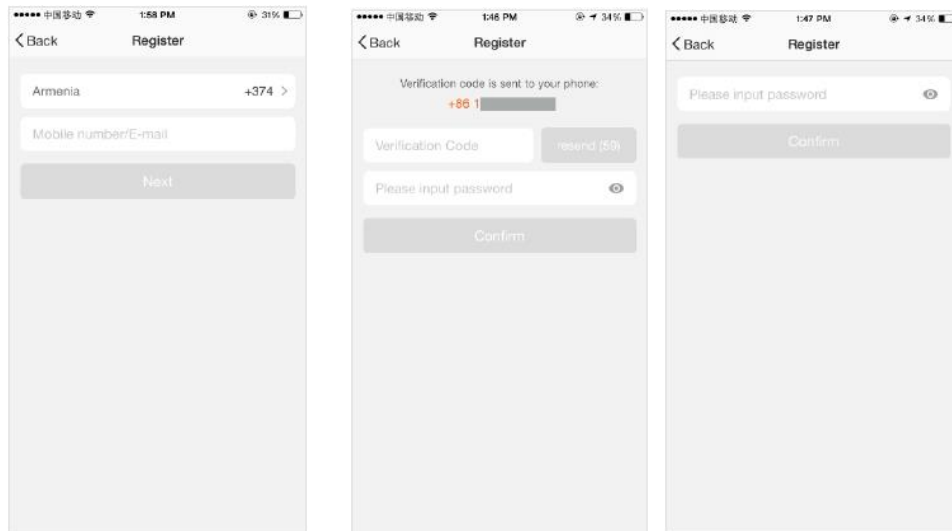

Sign in with existing username and password:

- a. Back to 'Log In' interface, the system automatically recognizes your country / area. You can also select your country code. Enter the mobile number/E-mail,
- b. Enter your registered mobile number or Email, and password to login.

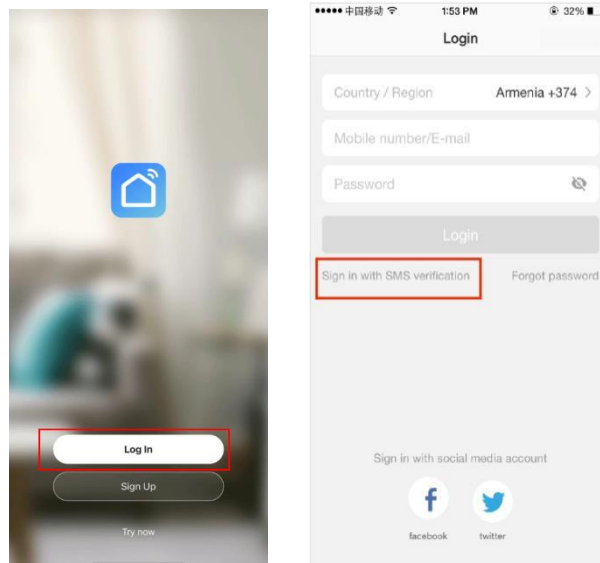

US 15A Smart Plug instruction

Sign in with social media account:

If you have installed Facebook or Twitter User in your smartphone, tap the corresponding icons and then sign in the App over social network authentication

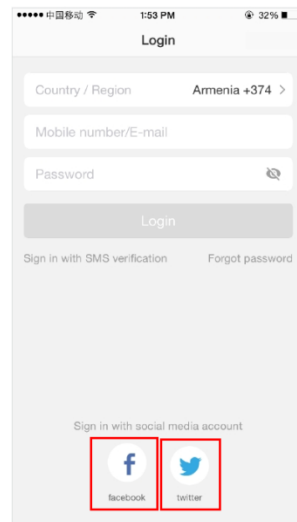

Forgot password:

To find your password back, please follow the procedures:

- Tap "Forgot password",
- The system automatically recognizes your country / area. You can also select your country code by yourself. Enter the mobile number/E-mail and tap "Next",
- Enter the verification code in the message/E-mail, and enter the new password, tap "Confirm" to finish.

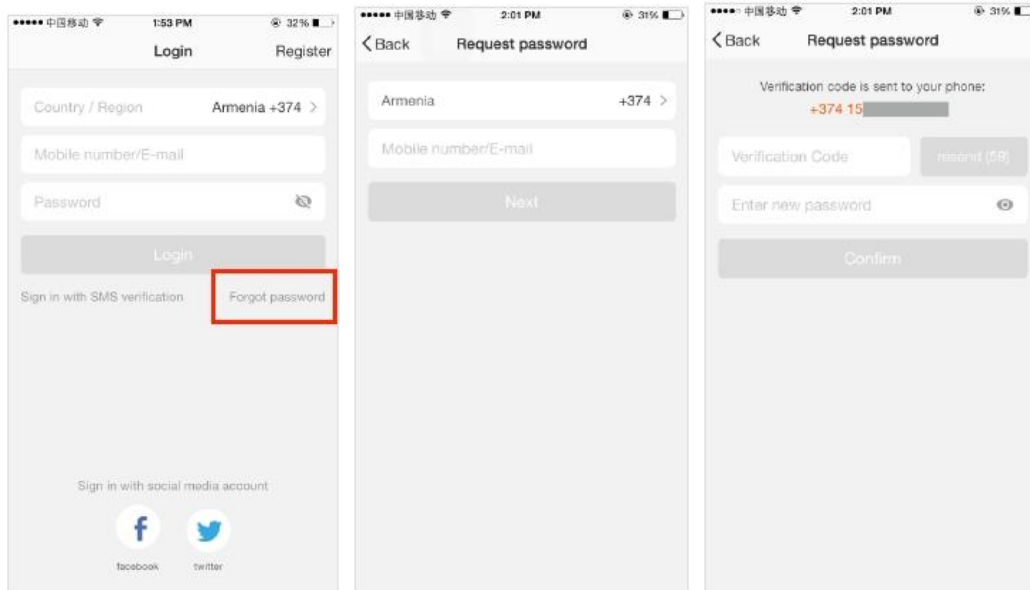

US 15A Smart Plug instruction

8、 User add device to network

a. Enter the 'my home' page and tap the top left corner icon  to display the 'personal information', you can fill out or modify the relevant information

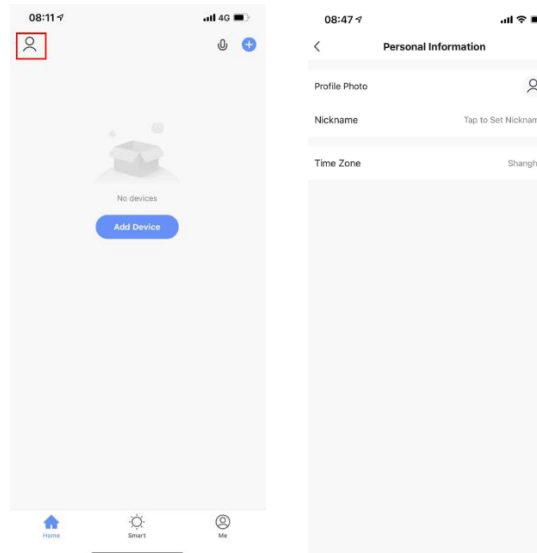

b. Ensure the mobile device is in the normal Wifi connection state and the signal is good, click the icon "add device" to enter the 'Add Manually' interface, select the corresponding Wifi plug type, meanwhile, you can open your phone Bluetooth to quickly add device.

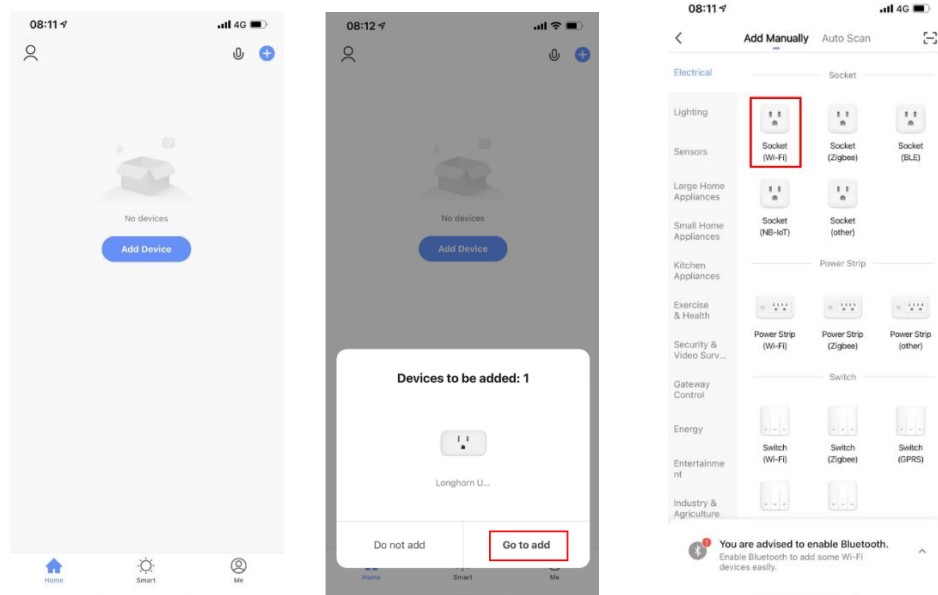

US 15A Smart Plug instruction

C. Ensure the mobile device is in the normal Wifi connection state and the wifi signal is good, **Just support 2.4GHz wifi model.**

Click the icon "add device" to enter the 'Add Manually' interface, select the corresponding wifi plug type, also you can open your phone bluetooth to quickly add device.

Ensure the device is switched on, observe whether plug status Red LED is flashing, if not, you must push the power button more than 5 seconds until the led change into flashing that represents into network matching ready status.,click the'next' icon, automatically complete finding device-> register on cloud->device reset mode,During this period, no need any operation, just need 30~60s waiting(**Up to your router and network signal strength**) **till appear connecting 100% complete** ,red led will stop flashing enter put out state, At this time,click the power button the led will change to blue color, the blue red represents device working status.

You imagine we create

Longhorn

US 15A Smart Plug instruction

After successfully adding the device, you can edit device name and binding the application environment, click “save”, change into main interface for customer ready to use

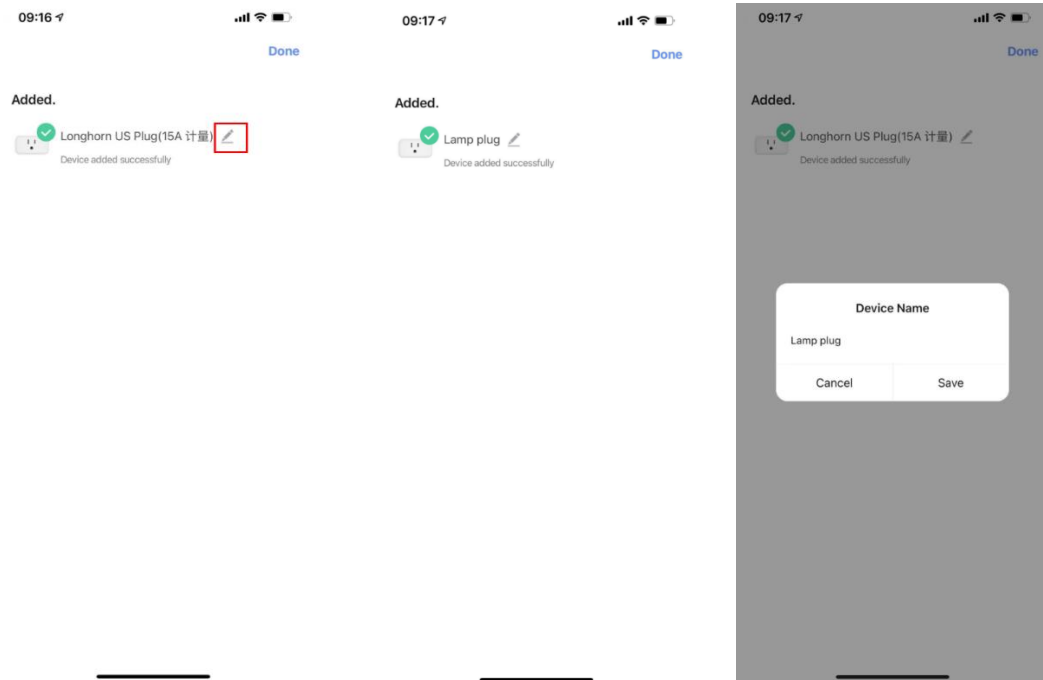

9、Remove device

Click the edit logo , going to interface and choose 'Remove Device', and select 'Disconnect and wipe data', reset the device. Also you can press the power key more than 5 seconds till the LED flash slowly (around 1 time/3s)

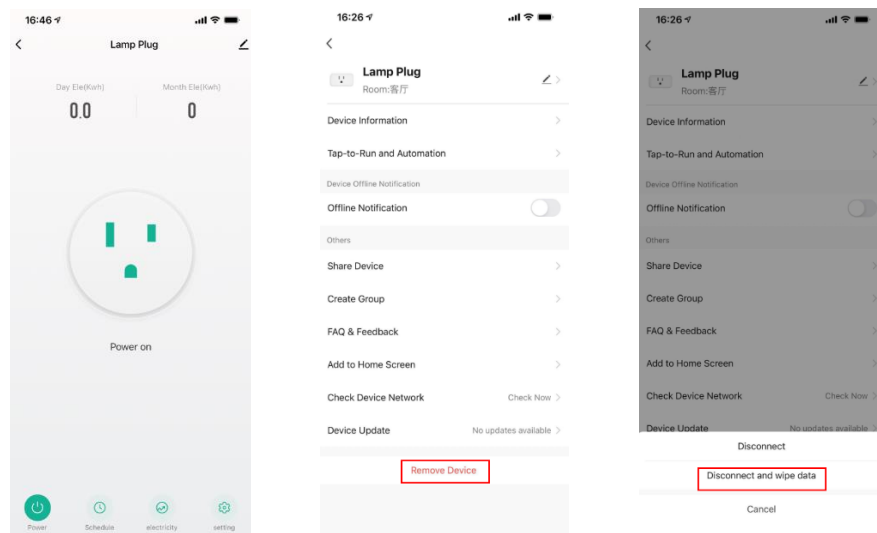

US 15A Smart Plug instruction

10.Function introduction

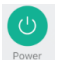

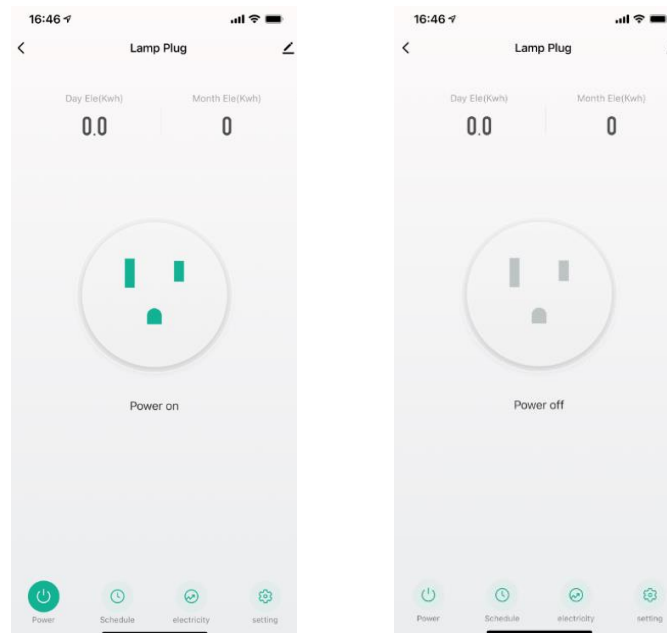
a.Tap the 'switch' icon  to achieve one-key switch on, switch off, remote on-off control

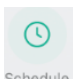

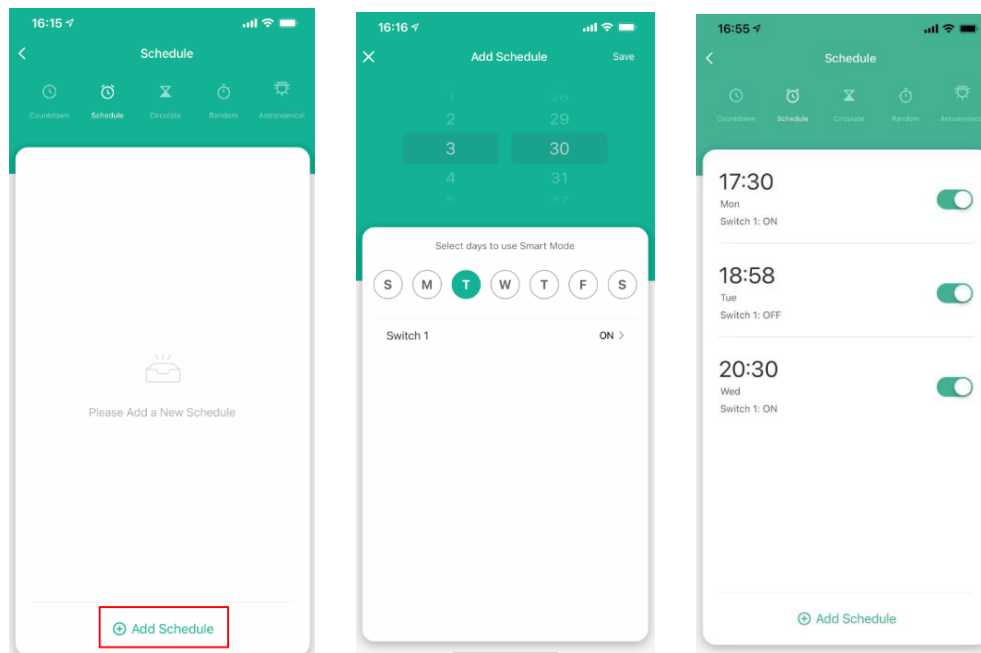

b.Click the 'Schedule' icon , users can set multiple automatic power on/power off according to their habits

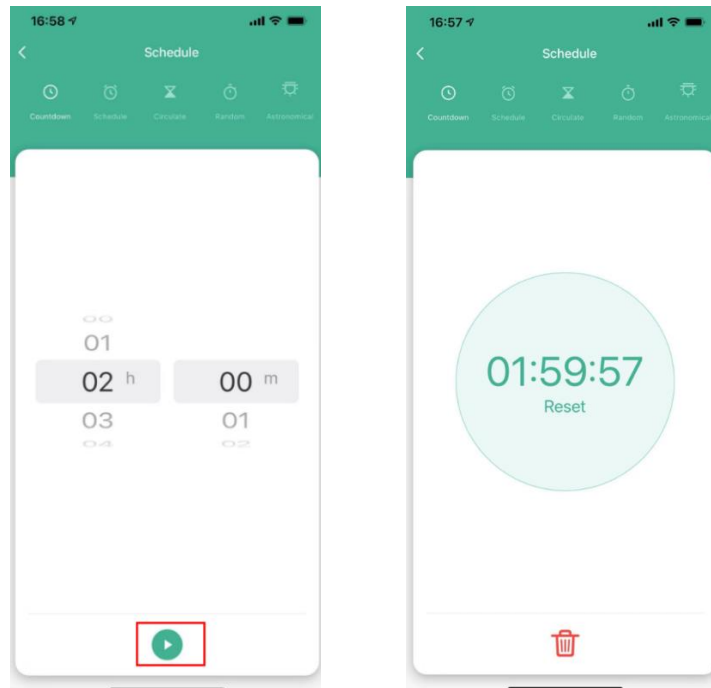

US 15A Smart Plug instruction

c. When the plug is in the state of power on/Power off, click the 'countdown' icon , choice the right time(support 00 hour 00 minute to 23 hours 59 minutes setting), click ' 



d. meanwhile, in the schedule interface, also you can enter the circulate  and Random  to set your private plan.

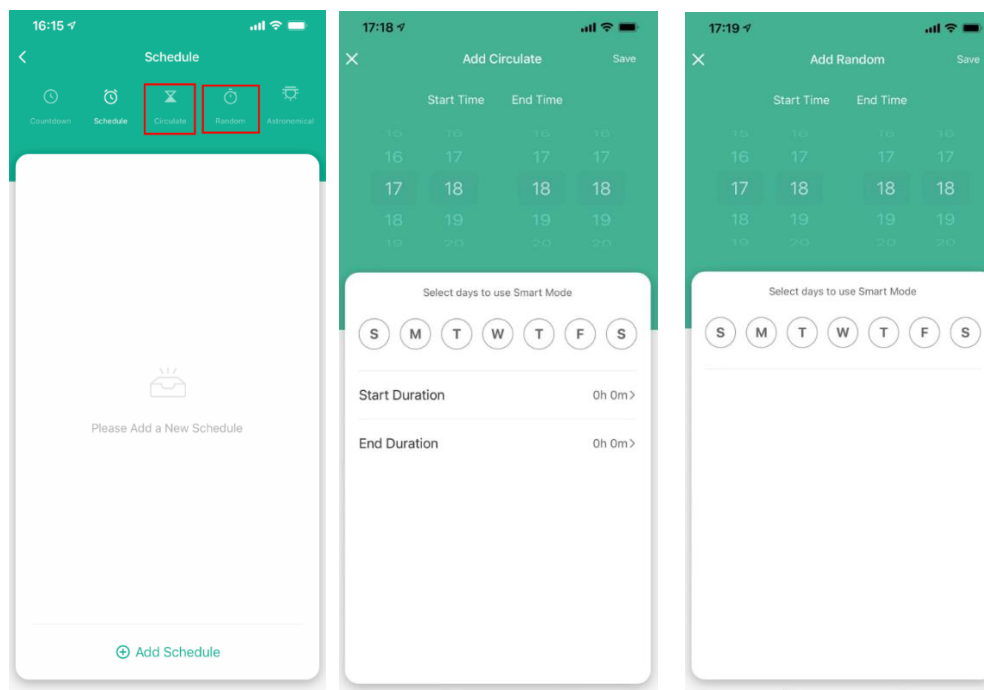

US 15A Smart Plug instruction

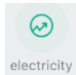

e. Click the 'electricity' icon  enter the power monitoring, provide users with visual power monitoring and statistics, also you can enter the operation monitoring to find all operating records of your device.

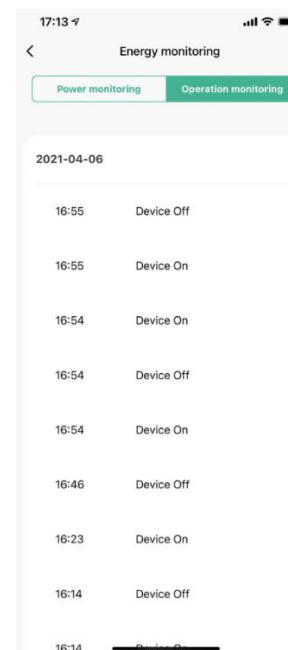
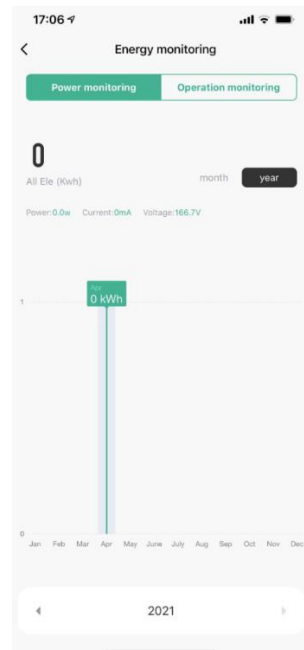
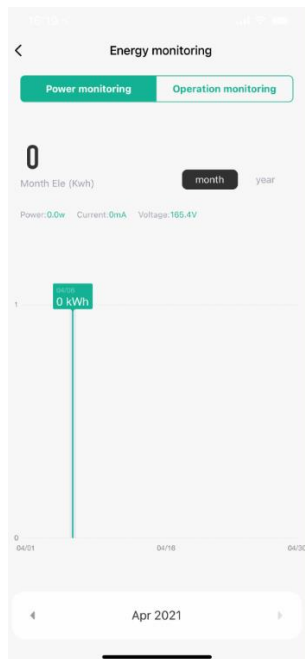

f. Support many third-party platform resources access control, Back to the home interface ,



click the icon  at right to enter the list of third-party support, users can selectively through the third-party platform authorization login access and voice control

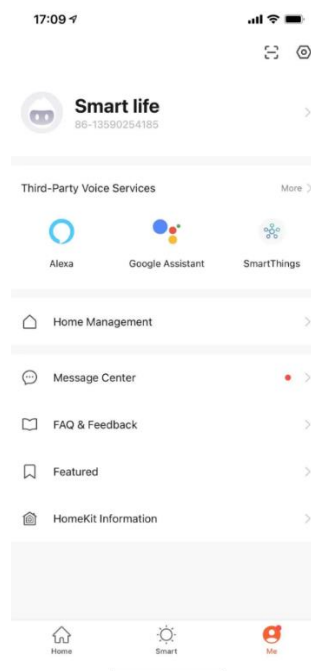

You imagine we create

Longhorn

Help you beautiful life more easy

