

# Intelligent sleep monitor (WiFi)

## instruction manual

SY58001

Thank you for choosing our smart products, which will bring you comfort and convenience. In order to enable you to better install and use this product, here we remind you to carefully read this instruction manual. If you have any questions, please visit our website [www.iksonya.com](http://www.iksonya.com), we will serve you wholeheartedly.

### I. Product profile and characteristics

SY58001 TightSleep intelligent sleep monitor is one of the series of intelligent products of IK.Sonya, which can realize all-around sleep monitoring with multi-dimensional data collection of heart rate, breathing rate, body movement, turning over, leaving bed, deep and shallow sleep, sleep duration, sleep abnormality and so on. It can realize remote and real-time view of dynamic sleep analysis data, alarm information, quality report and periodic data through the exclusive mobile phone app. Its characteristics are as follows:

- ◆Real-time accurate measurement and monitoring of heart rate and respiratory rate ;
- ◆Body movement and abnormal state in / off bed judgment;
- ◆Mobile phone alarm of abnormal status, notification of people for help;
- ◆Intelligent record of sleeping state, healthy life hints;
- ◆Safe and senseless design, sleep comfortably and unfettered;
- ◆The night lights are turned on / off, to illuminate the way under feet.

### II. Product diagram

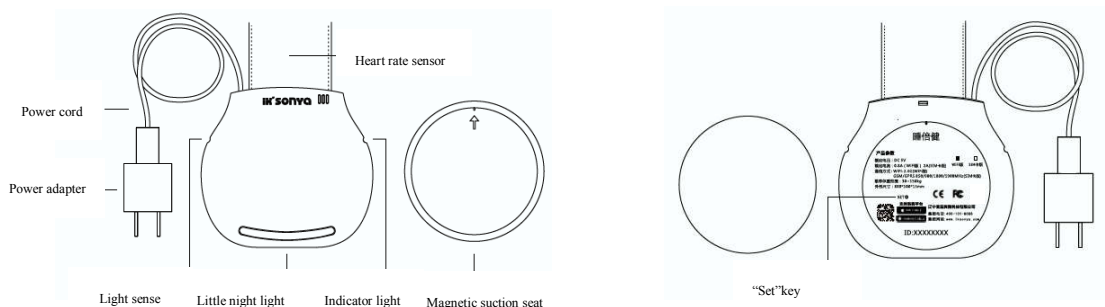

Intelligent sleep monitor (WiFi)

### III. Installation mode and requirements

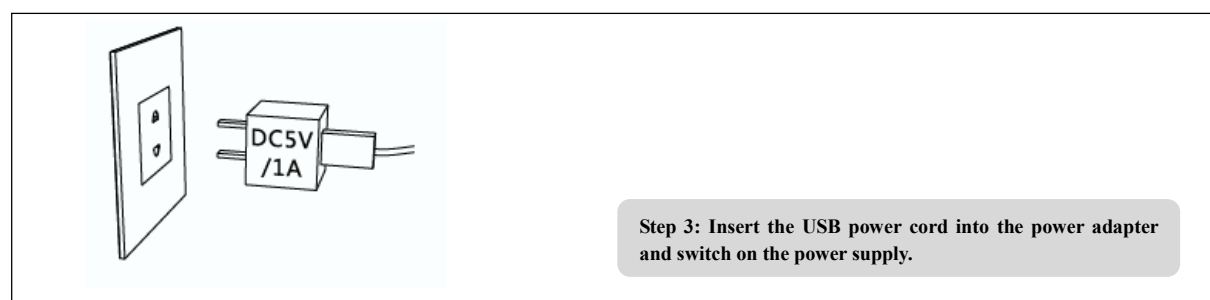
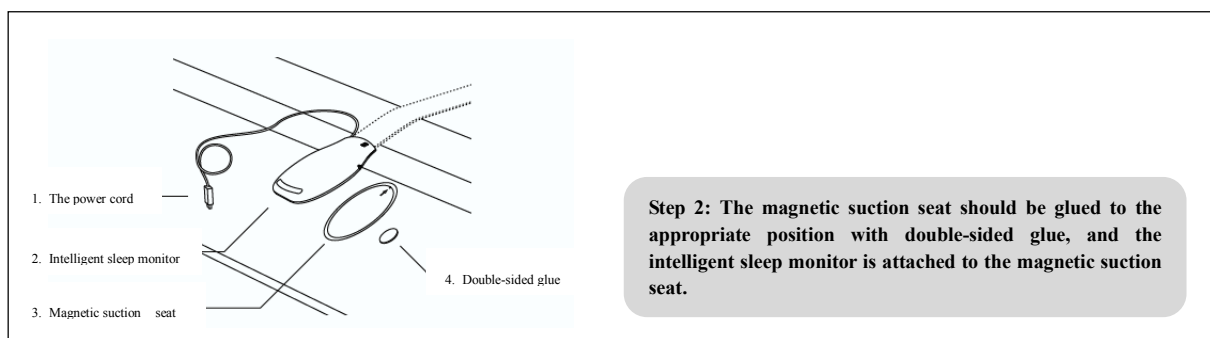
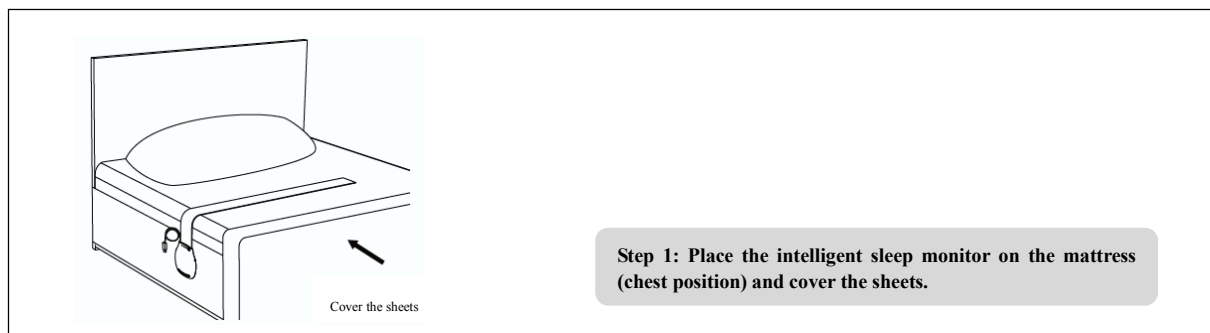

## IV. Method of use

### (I) Habitable Life APP download method

Download APP

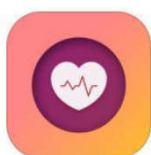

### (II) Intelligent APP adding device

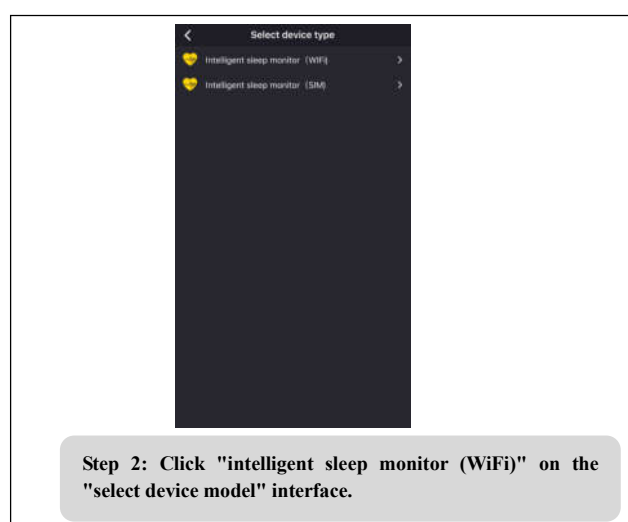
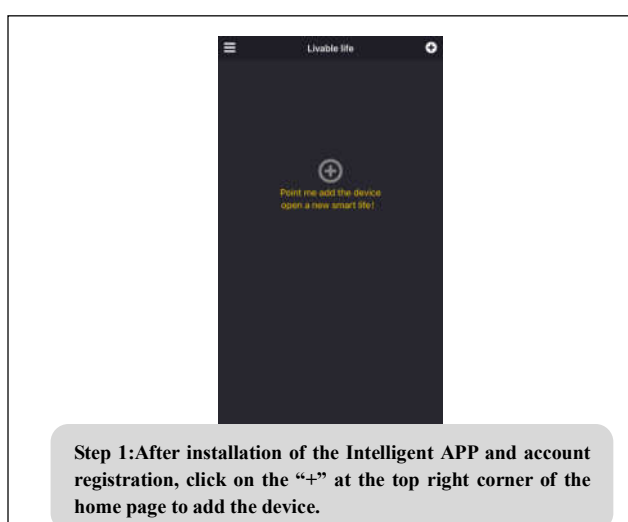

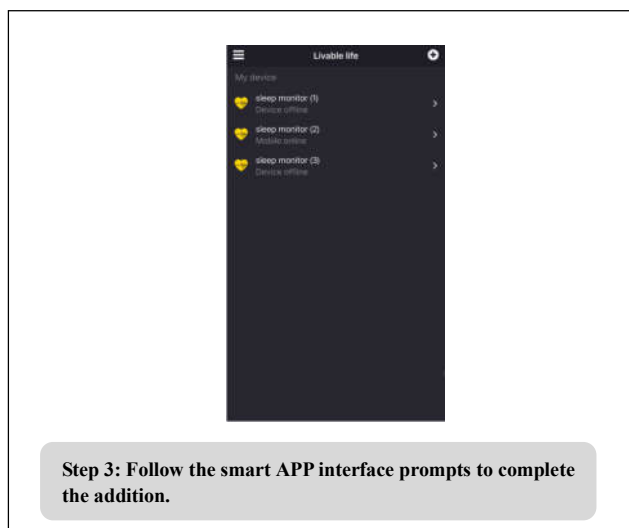

### (III) Light status description

Function	Indicator state
Switch (the power) on	Continuous green light, extinguished in 3 seconds
communicating	Red light flickers
Connecting to the network	Green light flickers
Add device	Continuous Green light

## V. Technical parameters

Outside dimensions: 880mm×100mm×15mm;

Rated voltage: DC5V;

Rated current: 0.8A;

Mode of communication: WiFi 2.4G;

Product weight: 200g.

## VI. Matters needing attention

Please use the original factory adapter;

Please place this product in a fixed position to prevent falling;

No force to bend the heart rate sensor;

It is forbidden to use this product in the environment of high temperature, high pressure, high humidity and strong magnetic field.

## VII. Packing list

An intelligent sleep monitor;

A power adapter;

A setting needle;

A magnetic suction seat;

An instruction manual;

A product warranty card;

A certificate of qualification (affixed to the product).

## **FCC Warning:**

This equipment has been tested and found to comply with the limits for a Class B digital device, pursuant to part 15 of the FCC Rules. These limits are designed to provide reasonable protection against harmful interference in a residential installation. This equipment generates, uses and can radiate radio frequency energy and, if not installed and used in accordance with the instructions, may cause harmful interference to radio communications. However, there is no guarantee that interference will not occur in a particular installation. If this equipment does cause harmful interference to radio or television reception, which can be determined by turning the equipment off and on, the user is encouraged to try to correct the interference by one or more of the following measures:

- Reorient or relocate the receiving antenna.
- Increase the separation between the equipment and receiver.
- Connect the equipment into an outlet on a circuit different from that to which the receiver is connected.
- Consult the dealer or an experienced radio/TV technician for help.

Caution: Any changes or modifications to this device not explicitly approved by manufacturer could void your authority to operate this equipment.

This device complies with part 15 of the FCC Rules. Operation is subject to the following two conditions: (1) This device may not cause harmful interference, and (2) this device must accept any interference received, including interference that may cause undesired operation.

The device has been evaluated to meet general RF exposure requirement. The device can be used in portable exposure condition without restriction.