

封面

封底

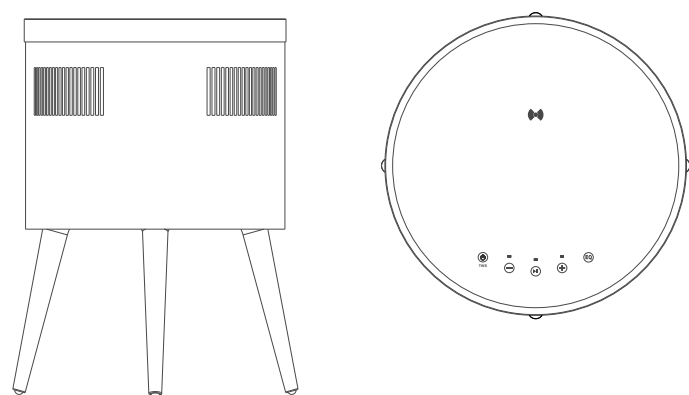

User's Manual
ST-180MCM-G
SMART HOME SPEAKER & CHARGING TABLE

LIMITED ONE-YEAR CONSUMER WARRANTY WITH PROOF OF PURCHASE (cont.)

IN ORDER FOR THE ONE-YEAR WARRANTY TO BE VALID, YOUR UNIT MUST BE SHIPPED WITH PROOF OF PURCHASE FROM A SOUNDSTREAM AUTHORIZED RETAILER. ALL UNITS RECEIVED BY SOUNDSTREAM FOR WARRANTY REPAIR WITHOUT PROOF OF SOUNDSTREAM AUTHORIZED DEALER INSTALLATION AND PURCHASE WILL BE COVERED BY THE LIMITED 90-DAY WARRANTY.

BY PURCHASING THIS PRODUCT, ALL WARRANTIES INCLUDING BUT NOT LIMITED TO EXPRESS WARRANTY, IMPLIED WARRANTY, WARRANTY OF MERCHANTABILITY, FITNESS FOR PARTICULAR PURPOSE, AND WARRANTY OF NON-INFRINGEMENT OF INTELLECTUAL PROPERTY ARE EXPRESSLY EXCLUDED TO THE MAXIMUM EXTENT ALLOWED BY LAW, AND SOUNDSTREAM NEITHER ASSUMES NOR AUTHORIZES ANY PERSON TO ASSUME FOR IT ANY LIABILITY IN CONNECTION WITH THE SALE OF THE PRODUCT. SOUNDSTREAM HAS ABSOLUTELY NO LIABILITY FOR ANY AND ALL ACTS OF THIRD PARTIES INCLUDING ITS AUTHORIZED DEALERS OR INSTALLERS. BY PURCHASING THIS PRODUCT, THE CONSUMER AGREES AND CONSENTS THAT ALL DISPUTES BETWEEN THE CONSUMER AND SOUNDSTREAM SHALL BE RESOLVED IN ACCORDANCE WITH CALIFORNIA LAWS IN LOS ANGELES COUNTY, CALIFORNIA. Some states do not allow limitation on how long an implied warranty lasts. In such states, the limitation or exclusions of this Limited Warranty may not apply. Some states do not allow the exclusion or limitation of incidental or consequential damages. In such states, the exclusion or limitation of this Limited Warranty may not apply to you. This Limited Warranty gives you specific legal rights, and you may have other rights which vary from state to state.



ST-180MCM-G
SMART HOME SPEAKER & CHARGING TABLE

What's in the Box

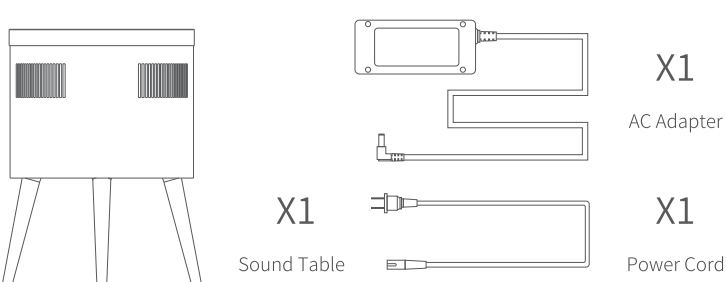

Specifications

Drive units: Subwoofer: 6.5" 4Ω 40W x 1 + Full range: 2.75" 8Ω 15W x 2 + Tweeter: 31mm 6Ω 10W x 2
RMS: 65W (15W*2 + 35W)
Bluetooth frequency: 2.402-2.480GHz
Frequency range: 45Hz-18KHz
S/N: ≥75dB
Separation ratio: ≥55dB
Bluetooth version: 4.2
Bluetooth transmit distance: 10m
Operating voltage: DC 18V ± 3.5A
USB Charging Port: DC 5V ± 2.4A
Wireless charger output: 5W (5V ± 1A)
Wireless charger frequency range: 111-205KHz
Audio input: Bluetooth, Aux-in
Aux-in: 3.5mm Stereo Plug
Material: MDF with tempered glass, PC+Nylon middle part with 100% Cationic Polyester mesh, Metal ring, Solid wood legs
Diameter: 410mm
Height: 665mm (1 layer)

Assembly instructions

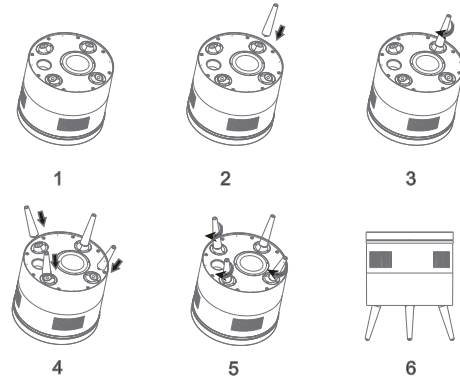

1. Open the box, put the speaker with the fixed holes upwards.
Remark: (please put the speaker on the a soft surface to protect the top panel from scratching)
2. Take one of legs and match it with one fixed hole.
3. Screw in rotating clockwise until tightly fixed.
4. To fix the other 3 legs follow same procedure.
5. Make sure that all four legs are correctly screwed in.
6. Place the speaker on the ground legs down, and it is ready to use now.

Warning:

1. The maximum load weight of this product is 33lb (15kgs). Please do not put any more weight than maximum load as damage to unit and top glass can occur and void any warranty.
2. Please do not sit on table top. It is not safe and not designed to be a seat.

Description of the product

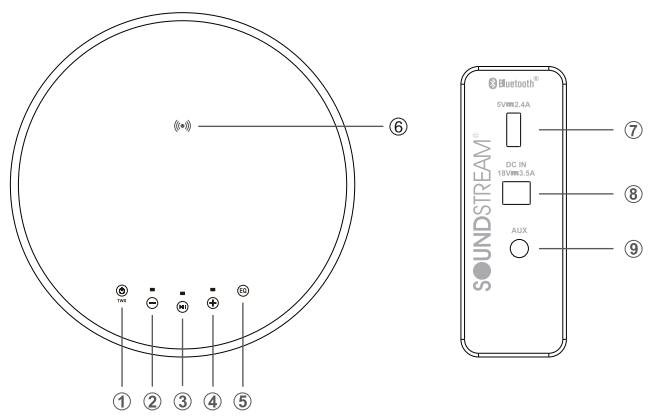

1. Power ON / OFF / TWS
2. Volume -
3. Play / Pause
4. Volume +
5. EQ (POP, ROCK, MOVIE)
6. Wireless charger symbol
7. USB charging port (DC 5V ± 2.4A)
8. DC IN (power socket)
9. AUX-in

Power ON / OFF

1. Connect the AC adapter with the speaker's DC socket (please make sure you use the original AC adapter comes with the speaker), you can hear the voice "Power On" from speaker prompt, the speaker will auto-start and enter Bluetooth mode as default, and sound "Bluetooth, waiting for connection", the smart phone or other Bluetooth devices can be paired with speaker.

Warning:

Please use the original A/C adapter for charging, if not, it may cause the charger to be charged slowly or cannot be charged at all. In extreme cases, A/C adapter will be burned out or other accident occurred!

2. Long press [POWER] button, the speaker will be turned on, you will hear the voice of "Power On" from speaker prompt, and it will enter Bluetooth mode with voice of "Bluetooth, waiting for connection".

3. Long press [POWER] button, the speaker will be turned off, you will hear the voice of "Power Off" from the speaker prompt.

AUX Auto Switch

Insert the AUX cable into the AUX socket at the rear panel of the speaker, the speaker will switch to AUX mode automatically, the green LED light will be on. The Bluetooth mode will be switched Off automatically. After taking out the AUX cable, the Bluetooth mode will be switched on automatically. Then you will hear the voice "Bluetooth, waiting for connection".

Bluetooth Connection and Play (LED indicator: the left LED light)

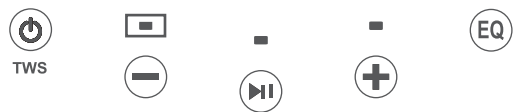

1. When the speaker is in Bluetooth mode, it will automatically switch to pairing state, the blue LED light will flash quickly, the Bluetooth device name is "Sound Table".
2. The speaker will pair with a smart phone via Bluetooth, the speaker will sound "Bluetooth is connected" after pairing, the blue LED light will be always on. If connection failed, the blue LED light will flash quickly and you need to retry.
3. When playing music after connecting with smart phone via Bluetooth, the speaker will pause if short press [Play/Pause], it will play after short press [Play/Pause] again.
4. When this speaker is connected with smart phone, long press the button [Play/Pause], the speaker will switch off the connection with the paired mobile phone, you can hear the voice of "Bluetooth Disconnected, waiting for connection", another smart phone can connect "Sound Table" via Bluetooth.

EQ Switch (LED indicator: the Middle light)

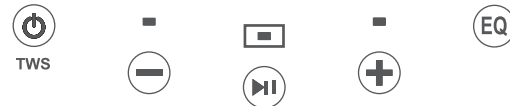

When the speaker is powered on, the speaker will enter normal mode as default, the LED light will not be illuminated. The speaker will enter POP mode with a short press [EQ], the RED LED light will be illuminated. The speaker will enter Rock mode with a short press again; the GREEN LED light will be illuminated. The speaker will enter Movie mode with a short press again; the LED light will be LIME color. The speaker will enter normal mode by pressing one more time.
EQ light Indicator
Red ---- Pop
Green ---- Rock
Lime ---- Movie

Voice Reminder:

1. POWER ON: Connecting the power supply (voice prompt when the speaker turns on).
2. Bluetooth: Bluetooth mode
3. POWER OFF: Shut off the power supply (voice prompt when the speaker turns off).
4. Waiting for connection: Pairing (enter Bluetooth mode, and back to Bluetooth mode).
5. Bluetooth is connected: pairing successfully, back to Bluetooth Mode successfully.
6. Bluetooth Disconnected, wait for connection: switch off the connection with the paired mobile phone (long press [Play/Pause]) to disconnect Bluetooth).
7. Maximum volume: Max volume level is 30.

Volume Control

1. Press [+] button to increase the volume, the white LED flash (when speaker turns on volume level 10 is default volume. in total, Max volume level is 30), you can hear the voice prompt "Maximum volume" when volume is at max.
2. Press [-] button to decrease the volume level, the white LED is flash.

Automatic Power Off

After power on the speaker, if no Bluetooth connection, no LINE IN signal, or disconnect the Bluetooth after 10 minutes, the speaker will be powered off automatically, the speaker will sound "POWER OFF"

USB Charging

When the speaker is powered on, the USB port can charge iPhone or Android mobile phones. USB port output is DC 5V ± 2.4A.

Remark:

The USB port (DC 5V ± 2.4A) can charge iPhone and other Android mobile phone even under Power off status if the A/C adapter connected to a power outlet.

Wireless charging

1. If you have a smart phone with wireless charging capability (Qi Charging), you can charge it by placing the phone on the engraved inductive symbol for wireless charging.
2. The symbol is located on the top of the speaker table.
3. Make sure to place your smart phone centered within the charging symbol. If there is charging connection, you will hear a short acoustic signal. You can remove your smart phone from the charging area at any time to end the charging process.
Remark: The wireless charger can charge iPhone and Android mobile phone even under Power off status if the A/C adapter connected with power.

TWS function (LED indicator: the right LED light)

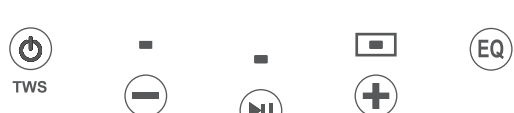

TWS feature allows you to link two sound tables together. The first table will be the master connected to the Bluetooth device and operate all controls. The second table is a linked speaker giving True Wireless Sound.

1. Turn on the first sound table and second sound table. Double click [POWER/TWS] on both tables, the speakers will enter team pairing mode, you will hear an acoustic signal, the orange LED will flash rapidly at the same time. After the team pairing, the orange LED of first sound table (Master) will remain always light, the LED of second sound table (linked TWS) will slow flash.
2. When speakers are team paired successfully, short press [POWER/TWS] one time, to switch Off the team pairing TWS mode.
3. When tables are team paired TWS mode successfully under Bluetooth, the two speakers can still work as a paired speakers by inserting the AUX cable into the AUX socket on the first sound table (Master). TWS mode will fail if Aux cable is inserted to the Aux socket on the second (linked) sound table.

Remark: While the sound tables are set to TWS mode, the EQ function of master speaker and sub-speaker has to be adjusted by each speaker's EQ button.

NOTE

This product complies with the radio interference requirements of the European Community.

This product is designed and manufactured with high quality materials and components, which can be recycled and reused.

This symbol means the product must not be discarded as household waste, and should be delivered to an appropriate collection facility for recycling. Proper disposal and recycling helps protect natural resources, human health and the environment. For more information on disposal and recycling of this product, contact your local municipality, disposal service, or the shop where you bought this product.

FCC STATEMENT :

This device complies with Part 15 of the FCC Rules. Operation is subject to the following two conditions:

- (1) This device may not cause harmful interference, and
- (2) This device must accept any interference received, including interference that may cause undesired operation.

Warning: Changes or modifications not expressly approved by the party responsible for compliance could void the user's authority to operate the equipment.

NOTE: This equipment has been tested and found to comply with the limits for a Class B digital device, pursuant to Part 15 of the FCC Rules. These limits are designed to provide reasonable protection against harmful interference in a residential installation. This equipment generates uses and can radiate radio frequency energy and, if not installed and used in accordance with the instructions, may cause harmful interference to radio communications. However, there is no guarantee that interference will not occur in a particular installation. If this equipment does cause harmful interference to radio or television reception, which can be determined by turning the equipment off and on, the user is encouraged to try to correct the interference by one or more of the following measures:

- Reorient or relocate the receiving antenna.
- Increase the separation between the equipment and receiver.
- Connect the equipment into an outlet on a circuit different from that to which the receiver is connected.
- Consult the dealer or an experienced radio/TV technician for help.

FCC Radiation Exposure Statement:

This equipment complies with FCC radiation exposure limits set forth for an uncontrolled environment. This equipment should be installed and operated with minimum distance 20cm between the radiator & your body.

LIMITED ONE-YEAR CONSUMER WARRANTY WITH PROOF OF PURCHASE

Soundstream promises to the original purchaser, to repair or replace this product with a new or refurbished unit (at Soundstream's sole and absolute discretion) should it prove to be defective in workmanship or material under normal use, for a period of one-year from the date of purchase from the Soundstream authorized retailer, PROVIDED the product was purchased from a Soundstream authorized retailer. During this one-year period, there will be no charge for product repair or replacement, PROVIDED the unit is returned to Soundstream, return shipping pre-paid, along with the required bill of sale or other dated proof of purchase, and the consumer's contact information.

If the unit is sold by anyone other than a Soundstream authorized retailer, the warranty period will be 90-days from the date of purchase. This warranty is nontransferable and does not apply to any unit that has been modified or used in a manner contrary to its intended purpose, and does not cover damage to the unit caused by installation or removal of the unit. During this 90-day period, there will be no charge for the repair or replacement PROVIDED the unit is returned to Soundstream, return shipping pre-paid, along with the bill of sale or other dated proof of purchase and the consumer's contact information.

This warranty is void if the product has been damaged by accident or unreasonable use, neglect, improper service or other causes not arising out of defects in materials or construction. This warranty does not cover the elimination of externally generated static or noise, or the correction of antenna problems or weak reception, damage to speakers, accessories, electrical systems, cosmetic damage or damage due to negligence, misuse, failure to follow operating instructions, accidental spills or customer applied cleaners, damage due to environmental causes such as floods, airborne fallout, chemicals, salt, hail, lightning or extreme temperatures, damage due to accidents, road hazards, fire, theft, loss or vandalism, damage due to improper connection to equipment of another manufacturer, modification of existing equipment, or Product which has been opened or tampered for any reason. Units which are found to be damaged by abuse resulting in thermally damaged voice coils are not covered by this warranty but may be replaced at the absolute and sole discretion of Soundstream. Unit must be returned to Soundstream, postage pre-paid, with bill of sale or other dated proof of purchase bearing the following information: consumer's name, telephone number, and address, authorized retailer's name and address, and product description. Please contact Soundstream warranty office at 800-724-1377, email to repairs@soundstream.com, or visit Soundstream.com/warranty to obtain a Return Authorization Number prior to shipping the product.