

User Manual

Smart Wall Light

BSWS

Part 1 – How to install the Wall Light

Warnings and cautions

- (1) All parts must be used as indicated in these instructions. This product is designed for use only with the supplied parts and/or accessories designated for use by manufacturer. Substitution of parts or accessories not designated for use with this product by manufacturer could result in personal injury or property damage, and will void the warranty. Contact an authorized dealer or the manufacturer if any parts are damaged or missing.
- (2) Make sure to cut off power before installation
- (3) If there is any damage to the cord, Please cut off the power and stop using it immediately
- (4) Suitable for general outdoor use.
- (5) Do not submerge in water.
- (6) This product is not a toy and is not designed for use by children.
- (7) For safety reasons and under the terms of the warranty, the enclosed device should not be opened
- (8) In case of explosion. Please keep the light away from fire and high temperature.

Specification

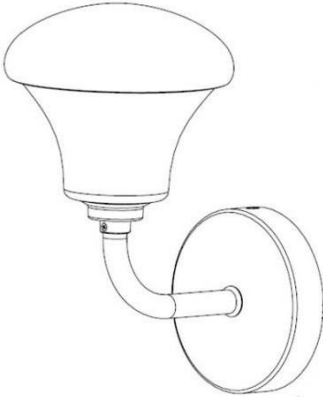
SKU	BSWS	
Input Voltage	120V, 50/60HZ	
Input Wattage	12-watt	
Output Wattage	RGB, 3-watt of each color. W, 10-watt	
Color	RGBW	
Light output	650 Lumen at 3000K, 80+CRI	
IP rating	IP44	
Use temperature	-20~40°C	
Warranty	2-year	

Components

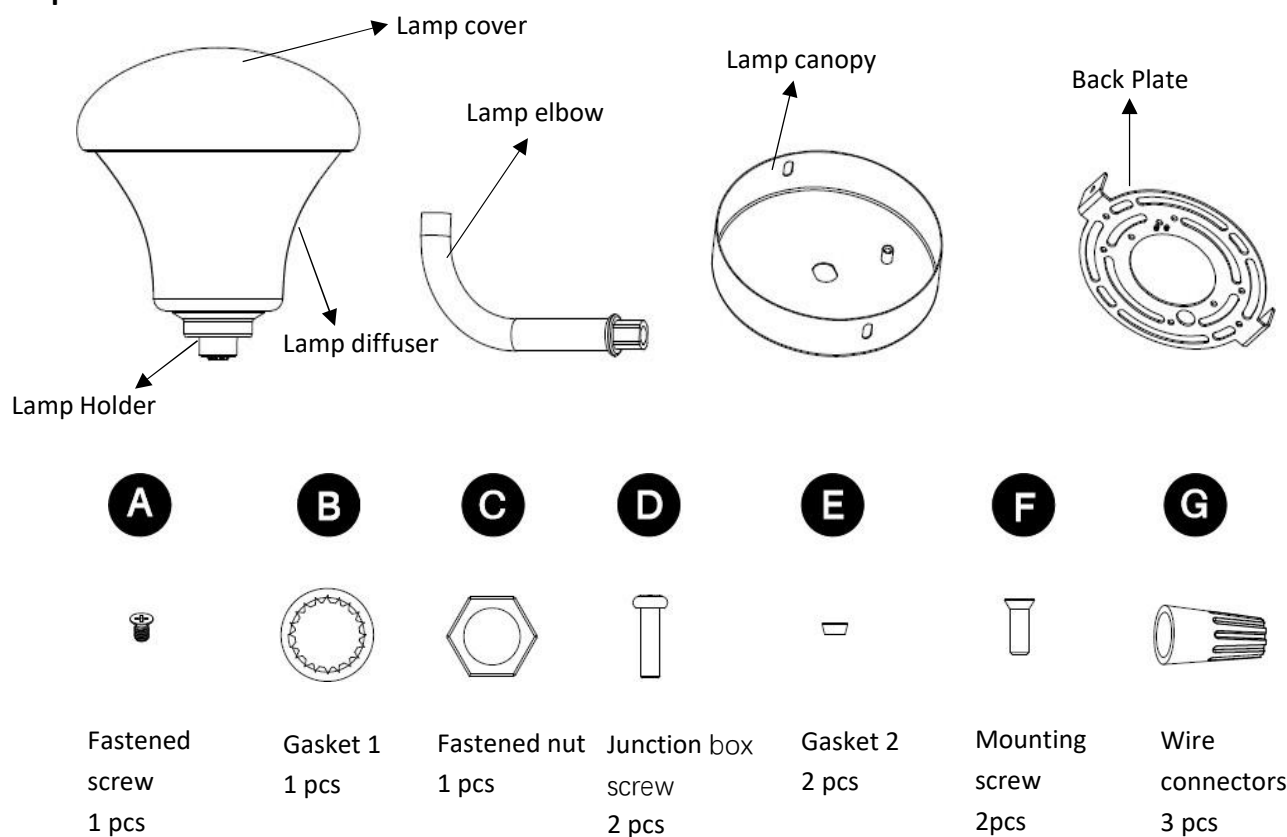

Installation

Step 1, Lamp assembly

- (1) , Pass the power cord through lamp Elbow(1a).
- (2) , Fasten the lamp elbow to lamp holder via fastened Screw (1b).
- (3) , Fasten the lamp elbow to lamp canopy(2a).
- (4) , Seured the Gasket(B) and Fastened Nut(C) to lamp canopy, make sure the gasket(B) be well secured(2b).

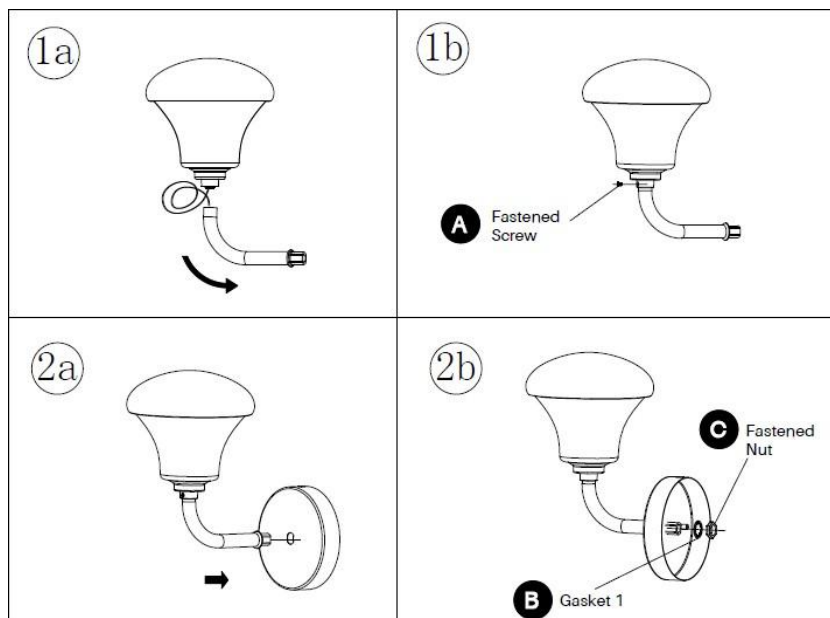

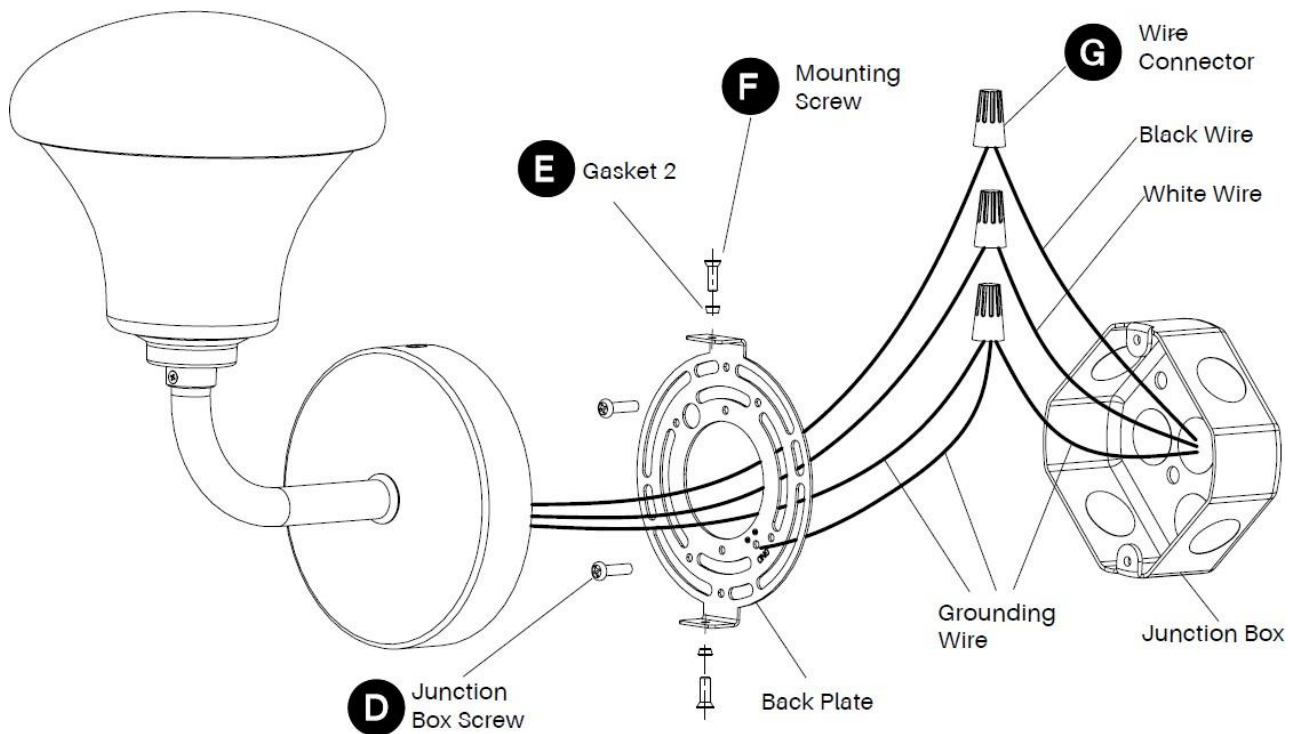

Fig.3

Step 2, mount the lamp fixture

- (1) Secure the back plate to the junction box with junction box screw (D),
- (2) Do the wiring connection with wire connectors (G) and following the indication of fig.3 and fig.4.
- (3) To prevent moisture/water from entering the outlet box and causing a short, use clear caulking (i.e. outdoor silicone sealant) to outline the outside of lamp canopy where it meets the wall. Leave a space at the bottom to allow moisture to escape (Fig.5).

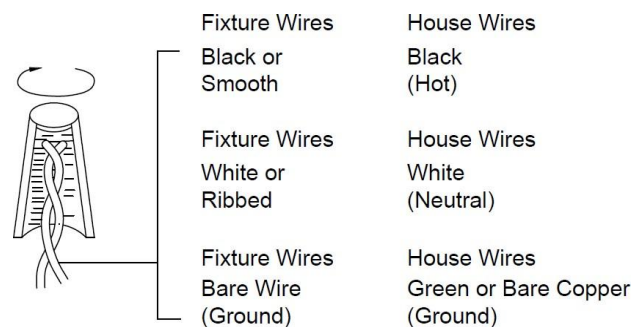

Fig.4

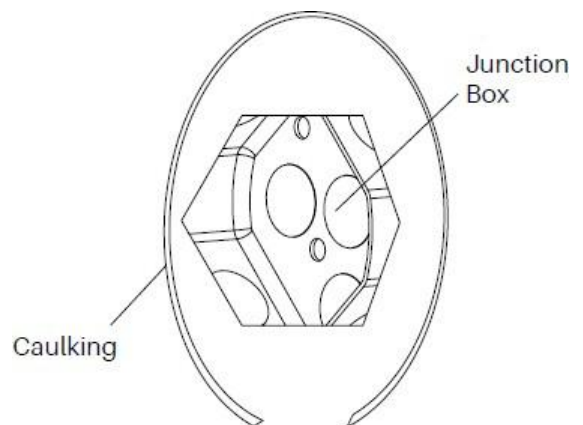

Fig.5

Part 2 – How to Control the wall light with APP ‘Happy Lighting’

Note

- (1) The farthest distance for the mobile phone APP to control the smart lights is no more than 32ft(10m) , to control the light efficiently please make sure that all lights are within 32ft(10m) of your phone.
- (2) Phone APP can control up to 8 pcs the smart lights at the same time, you are able to preset the colors and modes according to your preference

Step 1, APP Installation

- (1) Scan the QR code as the right to download the APP
- (2) Or Search ‘Happy Lighting’ and download the APP in Apple Store or Google Player.



Step 2, Bluetooth Connection

NOTE: Please following the below steps for the first time to use this APP.

- (1) Please enter your phone settings, open the Bluetooth. Note:
For Android phone, also need the Location Services.
- (2) Open the ‘Happy Lighting app’, the app will auto to scan and connect the device.

Step 3, User interface operation

- (1) ‘Adjust’ Button function Specification and operation. In this interface you can select the color you want and adjust the brightness

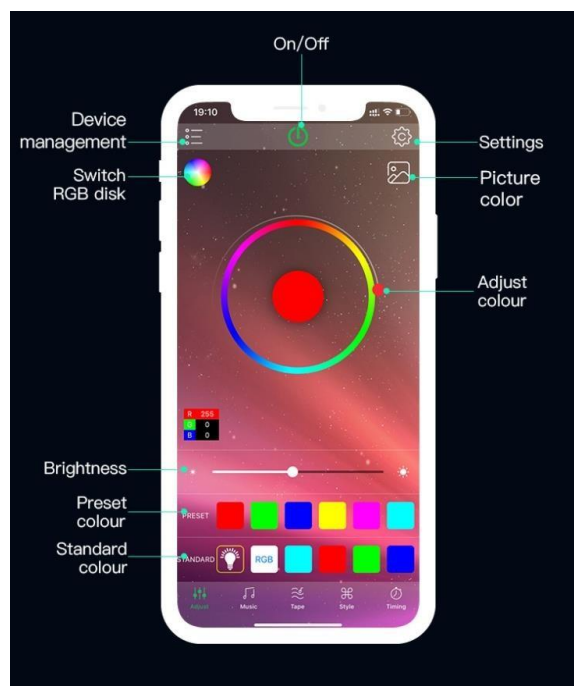
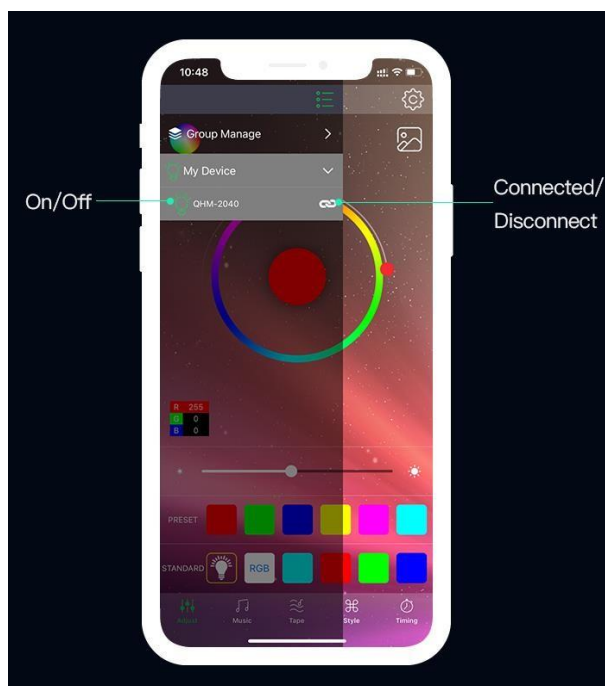

(2) 'Music' button function specification and operation.

Play the music you like that the light will change to sync the music

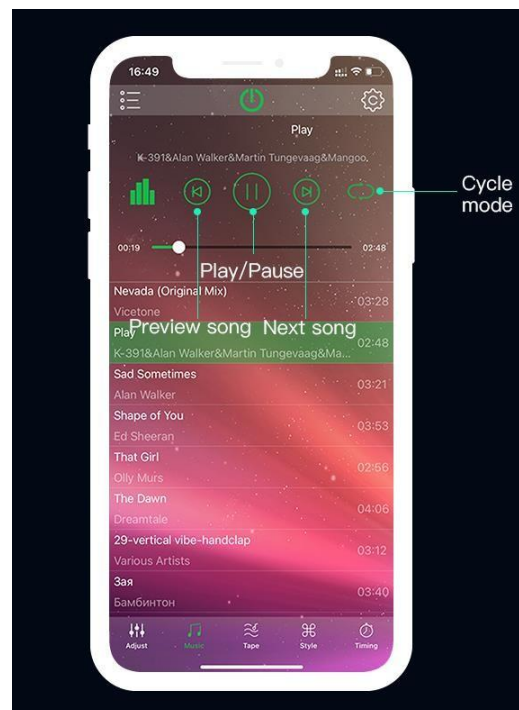

(3) 'Tape' button function specification and operation.

The light color will sync the voice or any environment voice via your phone. You can change the microphone sensitivity as your need.

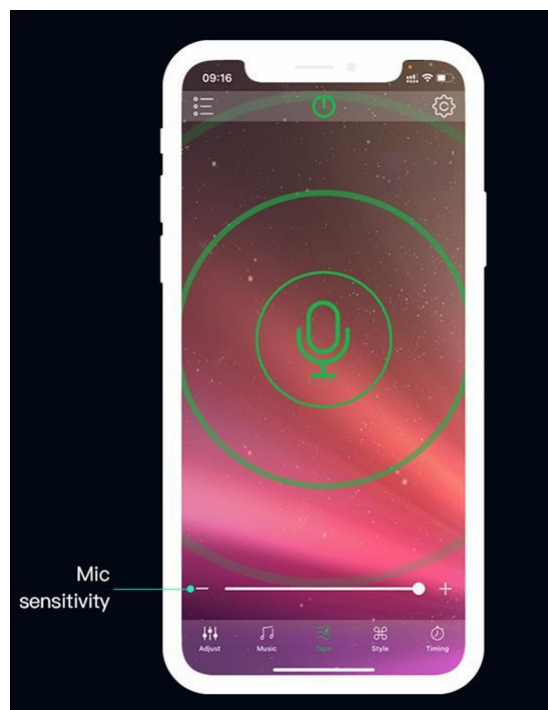

(4) 'Style' button function specification and operation.

The light color will change following the default scene you select.

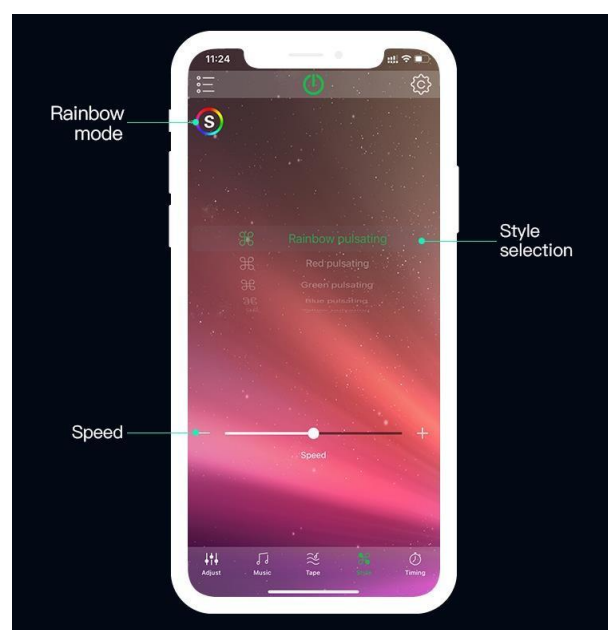

(5) 'Timing' button function specification and operation.

Set the On/off timing as your need, the light will be auto on/off accordingly when it's enable

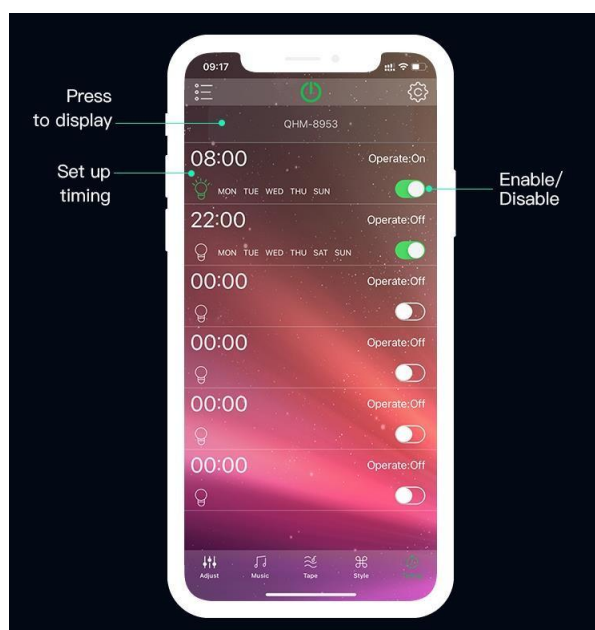

(6) 'Settings' button function specification and operation.

Light color will change accordingly when you shake your phone when 'shake' button is enable

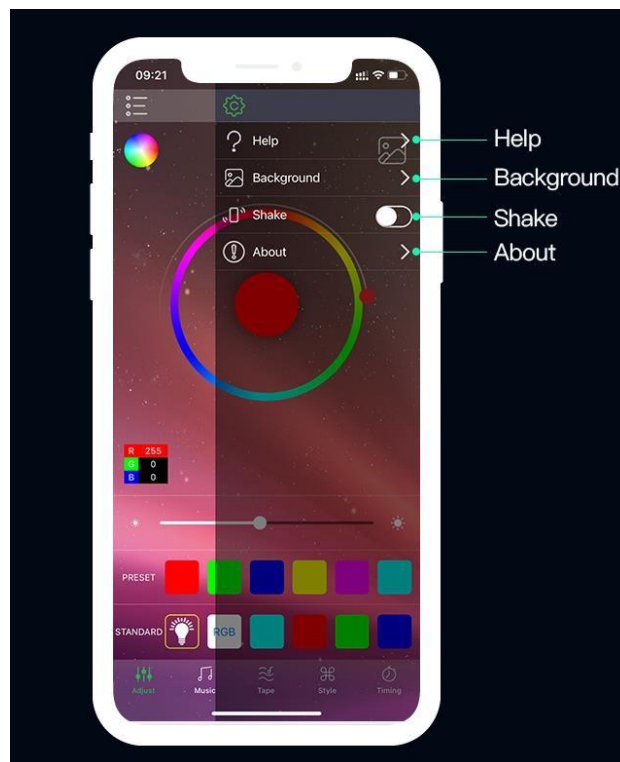

(7) 'Group manage' button function specification and operation.

Note: Max 8 devices adding for each group

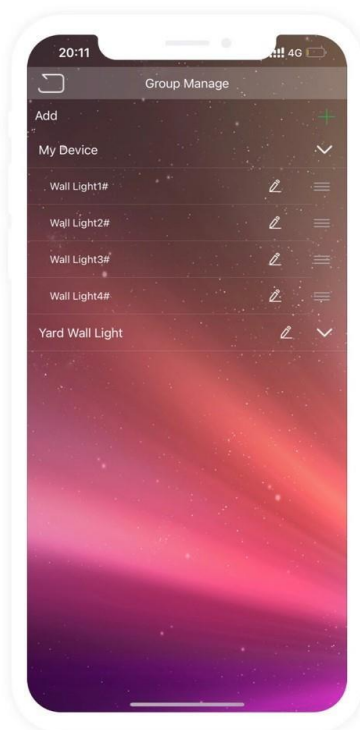

As indicated in red frame, Add New groups, for instant, name 'Yard Wall Light'

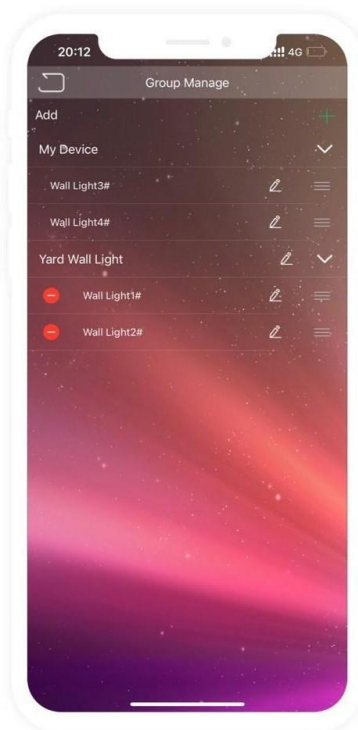

Press the device and drag to the New group 'Yard Wall Light'

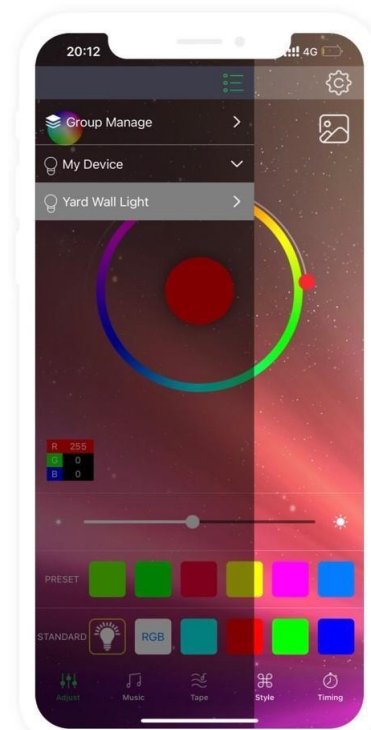

The group can do the same functions with single devices as indicated in No.(1)~(6) of Step 3 'User interface operation'

FCC Statement

This equipment has been tested and found to comply with the limits for a Class B digital device, pursuant to Part 15 of the FCC Rules. These limits are designed to provide reasonable protection against harmful interference in a residential installation. This equipment generates uses and can radiate radio frequency energy and, if not installed and used in accordance with the instructions, may cause harmful interference to radio communications. However, there is no guarantee that interference will not occur in a particular installation. If this equipment does cause harmful interference to radio or television reception, which can be determined by turning the equipment off and on, the user is encouraged to try to correct the interference by one or more of the following measures:

- Reorient or relocate the receiving antenna.
- Increase the separation between the equipment and receiver.
- Connect the equipment into an outlet on a circuit different from that to which the receiver is connected.
- Consult the dealer or an experienced radio/TV technician for help.

This device complies with part 15 of the FCC Rules. Operation is subject to the following two conditions:

(1) This device may not cause harmful interference, and (2) this device must accept any interference received, including interference that may cause undesired operation.

Changes or modifications not expressly approved by the party responsible for compliance could void the user's authority to operate the equipment.

The distance between user and products should be no less than 20cm.