

INSTALLATION INSTRUCTIONS
STRUT - Vacancy/Photo Sensor
 S2SN



CAUTION: TO PREVENT ELECTRICAL SHOCK, ENSURE ELECTRICITY HAS BEEN TURNED OFF AT THE CIRCUIT BREAKER BEFORE BEGINNING.

- Read all instructions before installing.
- System is intended for installation by a licensed electrician in accordance with the National Electrical Code (NEC) and local regulations.
- Retain installation instructions for future maintenance reference.

WARNING: All parts must be used as indicated in these instructions. This product is designed for use only with the supplied parts and/or accessories designated for use by WAC Lighting. Substitution of parts or accessories not designated for use with this product by WAC Lighting could result in personal injury or property damage, and will void the warranty. Contact an authorized dealer or the manufacturer if any parts are damaged or missing.

MISE EN GARDE: POUR ÉVITER TOUT CHOC ÉLECTRIQUE, ASSUREZ-VOUS QUE LE DISJONCTEUR SOIT MIS HORS TENSION AVANT DE COMMENCER.

- Lisez toutes les instructions avant l'installation.
- Le système doit être installé par un électricien licencié conformément au code national de l'électricité (NEC), et également aux règlements locaux.

ATTENTION: Toutes les pièces doivent être utilisées comme indiqué dans ces instructions. Ce produit est conçu pour être utilisé seulement avec les pièces et/ou accessoires fournis pour être utilisés avec les produits WAC Lighting. Remplacer des pièces ou accessoires non conçus pour ce produit WAC Lighting pourrait causer des dommages corporels ou matériels et pourrait également causer l'annulation de la garantie. Veuillez contacter un revendeur autorisé ou le fabricant si des pièces manquent ou sont endommagées.

FCC Radiation Exposure Statement:

This equipment complies with FCC radiation exposure limits set forth for an uncontrolled environment . This transmitter must not be co-located or operating in conjunction with any other antenna or transmitter. Any Changes expressly or modifications not approved by the party responsible for compliance could void the user's authority to operate the equipment. This device complies with part 15 of the FCC Rules. Operation is subject to the following two conditions: (1) This device may not cause harmful interference, and (2) this device must accept any interference received, including interference that may cause undesired operation.

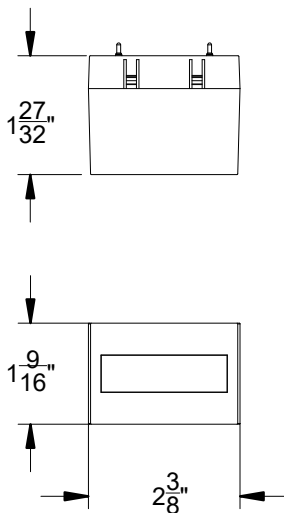

SENSOR OVERVIEW

STRUT Sensor is intended for use on WAC Lighting's STRUT Channel systems.

MODEL	STRUT SYSTEM
S2SN-1-BK	48VDC STRUT System

SPECIFICATIONS	
Input:	48VDC
Installation:	WAC STRUT System
Control:	Via WAC STRUT Connected Power Unit. Refer to CPU Specifications.

waclighting.com
 Phone (800) 526.2588
 Fax (800) 526.2585

Headquarters/Eastern Distribution Center
 44 Harbor Park Drive
 Port Washington, NY 11050

Central Distribution Center
 1600 Distribution Ct
 Lithia Springs, GA 30122

Western Distribution Center
 1750 Archibald Avenue
 Ontario, CA 91760

PREPARATION:

1. Shut off the power at the circuit breaker and ensure adequate room to install the new fixture on the STRUT Channel system.
2. Carefully unpack your new fixture and lay out all the parts on a clear area. Be careful not to lose any parts necessary for installation.

INSTALLATION TO STRUT SYSTEM:

The sensor features a STRUT adapter for power and mechanical connection to the installed STRUT channel system.

1. The sensor is polarity agnostic, and may be installed in STRUT channel in either orientation. (See **FIG. 1**).
2. Insert adapter into channel slot. Ensure the adapter is parallel to the channel during installation. Push the adapter into the channel until fully secured. NOTE: Fixture adapters also feature magnets to aid in fixture locating. (See **FIG. 2**).
3. Review connection, be sure sensor is secured in channel prior to finishing installation.
4. If removal or relocation is desired, remove from channel by gently pulling downwards. (See **FIG. 3**).
5. Commission and calibrate sensor using STRUT app. (See **FIG. 4**).

FIG. 1

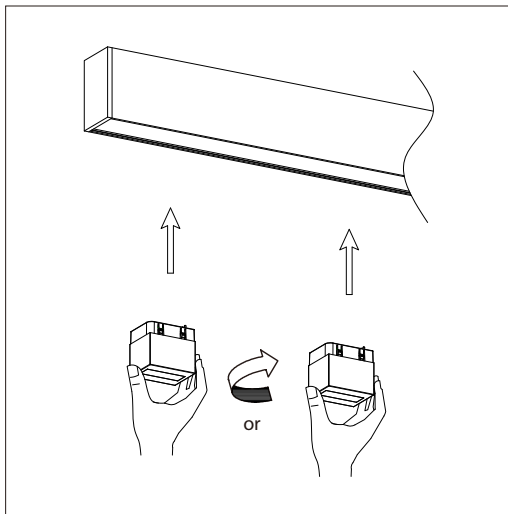

FIG. 2

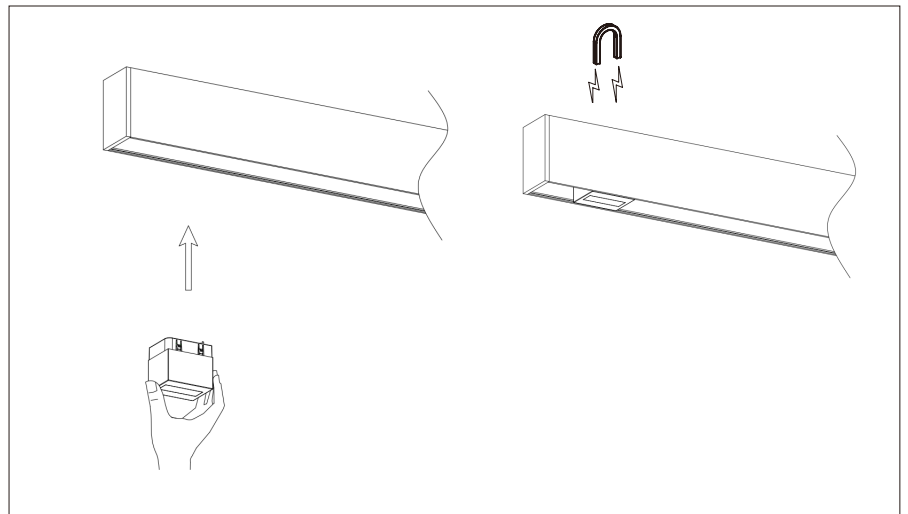

FIG. 3

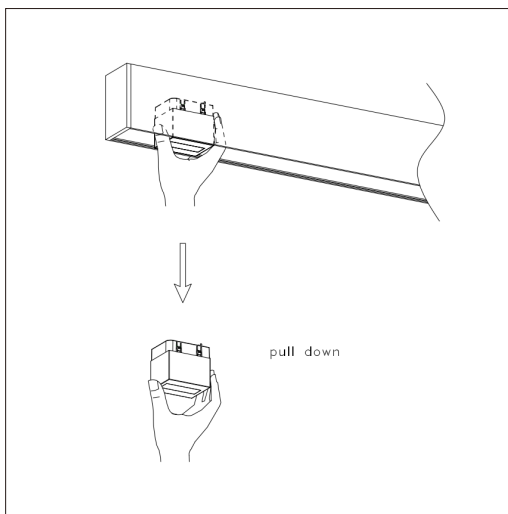
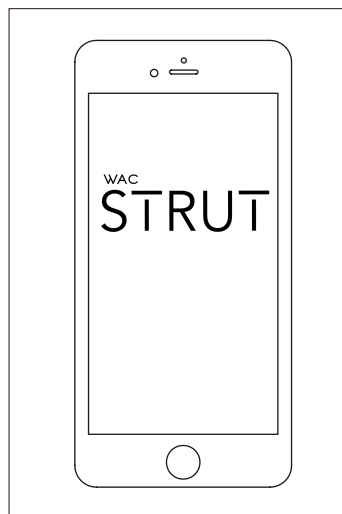

FIG. 4



INTEGRATION INSTRUCTIONS

1. This module has been tested and found to comply with the FCC Part15.245 for Modular Approval.
2. This Modular Approval is limited to OEM installation for mobile and fixed applications only. The antenna installation and operating configurations of this transmitter, including any applicable source-based time- averaging duty factor.
3. The maximum antenna gain is 3.3dBi.For situations where the host manufacturer is responsible for the integral antenna, the integration instructions shall inform the installer that the antenna permanently attached to the unit which used in the host product.
4. When the module is installed in the host device, the FCC ID label must be visible through a window on the final device or it must be visible when an access panel, door or cover is easily removed. If not, a second label must be placed on the outside of the final device that contains the following text: —Contains FCC ID:2APNFWAC000003
5. The Applicant:WAC LIGHTING CO uses various test mode programs for test set up which operate separate from production firmware. Host integrators should contact WAC LIGHTING CO for assistance with test modes needed for module/host compliance test requirements.
6. S2SN-1-BK's module is FCC authorized for the FCC Part15.245 listed on the grant, and that the host product manufacturer is responsible for compliance to any other FCC rules that apply to the host not covered by the product grant of certification. If the grantee markets their product as being Part 15 Subpart B compliant, then the grantee shall provide a notice stating that the final host product still requires Part 15 Subpart B compliance testing with the module installed.
- 7.The module is limited to use in the host.
the limited module manufacturer reviews detailed test data or host designs prior to giving the host manufacturer approval.The limited module manufacturer must state how control of the product into which the modular transmitter will be installed will be maintained such that full compliance of the product is always ensured. For additional hosts other than the specific host originally granted with a limited module, a Class II permissive change is required on the module grant to register the additional host as a specific host also approved with the module.