

SONOFF

DW2-RF

User manual V2.0

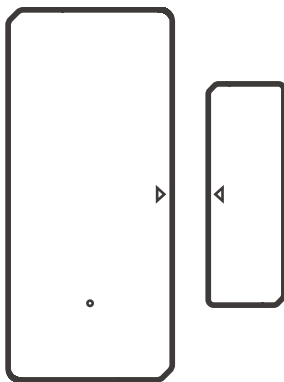

RF Wireless Door/Window Sensor

本设备需要连接SONOFF 433MHz RF Bridge进行智能操作,可与其他产品互联互通。

ⓘ 设备支持其他无线协议为433MHz的网关,具体以实际产品为准。

使用说明

1. 下载“易微联”APP

🔍 | 易微联



Android™ & iOS

2. 安装电池

2-1. 打开发射器后盖

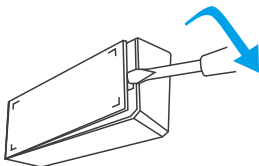

2-2. 根据正负极标识,装上电池

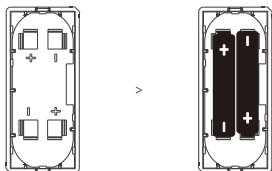

2-3. 合上后盖

ⓘ 电池需另行购买。

3. 添加子设备

添加子设备前, 请先连接网关。

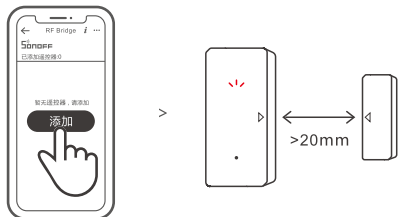

打开eWeLink APP, 选择要连接的网关, 点击"添加"选择报警器, 听到“滴”网关进入配对模式, 然后将“发射器”和“磁铁”分离大于20mm直到LED指示灯长亮1-2秒, 听到网关发出“滴滴”两声, 即添加完成。

⚠ 如添加失败, 请将设备移近网关后再重新添加。

安装设备

1. 撕下3M胶保护膜。

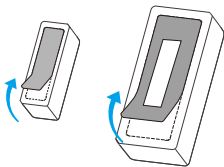

2. 安装时发射器和磁铁上的安装对位标识尽量对齐。

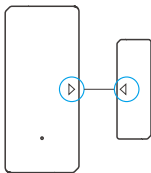

3. 分别粘贴在所需开合区域。

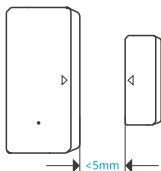

发射器和磁铁安装间隙门窗在闭合状态下小于5mm。

产品参数

产品型号	DW2-RF
RF	433MHz
工作电压	DC3V(2节1.5V电池)
电池型号	AAA (7号 1.5V)
静态电流	$\leq 6\mu\text{A}$
发射电流	$\leq 10\text{mA}$
无线发射距离	最大50米
安装距离	$< 5\text{mm}$
工作温度	$-10^{\circ}\text{C} \sim 40^{\circ}\text{C}$
材料	PC
产品尺寸	发射器: 70x31x19mm 磁铁: 42x14x16mm

产品介绍

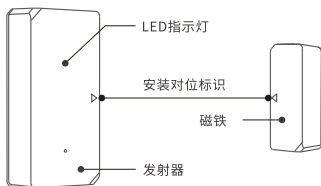

⚠ 设备重量<1Kg, 建议安装高度<2米。

产品特点

DW2-RF是一款低功耗的无线门窗传感器,通过发射器与磁铁的靠近与分开感知门窗开/合状态,通过添加场景联动设置控制其它设备。



低功耗



报警记录查询



场景联动

使用场景

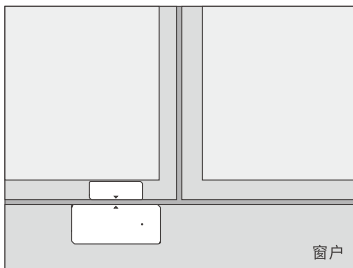
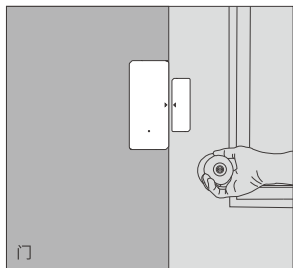

注意事项:

- 请勿安装在户外容易被破坏的位置;
- 请勿安装在基础不牢固或有雨淋的位置;
- 请勿安装在线路旁或磁性物体附近;

更换电池

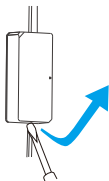

拆下外壳

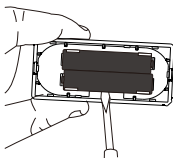

取出电池

The device can be operated intelligently via working with the SONOFF 433MHz RF Bridge to communicate with other devices.

ⓘ The device can work with other gateways supporting 433MHz wireless protocol. Detailed information is in accordance with the final product.

Operation instruction

1. Download APP

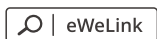

Android™ & iOS

2. Install batteries

2-1. Remove the back cover of the transmitter.

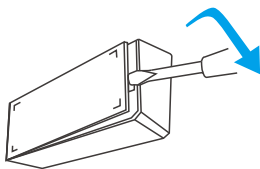

2-2. Insert batteries into the battery compartment based on identifiers of positive and negative poles.

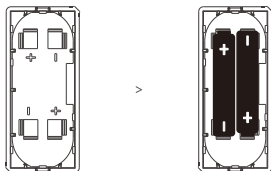

2-3. Close the back cover.

ⓘ The battery is not included, please purchase it separately.

3. Add sub-devices

Connect the Bridge before adding the sub-device.

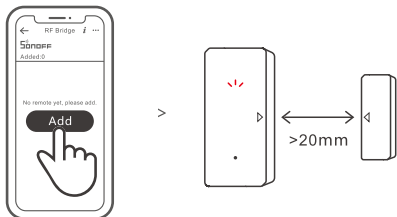

Access the eWeLink APP and select the Bridge, tap "Add" to select the alarm, and a "Beep" means the Bridge enters the pairing mode. Then separate the magnet for more than 20 mm from the transmitter until the LED indicator stays on for 1 to 2s, and the pairing is complete when you hear "Beep Beep".

⚠ If the addition failed, move the sub-device closer to the Bridge and try again.

Install the device

1. Tear off the protective film of the 3M adhesive.

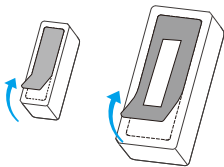

2. Try to align the mark line on the magnet with that on the transmitter during installation.

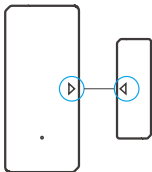

3. Install them in the opening and closing area separately.

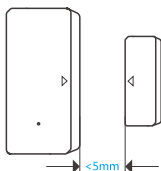

Make sure the installation gap is less than 5mm when the door or the window is closed.

Specifications

Model	DW2-RF
RF	433MHz
Working voltage	DC3V (2 x 1.5V battery)
Battery model	AAA 1.5V
Quiescent current	$\leq 6\mu\text{A}$
Emission current	$\leq 10\text{mA}$
Wireless transmission distance	Max. 50m
Installation gap	<5mm
Working temperature	-10°C~40°C
Material	PC
Dimension	Transmitter: 70x31x19mm Magnet: 42x14x16mm

Product Introduction

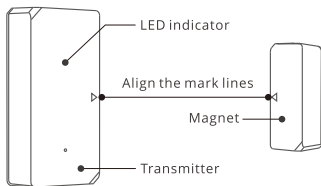

The device weight is less than 1 kg.
The installation height of less than 2 m is recommended.

Features

DW2-RF is a low-energy wireless door/window sensor that makes you know the opening/closing status of door and window by separating the magnet from the transmitter. Connect it with the Bridge and you can create a smart scene to trigger other devices.



Low-energy



Alarm recordings check



Smart scene

Application

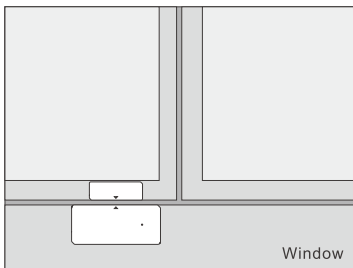
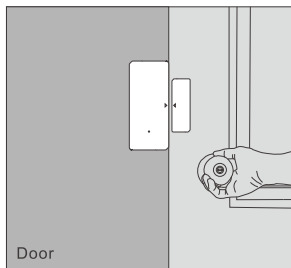

Note:

- Do not install outside the door/window.
- Do not install in the unstable position or in the place exposed to rain or moisture.
- Do not install near wiring or magnetic object.

Replace batteries

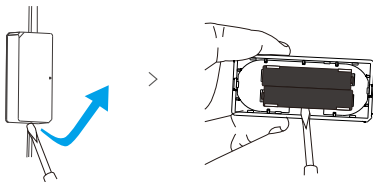

FCC Warning

Changes or modifications not expressly approved by the party responsible for compliance could avoid the user's authority to operate the equipment.

This device complies with part 15 of the FCC Rules. Operation is subject to the following two conditions: (1) This device may not cause harmful interference, and (2) this device must accept any interference received, including interference that may cause undesired operation.

FCC Radiation Exposure Statement:

This equipment complies with FCC radiation exposure limits set forth for an uncontrolled environment. This transmitter must not be co-located or operating in conjunction with any other antenna or transmitter.

Note:

This equipment has been tested and found to comply with the limits for a Class B digital device, pursuant to part 15 of the FCC Rules. These limits are designed to provide reasonable protection against harmful interference in a residential installation. This equipment generates, uses and can radiate radio frequency energy and, if not installed and used in accordance with the instructions, may cause harmful interference to radio communications. However, there is no guarantee that interference will not occur in a particular installation. If this equipment does cause harmful interference to radio or television reception, which can be determined by turning the equipment off and on, the user is encouraged to try to correct the interference by one or more of the following measures:

- Reorient or relocate the receiving antenna.
- Increase the separation between the equipment and receiver.
- Connect the equipment into an outlet on a circuit different from that to which the receiver is connected.
- Consult the dealer or an experienced radio/TV technician for help.

Hereby, Shenzhen Sonoff Technologies Co., Ltd. declares that the radio equipment type DW2-RF is in compliance with Directive 2014/53/EU. The full text of the EU declaration of conformity is available at the following internet address:

<https://sonoff.tech/usermanuals>

TX Frequency: SRD:433MHz

RF Output Power: -8.80dBm EIRP

The logo features the word "SONOFF" in a bold, black, sans-serif font. Above the letter "O" are three curved lines representing radio signal waves.

Shenzhen Sonoff Technologies Co., Ltd.

1001, BLDG8, Lianhua Industrial Park, shenzhen, GD, China

ZIP code: 518000

Website: sonoff.tech

MADE IN CHINA

