

4-key 433MHz Remote Controller

User manual V1.0

产品介绍

本设备适用于带433MHz遥控功能的SONOFF产品，以及支持433MHz通讯协议的其它设备。

产品参数

型号	4-key 433MHz Remote Controller
发射频率	433MHz
供电	3V纽扣电池 x 1 (电池型号:CR2032)
工作电流	10mA
工作温度	0°C-40°C
产品规格	55x30x14mm

使用方法

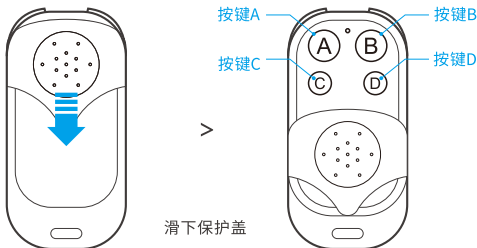

按键A/B/C/D可分别与支持433MHz通讯协议设备学习，学习成功后可通过遥控器按键控制该设备的开关。

⚠ 不同设备的学习方法不同，请参考支持433MHz通讯协议设备的说明书。

适配 SONOFF 设备

- RFR2
- BASICRFR3
- 4CHPROR3
- SlampherR2
- RF BridgeR2
- TX系列墙壁开关

学习案例:

1. 遥控器与RFR2学习方法

长按RFR2配对按钮3秒直到RFR2信号指示灯呈红色闪烁一下，然后短按遥控器上需学习的按键，RFR2信号指示灯呈红色再次闪烁一下，则表示配对成功。

2. 遥控器TX系列墙壁开关学习方法

长触摸开关上将要配对的通道按键3秒，听到开关发出“滴”一声后松开，然后短按遥控器上需配对的按键，再次听到开关发出“滴”一声，则表示配对成功。

Product Introduction

The device applies to all SONOFF products with 433MHz frequency and other devices supporting the 433MHz communication protocol.

Specifications

Model	4-key 433MHz Remote Controller
RF	433MHz
Power supply	3V button cell x 1 (Battery model: CR2032)
Working current	10mA
Operating temperature	0°C-40°C
Product size	55x30x14mm

How to use

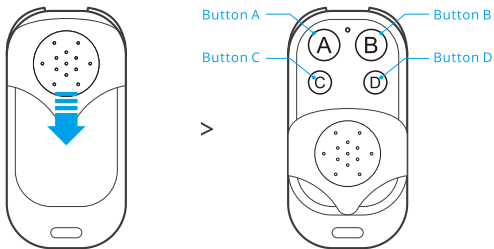

Swipe down the protective cover

Button A/B/C/D is able to learn devices that support 433MHz communication protocol respectively. After learning successfully, the on / off of these devices can be controlled by this remote controller.

ⓘ Different devices have different learning methods, please refer to the User Manual of the devices that support 433MHz communication protocol.

Works with SONOFF devices

- RFR2
- BASICRFR3
- 4CHPROR3
- SlampherR2
- RF BridgeR2
- TX series Wi-Fi smart switches

Learning case:

1. Remote control and RFR2 learning method

Long press the RFR2 pairing button for 3 seconds until the RFR2 signal indicator flashes red, then short press the key to learn on the remote control, and the RFR2 signal indicator flashes red again, indicating that the pairing is successful.

2. Learning method of TX series Wi-Fi smart switches of remote controller

Long touch the key of the channel to be paired on the switch for 3 seconds, release it after hearing the "drop" sound of the switch, and then short press the key to be paired on the remote control. If you hear the "drop" sound of the switch again, it indicates that the pairing is successful.

FCC Warning

Changes or modifications not expressly approved by the party responsible for compliance could void the user's authority to operate the equipment.

This device complies with part 15 of the FCC Rules. Operation is subject to the following two conditions: (1) This device may not cause harmful interference, and (2) this device must accept any interference received, including interference that may cause undesired operation.



Shenzhen Sonoff Technologies Co., Ltd.

3F & 6F, Bldg A, No. 663, Bulong Rd, Shenzhen, GD, China
ZIP code: 518000 Website: sonoff.tech

MADE IN CHINA

