

OUTDOOR THERMOMETER HUMIDITY TRANSMITTER INSTRUCTION MANUAL

Specifications

1. Temperature range: -40°F -- 158°F (-40°C--70°C).
 2. Wireless Range: 197ft/60m depending on home construction materials.
 3. Battery Requirements : 2 X AAA 1.5V batteries.
 4. Wireless Frequency: 433.93MHz
 5. The Sensor's initial channel is channel ONE, when contacting, please ensure to slide button on the back to set channel 1, 2 or 3.
 6. Sensor ONLY for special indoor outdoor Thermometer Humidity Monitor.
- Remarks: The outdoor sensor start reading the exact value and transmitting the signal after 30 minutes.

Features

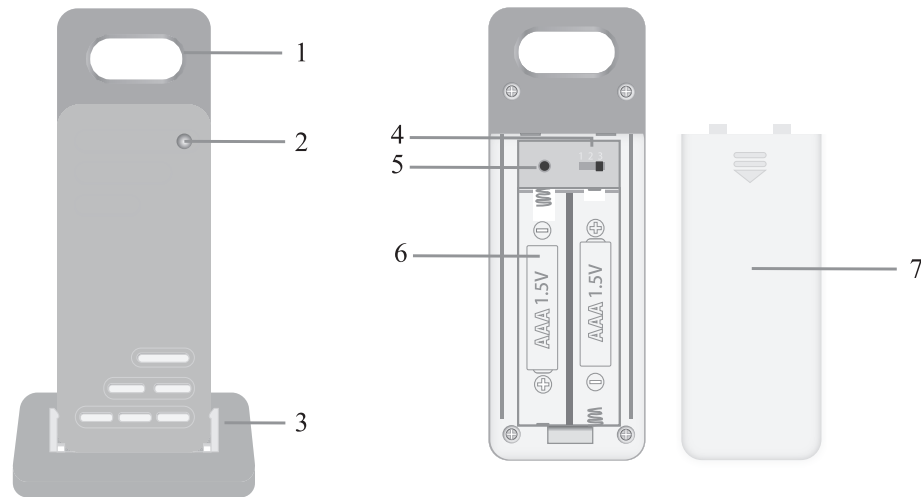

Outdoor Sensor

1. Integrated Hanger
For easy placement.
2. Wireless Signal Indicator
Flashes when data is being sent to the display unit.
3. Detachable stand
4. Slide to set channel 1, 2 or 3.
5. Press to send temperature/humidity data to the display unit manually.
6. Battery Compartment
7. Battery Compartment Cover

SETUP

Sensor Setup

Install or Replace Batteries

1. Slide off the battery compartment cover.
2. Insert 2 x AAA batteries into the battery compartment, as shown. Follow the polarity (+/-) diagram in the battery compartment.
3. Replace the battery cover.

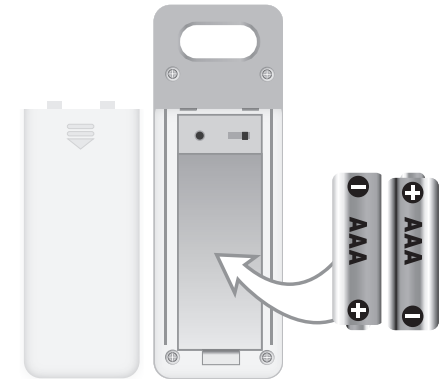

Placement for Maximum Accuracy

Tower Sensors are sensitive to surrounding environmental conditions. Proper placement of the outdoor sensor is critical to the accuracy and performance of this product.

Outdoor Sensor Placement

Tower Sensor must be placed outside to observe outdoor conditions. Sensor is rain-proof and is designed for general outdoor use, however, to extend its life place the sensor in an area protected from direct weather elements. **(Warning: Sensor must be vertical placement.)**

Hang the sensor using the integrated hang hole or hanger, or by using string (not included) to hang it from a suitable location, like a well covered tree branch. The best location is 4 to 8 feet above the ground with permanent shade and plenty of fresh air to circulate around the sensor.

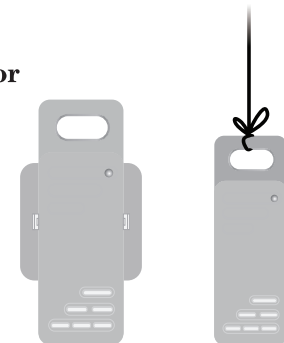

Important Placement Guidelines

- To ensure accurate temperature measurement, place sensor out of direct sunlight and away from any heat sources.
- Display unit and outdoor sensor must be within 197ft/60m of each other.
- To maximize wireless range, place sensor away from large metallic items, thick walls, metal surfaces, or other objects that may limit wireless communication.
- To prevent wireless interference, place sensor at least 3ft (0.9m) away from electronic devices (TV, computer, microwave, radio, etc.).

FCC Statement:

Any Changes or modifications not expressly approved by the party responsible for compliance could void the user's authority to operate the equipment.

This device complies with part 15 of the FCC Rules. Operation is subject to the following two conditions:

- (1) This device may not cause harmful interference, and
- (2) This device must accept any interference received, including interference that may cause undesired operation.

RF warning for Portable device:

The device has been evaluated to meet general RF exposure requirement. The device can be used in portable exposure condition without restriction.

Note: This equipment has been tested and found to comply with the limits for a Class B digital device, pursuant to part 15 of the FCC Rules. These limits are designed to provide reasonable protection against harmful interference in a residential installation. This equipment generates, uses and can radiate radio frequency energy and, if not installed and used in accordance with the instructions, may cause harmful interference to radio communications. However, there is no guarantee that interference will not occur in a particular installation. If this equipment does cause harmful interference to radio or television reception, which can be determined by turning the equipment off and on, the user is encouraged to try to correct the interference by one or more of the following measures:

- Reorient or relocate the receiving antenna.
- Increase the separation between the equipment and receiver.
- Connect the equipment into an outlet on a circuit different from that to which the receiver is connected.
- Consult the dealer or an experienced radio/TV technician for help.