

# WIRELESS CHARGING ALARM CLOCK

# USER MANUAL

## WIRELESS CHARGING ALARM CLOCK

---

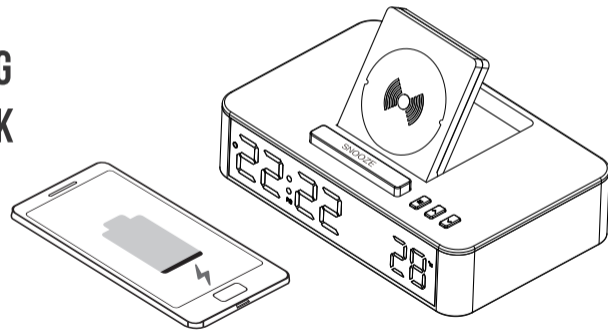

\*Please read this user manual carefully before using.

## 1 CAUTION

**! WARNING:** To reduce the risk of fire or electric shock, this apparatus should not be exposed to rain moisture and objects filled with liquids, such as vases, should not be placed on this apparatus.

### IMPORTANT SAFETY INSTRUCTIONS

- Read and keep these instructions.
- Heed all warnings.
- Do not use this apparatus near water.
- Clean only with dry cloth.
- Do not block any ventilation openings.
- Do not install near any heat sources such as radiators, heat registers, stoves or other apparatus (including amplifiers) that produce heat.
- Protect the power cord from being walked on or pinched, particularly at plugs, convenience receptacles, and the point where they exit from the apparatus.
- Unplug this apparatus during lightning storms or when unused for long periods of time.

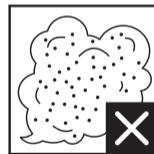
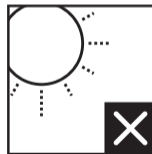
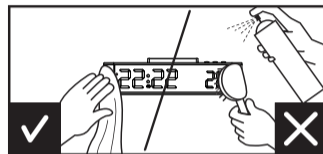
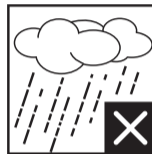

## 2 SPECIFICATIONS

- LED time display.
- There are 4 levels of brightness ( Bright, Medium,Dark, off).
- Automatic dimming according to ambient lighting.
- Night mode ( Automatic dimming during preset timing).
- Total 4 functional buttons: “MODE”, “UP”, “DOWN”, “SNOOZE”.
- Total 4 digits time display ( 12/24 hour modes selectable).
- The alarm AL display is 6:00.
- Alarm with pre-settable snooze function ( Snooze last for 5-60 minutes and unlimited times) .
- Displays the indoor temperature ( Display unit: °C/°F selectable).
- Indoor Temperature range: -4°F -- 158°F (-20°C--70°C).

**Remarks: During the charging process, cell phone battery heating may cause the displaying temperature to be higher than the current actual temperature.**

- RGB 7 colors ambient lighting (Manual and Auto modes).
- Back-up button battery: The 3V button battery is to retain the alarm/clock setting in case of a power failure. It can not display the alarm/clock time.
- Wireless Charge.
- **Wireless Charging Panel support One-button lifting function. ( Notice: The maximum load-bearing weight is 250 grams, best that not to exceed 230 grams )**

## 3 UNIT FEATURES&FUNCTIONS

Front

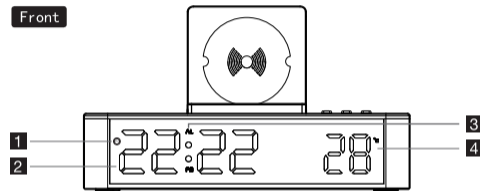

Back

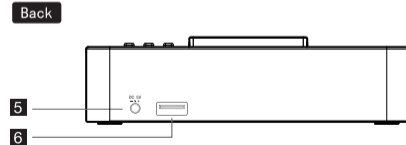

Bottom

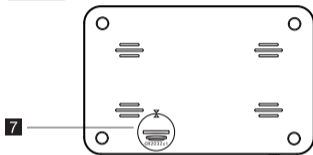

Side

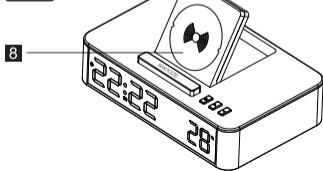

## ▶▶ FUNCTION:

- 1** Automatic dimming
- 2** Time
- 3** Alarm
- 4** Temperature
- 5** Power
- 6** USB output port
- 7** Back-up button battery
- 8** Wireless charging panel

Top

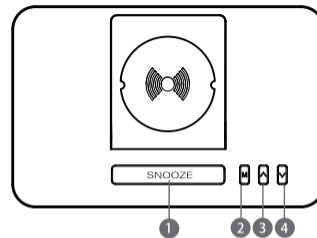

<b>1 SNOOZE</b>	1 Press to control the lifting wireless charging panel 2 When the alarm beeps, press to enter snooze mode
<b>2 MODE</b>	1 Press to select the display of Time, Alarm, Night mode by cycle 2 Press and hold for 3 seconds to enter setting mode
<b>3 UP</b>	1 Press to switch the brightness from bright,medium,dark,off 2 Press and hold for 2 seconds to enter automatic or manual dimming mode 3 In setup mode, press to increase value; Long press will increase at a faster pace.
<b>4 DOWN</b>	1 Press to switch the RGB 7 colors light 2 Press and hold for 3 seconds to turn on/off alarm 3 In setup mode, press to decrease value;Long press will decrease at a faster pace.

## 4 BASIC

### POWER ON

\* Connect the power cable into the jack on the back marked “DC 5V” and then plug the power cable into the socket. The LCD display turns on.

#### 4.1 Set Time

- Press and hold “M” button for 3 seconds to enter setting mode. The sequence is “12/24 hours format”-“Hour”-“Minute”-“°C/°F unit” setting mode.
- In setup mode, the setting object is flashing.
- Adjust the value using “▲” or “▼” buttons, after setting press “M” once to enter other mode. Press “▲” or “▼” to switch the Hour mode between 12 Hour and 24 Hour. Press “M” to confirm it and enter into “Hour” “Minute” setting. It exits the setting in 10 seconds if no operation on any key.
- Remark: In time setting mode, there is no “AL” icon in display.

#### 4.2 SET ALARM TIME

- Press “M” button once to enter alarm setting mode. (There is “AL” icon in display)

- Press and hold “M” button for 3 seconds to enter setting mode. The sequence is “Hour”-“Minute”-“Snooze time”.
- In setup mode, the setting object is flashing.
- Adjust the value using “▲” or “▼” buttons, after setting press “M” once to confirm and enter other mode.
- The default Snooze time is 5 minutes; “05” value is flashing (represent of 5 minutes), press “▲” or “▼” buttons to set from 5 to 60 minutes snooze time.
- Once the setting is finished, the alarm turns on and the “AL” icon appear in display.
- Turn on and turn off AL alarm: Press and hold “▼” button for 3 seconds to switch. (There is “AL” icon in display is on condition and no “AL” icon is off condition).
- BUZZER alarm last for 2 minutes.
- When the alarm beeps, press “SNOOZE” button to enter snooze mode. The corresponding “AL” icon flashes till reach to the snooze time preset and then alarm again.
- When the alarm beeps, press any other buttons except the “SNOOZE” button to turn off the alarm and snooze. AL symbol stops flashing. (If not cancel the preset alarm, it will still beeps next day)
- When the alarm beeps, the RGB 7 Colors light will light up and enter color changing mode automatically, Then recovery to preset status after the alarm stops.

### 4.3 NIGHT MODE SETTING

- Night mode means that LED automatically enter into the low brightness display status at night or preset period.
- Press “M” button twice enter into night mode (the default is “OFF”), Switch the value using “^” or “v” buttons, if select “ON” means that night mode turns on, during the period of 18:00 to 6:00 the next day, it will automatically enter into low brightness display status.
- When night mode is “ON”, press and hold “M” button for 3 seconds to enter interval time setting mode. The setting sequence is: “start hour”-“start minute”-“end hour”-“end minute”. At start hour and minute setting status, the upper point in the center of the screen is long bright. At end hour and minute setting status, the lower point in the center of the screen is long bright.

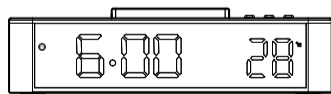
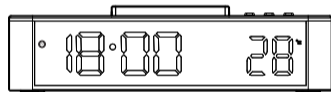
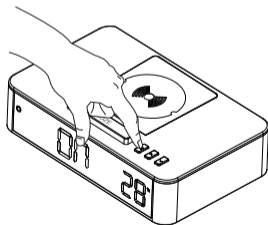

### 4.4 DISPLAYS THE INDOOR TEMPERATURE

- The default unit is °C.
- To switch the unit from °C to °F: In time setting mode, press and hold “M” button for 3 seconds into setting mode, then press “M” button three times to unit setting mode, Switch the value using “^” or “v” buttons.

### 4.5 AUTOMATIC&MANUAL DIMMING SET

- Press “^” button to switch the brightness from bright, medium, dark, off by cycle.
- Press and hold “^” button for 3 seconds to enter setting mode, after “OFF” displayed for three seconds enter into manual dimming.
- Press and hold “^” button for 3 seconds, after “ON” displayed for three seconds enter into automatic dimming. ( Automatic dimming according to ambient lighting).

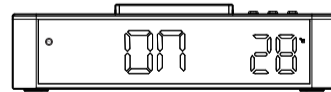
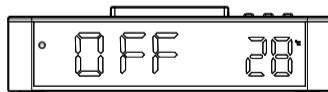

## 4.6 RGB 7 COLORS AMBIENT LIGHTING

- The default is color changing status. Press“**V**”once to select the color, the sequence is: color changing - off - red - orange - green - light blue - dark blue - purple -white by cycle.
- In color changing mode, each color last for 5 seconds.

## 4.7 WIRELESS CHARGING

- Wireless charging panel support One-button lifting function. Press “SNOOZE” button once to control the lifting of panel.

**Notice:** The maximum load-bearing weight is 250 grams, best that not to exceed 230 grams.

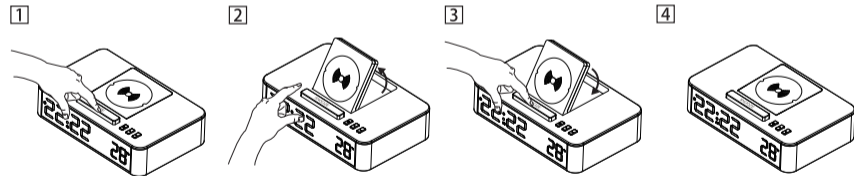

Charging board one button lifting step 1-4

- Charge all Qi enabled mobile devices wirelessly using the charging panel: Wirelessly charges iPhone X, iPhone 8 Plus and iPhone 8 / Samsung Galaxy S8| S8+| Note8 etc.
- Fully charged require continuous 4 hours.
- The distance between charging panel and mobile phone can not exceed 2 mm (Wireless charging may not work properly if you have attached a thick case or shell to your mobile device).
- Operation Voltage: DC5V 2A.
- Load Power: 5W.
- The efficiency of wireless charging >70%.
- The working temperature: 0 - 40°C.
- Equipped with foreign body detection and protection function.
- When the mobile device is not placed on the charging surface properly or depending on the location of the mobile devices's wireless charging coil, your mobile device may not charge properly.

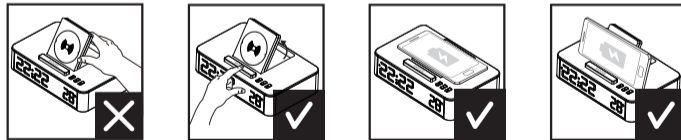

The Wireless charging panel only supports SNOOZE button trigger lifting, can't pull it up or press it down by hands or other tools.

## 4.8 NOTICE

- The default of brightness is bright when power on.
- **Remarks: During the charging process, cell phone battery heating may cause the displaying temperature to be higher than the current actual temperature.**
- Keep the product dry and don't put it in the damp place to avoid the product's internal circuit being affected.
- Keep the product away from direct sunlight or hot places. High temperature will shorten the life of electronic devices, destroy the battery or distort certain plastic parts.
- With one USB output port enables charging of smartphones and other digital devices.

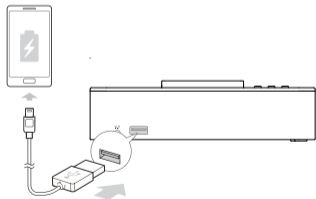

## WIRELESS CHARGING ALARM CLOCK

### FCC WARNING

Any Changes or modifications not expressly approved by the party responsible for compliance could void the user's authority to operate the equipment. This device complies with part 15 of the FCC Rules. Operation is subject to the following two conditions: (1) This device may not cause harmful interference, and (2) this device must accept any interference received, including interference that may cause undesired operation.

Note: This equipment has been tested and found to comply with the limits for a Class B digital device, pursuant to part 15 of the FCC Rules. These limits are designed to provide reasonable protection against harmful interference in a residential installation. This equipment generates, uses and can radiate radio frequency energy and, if not installed and used in accordance with the instructions, may cause harmful interference to radio communications. However, there is no guarantee that interference will not occur in a particular installation. If this equipment does cause harmful interference to radio or television reception, which can be determined by turning the equipment off and on, the user is encouraged to try to correct the interference by one or more of the following measures:

- Reorient or relocate the receiving antenna.
- Increase the separation between the equipment and receiver.
- Connect the equipment into an outlet on a circuit different from that to which the receiver is connected.
- Consult the dealer or an experienced radio/TV technician for help.

### RF EXPOSURE STATEMENT

This equipment complies with FCC radiation exposure limits set forth for an uncontrolled environment. This transmitter must not be co-located or operating in conjunction with any other antenna or transmitter. This equipment should be installed and operated with minimum distance 20cm between the radiator & your body.