

SOUNDSTREAM ICON



ICON

Quick Stade Guide

① What's in the box

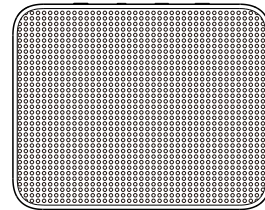

x 1

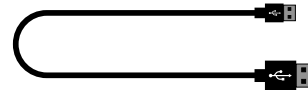

x 1

ICON

Quick Stade Guide

② Buttons

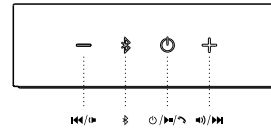

③ Connections

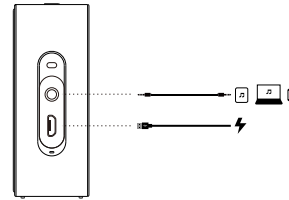

ICON

Quick Stade Guide

④ Bluetooth

1. Bluetooth connection

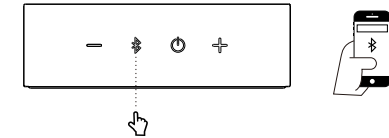

2. Music control

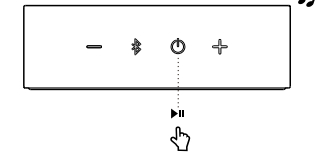

SOUNDSTREAM

WARRANTY NO:1000001

WARRANTY CARD

MODEL NO:	
SERIAL NO:	

DEALER'S NAME & ADDRESS(STAMP)

D	D	M	M	Y	Y	Y	Y
---	---	---	---	---	---	---	---

Dealer's endorsement is required for validation of this warranty.

IMPORTANT

This warranty Rwgistraton Card Must be duly completed and mailed to KATO AUTOMART (M) SDN BHD Within fourteen (14) days from date of purchase to ensure validity. Warranty and any alteration or amendment to this card will render the warranty void. Please produce this card when requesting for service.

SOUNDSTREAM

WARRANTY NO:1000001

WARRANTY CARD

MODEL NO:	
SERIAL NO:	

CUSTOMER'S PARTICULAR:

CUSTOMER'S NAME: _____

ADDRESS: _____

MOBILE: _____ TEL NO: _____

DEALER'S NAME & ADDRESS(STAMP)

DATE OF PURCHASE							
D	D	M	M	Y	Y	Y	Y

ICON

Quick Stade Guide

⑤ Speakerphone

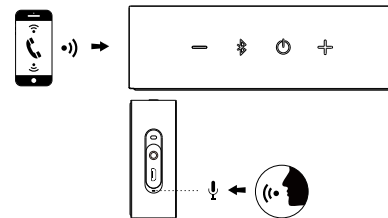

⑥ LED indication

Status	LED indication
Bluetooth Not connected	Slow blinking
Bluetooth Pairing mode/Incoming call	Fast blinking
Bluetooth Connected	On
Low Power	Blinking
Charging	On

ICON

Quick Stade Guide

⑦ Warning

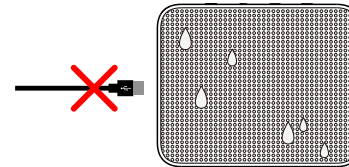

icon is IPX7 waterproof

IMPORTANT: To ensure that icon is waterproof, please remove all cable connections and tightly close the; exposing the icon to liquids without doing so may result in permanent damage to the speaker, and do not expose icon to water while charging, as doing so may result in permanent damage to the speaker or power source.

IPX7 waterproof is defined as the speaker can be immersed in water up to 1m for up to 30 minutes.

If the speaker will not be used for a long period of a long period of time, please charge the battery at least once every 3 months. Battery life varies due to usage patterns and environmental conditions.

ICON

Quick Stade Guide

Technology Specifications

- Bluetooth version: 3.0
- Bluetooth Profile: A2DP v1.3, AVRCP v1.6, HFP v1.7, HID v1.1, AVCTP v1.4, AVDTP v1.3, and SPP v1.2
- Transducer: 1 x 40mm
- Rated power: 3.0W RMS
- Frequency response: 180Hz-20kHz
- Signal-to-noise ratio: 70dB
- Battery type: Lithium-ion polymer(3.7V, 750mAh)
- Battery charge time: 2.5Hours
- Music playing time: 6Hours
- Bluetooth transmitter power: 0-8dBm
- Bluetooth transmitter modulation: GFSK | π/4 DQPSK | 8DPSK
- Dimensions: 90 x 73 x 30 (mm)
- Weight: 175g

ICON

Quick Stade Guide

FCC Compliance Notice

Any changes or modifications not expressly approved by the party responsible for compliance could void the user's authority to operate the equipment.

This device complies with Part 15 of the FCC Rules. Operation is subject to the following two conditions:
(1) This device may not cause harmful interference, and
(2) This device must accept any interference received, including interference that may cause undesired operation.

This equipment has been tested and found to comply with the limits for a Class B digital device, pursuant to part 15 of the FCC Rules. These limits are designed to provide reasonable protection against harmful interference in a residential installation. This equipment generates, uses and can radiate radio frequency energy and, if not installed and used in accordance with the instructions, may cause harmful interference to radio communications. However, there is no guarantee that interference will not occur in a particular installation. If this equipment does cause harmful interference to radio or television reception, which can be determined by turning the equipment off and on, the user is encouraged to try to correct the interference by one or more of the following measures:

- Reorient or relocate the receiving antenna.
- Increase the separation between the equipment and receiver.
- Connect the equipment into an outlet on a circuit different from that to which the receiver is connected.
- Consult the dealer or an experienced radio/TV technician for help.

FCC Radiation Exposure Statement:

This equipment complies with FCC radiation exposure limits set forth for an uncontrolled environment. This transmitter must not be co-located or operating in conjunction with any other antenna or transmitter.