

6.5' BH NOBLE FIR TREE WITH EASY PLUG® AND LED COLOR+CLEAR® LIGHTS

OWNER'S MANUAL

26 Watts

Thank you for purchasing your Christmas tree from **Balsam Hill®**. The instructions below will help you quickly and easily set up your new tree.

1. Find a level surface near an electrical outlet and assemble the tree stand as shown in **Fig. A**.

Fig. A - Tree Stand Assembly

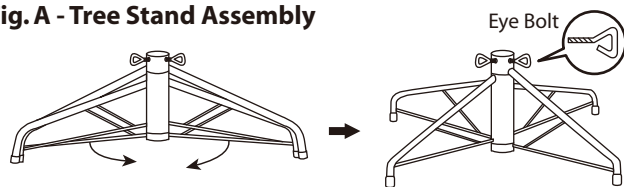

1. Pull apart the legs of the stand so that they are x-shaped.
2. When inserting the bottom section of the tree into the assembled stand, thread the eyebolt into the stand and tighten until the pole is firmly secured.

Fig. B - Assembling the tree

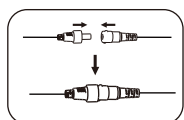

Section 3

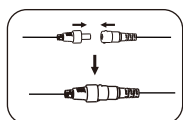

***Electrical Rating For The Tree (For Indoor Use Only)**

Input: AC 120V, 60Hz, 0.45A
Output: DC 29V, 0.9A

Section 2

Do Not Tamper Internal Parts

Open the protective cap

Section 1

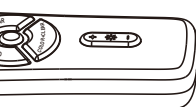
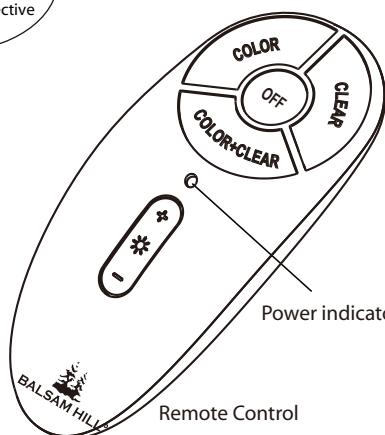

Plug Adapter Into Wall Outlet

2. Each tree section is numbered with a tag. Please identify all sections before assembling.
3. Assemble the tree from bottom to the top. Start with the bottom section (section 1) and remove the protective cap before inserting into the assembled stand. Make sure the pole is firmly inserted and secured into the stand.



4. Plug the adapter into the wall outlet (**See Fig. B**) and use the remote control to turn on the lights. This section of your tree should now be lit. If some bulbs do not light or flicker, search for any loose plugs and/or broken, loose or missing bulbs. Connect the plugs or replace the bad bulbs promptly in order to maintain the performance and life expectancy of your pre-lit tree.
5. Allow branches to fall into place or gently pull up and out. When adjusting branches, be sure that all wires are free of branch hinges. Begin to shape the branches and tips in the bottom section inserted into the tree stand. Start with the tips closest to the middle of the tree; pull the individual tips alternately upward and outward working your way to the tip of the branches (**See Fig. C**). Work row by row to the upper part of the tree leaving no tip untouched. Continue to shape each branch as described above as you set up each tree section.

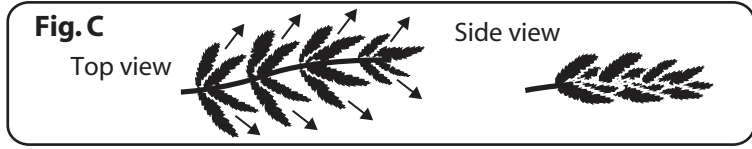

6. Find the next section, remove the protective cap, and insert the section into the bottom section. Turn the pole of the section and make sure the pole is inserted into place. When properly inserted, you should see the section light up (if you have already turned on the lights using your remote control). Continue this step and step 5 until the entire tree is set up, lit, and ready to be decorated.

STORAGE INSTRUCTIONS

1. Unplug adapter from the wall outlet first and then remove all ornaments and decorations.
2. Disassemble the tree from the top to the bottom. Start with the tree top and gently lift straight up to remove from section below and fold all branches toward the pole.
3. Continue by gently lifting each section straight up from the section below. Fold all branches toward the pole until the bottom section is removed from the tree stand. Cover the protective cap on the poles to avoid damaging the internal parts. (**See Fig. D**)
4. Carefully place all tree sections into the storage bags within the shipping box(es) and tape the box(es) shut.
5. When not in use, please store your tree in a cool, dry place away from sunlight. Exposing your tree to excessive heat or humidity may damage your tree.
6. Keep out of reach of pets and children.

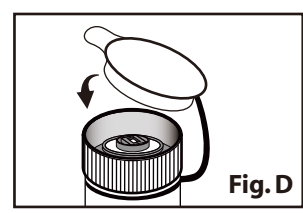

TROUBLESHOOTING TIPS

For Pre-lit Trees, If The Tree Does Not Illuminate

1. Check to make sure that all plugs and adapter are properly connected as indicated in **Fig. B**.
2. Turn the poles gently to make sure pole-to-pole connection is secured.
3. Check for loose, broken or missing bulbs, and replace as needed.

LOOSE BRANCHES

1. Extra hinge pins are included for repairing the hinges of the branches. Place the branch into the slot of the bracket.
2. Insert a new hinge pin through the hole and secure using the retainer washer. (**See Fig. E**)

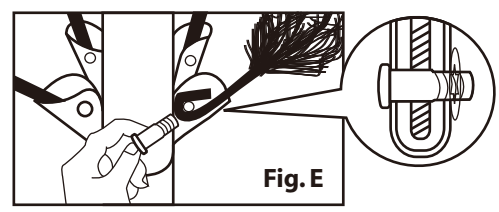

SPARE PARTS

Each tree includes hinge pins/washers, and for pre-lit trees spare bulbs are also included. If extra parts are needed, please contact our Customer Service Center at customerservice@balsamhill.com

CAUTION:

1. To reduce the risk of fire and electric shock:
 - a) Use only the power supply that was provided with this product;
 - b) Do not install on trees having needles, leaves or branch covering of metal or materials which look like metal, and
 - c) Do not mount or support strings in a manner that can cut or damage wire insulation.
2. Use only the adapter supplied with this product. Using a different adapter will damage the lights and may cause fire, or electrical shock hazards.

Light Controller & Remote Control

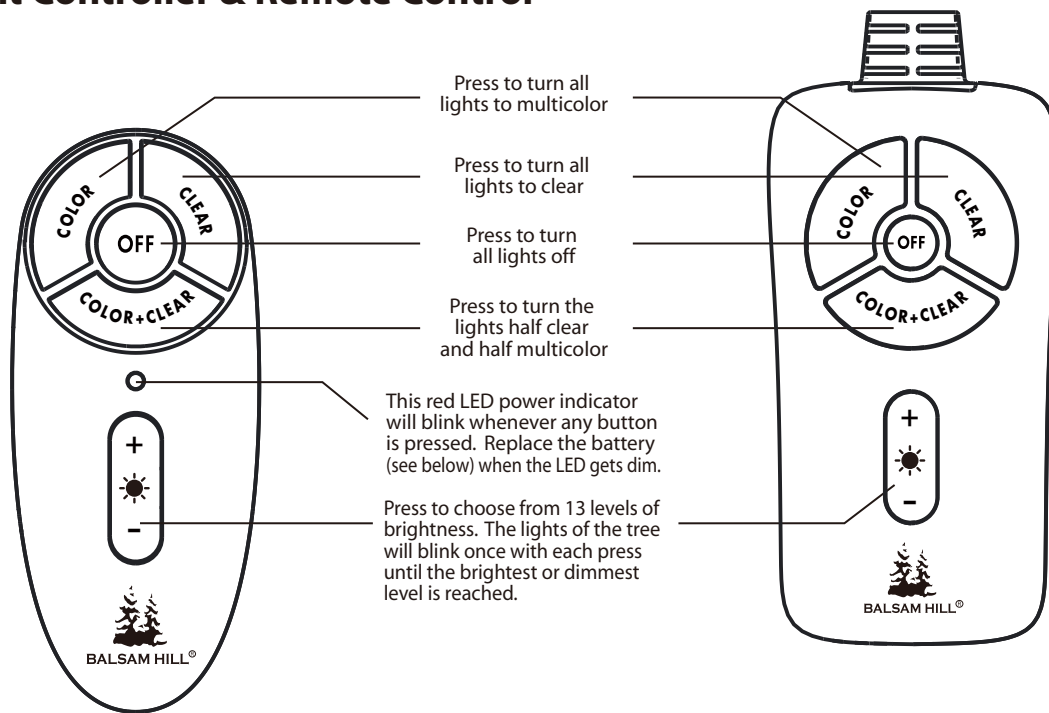

Battery Replacement

1. Slide open the battery cover.
2. Replace with a new CR2032 button cell battery with correct polarities (+/-) as indicated.
3. Slide the battery cover closed.

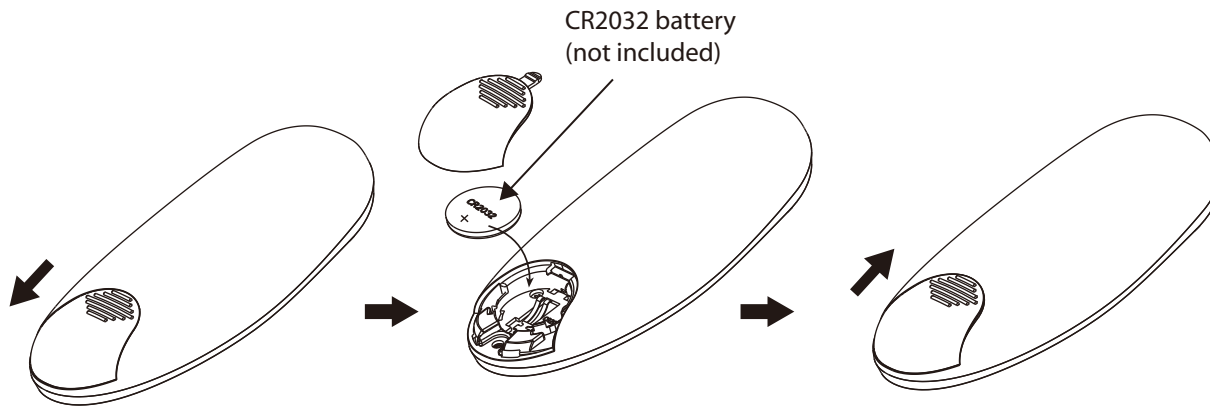

WARNING:

1. This product is powered by a lithium battery. Due to their small size, lithium batteries can easily be swallowed by children. Ingestion of such batteries has been known to cause death.
2. This product contains a lithium battery which if swallowed has been known to cause death.
3. Do not expose the product to moisture.
4. Remove batteries when not used for an extended period of time, or when depleted.
5. Dispose of used batteries properly by following directions on batteries.
6. Use only CR2032 batteries for the remote controller.
7. Clean the battery contact surfaces gently prior to battery installation.
8. DO NOT DISPOSE OF BATTERIES IN FIRE. BATTERIES MAY EXPLODE OR LEAK.

Statement

This device contains licence-exempt transmitter(s)/receiver(s) that comply with Innovation, Science and Economic Development Canada's licence-exempt RSS(s).

Operation is subject to the following two conditions:

- (1) this device may not cause interference, and
- (2) this device must accept any interference, including interference that may cause undesired operation of the device.

This device comply with the requirement of the RF exposure.

Déclaration

Ce dispositif contient de(s) émetteur(s)/récepteur(s) sans licence conforme(s) à la norme d'exemption de licence pour les RSS de Innovation, Sciences et Développement économique Canada.

L'exploitation est autorisée aux deux conditions suivantes :

- (1) l'appareil ne doit pas produire de brouillage, et
- (2) l'utilisateur de l'appareil doit accepter tout brouillage radioélectrique subi, même si le brouillage est susceptible d'en compromettre le fonctionnement.

Ce dispositif est conforme aux exigences d'exposition aux RF.

FCC notices:

WARNING: Changes or modifications to this unit not expressly approved by the party responsible for compliance could void the users authority to operate the equipment.

This device complies with Part 15 of the FCC Rules. Operation is subject to the following two conditions:

- (1) this device may not cause harmful interference, and
- (2) this device must accept any interference received, including interference that may cause undesired operation.