

4G MiFi MT504
User Manual

Legal Information

Copyright ©2022. All rights reserved.

No part of this manual may be reproduced or transmitted in any form or by any means without prior written consent of MeiG Smart Technology Co., Ltd and its affiliates.

Reserves the right to change or modify any information or specification contained in this manual without prior notice and without any liability.

Limitation of Liability

Due to the nature of wireless communications, transmission and reception of data can never be guaranteed. Data may be delayed, corrupted (i.e., have errors) or be totally lost.

Shall not be liable for any loss of profits or indirect, special, incidental or consequential damages resulting from or arising out of or in connection with using of this product, whether or not had been advised, knew or should have known of the possibility of such damages, including, but not limited to lost profits, interruption of business, cost of capital, cost of substitute facilities or product, or any downtime cost.

1. Product Overview

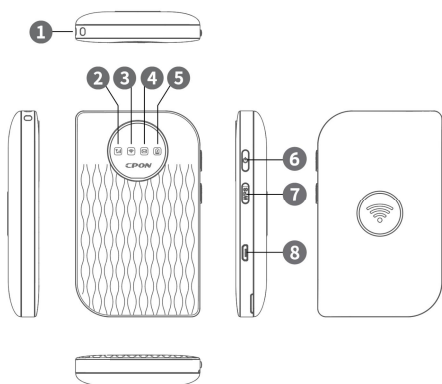

1. Hanging hole
2. Network indicator
3. Wi-Fi indicator
4. SMS indicator
5. Battery indicator
6. Power button
7. WPS button
8. Micro USB port

| LED indicator | Description |
|----------------------|---|
| Network indicator | Network indicator (in red and blue): 4G/3G out of service/arrearage: solid red light is on; 4G/3G network signal is normal: solid blue light is on. |
| Wi-Fi indicator | Wi-Fi indicator (in blue): Wi-Fi on: blue; Wi-Fi Off: light off ; WPS pairing/user access: it flashes for 15s and 5s respectively. |
| SMS indicator | SMS indicator (in blue): There is a new SMS: blue light flashes; Normal/No new SMS: light off. |
| Battery indicator | Battery indicator (in red and blue): Battery >=25%, solid blue light is on; Battery <25%, solid red light is on; When charging: Battery>=25%, blue light flashes; Battery < 25%, red light flashes; Power charge completed: solid blue light is on. |

Note:The Wi-Fi indicator and SMS indicator will flash alternately during software upgrading and the device will restart after upgrade done.

Note: When the battery is powered on, the LED light will automatically turn off after 30s of normal light; the user can turn on or off the LED light again by pressing the power button.

2. Insert and remove the SIM card

Insert the SIM card

1. Shutdown the MT504;
2. Insert the SIM card into the SIM card slot according to the steps shown in the figure.

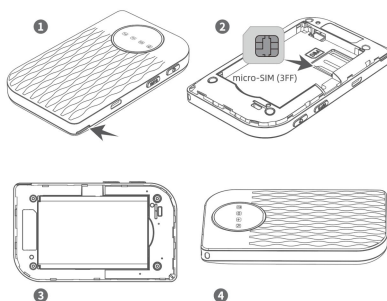

Note: this model accepts only 3FF Micro SIM card. Please do not bend or scrape the SIM card and avoid contact with static electricity, water or dust.

Remove the SIM card

1. Power off the MT504, open the back cover and take out the battery;
2. Gently remove the SIM card from the SIM card slot and close the protective cover of the SIM card.

3. Charging

Charging method: plug the adapter end into power socket, and the USB end of the charging cable into Micro USB port of MT504; please charge MT504 with 5V/1A power adapter.



4. MiFi Management

Login Device Management Interface

1. Make sure that your device is connected to MT504 via Wi-Fi;
2. Open the browser, enter "http://192.168.60.1" in the address bar and click enter;
3. Enter the user name and password, and click Login. You can check and modify the configuration in the management interface.

Note: Default user name: admin. Password: admin. It's printed on the device label, and it could be other values based on requirements from the customer.

Wi-Fi Connections Setting

1. Press the power button for 3s to power on the device, and the LED lights on the device will turn on in turn;
2. Use your device to search for a wireless network with the name "MT504_XXXXXX" for Wi-Fi and click Connect. If a security mechanism is adopted, you need to enter the correct Wi-Fi password; the password is random 8 letters and figures. It's printed on the device label, and it could be other values based on requirements from the customer.

Note: XXXXXX is the rightmost six digits of the device MAC address.

How to change the name and password of Wi-Fi

1. Login <http://192.168.60.1> to enter Web management interface.
2. Select Management > WLAN Settings, and you can see Wi-Fi Name (SSID) and Password. Delete old SSID and password, then enter new SSID and password as needed.
3. Click the “Apply” button and wait for the prompt “Success” on the screen. You can exit the management interface.
4. Wait for the computer or laptop's screen to display the Wi-Fi icon, which indicates that the wireless network has been successfully connected.

Power off& Forcedly Restart Device & Restore Factory Settings

1. Power off: press the power button for about 3s.
2. Forcedly restart: Open the back cover of MT504, remove the battery and install the battery after power off, and press the power button to forcedly restart the device.
3. Restore factory settings: when the device is powered on, press the power key+WPS key for about 5s to enter the factory setting, and the system will automatically restore the factory settings.

Note:

Restore factory settings will delete all user-defined Wi-Fi settings from the device and all settings on the management interface will be restored to factory default setting.

5. Safety Information

- Certain electronic devices (e. g. vehicle electronic systems) may be affected by electromagnetic interference if the shielding is inadequate. If necessary, please consult the manufacturer of the device prior to use.
- The devices may interfere with medical equipment such as hearing aids and pacemakers. Please keep the device at a distance of more than 20cm from such medical devices during use. Turn off the device if necessary. Before using the device, consult your doctor or the manufacturer of the medical device.
- When using the device in places such as petroleum warehouses or chemical plants where explosive gases or explosive products are present, pay attention to restrictions on use. Turn off the device if necessary.
- Electronic transmission devices are prohibited in aircraft, gas stations and hospitals. In these cases, observe all warning signs and turn off the devices when necessary.
- Do not touch the internal antenna area as it shall affect the performance of the device.
- Place the device out of the reach of children. Injury may occur if the device is used as a toy.
- Do not touch the metal part of the device while the device is running as it may cause burns.

6. Use of the device

Please use original or authorized accessories. Unauthorized accessories may affect performance of the device and violate relevant national regulations for telecommunications terminals.

- Avoid using the device inside or near metal structures that emit electromagnetic waves, which may affect signal reception.
- This device is not waterproof, please keep it dry and place it in a cool place.
- Do not use the device immediately after a sudden temperature change. Because in this case, moisture will be generated inside and outside the device, you need to wait patiently for the device to dry.
- Handle the device carefully. Do not drop, bend or impinge on it, otherwise it may be damaged.
- Non-professional are not allowed to disassemble the device, and repair work shall be carried out by qualified technicians.
- The recommended operating temperature range is 0°C~+35°C and the humidity range is 5%-95%. The ideal storage temperatures are -20 °C to +60 °C. Extreme heat or cold may damage your device or accessories.
- Do not enclose or cover your device with towels or other objects during charging.
- Do not place the device in a container with poor heat dissipation, such as a box or bag during charging.
- This product is sold with power adapter, and the original charger is recommended.
- Note: Please use the original battery. There is a danger of explosion if the wrong type of battery is used. Always dispose of the exhausted batteries according to the instructions.

7. Battery Handling

- Do not short-circuit the battery, as this can cause excessive heat and fire.

- Do not store the battery in hot areas or dispose of it in a fire, as this can cause an explosion.
- Do not disassemble or modify the battery.
- When not using the battery for a long period, remove it from your device and store it in a cool, dry place.
- Never use a damaged or worn-out charger or battery.

Return the worn-out battery to the provider or put it in an approved recycling container. Do not put it in your regular house trash.

8. EU regulatory conformance

RF exposure requirements

Important safety information regarding radio frequency (RF) radiation exposure:

RF exposure guidelines require that the device be used at a minimum of 0.5CM from the human body. Failure to observe this guideline may result in RF exposure exceeding limits.

Hereby, MeiG Smart Technology Co., Ltd. declares that this device MT504 is in compliance with Directive 2014/53/EU.

The most recent and valid version of the DoC (Declaration of Conformity) can be viewed at <https://cn.meigsmart.com/>.

Restrictions of use

This product may be used in the following European member states subject to the following restrictions. For products that operate in the frequency band 5.150 to 5.350 GHz, wireless access systems (WAS), including radio local area networks (RLANs), shall be restricted to indoor use.

| | | | | | | | | | | | |
|---|----|----|----|----|----|----|----|----|----|----|------------|
|  | AT | BE | BG | CH | CY | CZ | DE | DK | EE | EL | ES |
| | FI | FR | HR | HU | IE | IS | IT | LI | LT | LU | LV |
| | MT | NL | NO | PL | PT | RO | SE | SI | SK | TR | UK (NI) |

Certification information (SAR)

This device meets guidelines for exposure to radio waves.

Your device is a low-power radio transmitter and receiver. As recommended by international guidelines, the device is designed not to exceed the limits for exposure to radio waves. These guidelines were developed by the International Commission on Non-Ionizing Radiation Protection (ICNIRP), an independent scientific organization, and include safety measures designed to ensure the safety of all users, regardless of age and health.

The Specific Absorption Rate (SAR) is the unit of measurement for the amount of radio frequency energy absorbed by the body when using a device. The SAR value is determined at the highest certified power level in laboratory conditions, but the actual SAR level during operation can be well below the value. This is because the device is designed to use the minimum power required to reach the network.

The SAR limit adopted by Europe is 2.0 W/kg averaged over 10 grams of tissue, and the highest SAR value for this device is 1.434W/kg which complies with this limit.

9. FCC Regulations

(15C) This device complies with part 15 of the FCC Rules. Operation is subject to the following two conditions: (1) This device may not cause harmful interference, and (2) this device must accept any interference received, including interference that may cause undesired operation.

Changes or modifications not expressly approved by the manufacturer could void the user's authority to operate the equipment.

The antenna(s) used for this transmitter must not be co-located or operating in conjunction with any other antenna or transmitter.

(15B)This equipment has been tested and found to comply with the limits for a Class B digital device, pursuant to part 15 of the FCC Rules.

These limits are designed to provide reasonable protection against harmful interference in a residential installation. This equipment generates, uses and can radiate radio frequency energy and, if not installed and used in accordance with the instructions, may cause harmful interference to radio communications. However, there is no guarantee that interference will not occur in a particular installation. If this equipment does cause harmful interference to radio or television reception, which can be determined by turning the equipment off and on, the user is encouraged to try to correct the interference by one or more of the following measures:

- Reorient or relocate the receiving antenna.
- Increase the separation between the equipment and receiver.
- Connect the equipment into an outlet on a circuit different from that to which the receiver is connected.

Consult the dealer or an experienced radio/TV technician for help.

Radio Frequency (RF) Energy

This device was tested for typical body-worn operations. To comply with RF exposure requirements, a minimum separation distance of 1.0 cm must be maintained between the user's body and the device, including the antenna. Third-party belt-clips, holsters, and similar accessories used by this device should not contain any metallic components. Body-worn accessories that do not meet these requirements may not comply with RF exposure requirements and should be avoided. Use only the supplied or an approved antenna.

10. Fault Diagnosis

If you encounter problems when using MT504, try the below measurement to fix the problems:

1. If the MT504 does not respond, remove the back cover and the battery for power off, then reinstall the battery, and press the power button again for powering on.
2. If it still does not respond, try to restore factory settings.

Q&A

Q: What should I do if fails to connect the Wi-Fi SSID?

A: Follow the following steps:

1. Check whether the password you entered is correct.
2. Check whether the WPS security mechanism is enabled on your PC. If yes, please check whether the WPS on the device has been turned on.

Q: What should I do if the product out of service?

A: It may be due to network signal instability or hardware problems.

You can try the following solutions:

1. If you are in or near the building where signals may be blocked, please move to a place with better signal. For example, try moving the device close to the window.
2. Check the hardware for any loose or damaged parts.

Q: What should I do if I forget the Wi-Fi password?

A: You can restore the device to factory default settings by restoring the factory settings menu.

Q: What should I do if it fails to connect to the Data?

A: You may be in an area with weak network signal coverage, please try to move to another location or area with better network signal coverage.

Q: What should you do if the device cannot connect to the Internet when you are in abroad.

A: Make sure that you have enabled international roaming services. You can contact your service provider to enable roaming services before going abroad.