

Manual

Trek

What's in the box?

Congratulations on purchasing the **Trek Kit**!
Included in your purchase should be the following:

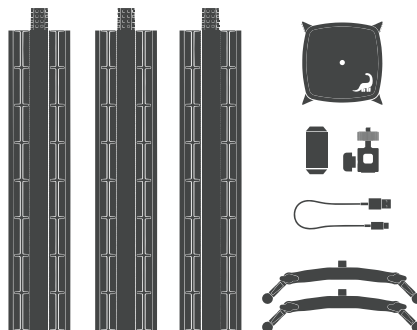

Straight Track (3pcs.) Ball Head (1pcs.) USB Cable (1pcs.)
Legs (2pcs.) Shuttle (1pcs.) Phone Mount (1pcs.)

Using Trek

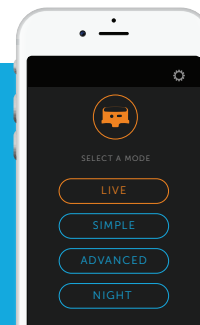

Download our free app for Android and iOS, **Dyno Trek**, which will allow you to operate your Trek camera slider system. In the app you will be able to adjust simple and advanced settings to achieve the desired shot.



Sync your Trek

When you open the Dyno Trek App, simply press "New Device" with your Trek unit turned on and the app will find and connect to your Trek.

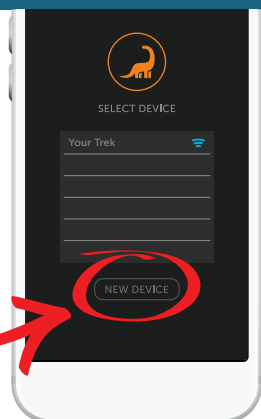

First: Connect the track pieces by inserting them end on end via the male and female connections. Connect as many pieces as you wish to achieve the shot you have in mind.

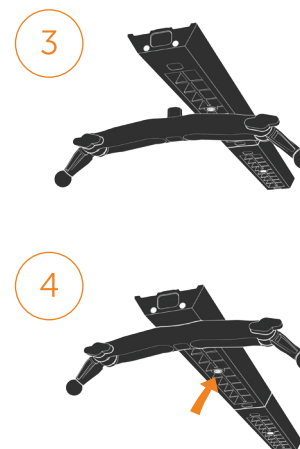
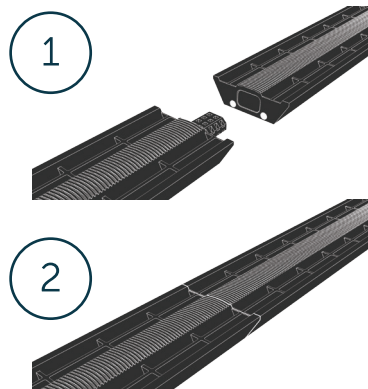

Second: Connect the legs to the bottom of the tracks by inserting them into the magnetic ports on the bottom of the track. Attach them to whichever port will satisfy the terrain you want to shoot on. (You can also attach a tripod to the bottom of the track via the threaded inserts as indicated by the orange arrow).

Third: Attach the shuttle to the track by utilizing the 4 extruded finger grips to pull apart the suspension arm. Once pulled apart, place the shuttle on top of the track in the desired location before slowly releasing the suspension arm so that the shuttle grips the track. Before starting the program, make sure the shuttle is firmly on the track by lightly pushing down on the top of the shuttle. (This ensures a proper fit).

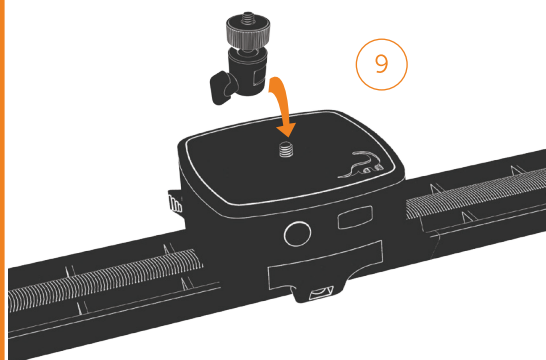
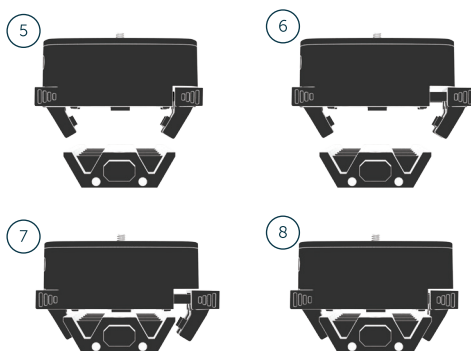

Fourth (optional): Screw the ball head to the top of the shuttle until snug. Place your smartphone in the phone mount and then screw directly to the ball head. You can choose to not use the Ball Head and screw your phone (or any camera you wish to use directly to the shuttle).

Fifth: Trek is designed to go exactly how far you tell it, without falling off the end of your track configuration. We account for the size of the shuttle in our calculations, so you do not have to over or under correct for distance. If lined up on one side of the track (shown below) and told to go the distance of that track (1ft for 1 track), the shuttle will stop at the other end without falling off.

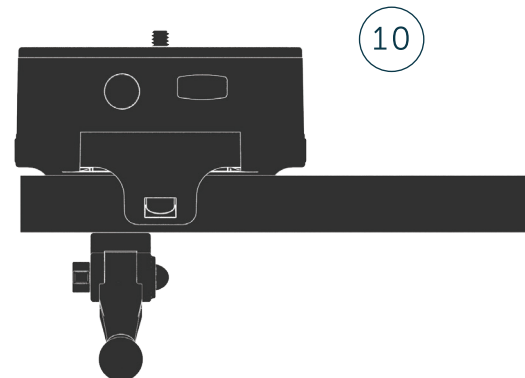

Specifications



Bluetooth
Capability



Full Range of
Incline



Lightweight



Long Exposure
Stepping



Dual Charging



Weather
Resistant



25+ Hours
Battery Life



Use your phone for video, too!

In many cases, you probably want to use your smartphone to control Trek via the app **and** use it for your shot.

Well, you can!

Once you have sent your settings to the shuttle (via Simple, Advanced, or Night modes) and it is lighting up green, exit out of the app, set up your phone for the shot you want, and when you are ready to go, press the power button on the front of the shuttle to start the movement.

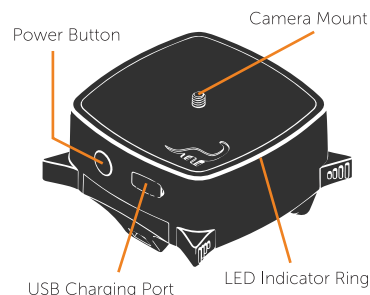

Charging

To charge the shuttle, plug the USB-C charging cable into the USB port. The light will flash red when charging and will light up green when fully charged. For best results, fully charge before use.

Troubleshooting

If the shuttle stops working, plug it into a power source to reset it.
dynoequipment.com/support

How does it work?

Take your timelapse and video to the next level with Trek.



Once you have your camera set up on the shuttle and clamped to the track, use the Dyno Trek app to control the shuttle's movements along the track.

Get Involved



facebook.com/dynoequipment



@dynoequipment



vimeo.com/dynoequipment



www.dynoequipment.com

LED Light Ring

Trek comes with a sleek LED light ring to help communicate the different states of the shuttle and your shot. Listed below are the different colors you will see and their meaning.

Blue : Indicates the shuttle is searching for Bluetooth connection (when fading), indicates the shuttle is connected to a mobile device (when blinking, then solid), and indicates the shot is over (when blinking).

Green : Indicates that your settings have been sent to the shuttle (only for Simple, Advanced, and Night modes). At this point, the shot can be started either through the Dyno Trek app or by pressing the power button on the front of the

To turn off the LED light when taking a shot, simply tap the blue light icon or the grey shuttle icon on the run time page in the app.

Warranty Information

What is covered:

Dyno Equipment warrants that Trek, when delivered to you in new condition, in original packaging, from our online store and is used in normal conditions, is free from any defects in manufacturing, materials and workmanship.

What we will do:

During the warranty period, we will, at our discretion, repair or replace (using new or refurbished replacement parts) any defective parts within a reasonable period of time and free of charge.

For more information on our terms and conditions, please visit:

www.dynoequipment.com/support



Warnings ⚠

Do not disassemble your Trek Shuttle. Changes or modifications not expressly approved by Dyno Equipment for compliance will void the user's authority to operate the equipment.

Do not operate underwater or outside of our operating temperature range (0-50° C).

Make sure to not run the shuttle farther than the amount of track you have set up, to make sure the shuttle does not fall off the end.

Use only with approved USB charging devices.

Do not use other tracks with the shuttle. It has been designed to work with only the ones provided by Dyno Equipment.

Per FCC 15.19(a)(3) and (a)(4) This device complies with part 15 of the FCC Rules. Operation is subject to the following two conditions: (1) This device may not cause harmful interference, and (2) this device must accept any interference received, including interference that may cause undesired operation.

Per RSS-Gen, Section 8.4 This device complies with Industry Canada license-exempt RSS standard(s). Operation is subject to the following two conditions: (1) this device may not cause interference, and (2) this device must accept any interference, including interference that may cause undesired operation of the device.

Ce dispositif est conforme à la norme RSS-Gen, Section 8.4 d'Industrie Canada applicable aux appareils radio exempts de licence. Son fonctionnement est sujet aux deux conditions suivantes: (1) le dispositif ne doit pas produire de brouillage préjudiciable, et (2) ce dispositif doit accepter tout brouillage reçu, y compris un brouillage susceptible de provoquer un fonctionnement indésirable.

Operational frequency bands: 2402MHz - 2480MHz (2MHz separation, 40 channels. Maximum power output: 800uW.

