

WIRELESS CHARGER

Please read this operation instruction carefully and keep it properly before using this product.

Thank you for purchasing and using this product!

In order to bring you a better experience, read this manual and also please refer to your mobile phone or your electronic product manual.

Product Specifications

Product Name	Wireless Charger
Model	CDRZ44
Size	≈(84×97×10)mm
Net Weight	≈85g
Power	TX-5W, 7.5W, 10W (Max)
Charging Induction Distance	≈(4~6)mm
Applicable Model	The Qi standard of iPhones, Samsung, LG, Moto and others who will support wireless charging function.
Product List	Wireless charger ×1, Instruction book ×1, Instruction card ×1

The parameters above are derived from the laboratory of ANDOBIL, The actual parameter would be different because of products or other factors. The image shown here is indicative only.

Product Overview

Charging Induction Distance: The induction distance between the inner induction coil of the mobile phone and that of charger is 4-6mm, the thickness of mobile phone case should not exceed 4mm, please do not use a case which is too thick while charging.

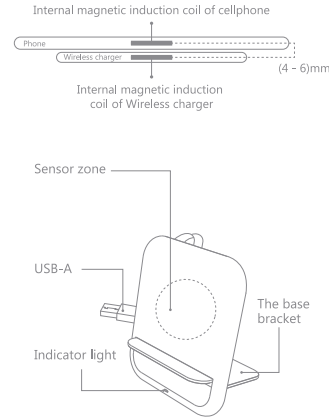

Instructions

1. When connected to the power, the blue LED light will be on and then turn off, enter standby mode.
2. Put your phone in the induction area, the blue LED light will turn on, then it works.
3. The blue LED light will flash when it feels any metal foreign object. Charging protection mode will open, you can't charge until removing foreign object.
4. Two models of use: A Stand or a pad. Shown as the picture: Hold the main body by one hand, then flip the base up by the other hand.

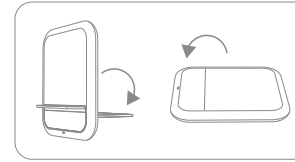

Note: Facility can be charged only when it meets Qi standards.

The LED light display status of wireless charger

Charging status	LED light display status
Power on	LED lights blue and then turn off
Standby	LED lights off
Charging	LED light always on blue light
Full charged	LED lights off(Samsung series) / LED always on blue light(iphone series)
Foreign body sensation	LED blue light flashing (1s/ time)



Notes

1. Do not disassemble, impact, crush or throw it into fire. If there is serious swelling, do not continue to use it. Do not leave it in a hot environment.
2. Please do not use the wireless charger under severe high temperature, humidity, or corrosive conditions to avoid the circuit being damaged which will lead to infinite leakage.
3. Please keep it away from magnetic card(ID Card or Bank Card) with magnetic stripe or chip, for it may cause magnetic failure.
4. Please don't put metal or metal case on the charger.
5. Please keep the distance between the implanted medical device (pacemaker, implant cochlea, etc.) and wireless charger at least 20cm.
6. Please keep the charger away from water or other liquid.
7. If the charger needs cleaning, please make sure the power is off.
8. Please do not let children play it as a toy.
9. Please keep the temperature is between 0 C to 40 C when yo use it.



FCC Statement

This device complies with part 15 and part 18 of the FCC Rules. Operation is Subject To the following two conditions:

(1) This device may not cause harmful interference, and (2) this device must accept any interference received, including interference that may cause undesired operation. Changes or modifications not explicitly approved by the party responsible for compliance could void the user's authority to operate this equipment.

Note: this equipment has been tested and found to comply with the limits for a Class B digital device, pursuant to part 15 and part 18 of the FCC Rules. These limits are designed to provide reasonable protection against harmful interference in a residential installation. This equipment generates, uses and can radiate radio frequency energy and, if not installed and used in accordance with the instructions, may cause harmful interference to radio communications. However, there is no guarantee that interference will not occur in a particular installation. If this equipment does cause harmful interference to radio or television reception, which can be determined by turning the equipment off and on, the user is encouraged to try to correct the interference by one or more of the following measures:

- Reorient or relocate the receiving antenna.
- Increase the separation between the equipment and receiver.
- Connect the equipment into an outlet on a circuit different from that to which the receiver is connected.
- Consult the dealer or an experienced radio/TV technician for help.

The equipment complies with FCC radiation exposure limits set forth for an uncontrolled environment. During the operation of device a distance of 15 cm surrounding the device and 20 cm above the top surface of the device must be respected.

This device complies with Part 18 of the FCC Rules. This equipment generates uses and can radiate radio frequency energy and, if not installed and used in accordance with the instructions, may cause harmful interference to radio communications. If this equipment does cause harmful interference to radio or television reception, which can be determined by turning the equipment off and on, the user is encouraged to try to correct the interference by one or more of the following measures:

- Increase the separation between the equipment and any other radio device.
- Connect the equipment into an outlet on a circuit different from that to which the receiver is connected.

Warranty Card

Customer Name: _____

Phone Number: _____

Product Name: _____

Date of Purchase: _____

Address: _____

Notes: _____

WWW.ANDOBIL.COM

Email: support@andobil.com

Add: 322, Bldg. 7, Pengsheng Village, No.39 Bagua 1 Rd., Pengsheng CMNY, Yuanling St Futian Dist., Shenzhen CHINA

Shenzhen Andobil Technology Co., Ltd. Andobil is the trademark registered in U.S and other countries. All rights reserved.

MADE IN CHINA