

Model # NAW-001
AIRNANO Fast Wireless Charger

For Qi-enabled devices

User Manual

NAW-001

AIRNANO Fast Wireless Charger

About AIRNANO Fast Wireless Charger

With AIRNANO Wireless Charger NAW-001, you can charge your compatible phone easily at all times. Put your phone on Nano Pad, and charging starts immediately.

Package Contents

- AIRNANO Qi Fast Wireless Charger
- Micro 5 Pin USB Charge/sync Cable
- Universal Car Phone Cradle
- User Manual

Features

*** Magic Nano Suction Foam Pad of our own technology & design**

- Smart phone keeps sticking on AIRNANO for over a year without dropping
- 2.8mm thickness / Copper Foil Laminated Nano Suction Foam Technology with high surface tension & air absorption force

*** 3 Different Applications with one Nano Pad Head**

- A. Car Dashboard
- B. Car Vent Hole
- C. Tabletop Mounting

*** Compact / simple / slim / minimalistic design as interior decoration**

- No clamps, no cradles
- To protect your phone from scratches
- Easily rotatable to either landscape or portrait orientation

• Fast Wireless Charging

- Charges on contact
- Reliable Wireless Charging to be compatible with all Qi- standard smart phones
- High-speed charging : Output Operating Voltage Max. 9V
- No over-heat by special designed mechanical design
- Over-charging / over-temperature protection
- Low standby current draw lets you leave the wireless charging base plugged in when not in use.

*** Universal Wireless Charger**

- To be compatible with all smart phones/mini tablet
- Phone Cradle for extremely porous & uneven phone/case surfaces

Compatibility

AIRNANO Qi Wireless Charger is optimized to work with all the devices with Qi wireless technology



Nano Pad Head

NAW-001
AIRNANO Fast Wireless Charger

Put your phone on AIRNANO Nano Pad Head

Just drop your on the Nano Pad and enjoy the ride.
You can use easily your AIRNANO Nano Pad Head both horizontally and vertically



Remove the plastic protection film off Nano Pad.



Mount Smart Phone on Nano Pad.



Rotate into any directions



Fix smart phone to your favorite angle.



Keep Nano Pad cleaned against dusts and stains with wet tissue, to restore absorption force.

Compatibility with various phone / case surfaces

Nano Suction Foam Pad with 2.8mm thickness & copper foil laminated bonds well to smooth, flat, clean surfaces like a suction cup with millions of microscopic craters that work by creating a lot of partial vacuums between the Pad & Smart Phone. So, as you press down phone firmly, there will be more powerful absorption force.

- A. On smooth, even, non-porous surface, you can just drop phone on Nano Pad
- B. On normally uneven/porous surface, press down phone firmly on Nano Pad
- C. On extremely uneven/porous surface, you can attach Universal Car Phone Cradle
- D. Make sure to keep AIRNANO charging pad clean against dusts and stains by wet tissue

Universal Car Phone Cradle

Car Phone Cradle, adapt to a variety of road conditions, allows AIRNANO Pad to hold phone/case with extremely uneven surfaces in place tighter than any other Qi chargers, ensuring that your phone stays properly aligned for charging.



Put the Car Phone Cradle on the hole of Nano Pad backside



Turn the Cradle downwards to USB Port to lock it up. When not needed, you can put the support aside, or detach it.



Car Phone Cradle can be adjusted upwards and downwards to fit the charging position of different mobile phones

LED Indicator Status

LED	Status
Blue	Charging complete
Red	Device is charging
Red Blinking	Normal Error
Stand-by	No LED

Troubleshooting

Device not charging/LED is blinking red

- Make sure that your device is Qi-enabled.
- Make sure that your charging pad is connected to a car cigar jack
- Make sure that your device is positioned correctly on your AIRNANO charging pad.
- Make sure that there is no other objects on the charging pad.
- Make sure that AIRNANO charging pad is not wet.

Device charges slowly

- Make sure that your device is positioned correctly on your AIRNANO charging pad.

NAW-001

AIRNANO Fast Wireless Charger

Specification

- Input Voltage : 5V/2A , 9V / 1.67A
- Operating Frequency : 112 ~ 181KHz
- Charging Distance : 7 ~ 8mm
- Operating Voltage : 9V
- Operating Temperature : -20 ~ +65°C
- Efficiency : max 75%
- Interface : Micro USB

Product Warranty Period

One year from date of purchase

If you experience any problems during use, please contact us at the address below.

<http://www.newscon.co.kr>

A. AIRNANO Car Dashboard Fast Wireless Charger

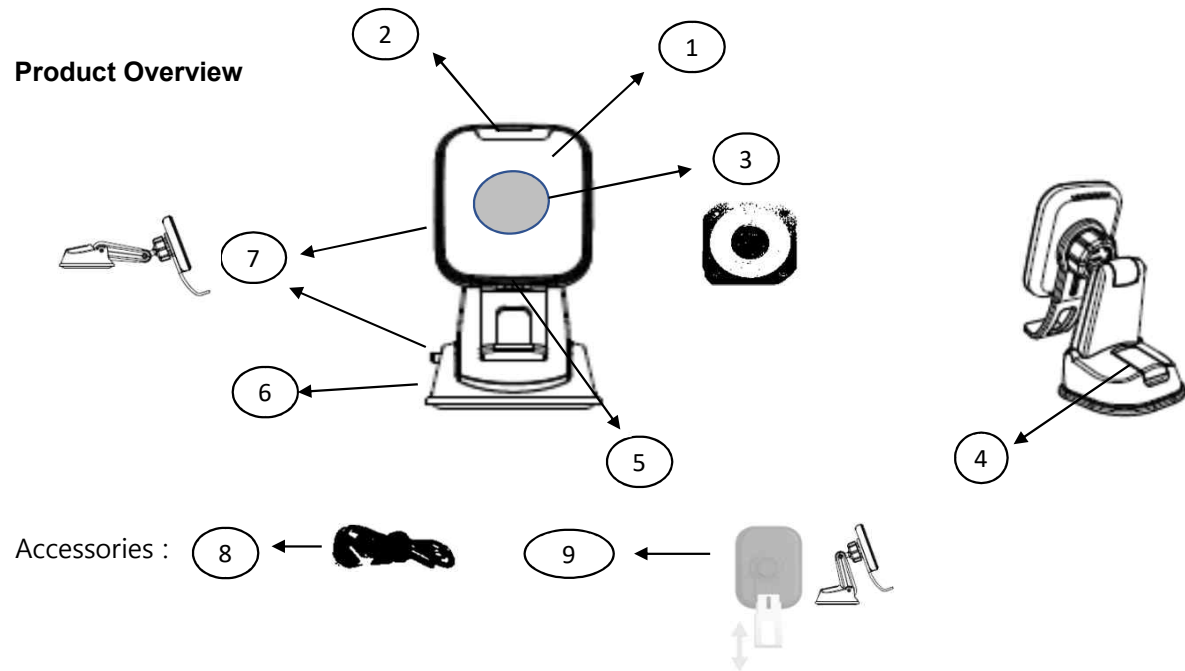

No	Parts
1	AIRNANO Charging Pad
2	Charging Status LED
3	Wireless Charger Transmitter - Wireless Charging Area : 18 x 20 x 8mm
4	Mount Locking Lever
5	Micro 5 Pin USB Connector
6	Gel Suction Cup
7	Adjustable Arm / Head Knob
8	Micro 5 Pin USB Cable
9	Universal Car Phone Cradle

Attach the gel suction cup on the dashboard

Find an easily-accessible spot for AIRNANO Gel Pad on the dashboard of your car. Some treatments on the dashboard or dirt on the suction cup may result in a significantly less effective bond. So before you start, remove such treatments and make sure that the cup is clean.

1. Place the gel suction cup in a good spot on the dashboard, Press down firmly and evenly.
2. Make sure the locking lever is released.
3. Press down AIRNANO holder, and snap the locking lever closed.



1. Remove the plastic protection film off from the gel suction cup.



2. Press down Gel Pad firmly



3. Lock up the lever to fix



4. Washing and drying Gel Pad restore the absorption force.

Remove the holder from the dashboard

Push the mount locking lever inwards, and lift from the tab on the edge of the suction cup.

A. AIRNANO Car Dashboard Fast Wireless Charger

Connect the cables

1. Connect the supplied micro USB charge/sync cable to the micro USB port on your AIRNANO pad and to the car charger's USB port.
Insert the car charger into the car's cigarette lighter socket.

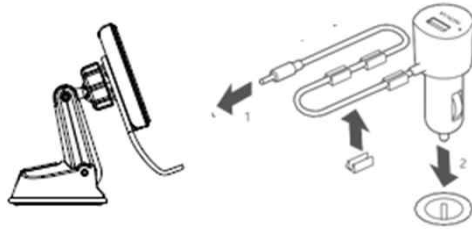

2. Place your Qi-enabled device on the center position of AIRNANO Pad with the screen facing up. When driving. The LED is red when your device is charging.



Note : If the LED is blinking red, your device is not charging. See "Troubleshooting" for more information.

A. AIRNANO Car Dashboard Fast Wireless Charger

Charge your phone

Whenever the power supply is plugged in, AIRNANO charges your phone.

To start charging, just drop your on the Nano Pad and enjoy the ride.

An indicator light switches on. When the area around the AIRNANO pad free. If there is something in AIRNANO pad as well as your phone, The phone doesn't charge, and the indicator light blinks quickly.

It is normal for AIRNANO and phone to get warm, and they may get even warmer if you use your phone to, for example, navigate while driving. Charging may be less efficient if you use your phone for activities that need a lot of power, such as navigating and making a call at the same time.

You can use easily your AIRNANO Nano Pad Head both horizontally and vertically



Drop your phone on Nano Pad on the center position.

Then it starts charging safety. Enjoy hands-free calling with your phone.

When driving. Wireless Charger support multi high power output up to 10W.

<Notices>

1. When cleaning the wireless charger, be careful not to keep AIRNANO wet.
2. Keep the AIRNANO Pad clean against dusts and stains by wet tissue

B. AIRNANO Car Vent Hole Fast Wireless Charger

Product Overview

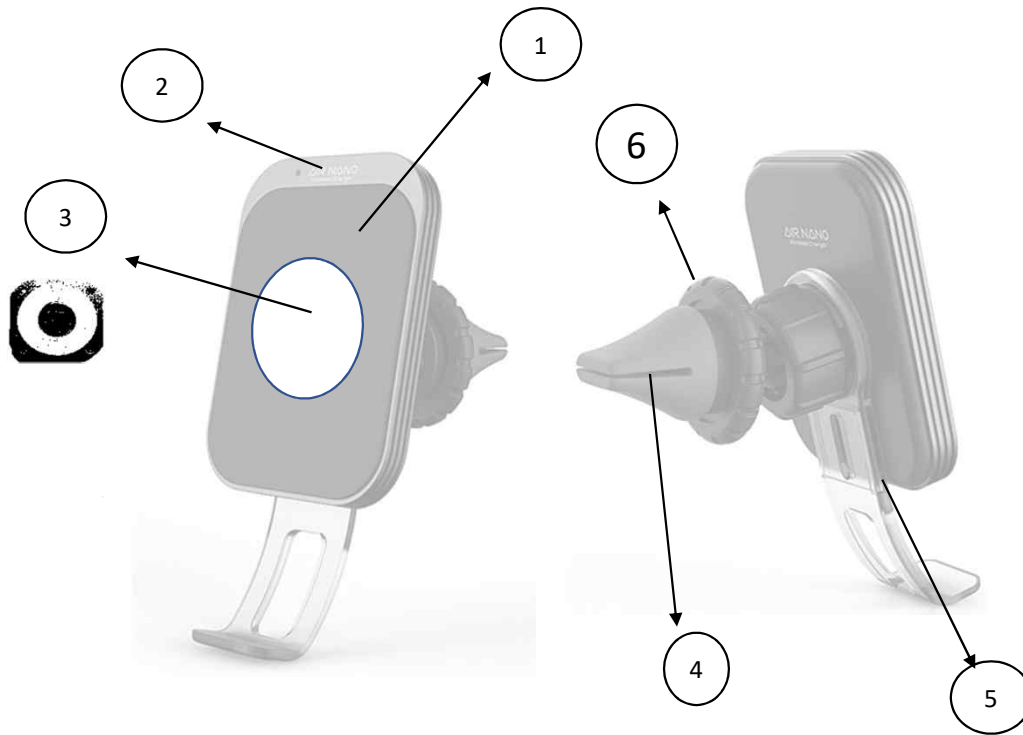

No	Parts
1	AIRNANO Charging Pad
2	Charging Status LED
3	Wireless Charger Transmitter - Wireless Charging Area : 22 x 20 x 8mm
4	Vent Mount Finger
5	Micro 5 Pin USB Connector
6	Locking Joint
7	Micro 5 Pin USB Cable
8	Universal Car Phone Cradle
9	Heat Prevention Cradle + Joint

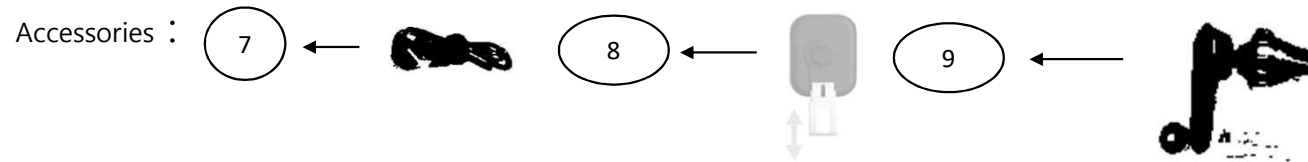

B. AIRNANO Car Vent Hole Fast Wireless Charger

Connect the cables

1. Connect the supplied micro USB charge/sync cable to the micro USB port on your AIRNANO pad and to the car charger's USB port.
Insert the car charger into the car's cigarette lighter socket.

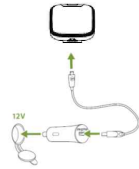

2. Slide the vent mount's fingers over one of your vehicle's vent louvers to attach.
(The mounting fingers can be rotated to accommodate two different louver thickness.)

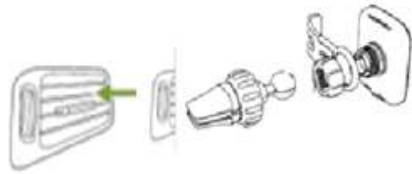

3. Place your compatible device against the vent mount.
The vent mount will securely hold the device and automatically align it for a proper charge.



B. AIRNANO Car Vent Hole Fast Wireless Charger

Using AIRNANO Vent Mount

1. Charging will automatically begin when you place a compatible device against the vent mount. You can rotate the vent mount so your device is in either portrait or landscape orientation.

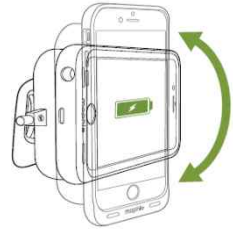

IMPORTANT : Do not direct heated air from the vent onto the vent mount while it is attached to the vent. This can damage the vent mount and a docked device. When running the vehicle's heater, completely close the vent the vent mount is attached to, or direct the heated air out of the vehicle's lower vents and entirely away from the upper vents, or connect Heat Prevention Cradle .

- **Heat Prevention Cradle**

To avoid direct heated air from the air vent, you can install the mechanical support. Connect the Heat Prevention Cradle with the joints between Nano Pad & Vent Mount.

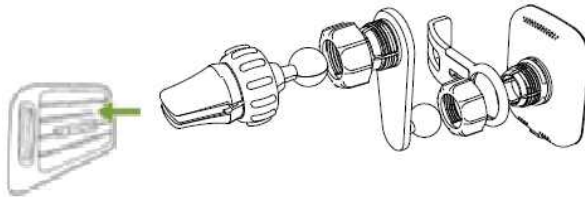

B. AIRNANO Car Vent Hole Fast Wireless Charger

Charge your phone

Whenever the power supply is plugged in, AIRNANO charges your phone.

To start charging, just drop your on the Nano Pad and enjoy the ride.

An indicator light switches on. When the area around the AIRNANO pad free. If there is something in AIRNANO pad as well as your phone, The phone doesn't charge, and the indicator light blinks quickly.

It is normal for AIRNANO and phone to get warm, and they may get even warmer if you use your phone to, for example, navigate while driving. Charging may be less efficient if you use your phone for activities that need a lot of power, such as navigating and making a call at the same time.

You can use easily your AIRNANO Nano Pad Head both horizontally and vertically

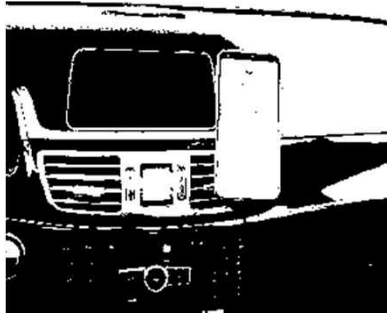

Drop your phone on Nano Pad on the center position.

Then it starts charging safety. Enjoy hands-free calling with your phone.

When driving. Wireless Charger support multi high power output up to 10W.

<Notices>

1. When cleaning the wireless charger, be careful not to keep AIRNANO wet.
2. Keep the AIRNANO Pad clean against dusts and stains by wet tissue

C. AIRNANO Tabletop Mounting Fast Wireless Charger

Product Overview

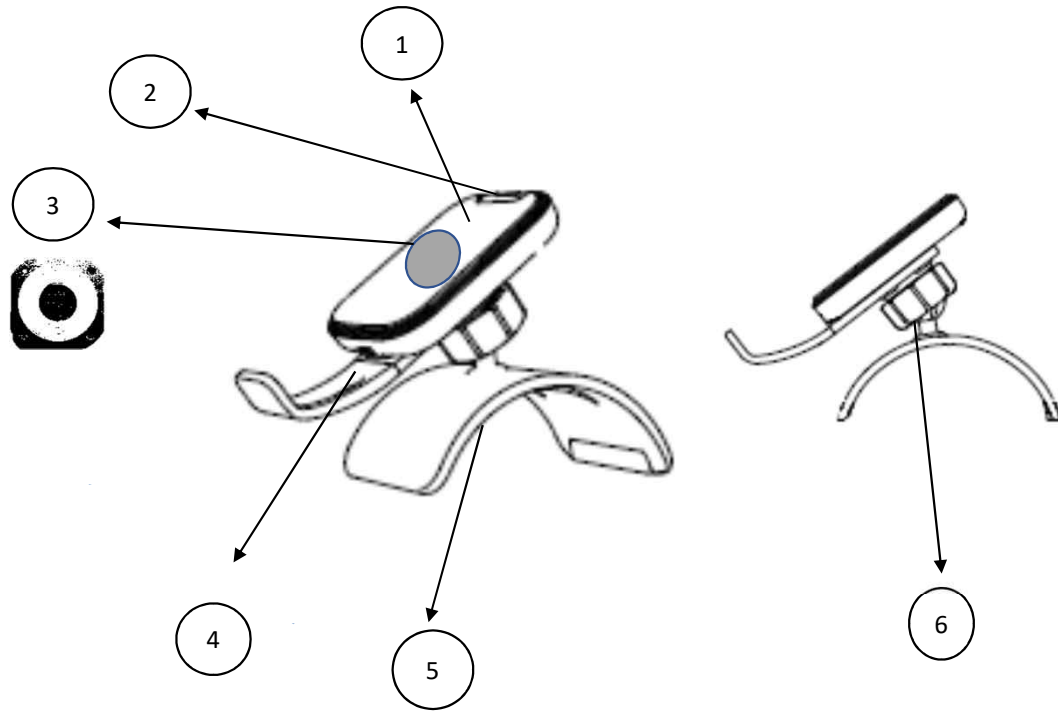

No	Parts
1	Nano Charging Pad
2	Charging Status LED
3	Wireless Charger Transmitter - Wireless Charging Area : 18 x 20 x 8mm
4	Micro 5 Pin USB Connector
5	Stand
6	Joint to connect Nano Pad & Stand
7	Micro 5 Pin USB Cable
8	Universal Phone Cradle

Accessories :

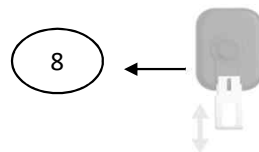
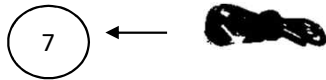

C. AIRNANO Tabletop Mounting Fast Wireless Charger

Charging your wireless device

1. Connect the AC wall adapter to the charging base and to the wall outlet.

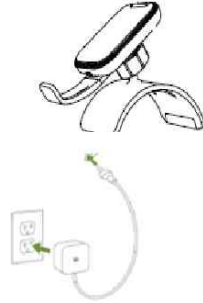

2. Place the wireless device on the wireless charging base as shown in the illustration below. Make sure the center of the device is aligned over the center of the charging base. Charging will begin on contact.

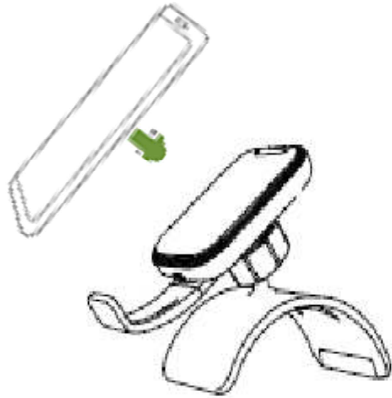

NAW-001
AIRNANO Fast Wireless Charger

Warranty

We are dedicated to making the best quality products.
To back this up, this product is warranted for 2 years from date of purchase.
This warranty does not affect any statutory rights that you may be entitled to.
Keep a copy of your purchase receipt as proof of purchase.

Warning

Read all instructions and warnings prior to using this product. Improper use of this product may result in product damage, Excess heat, toxic fumes, fire or explosion.

- * Do not direct heated air from the vent onto the vent mount while it is attached to the vent.
When running the vehicle's heater, completely close the vent the vent mount is attached to, or direct the heated air out of the vehicle's lower vents and entirely away from the upper vents, or apply Heat Prevention Cradle.
- * Do not store device in high-temperature environment, including heat caused by intense sunlight or other forms of heat.
Do not place device in fire or other excessively hot environments.
- * Do not disassemble this device or attempt to re-purpose or modify it in any manner.
- * Do not attempt to power this device using any method, apparatus, or connection other than the device's micro-USB connector.
For questions or instructions for the various ways to power the device refer to the illustrations in this user manual.
- * Do not attempt to replace any part of this device.
- * If this device is intended by Purchaser to be used by a minor, purchasing adult agrees to provide detailed instructions and warnings to any minor prior to use.
Failure to do so is sole responsibility of purchaser, who agrees to indemnify Manufacturer for any unintended use/misuse by a minor.
- * All products have gone through a thorough quality assurance inspection. If you find that your device is excessively hot, is emitting odor, is deformed, abraded, cut or is experiencing or demonstrating an abnormal phenomenon, immediately stop all product use and contact Manufacturer.

NAW-001

AIRNANO Fast Wireless Charger

Product and safety info

General safety instructions

Read these simple guidelines. Not following them may be dangerous or illegal. For further information, read the complete user guide. Obey all local laws. Always keep your hands-free to operate the vehicle while driving. Your first consideration while driving should be road safety. Only operate the mounting device or mobile holder if it is safe to do so under all driving conditions.

When you install the mounting device or mobile holder, make sure that they do not interfere with or hinder the steering or braking systems or other systems used in the operation of the vehicle (for example) or disturb your field of vision while driving.

Check that the deployment of the airbag is not blocked or impaired in any way. Make sure that the mounting device or mobile holder is not installed where you might come in contact with it in the event of an accident or collision.

Periodically check that the suction cup at the bottom of the mounting device is firmly attached to the windscreen or the dashboard, especially if the ambient temperature changes a lot.

Take care of your device

Handle your device, charger and accessories with care. The following suggestions help you keep your device operational.

- Keep the device dry. Precipitation, humidity, and all types of liquids or moisture can contain minerals that corrode electronic circuits. If your device gets wet, let the device dry.
- Use the charger for intended purposes only. Improper use, or use of incompatible may present a risk of fire, explosion, or other hazard. Never use a damaged charger.
- Do not attempt to charge a device having a damaged, cracked or open battery case or a device that is not compatible with Qi.
- Do not use or store the device in dusty or dirty areas.
- Do not store the device in high temperatures. High temperatures may damage the device.
- Do not store the device in cold temperatures. When the device warms to its normal temperature, moisture can form inside the device and damage it.
- Unauthorized modifications may damage the device and violate regulations governing radio devices.
- Do not drop, knock, or shake the device or the battery. Rough handling can break it.
- Only use a soft, clean, dry cloth to clean the surface of the device.

Copyrights and other notices



DECLARATION OF CONFORMITY

Hereby, we, Newscon Corporation, declares that this NAW-001A product is in compliance with the essential requirements and other Relevant provisions of Directive 2004/108/EC.

This availability of products may vary by region. For more info, contact your dealer. This device may contain commodities. Technology or software subject to export laws and regulations from the US and other countries. Diversion contrary to law is Prohibited.

The contents of this document are provided "as is". Except as required by applicable law, no warranties of any kind, either express Or implied, including, but not limited warranties of merchantability and fitness for a particular purpose, are made In relation to the accuracy, reliability or contents of this document.
We reserves the right to revise this document or withdraw it at any time without prior notice.

To the maximum extent permitted by applicable law, under no circumstances shall Newscon Corporation or any of its licensors be responsible for any loss of data or income or any special, incidental, consequential or indirect damages howsoever caused.

Reproduction, transfer or distribution of part or all of the contents in this document in any form without the prior written permission of Newscon Corporation is prohibited. Newscon Corporation operates a policy of continuous development. Newscon Corporation reserves the right to make changes and improvements to any of the products described in this document without prior notice.

FCC/Industry Canada Notice

This device complies with part 15 of the FCC rules and Industry Canada license-exempt RSS standard. Operation is subject to the following two conditions : (1) This device may not cause harmful interference, and (2) this device must accept any interference, received, including interference that may cause undesired operation.

Note : This equipment has been tested and found to comply with the limits for a Class B digital device, pursuant to part 15 of the FCC Rules. These limits are designed to provide reasonable protection against harmful interference in a residential installation. This equipment generates, uses and can radiate radio frequency energy and, if not installed and used in accordance with the instructions, may cause harmful interference to radio communications. However, there is no guarantee that interference will not occur in a particular installation. If this equipment does cause harmful interference to radio or television reception, which can be determined by turning the equipment off and on, the user is encouraged to try to correct the interference by one or more of the following measures:

- Reorient or relocate the receiving antenna.
- Increase the separation between the equipment and receiver.
- Connect the equipment into an outlet on a circuit different from that to which the receiver is connected.
- Consult the dealer or an experienced radio/TV technician for help.

FCC Compliance Statement

This device complies with part 15 of the FCC rules. Operation is subject to the following two conditions: (1) This device may not cause harmful interference, and (2) this device must accept any interference received, including interference that may cause undesired operation.

FCC Caution

Any changes or modifications not expressly approved by the party responsible for compliance could void the user's authority to operate this equipment. This transmitter must not be co-located or operating in conjunction with any other antenna or transmitter.

FCC Radiation Exposure Statement

This equipment complies with FCC radiation exposure limits set forth for an uncontrolled environment. This equipment should be installed and operated with minimum distance 20 cm between the radiator and your body. This transmitter must not be co-located or operating in conjunction with any other antenna or transmitter.