

# **SYLVANIA**

## **WIRELESS SPEAKER**

**MODEL NO. : SP429**

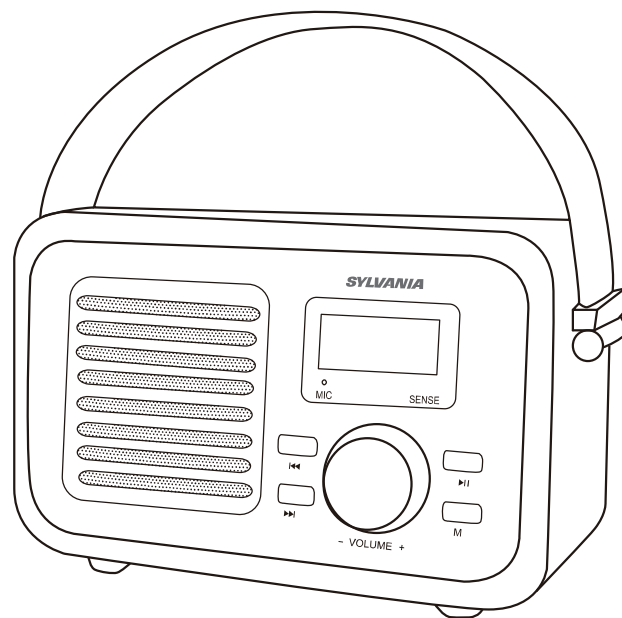

## **Instruction Manual**

Thank you for purchasing this product.  
Please read this manual carefully, and  
save it for future reference.

SYLVANIA is a registered trademark of  
OSRAM Sylvania Inc. used under license.

# TABLE OF CONTENTS

<b>Warnings and Precautions</b> .....	<b>1</b>
<b>Important Safety Instructions</b> .....	<b>2</b>
<b>Product Features</b> .....	<b>3</b>
<b>Package Contents</b> .....	<b>3</b>
<b>Device Overview</b> .....	<b>4</b>
Speaker Overview.....	4
RemoteControl.....	5
Replace the Remote Control Battery.....	6
<b>Getting Started</b> .....	<b>7</b>
Installing the USB Power Cable.....	7
Charging the Built-in Battery .....	7
<b>Operating the Picnic Speaker</b> .....	<b>8</b>
Power On/Off the Speaker .....	8
Bluetooth Audio Streaming / Bluetooth Phone-calling.....	9
Using the USB Port .....	10
Using the TF Card Slots .....	11
Listening to the Radio .....	12
Using the AUX Input .....	13
<b>Product Specifications</b> .....	<b>14</b>
<b>Trouble Shooting Guide</b> .....	<b>14</b>

# WARNINGS AND PRECAUTIONS

**WARNING:** To reduce the risk of fire or electric shock, do not expose this apparatus to rain or moisture.

**CAUTION:** Use of any controls or adjustments or performance of procedures other than those herein specified may result in hazardous radiation exposure.

**WARNING:** Changes or modifications to this unit not expressly approved by the party responsible for compliance could void the user's authority to operate the equipment.

**WARNING:** Do not place the unit on top of any soft, porous, or sensitive surfaces to avoid damaging the surface. Use a protective barrier between the unit and surface to protect the surface.

**CAUTION:** Danger of explosion if battery is incorrectly replaced. Replace only with the same or equivalent type.

**WARNING:** The battery, batteries, and battery pack shall not be exposed to excessive heat such as sunshine, fire, or the like.

**WARNING:** Lithium batteries, like all rechargeable batteries are recyclable and should be recycled or disposed of in normal household waste. Contact your local government for disposal or recycling practices in your area. They should never be incinerated since they might explode.

**WARNING:** Shock hazard - Do Not Open.

# IMPORTANT SAFETY INSTRUCTIONS

1. Read these Instructions.
2. Keep these Instructions.
3. Heed all Warnings.
4. Follow all instructions.
5. Do not use this apparatus near water.
6. Clean only with a dry cloth.
7. Do not block any ventilation openings. Install in accordance with the manufacturer's instructions.
8. Do not install near any heat sources such as radiators, heat registers, stoves, or other apparatus (including amplifiers) that produce heat.
9. Only use attachments/accessories specified by the manufacturer.

---

10.



Use only with a cart, stand, tripod, bracket, or table specified by the manufacturer, or sold with the apparatus. When a cart is used, use caution when moving the cart/apparatus combination to avoid injury from tip-over.

---

11. Unplug this apparatus during lightning storms or when unused for long periods of time.
12. Refer all servicing to qualified service personnel. Servicing is required when the apparatus has beendamaged in any way, such as power-supply cord or plug is damaged, liquid has been spilled or objects have fallen into the apparatus, the apparatus has been exposed to rain or moisture, does not operate normally, or has been dropped.

**Special note:** When placing your unit on a lacquered or natural finish, protect your furniture with a cloth or other protective material.

## PRODUCT FEATURES

- Bluetooth technology: V4.2
- Bluetooth transmission range: 10M (Free space)
- Leather carry handle
- Sound output: 3W (max.)
- USB & TF card support direct music play
- FM radio
- 3.5mm auxiliary input (stereo mini jack)
- Built-in Lithium-ion rechargeable battery
- Power rating: DC 5V / 1.0A (via Micro-USB port)

## PACKAGE CONTENTS

Please make sure that the items shown below are included in the package. Should an item be missing, please contact the local retailer from which you purchased this product.

- Bluetooth speaker: 1 pcs
- Instruction manual: 1 pcs
- USB charging cable: 1 pcs
- 3.5mm stereo audio cable: 1 pcs
- Warranty card: 1 pcs
- Remote Control: 1pcs

# DEVICE OVERVIEW

## Speak Overview

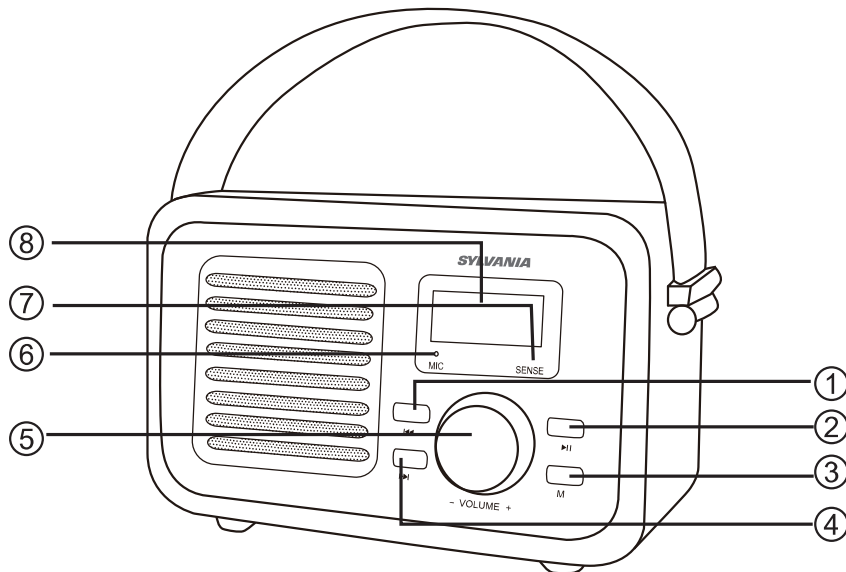

### ① ◀◀ (PREVIOUS)

- FM Radio Mode:  
Skips to previous channel.
- USB/TF Card Player Mode:  
Skips to previous track;  
Press and hold it for fast rewind.
- Bluetooth Mode:  
Skips to previous track.
- Line In Mode:  
Not applicable.

### ④ ▶▶ (NEXT)

- FM Radio Mode:  
Skips to next channel.
- USB/TF Card Player Mode:  
Skips to next track;  
Press and hold it for fast forward.
- Bluetooth Mode:  
Skips to next track.
- Line In Mode:  
Not applicable.

### ② ▶|| (PLAY/PAUSE)

- Bluetooth/FM/USB/TF Card Mode:  
Starts or pauses play back.
- Bluetooth Phone-calling Mode:  
Answers or hangs up the phone.  
short press once to answer / press  
and hold it for seconds to reject when  
a call comes in.  
Press and hold the play button  
for three seconds to redial the last  
call.
- FM Radio Mode:  
press once it can go to auto search  
mode and auto store all the stations.

### ⑤ VOLUME KNOB

- Turn clockwise to increase volume;
- Turn counterclockwise to decrease  
volume.

### ⑥ MIC

- Built-in microphone.

### ⑦ SENSE

- Built-in remote control sensor.

### ③ M (MODE)

- Switches working mode among  
USB/TF/AUX/FM/Bluetooth.

### ⑧ DISPLAY

- Displays information.

## RemoteControl

Note: Before first time use, pull the plastic tab sticking out of the remote control. It protects the battery and the remote control will not work unless it is removed.

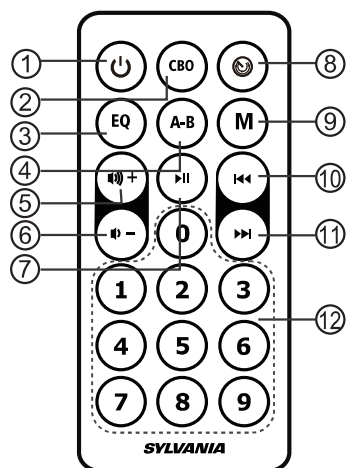

### ① Power on/off

### ② Repeat mode

- USB or TF card player mode:  
Switches repeat mode among Folder/Single/All/Random/Selections play/No repeat.

### ③ EQ

- Bluetooth/USB/TF card mode:  
Switches repeat mode among preset EQ: Classic/Country/Jazz/Normal/Popular/Rock.
- FM radio / LINE IN mode:  
Not applicable.

### ④ Repeat A-B

- USB/TF card mode:  
Sets start point A and ending point B to play back repeatedly.
- Bluetooth/FM/LINE IN mode:  
Not applicable.

### ⑤ Volume +

- Increases volume.

### ⑥ Volume -

- Decreases volume.

### ⑦ Play / pause

- Bluetooth/FM/USB/TF Card Mode:  
Starts or pauses play back.
- Bluetooth Phone-calling Mode:  
Answers or hangs up the phone.  
short press once to answer / press and hold it for seconds to reject when a call comes in.  
Press and hold the play button for three seconds to redial the last call.
- FM Radio Mode:  
Starts or stops auto channel search.

### ⑧ Radio automatic search

- FM Radio mode:  
Press and hold for appr. 2 seconds to start auto channel search and memory.  
Press again to stop channel search and play the first stored channel.
- The other modes:  
Not applicable.

### ⑨ Mode

- Switches working mode among USB/TF/AUX/FM/Bluetooth.

### ⑩ ◀◀ (PREVIOUS)

- FM Radio Mode:  
Skips to previous channel.
- USB/TF Card Player Mode:  
Skips to previous track;  
Press and hold it for fast rewind.
- Bluetooth Mode:  
Skips to previous track.
- Line In Mode:  
Not applicable.

### ⑪ ▶▶ (NEXT)

- FM Radio Mode:  
Skips to next channel.
- USB/TF Card Player Mode:  
Skips to next track;  
Press and hold it for fast forward.
- Bluetooth Mode:  
Skips to next track.
- Line In Mode:  
Not applicable.

### ⑫ 0-9 numbers

## Replace the Remote Control Battery

1. Hold the remote control with the buttons facing down.
2. Push and hold the small release tab while pulling the battery tray out.
3. Replace the “CR2025” Lithium battery on the tray with the positive (+) side facing up.
4. Push the tray back in until it clicks into place.



### Note:

- *To use the remote control, point it towards the remote sensor in the lower right-hand corner of the LED screen, within a range of five (5) meters from the speaker at an angle of up to 30 degree.*
- *The remote control will not operate if its path is blocked.*
- *If the remote control will not be used for a long period of time, take out the batteries and place the remote control in a cool and dry place.*



### **WARNING!**

Button cell batteries can cause serious injury or death if swallowed. Dispose of safely! Store batteries out of reach of children!



# GETTING STARTED

## Installing the USB Power Cable

Insert the Micro-USB connector of the USB cable (supplied) into the DC 5V socket at the back of the speaker fully and firmly, and then plug the other end of the cable to a corresponding USB port of your PC, adapter or other device which support DC 5V / 1.0A output.

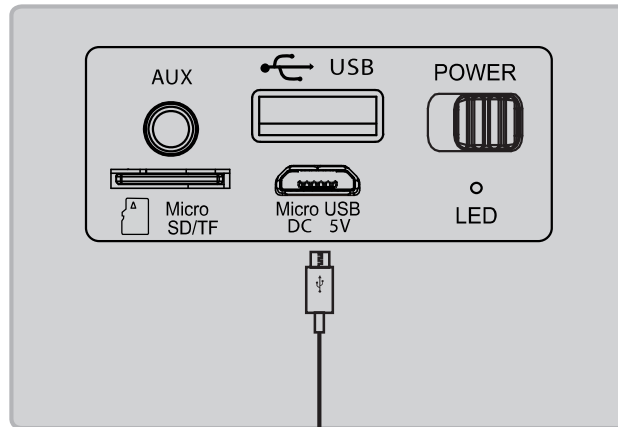

### Notes:

- Before moving or installing this product, make sure the Power switch of the unit is in OFF position.
- Disconnect the USB cable from the speaker when unused for long periods of time.

## Charging the Built-in Battery

The speaker has a built-in rechargeable battery, follow the instructions below to fully charge it for outdoor use:

1. Switch off the speaker and connect the USB cable for DC power input.
2. The LED charging indicator turns red when charging the built-in battery.
3. The LED charging indicator goes off when fully charged.

### Notes:

- When the speaker is working with the built-in battery and it prompts that the battery is low, please connect the USB cable to charge it immediately, or stop using it and power it off to avoid malfunction.

# OPERATING THE SPEAKER

## Power On/ Off the Speaker

Set the Power switch in ON position to power on the speaker, and the LED screen in front panel will light up.

Set the Power switch in OFF position to power off the speaker. The LED screen in front panel will go off.

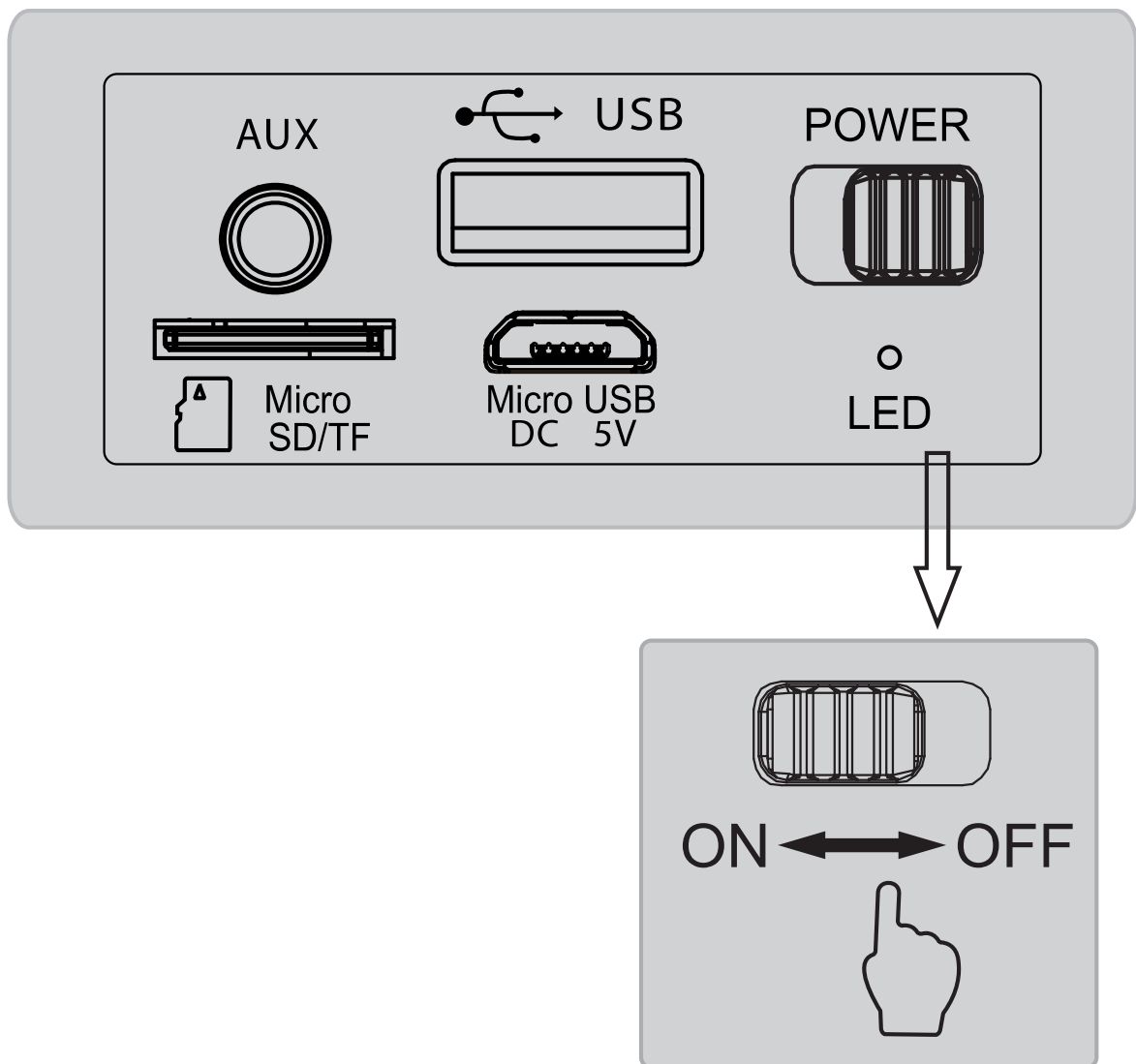

## Bluetooth Audio Streaming / Bluetooth Phone-calling

This speaker has wireless Bluetooth audio streaming function and supports hands-free calls, follow the instructions:

### Pairing the speaker with a Bluetooth device

Pairing is the process required to create a link between Bluetooth devices to allow wireless connection. You must pair a device with the speaker before you start using it.

1. Press MODE button on the speaker to select Bluetooth mode, the LED screen will show "BLUE" when waiting for connection.
2. Turn on the Bluetooth function on the Bluetooth device, search for devices and select "Sylvania SP429" to connect.  
If a Passkey is requested, enter "0000."
3. When the bluetooth connection has been established, the speaker has a prompt voice saying "connected".

#### **Notes:**

- *Once Bluetooth devices are paired, there is no need to pair them again.*

### Listening to Music of the Registered Device / Answers or Hangs up the phone

1. Press MODE button on the speaker to select Bluetooth mode.
2. On the Bluetooth device, select "Sylvania SP429".
3. After Bluetooth connection is established, start playback on the Bluetooth device.
4. Depending on the Bluetooth device, the playback may also be controlled with certain control buttons on the front panel of the speaker.
5. After the bluetooth connection is established with your mobile, when a call comes in, short press the Play/Pause button to answer it. Or if you want to reject the phone, just press and hold the button for seconds to hang up. Beside, you can press and hold the play button for three seconds to redial the last call.

#### **Notes:**

- *The ultimate sound volume can be adjusted by using the volume controls of both your connected Bluetooth device and the speaker.*

## Using the USB Port

The speaker has a USB port for you to insert a compatible USB drive and directly play stored WMA / MP3 audio contents.

1. Make sure the speaker is power on.
2. Insert your USB drive into the USB port on the back panel of the speaker.

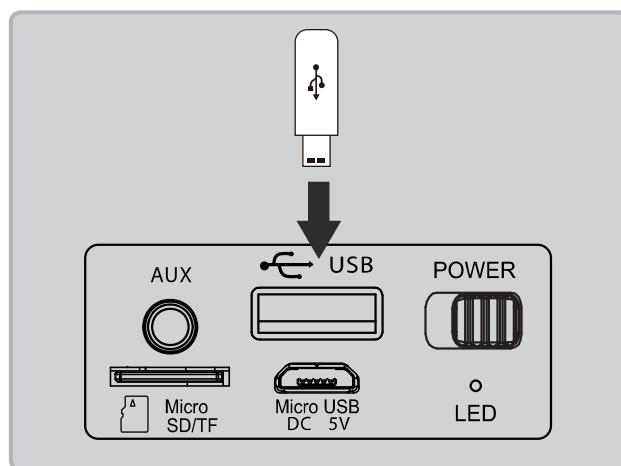

3. Press **Mode** button to select **USB mode**.
4. If playback doesn't start automatically, press the **Play/Pause** button to start playback.
5. Use the control buttons on the front panel of the speaker to adjust the volume and control the playback.

### **Notes:**

- *The USB drive will only fit in one direction, do not force it as this would damage it and the built-in reader of the speaker.*
- *Not all music formats are supported.*
- *Music playback may start automatically after a USB drive is inserted.*

## Using the TF Card Slots

The speaker has a TF (Micro SD) card slot for you to insert your compatible memory cards and directly play stored WMA / Mp3 audio contents.

1. Make sure the speaker is power on.
2. Insert your TF card to the TF card slot on the back of the speaker.

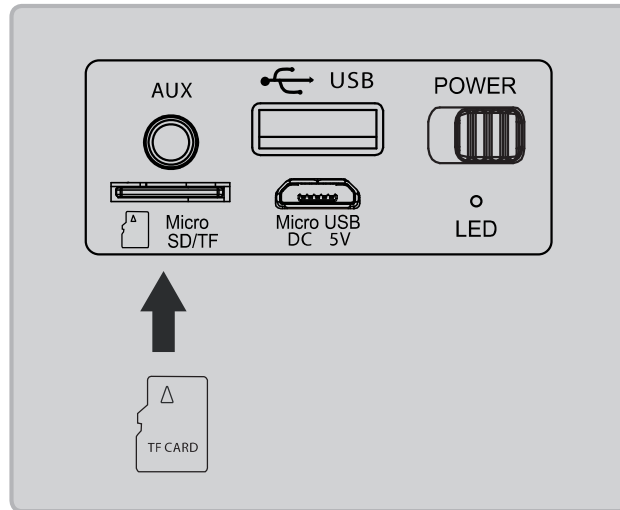

3. Press **Mode** button to select the mode of **Card player**.
4. If playback doesn't start automatically, press the **Play/Pause** button to start playback.
5. Use the control buttons on the front panel of the speaker to adjust the volume and control the playback.

### Notes:

- *The TF cards will only fit in one direction, do not force it as this would damage it and the built-in card reader.*
- *Not all music formats are supported.*
- *Music playback may start automatically after a TF card is inserted.*

## Listening to the Radio

The speaker features FM radio function.

1. Make sure the speaker is power on.
2. Inserted the 3.5mm audio cable (supplied) to work as FM antenna.

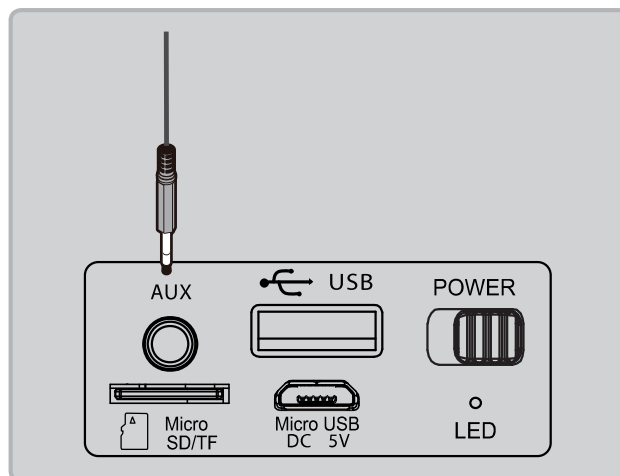

3. Press the **Mode** button on the front panel the top of the speaker repeatedly to select **FM Radio** mode.
4. Press **Play/Pause** button to start auto-scan of available FM channels, and store them in built-in memory. Once the scan is finished, the first stored radio channel will be playing.
5. Press **Next or Prev** button to select your desired channel.
6. Use **- / +** volume knob to decrease/increase volume of the speaker.

### Notes:

- *This function is subject to FM radio signal strength and availability in your area.*
- *Adjust the inserted audio cable to get the best reception.*

## Using the AUX input

The Bluetooth Speaker has an AUX input (Line In) at its back, for you to use a 3.5mm stereo audio cable to connect it to other audio player.

1. Connect one end of the 3.5mm stereo audio cable (supplied) to the AUX jack at the back of the speaker, and the other end to your audio player, smart phone or audio device etc.



2. Switch the speaker on.
3. Press the MODE button on the unit to select Line In mode.
4. The speaker will play the sound input through the connected cable.

### **Notes:**

- *In AUX (Line-In) mode, the control buttons on the unit don't work, except the volume control knob.*
- *The ultimate sound volume can be adjusted by using the volume controls of both your connected device and the speaker.*

## PRODUCT SPECIFICATIONS

Output Power	3W
Speaker Units	1 x 2.25"
Sensitivity	>60db
Frequency Range	20Hz-18KHz
Distortion	<0.1% (@1W)
SNR	>60db
Dimensions	W170 × D80 × H110 mm
Power Input	DC 5V/1.0A, via Micro-USB port
Built-in Battery:	Rechargeable Lithium-ion battery Capacity: 3.7V/1800mAH Charging time: 4-6 hours Play time: 10 hours max.
Power Consumption	< 3W

## TROUBLE SHOOTING GUIDE

Symptoms	Solutions
No power	Make sure the power switch is set in the "ON" position. Make sure the USB cable is connected to the unit and the power output. Charge the built-in battery.
No sound	Check whether the volume is set at minimum level.
No sound after initial Bluetooth connection	Check if your Bluetooth enabled device and the speaker is successfully paired via Bluetooth.



#### FCC Statement

This equipment has been tested and found to comply with the limits for a Class B digital device, pursuant to part 15 of the FCC Rules. These limits are designed to provide reasonable protection against harmful interference in a residential installation. This equipment generates, uses and can radiate radio frequency energy and, if not installed and used in accordance with the instructions, may cause harmful interference to radio communications. However, there is no guarantee that interference will not occur in a particular installation. If this equipment does cause harmful interference to radio or television reception, which can be determined by turning the equipment off and on, the user is encouraged to try to correct the interference by one or more of the following measures:

- Reorient or relocate the receiving antenna.
- Increase the separation between the equipment and receiver.
- Connect the equipment into an outlet on a circuit different from that to which the receiver is connected.
- Consult the dealer or an experienced radio/TV technician for help.

Caution: Any changes or modifications to this device not explicitly approved by manufacturer could void your authority to operate this equipment.

This device complies with part 15 of the FCC Rules. Operation is subject to the following two conditions: (1) This device may not cause harmful interference, and (2) this device must accept any interference received, including interference that may cause undesired operation.

#### RF Exposure Information

The device has been evaluated to meet general RF exposure requirement. The device can be used in portable exposure condition without restriction.