

T20S Bluetooth Speaker

User's Manual

BLUETOOTH SPEAKER T20S, T20



Thank you for choosing the T20S Speaker as your source for entertainment. You can use this item with iPad, iPhone, iPod and many types of smart-phone to stream music and enjoy hands-free calling. For the best results, please read this manual before using the speaker.

WITSLISM TECHNOLOGY.,LIMITED

1 What's in the box

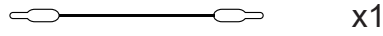
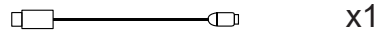
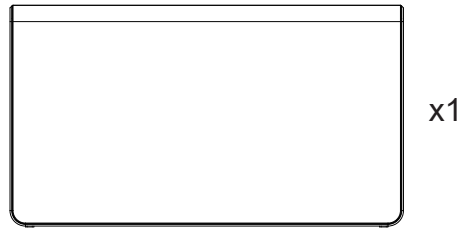

2 Buttons

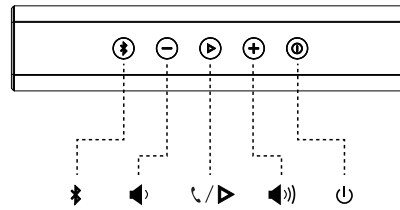

3 Connections

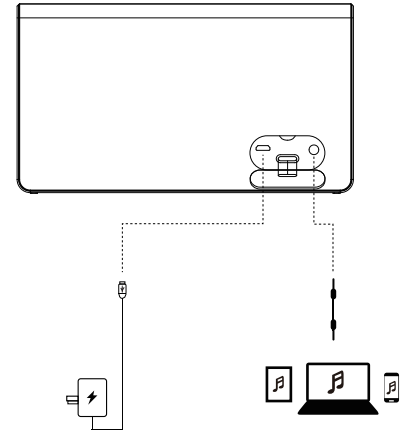

4 Bluetooth®

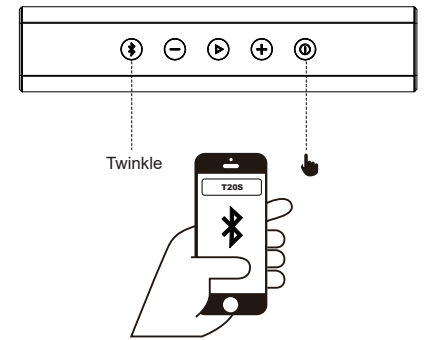

5 Hands-free

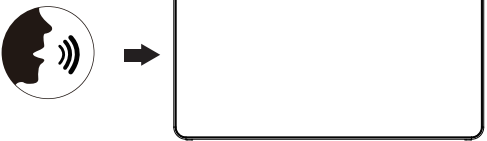
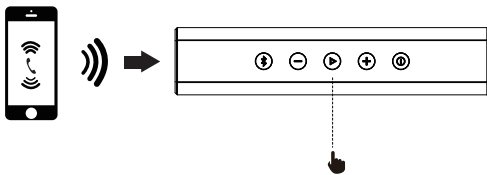

6 TWS Connect

Induction connection / Easier and Faster!
Patent for invention : 201710856023.6

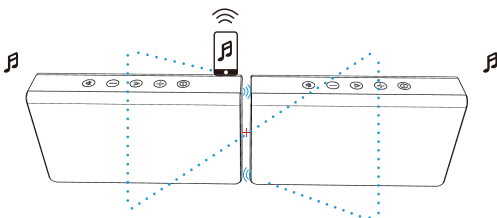

Step1: Power on

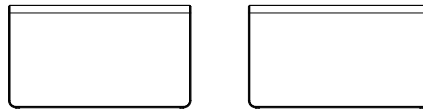

Step2: Leaning together

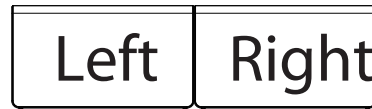

Step3: Complete the connection

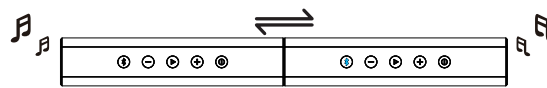

TWS connections: If you buy two T20S, then you can connect to become a wireless stereo (TWS). Disconnect all the audio source after power-on and switch to Bluetooth mode. Put the two T20S close to each other and the TWS pairing is done automatically. After successful connected, the left T20S is the left channel and the other one is the right channel. The left channel of T20S's Bluetooth key is flash, right channel T20S's Bluetooth key steady light, using mobile phone's Bluetooth or Aux connected to the left channel T20S, you can enjoy the shocking of TWS. Put two units together again that can clears the TWS connection.

7 LED Behavior

Bluetooth pairing	Twinkle	Charging	breathing
Bluetooth Paired	steady on	Fully charged	steady on
TWS Pairing	Left Right Twinkle	Low battery	Twinkle
TWS Paired	Left Twinkle Right	MAX Volume	Twinkle + -

8 Warning

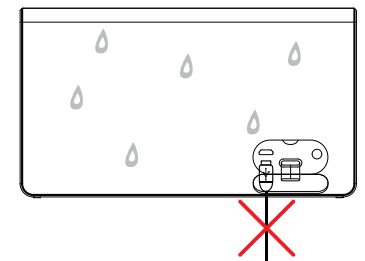

9 Technical Data

BT Version	4.2
Driver	57mm*2
Output	20W@1%THD+N
SNR	>85dB
Frequency range	80Hz-20KHz
Input voltage	5V
Input current	1.8A
Speaker/driver size	57mm 4Ω 10W
THD	0.32%
Battery	7.4V 2400mAh 17.76Wh 3C
Bluetooth distance	>10m
TWS distance	>5m
Playing time	About 10 hours
Size	229x128.5*49 mm
Net weight	780 g

FCC Caution.

This device complies with part 15 of the FCC Rules. Operation is subject to the following two conditions:

- (1) This device may not cause harmful interference, and
- (2) this device must accept any interference received, including interference that may cause undesired operation.

Any Changes or modifications not expressly approved by the party responsible for compliance could void the user's authority to operate the equipment.

Note: This equipment has been tested and found to comply with the limits for a Class B digital device, pursuant to part 15 of the FCC Rules. These limits are designed to provide reasonable protection against harmful interference in a residential installation. This equipment generates uses and can radiate radio frequency energy and, if not installed and used in accordance with the instructions, may cause harmful interference to radio communications. However, there is no guarantee that interference will not occur in a particular installation. If this equipment does cause harmful interference to radio or television reception, which can be determined by turning the equipment off and on, the user is encouraged to try to correct the interference by one or more of the following measures:

- Reorient or relocate the receiving antenna.
- Increase the separation between the equipment and receiver.
- Connect the equipment into an outlet on a circuit different from that to which the receiver is connected.
- Consult the dealer or an experienced radio/TV technician for help.

The device has been evaluated to meet general RF exposure requirement. The device can be used in portable exposure condition without restriction.