



SKU#: BH19-093-599-84

Model: GW-W-SIRC

1 SET OF 12 COUNT

WiFi String Light

PACKAGE CONTENTS

DESCRIPTION	QUANTITY
24 foot string light	1
Plug-in power supply with controller	1
4-pin S14 lamps	14
Handheld remote control	1
CR2025 Battery for remote	1



Questions, problems, missing parts?
Before returning to your retailer, call our customer service at
1-800-285-8051 Monday – Friday 8:00 a.m. – 5:00 p.m. CST

SAFETY INFORMATION

Please read and understand this entire manual before attempting to assemble, operate or install the product.

WARNING: When using outdoor use portable lighting products, basic safety precautions should always be followed to reduce the risk of fire, electric shock, and personal injury including the following:

READ AND FOLLOW ALL SAFETY INSTRUCTIONS

- a) Ground Fault Circuit Interrupter (GFCI) protection should be provided on the circuits or outlet to be used for the outdoor use string light product. Receptacles are available that have built-in GFCI protection for this measure of safety.
- b) Only use outdoor extension cords such as type SEW, SEOW, SEOOW, SOW, SOOW, STW, STOW, STOOW, SJEW, SJEOW, SJEOOW, SJW, SJOW, SJOOW, SJTW, SJTOW, or SJTOOW. This designation is marked on the wire of the extension cord.
- Read and follow all instructions that are on the product or provided with the product.
- This product operates at 120V, 60Hz 6W per string
- This seasonal use product is not intended for permanent installation or use.
- Do not mount or place near gas or electric heaters, fireplaces, candles, or other similar sources of heat.
- Do not secure the wiring of the product with staples or nails, or place on sharp hooks or nails.
- Do not let lamps rest on the supply cord or on any wire.
- Unplug the product when leaving the vicinity of the product or when left unattended.
- This is an electric product and is not a toy! To avoid risk of fire, burns, personal injury, and electric shock, it should not be played with or placed where small children can reach it.
- Do not use this product for other than its intended use.
- Do not hang ornaments or other objects from cord, wire, or light string.
- Do not close doors or windows on the product or extension cords as this may damage the wire insulation.
- Do not cover the product with cloth, paper, or any material not part of the product when in use.
- This product is equipped with push-in type lamps.
- Do not operate this product with lamps missing from sockets. Missing lamps should be replaced promptly.
- Risk of fire: This product does not contain lamp shunts which allow the product to operate if one lamp burns out. Replace lamps only with the spare lamps provided with this product.
- **DO NOT EXCEED THE MAXIMUM EXTENSION LENGTH IN FEET PERMITTED BY THE MARKING.** The maximum extension length for this string light is 96 feet or 4 units. When adding additional extension pieces, use only the same product sold by Wal-Mart with vendor stock# BH19-093-599-84.

SAVE THESE INSTRUCTIONS



WARNING: PROPOSITION 65

This product can expose you to Lead, which is known to the State of California to cause cancer. For more information go to www.P65Warnings.ca.gov.

PREPARATION

Before beginning assembly, installation, or operation of product, make sure all parts are present. Compare parts with package and hardware contents lists on page 1. If any part is missing or damaged, do not attempt to assemble, install or operate the product. Contact customer service for replacement parts.

Tools Required for Assembly (not included): Phillips Screwdriver, Safety Glasses, Ladder, Supporting hardware (eyebolts or brackets).

Estimated assembly time: 20 minutes

INSTALLATION INSTRUCTIONS

WARNING

- Disconnect power at the source prior to beginning installation or servicing product.
- Be careful not to damage or cut the wire insulation (covering) during fixture installation. Do not permit power cord or wires to contact any surface having a sharp edge. To do so may damage or cut the wire insulation, which could cause serious injury or death from electric shock.
- String light sockets must be suspended so that lamps are facing downwards. DO NOT mount the light string with sockets facing upward. Lamps should hang freely with at least 3 inches of space from nearest object.

1. Carefully remove all the parts from the packaging, and gently lay them out on a smooth workspace. Remove the packing material and uncoil the string light (A). Be careful not to cut or nick the string nor damage the pre-attached lamps.

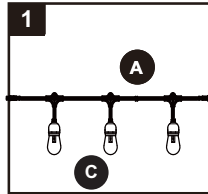

2. Ensure all 12 of the pre-attached lamps are securely affixed to each of the string light's (A) sockets by gently turning each lamp (C) clockwise. Do not over-turn.

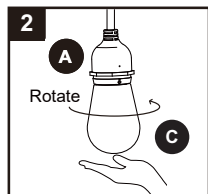

3. Connect the 12V plug-in power supply with adaptor (B) to the light string (A) by pushing the male and female end connections together, then tightening the screw-on connection cover.

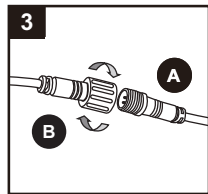

4. Securely attach string light (A) to a support structure using the eyelet holes at the top of each suspended socket and appropriate supporting hardware (eyebolts, brackets, etc. not included).

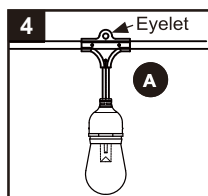

5. Plug-in power supply with adaptor (B) to an appropriate power outlet.

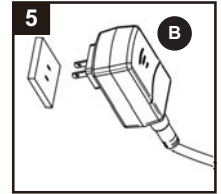

OPTIONAL

6. Use handheld remote control (D) for on/off control, dimming, and color control. Remove plastic tab from battery door before use.

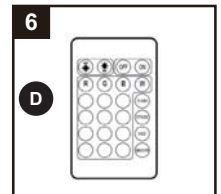

7. To replace remote control's battery (D), follow directions on the back of remote control (D) to slide battery drawer out. Replace battery (+ side up) and slide battery drawer back in place.

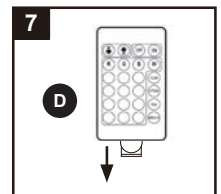

EXTENDING THE SERIES

1. Ensure that all string lights (A) are unplugged before adding additional string light (A) segments to the series.

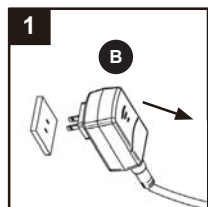

2. Remove the end cap from the last string light (A) in the series by unscrewing the plastic end cap.

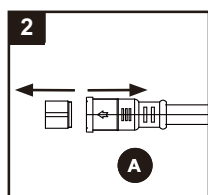

3. Connect two string lights together by pushing the male and female end connections together, then tightening the screw-on connection cover. Ensure the new last string in the series still has its end cap attached.

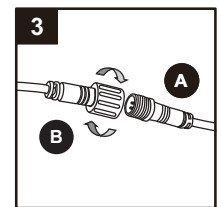

CARE AND MAINTENANCE

- When the product is placed on a live tree, the tree should be well maintained and fresh. Do not place on live trees in which the needles are brown and break off easily.
- If the product is placed on a tree, the tree should be well secured and stable.
- Before using or reusing, inspect product carefully. Discard any products that have cut, damaged, or frayed wire insulation or cords, cracks in the lamp-holders or enclosures, loose connections, or exposed copper wire.
- When storing the product, carefully remove the product from wherever it is placed, including trees, branches, or bushes in order to avoid any undue strain or stress on the product conductors, connections, and wires.
- When not in use, store neatly in a cool, dry location protected from sunlight.

TROUBLESHOOTING

- 1) The light does not come on at all:
 - a) Make sure the wall switch and circuit breaker are on.
- 2) One of the lamps has burned out.
 - a) Disconnect power to the string light. Remove effected lamp by gently gripping lamp and then turning in a counter-clockwise direction. Replace lamps only with 12V, 0.5W S14 lamps provided. Align the groove on the socket with the bolt on the lamp, then gently insert the lamp into the socket. Turn the lamp in a clockwise direction until fully seated.

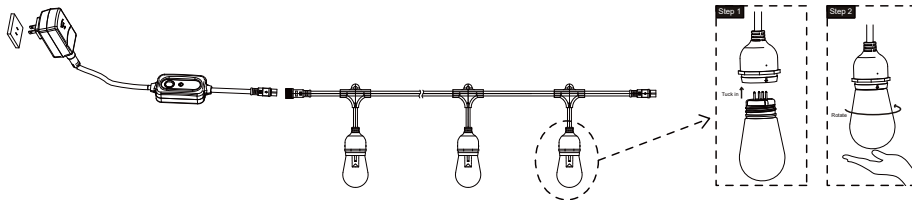

FCC Compliance Statement

This device complies with part 15 of the FCC Rules. Operation is subject to the following two conditions:

1. This device may not cause harmful interference, and
2. This device must accept any interference received, including interference that may cause undesired operation.

FCC WARNING

This equipment has been tested and found to comply with the limits for a Class B digital device, pursuant to Part 15 of the FCC Rules. These limits are designed to provide reasonable protection against harmful interference in a residential installation. This equipment generates, uses and can radiate radio frequency energy and, if not installed and used in accordance with the instructions, may cause harmful interference to radio communications. However, there is no guarantee that interference will not occur in a particular installation. If this equipment does cause harmful interference to radio or television reception, which can be determined by turning the equipment off and on, the user is encouraged to try to correct the interference by one or more of the following measures:

- Reorient or relocate the receiving antenna.
- Increase the separation between the equipment and the receiver.
- Connect the equipment into an outlet different from that to which the receiver is connected.
- Consult the dealer or an experienced radio/TV technician for help.

TWO-YEAR LIMITED WARRANTY

If, during normal use, this lighting fixture breaks or fails due to a defect in material and workmanship within one (2) year from the date of original purchase, simply bring this lighting fixture with your original sales receipt back to your nearest retail store. At its discretion, agrees to have the product or any defective part(s) repaired or replaced with the same or similar product free of charge, within the stated warranty period, when returned by the original purchaser with original sales receipt. This warranty; (1) excludes expendable parts including but not limited to light bulbs; (2) does not cover damage that has resulted from abuse or misuse; and (3) does not cover any losses, labor, injuries to persons/property or costs. This warranty does give you specific legal rights and you may have other rights, which vary from state to state.

REMOTE CONTROL INSTRUCTIONS

1. The default setting of the WIFI controller is 4 channels in the sequence of RGBW (sequence GRB for RGB version). If you want to change the output channel, follow the steps below:

- a.) Ensure power point is turned off and then unplug the transformer
- b.) Plug the transformer back into power point and turn on power
- c.) Plug in again and turn on power

When the lights are illuminated:

- d.) Press button B for 2 to 3 seconds, when white light flickers, you have successfully changed the output channel to BRGW sequence
- e.) Press button G to change the output channel to GRBW sequence
- f.) Press button R to change the output channel to RGBW sequence
- g.) In RGBW version, press W button for RGB and White light
- h.) Press button W for 2 seconds to switch to the W channel.

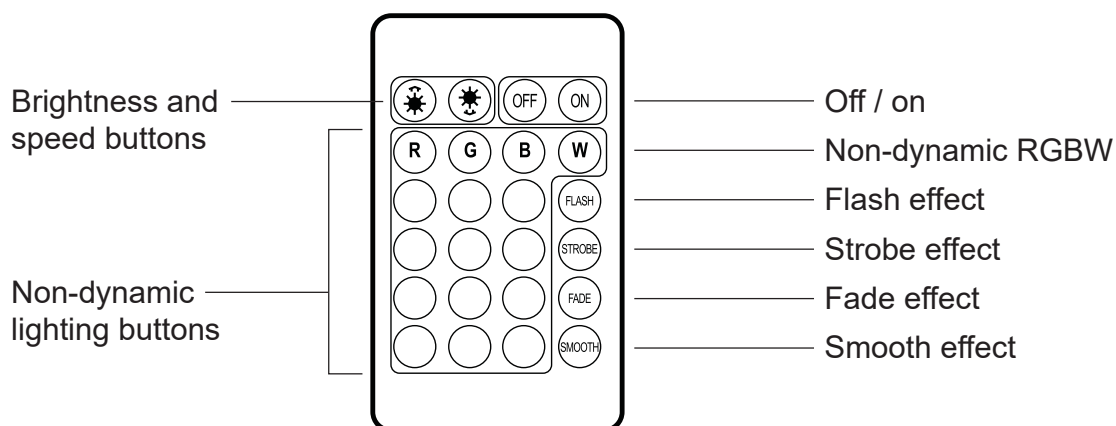

WIFI STRING LIGHT QUICK START GUIDE FOR APPLE IOS

1. Download the Magic Home Pro app from the App Store. Filter the search by 'Supports' and select 'iPhone Only' if the app does not appear in the initial search. You may also scan the QR code in Figure 1 for quick download.

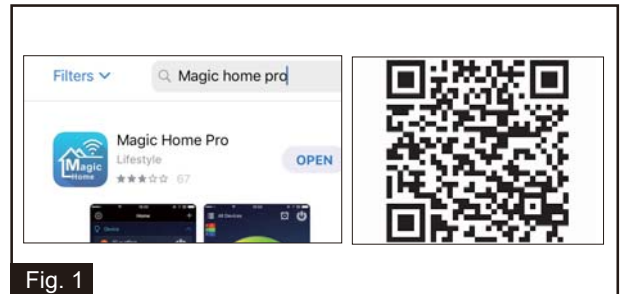

Fig. 1

2. Once downloaded, open the Magic Home app. Select the "+" icon to close the initial prompt to 'add a device', then select the settings gear wheel in the top left corner. Select "Sign in or Create an account". Once you have created an account, sign in and swipe left to return to the home screen.

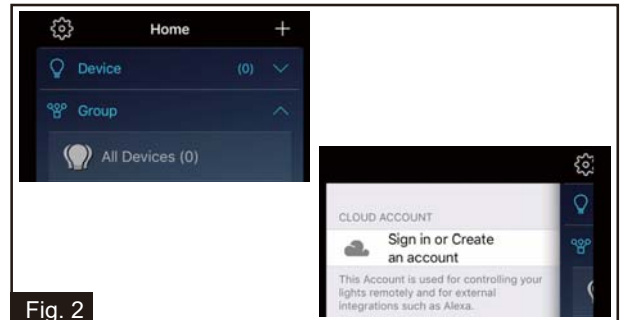

Fig. 2

3. To add a smart light device, make sure the device is plugged in. Select the + icon in the upper right hand corner on the home screen then select "Connect light to WiFi network". Connect your phone or tablet to the WiFi signal being emitted by the smart light device by selecting "Open Wifi Setting", then selecting the network "LEDnet#####". Once connected, return to the Magic Home app.

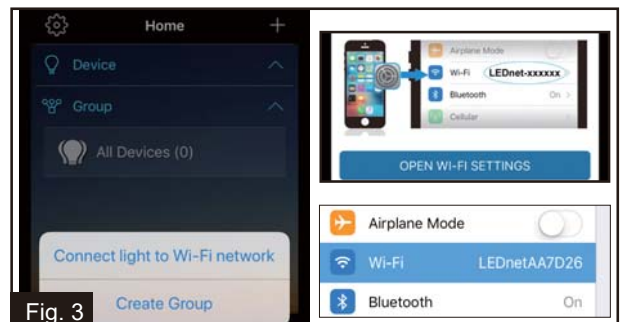

Fig. 3

4. Now, the app will prompt you to connect the smart light device to a local 2.4Ghz WiFi connection. Select an appropriate local network from the list provided.

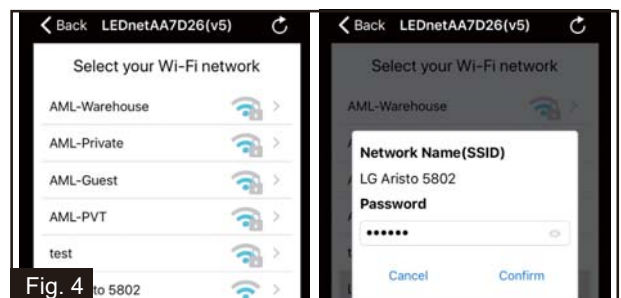

Fig. 4

5. Once connected, the app will prompt you to rename the connected smart light device. Name this device something that is easily recognized. Suggestions include using titles based on location or use, as well as words that are short and easily distinguishable in spoken word.

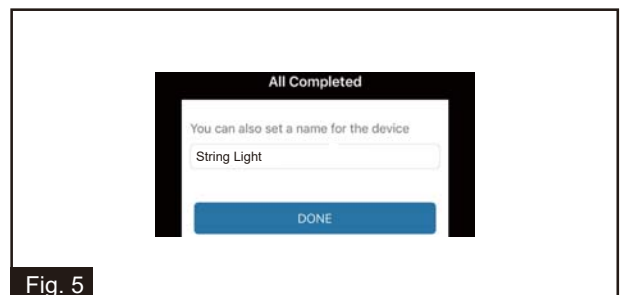
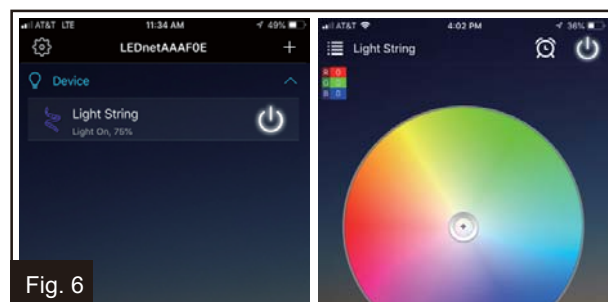

Fig. 5

WIFI STRING LIGHT QUICK START GUIDE FOR APPLE IOS

6. Congratulations! Your smart light device is now ready to control. Select the device from the home screen to enter the device's control panel.

To use the Magic Home Pro app with Amazon Alexa or Google Home Assistant, follow the directions on pages 11-14.



FEATURES

1. Color Screen - The 5 DIY buttons allow for quick access to custom preset colors. Select the desired color on the color wheel, then press and hold a DIY button to set. On the display - top left - the individual RGB channels can be adjusted from 0-255 to obtain a desired color.
2. CCT - CCT stands for 'correlated color temperature'. This screen controls various color settings to create warm white and cool white color mixes.
3. Functions - There are 20 preset color sequences. The 'Customs' tab allows for customization of sequences.
4. Camera - This is a color picking function that will capture colors in real time through a device's camera. The camera can capture colors such as Red, Green, Blue, or mixes of the three, however it will not capture some colors such as Black.
5. Timer - Select the clock icon to the left of the power icon to access timer functions. Set multiple timers with repeat settings as well as sunrise/sunset timers which coincide with sunrise/sunset times.
6. Mic - use audio microphone on smart device to control light movement (audio from room)
7. Music - use to synchronize light movement with music on smart device (audio from device)

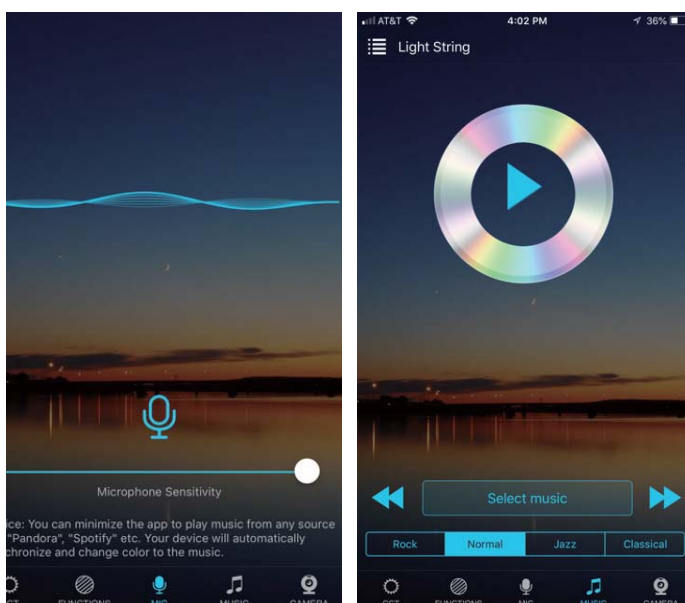
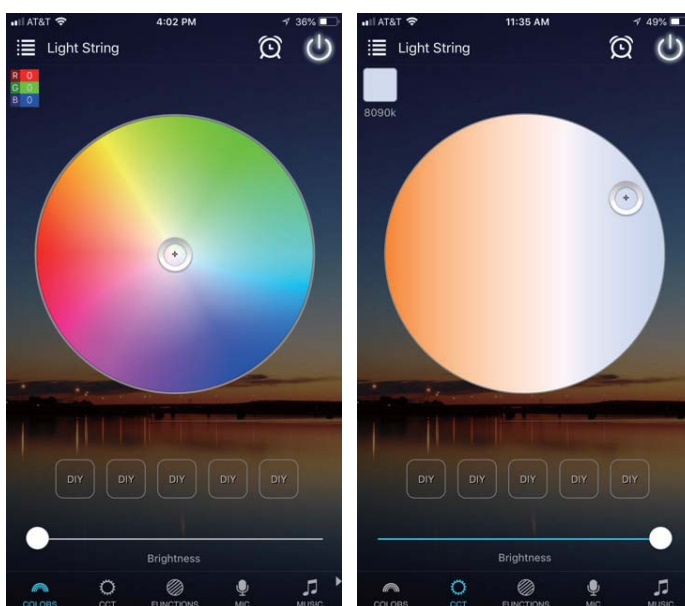

WIFI STRING LIGHT QUICK START GUIDE FOR ANDROID

1. Download the Magic Home Pro app from the Google Play Store. You may scan the QR code in Figure 1 for quick download.

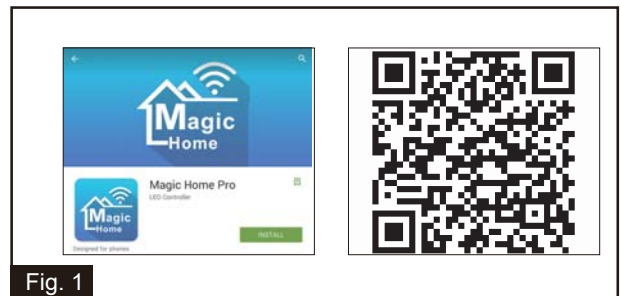

Fig. 1

2. Once downloaded, open the Magic Home app. Select the “X” icon to close the initial prompt to ‘add a device’, then select the drop-down menu in the top left corner. Select “Sign in or Create an account”. Once you have created an account, sign in and swipe left to return to the home screen.

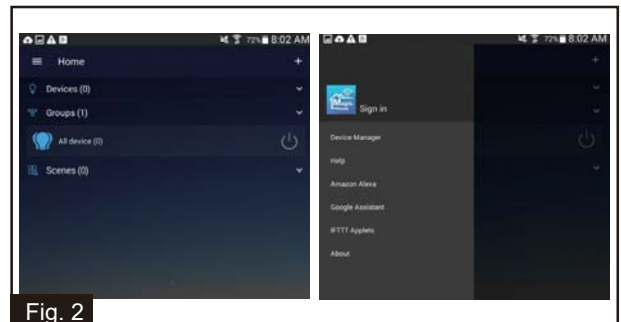

Fig. 2

3. To add a smart light device, make sure the device is plugged in. Select the + icon in the upper right hand corner on the home screen then select “Add Device”. This will prompt you to connect your phone or tablet to the WiFi signal being emitted by the smart light device. Select the network “LEDnet#####”.

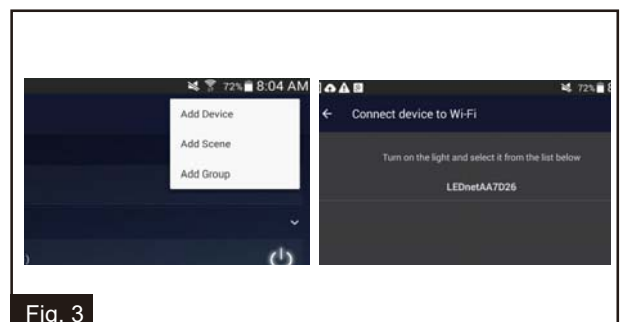

Fig. 3

4. Now, the app will prompt you to connect the smart light device to a local 2.4Ghz WiFi connection. Select the appropriate WiFi network from the list provided.

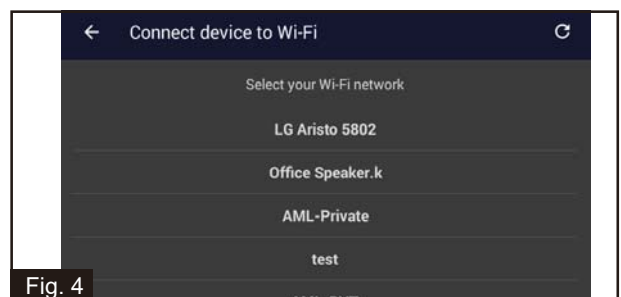

Fig. 4

5. Once connected, the app will prompt you to rename the connected smart light device. Name this device something that is easily recognized. Suggestions include using titles based on location or use, as well as words that are short and easily distinguishable in spoken word.

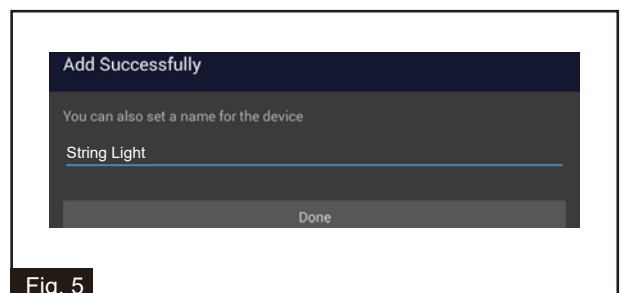
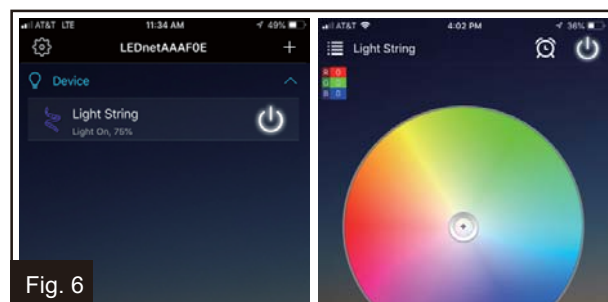

Fig. 5

WIFI STRING LIGHT QUICK START GUIDE FOR ANDROID

6. Congratulations! Your smart light device is now ready to control. Select the device from the home screen to enter the device's control panel.

To use the Magic Home Pro app with Amazon Alexa or Google Home Assistant, follow the directions on pages 11-14.



FEATURES

1. Color Screen - The 5 DIY buttons allow for quick access to custom preset colors. Select the desired color on the color wheel, then press and hold a DIY button to set. On the display - top left - the individual RGB channels can be adjusted from 0-255 to obtain a desired color.
2. CCT - CCT stands for 'correlated color temperature'. This screen controls various color settings to create warm white and cool white color mixes.
3. Functions - There are 20 preset color sequences. The 'Customs' tab allows for customization of sequences.
4. Camera - This is a color picking function that will capture colors in real time through a device's camera. The camera can capture colors such as Red, Green, Blue, or mixes of the three, however it will not capture some colors such as Black.
5. Timer - Select the clock icon to the left of the power icon to access timer functions. Set multiple timers with repeat settings as well as sunrise/sunset timers which coincide with sunrise/sunset times.
6. Mic - use audio microphone on smart device to control light movement (audio from room)
7. Music - use to synchronize light movement with music on smart device (audio from device)

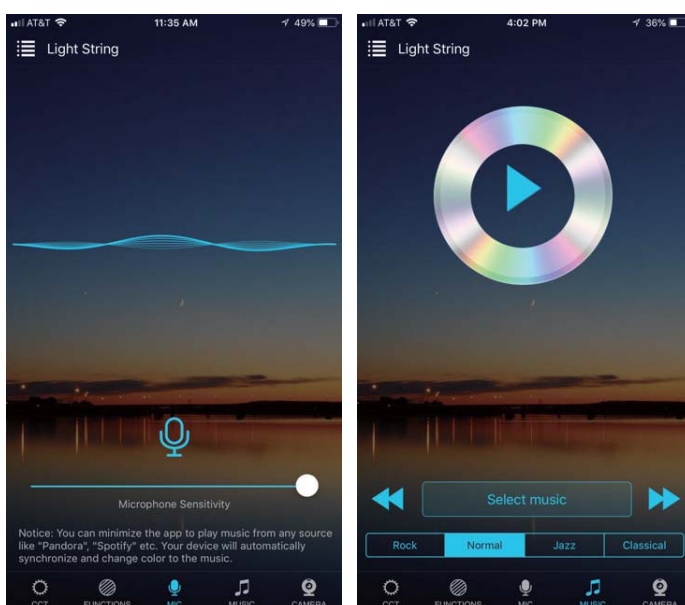
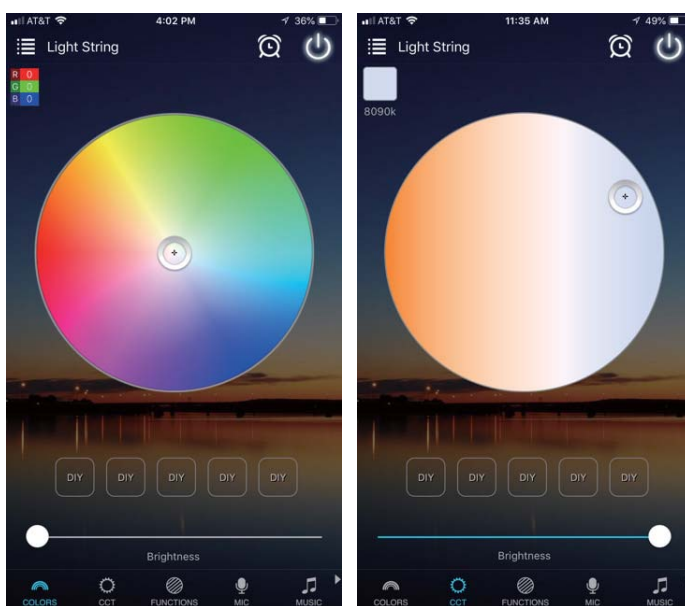

CONNECT WIFI STRING LIGHT TO AMAZON ALEXA

If your Amazon Alexa device is not already set-up, follow the Amazon Alexa device's instructions to establish an Amazon account and download the Amazon Alexa app.

1. From the Amazon Alexa app home page, select the drop-down menu in the upper left hand corner. Select 'Skills & Games'.

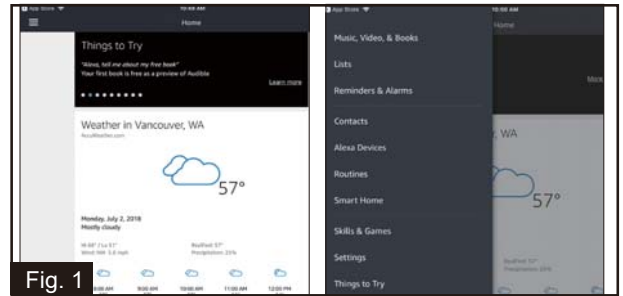

2. Search the skills for 'Magic Home Pro' and select 'Magic Home' from the search results.

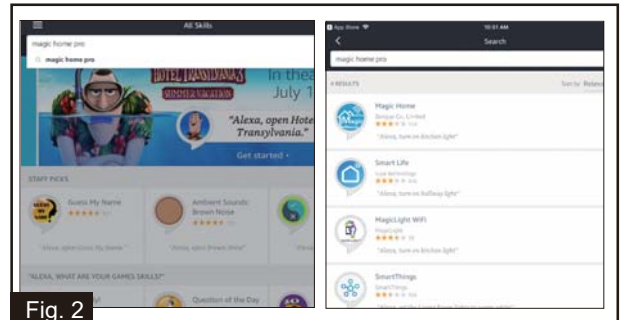

3. Select "Enable" to teach your Amazon Alexa app the skill set for the Magic Home Pro app. The app will prompt you to enter your Magic Home log-in information. Make sure to use the same log-in information for both the Magic Home App log-in when syncing skills in Amazon Alexa.

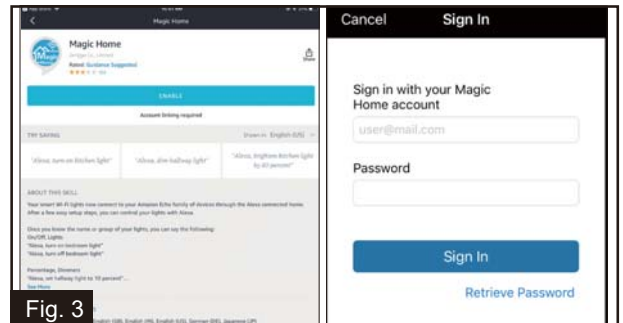

4. Once completed, the Amazon Alexa app will display that the Magic Home skill has been successfully linked. Close this window by selecting the "X" in the upper right hand corner of the screen. The app will then prompt you to search for connected devices. Select "Discover Devices" or say "Alexa, Discover Devices".

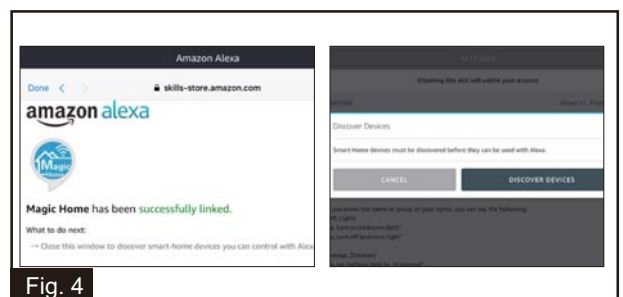

5. The app will now search for connected devices. Once complete, you will see a list of all connected devices discovered by the Amazon Alexa app. You should see your smart light device on this list.

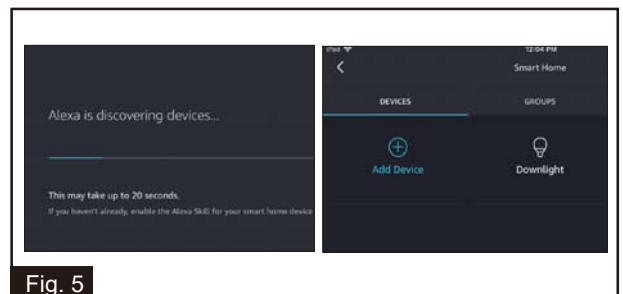

CONNECT WIFI STRING LIGHT TO AMAZON ALEXA

6. Congratulations! Your smart light device has now been connected to the Amazon Alexa device.

SUGGESTED COMMANDS

- Alexa, set [device name] to [0-100]%
- Alexa, turn [device name] on/off
- Alexa, dim/brighten [device name]
- Alexa, increase/decrease [device name]
- Alexa, set/change the [device name] to [color]
- Alexa, make the [device name] white
- Alexa, set/change the [device name] to white
- Alexa, is [device name] on?

Various color suggestions:

- Blue
- Crimson
- Cyan
- Fuchsia
- Gold
- Green
- Lavender
- Lime

TROUBLESHOOTING

- The light does not come on at all:
 - a) Make sure the circuit breaker is on and that switch controlling branch circuit is on.
- To reset the smart light to factory settings:
 - a) Power the light on and off 4 times in succession: On for 5 seconds, then Off for 3 seconds.
- If the smart light device does not respond to commands
 - a) Check the status by selecting the settings gear wheel from the home screen, then selecting "Device Manager". Both icons shown should be blue. If not, try reconnecting the device.
- The Wifi signal emitted by the smart light device is not connected to the internet.
 - a) The goal of setup is to get the control device (phone or tablet), the smart light device, and/or auxiliary smart speaker on the same local Wifi network.
- Smart device won't find the Wifi signal of the smart light.
 - a) Check if the string light has been connected with the router while also checking the WiFi connection of the smart device.
- The smart light will not connect with the router.
 - a) Ensure the correct password is being used.
 - b) Disconnect power to the smart light and the router then shut down the app. Restart the router, followed by the smart light 30 seconds later. Wait 2 minutes before restarting the app.
- The App is not recognizing the smart light after choosing the Wifi signal
 - a) Refresh the app device list by sliding down on the screen.
 - b) Try disabling the Wifi connection on your smart device, wait a few minutes, then try again.

If these suggestions do not fix the issue, please consult a certified electrician.

WIFI STRING LIGHT QUICK START GUIDE FOR REMOTE CONTROL

Normally upon connect the smart light device, It will show “ Color Screen - The 5 DIY buttons” as below picture.

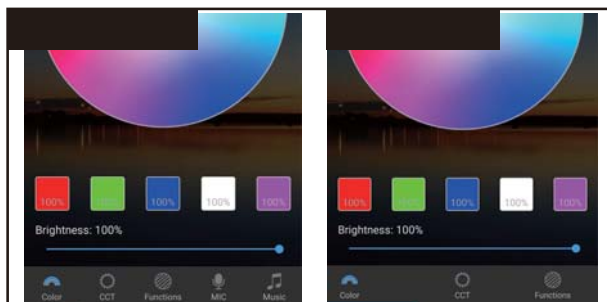

Under the remote connection, It will show “ Color Screen-The 3 DIY buttons” as below picture.

If you need to cancel or turn on the CCT function, Can be set on the device management page.

1. Go back to the device Management page, select the “device management” in the upper-left corner, and go to device Management.

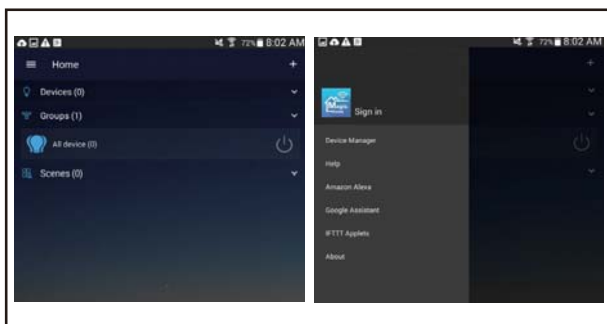

2. Select the device to operate on, and open the icon selected in the diagram.

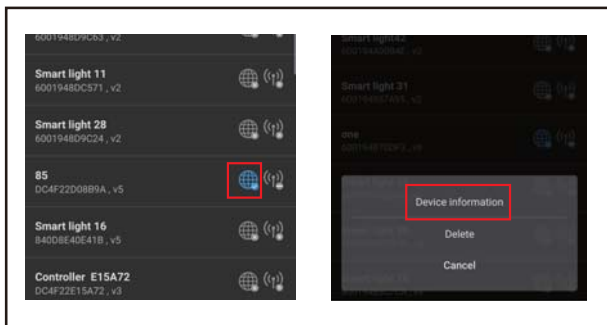

3. After clicking on device information, and select the “Auxiliary Settings”. To open or cancel the CCT.

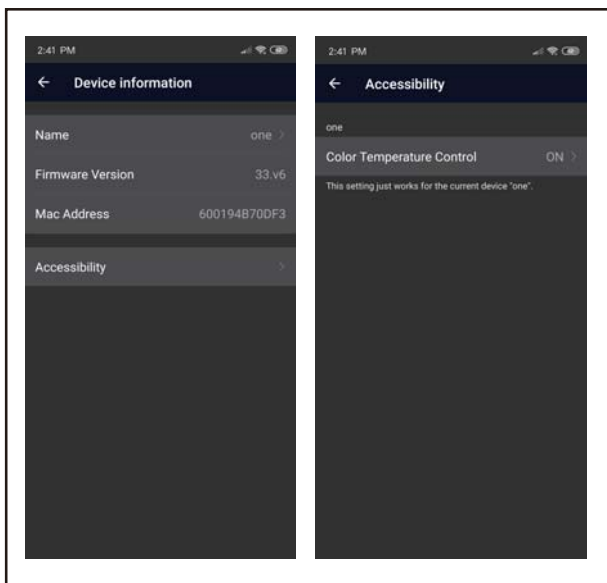

CONNECT WIFI STRING LIGHT TO GOOGLE ASSISTANT

If your Google Home smart speaker device is not already set-up, follow the Google Home device's instructions to establish a Google account and download the Google Home app.

1. From the Google Home app homepage, select the drop down menu in the upper left hand corner.

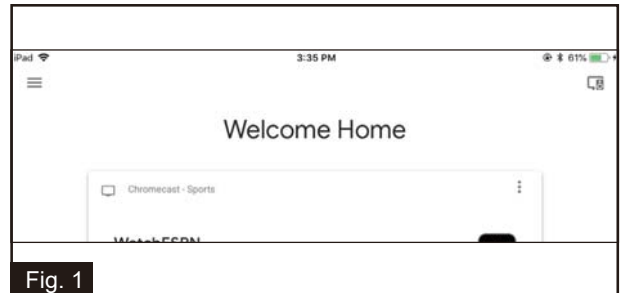

2. Select "Home Control" from the drop down list.

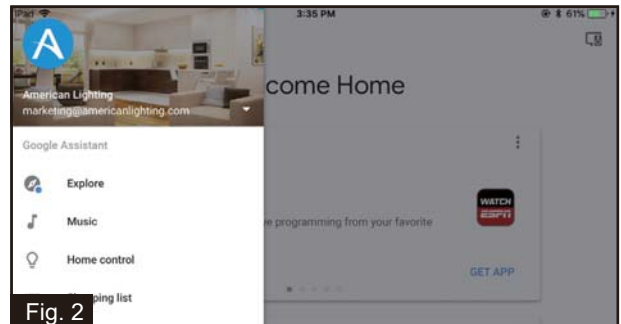

3. From the home control screen, select the + icon in the bottom right hand corner. Select "Magic Home" from the list of compatible programs to link the Magic Home app to the Google Home app.



4. The app will prompt you to enter your log-in information for the Magic Home app to continue.

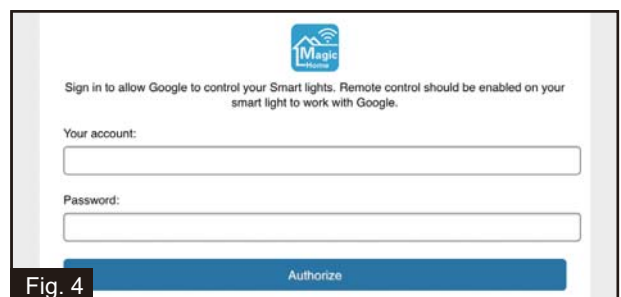

5. The app will now search for connected devices. Once complete, you will see a list of all connected devices discovered by the Google Home app. You should see your smart light device on this list.



CONNECT WIFI STRING LIGHT TO GOOGLE ASSISTANT

6. Congratulations! Your smart light device has now been connected to the Google Home device.

SUGGESTED COMMANDS

- Ok Google, set [device name] to [0-100]%
- Ok Google, turn [device name] on/off
- Ok Google, dim/brighten [device name]
- Ok Google, increase/decrease [device name]
- Ok Google, set/change the [device name] to [color]
- Ok Google, make the [device name] white
- Ok Google, is [device name] on?

Various color suggestions:

- Blue
- Crimson
- Cyan
- Fuchsia
- Gold
- Green
- Lavender
- Lime

TROUBLESHOOTING

- The light does not come on at all:
 - a) Make sure the circuit breaker is on and that switch controlling branch circuit is on.
- To reset the smart light to factory settings:
 - a) Power the light on and off 4 times in succession: On for 5 seconds, then Off for 3 seconds.
- If the smart light device does not respond to commands
 - a) Check the status by selecting the settings gear wheel from the home screen, then selecting "Device Manager". Both icons shown should be blue. If not, try reconnecting the device.
- The Wifi signal emitted by the smart light device is not connected to the internet.
 - a) The goal of setup is to get the control device (phone or tablet), the smart light device, and/or auxiliary smart speaker on the same local Wifi network.
- Smart device won't find the Wifi signal of the smart light.
 - a) Check if the string light has been connected with the router while also checking the WiFi connection of the smart device.
- The smart light will not connect with the router.
 - a) Ensure the correct password is being used.
 - b) Disconnect power to the smart light and the router then shut down the app. Restart the router, followed by the smart light 30 seconds later. Wait 2 minutes before restarting the app.
- The App is not recognizing the smart light after choosing the Wifi signal
 - a) Refresh the app device list by sliding down on the screen.
 - b) Try disabling the Wifi connection on your smart device, wait a few minutes, then try again.

If these suggestions do not fix the issue, please consult a certified electrician.

CARE AND MAINTENANCE

- Use only a mild soap and/or water with a soft cloth to clean the fixture. Harsh chemicals will damage the fixture. Do not wipe the fixture with a rough cloth that may scratch the finish or the lens.

FCC Warning

FCC ID: 2AP9S-GW-W-SIRC

FCC Warning:

This device complies with part 15 of the FCC Rules. Operation is subject to the following two conditions: (1) This device may not cause harmful interference, and (2) this device must accept any interference received, including interference that may cause undesired operation. Any Changes or modifications not expressly approved by the party responsible for compliance could void the user's authority to operate the equipment.

This equipment has been tested and found to comply with the limits for a Class B digital device, pursuant to part 15 of the FCC Rules. These limits are designed to provide reasonable protection against harmful interference in a residential installation. This equipment generates uses and can radiate radio frequency energy and, if not installed and used in accordance with the instructions, may cause harmful interference to radio communications. However, there is no guarantee that interference will not occur in a particular installation. If this equipment does cause harmful interference to radio or television reception, which can be determined by turning the equipment off and on, the user is encouraged to try to correct the interference by one or more of the following measures:

- Reorient or relocate the receiving antenna.
- Increase the separation between the equipment and receiver.
- Connect the equipment into an outlet on a circuit different from that to which the receiver is connected.

FCC RF exposure statement:

The equipment complies with FCC Radiation exposure limit set forth for uncontrolled environment. This equipment should be installed and operated with minimum distance 20cm between the radiator and your body.

ONE-YEAR LIMITED WARRANTY

If, during normal use, this lighting fixture breaks or fails due to a defect in material and workmanship within one (1) year from the date of original purchase, simply bring this lighting fixture with your original sales receipt back to your nearest retail store. At its discretion, agrees to have the product or any defective part(s) repaired or replaced with the same or similar product free of charge, within the stated warranty period, when returned by the original purchaser with original sales receipt. This warranty; (1) excludes expendable parts including but not limited to light bulbs; (2) does not cover damage that has resulted from abuse or misuse; and (3) does not cover any losses, labor, injuries to persons/property or costs. This warranty does give you specific legal rights and you may have other rights, which vary from state to state.



Questions, problems, missing parts?
Before returning to your retailer, call our customer service at
1-800-285-8051 Monday – Friday 8:00 a.m. – 5:00 p.m. CST