



**1 YEAR*
WARRANTY**



Full warranty disclosure available at www.visiontek.com. Product must be registered within 30 days of purchase for warranty to be valid. Register at <https://www.visiontek.com/warranty-registration.html> If you have questions or need assistance with this product, call Support at (866) 883-5411.

Part # 900923

TROUBLE SHOOTING

- 1. My mobile phone can't find any new Bluetooth devices?**
Make sure the Bluetooth speaker has entered pairing mode; and is within the effective working range.
- 2. Bluetooth devices can't pair up**
a) Make sure your mobile phone allows a new connection, and did not reach the maximum allowed connections, please refer to your mobile device manual.
b) Make sure you click the right Bluetooth pairing name.
- 3. My mini speaker does not play music / answer calls when connected to a mobile phone?**
a) Make sure your mobile phone supports A2DPand HSF(hands-free)/profile.
b) Ensure your mobile phone is within effective working range.
- 4. When paired with my computer, windows ask for new driver?**
The Bluetooth A2DP/HSF drivers may be required to play via Bluetooth Connection. But the driver is actually needed for the Bluetooth module on your PC, and not the speaker. Different Bluetooth modules may require different drivers. Please contact your PC or Bluetooth module's manufacturer for driver updates.
- 5. Why can't I remotely control the pause, play, previous song and skip track functions with the speaker when playing music?**
a) When you are using 3.5mm AUX audio in connection, you can't pause, change volume or skip tracks with the buttons on the speaker.

- b) This feature needs the Bluetooth devices paired with the speaker to support AVRCP (Audio/Video Remote Control Profile). Please make sure your cell phone or other Bluetooth device supports AVRCP.
- SAFETY NOTICES**
Read the following recommendations before using the Bluetooth speaker.
- Keep it dry and avoid damp places to avoid the product's internal circuit being affected.
 - Keep the product away from direct sunlight or hot places. High temperatures will shorten the life of electronic devices, destroy the battery or distort certain plastic parts.
 - Don't expose the product to extreme cold. It may damage the internal circuit board.
 - Don't try to disassemble the product, any evidence of tampering will void the warranty.
 - Don't use intensive chemical products or detergent to clean the product.
 - Don't scratch the surface with sharp tips.

FCC STATEMENT

Changes or modifications to this unit not expressly approved by the party responsible for compliance could void the user's authority to operate the equipment.

This device complies with Part 15 of the FCC Rules, Operation is subject to the following two conditions:
(1) This device may not cause harmful interference, and
(2) this device must accept any interference received, including interference that may cause undesired operation.

Note: This equipment has been tested and found to comply with the limits for Class B digital device, pursuant to part 15 of the FCC Rules. These limits are designed to provide reasonable protection against harmful interference in a residential installation. This equipment generates, uses and can radiate radio frequency energy and, if not installed and used in accordance with the instructions, may cause harmful interference to radio or television reception, installed and used in accordance with the instructions, may cause harmful interference to radio or television reception, which can be

determined by turning the equipment off and on, the user is encouraged to try to correct the interference by one or more of the following measures:
- Reorient or relocate the receiving antenna.
- Increase the separation between the equipment and the receiver
- Connect the equipment into an outlet on a circuit different from that to which the receiver is connected.
- Consult the dealer or an experienced radio/TV technician for help.



USER MANUAL



07

08

09

10

PACKAGE CONTENTS

- 1- SoundTube PRO Bluetooth Speaker
- 1- User Manual
- 1- USB Charging Cable
- 1- AUX 3.5mm Audio Cable

ABOUT

The VisionTek SoundTube PRO is a compact Bluetooth speaker that can be wirelessly connected to Bluetooth devices such as smart phones, tablets and computers to playback any music collection stored on them. Thanks to the powerful battery and passive radiator, the system delivers amazing bass sound. It can support about 6 to 8 hours' of play time and is the perfect companion for home, office or travel. The process control helps you get rid of complicated connections and wiring distance constraints, ensuring high-quality music anytime and anywhere.

BLUETOOTH CONNECTION

Hold the power button down for a few seconds to turn the device on, when the blue led flashes quickly. The speaker now has entered the Bluetooth pairing mode.

CONNECTING TO MOBILE PHONES/TABLET PCs/COMPUTERS

- Activate your phone's Bluetooth.
- Go to your phone's Bluetooth settings, scan for new Bluetooth devices.
- Find "Sound Tube PRO", click the device name and pair with it.
- If your phone ask for a code, please enter "0000" and confirm it.
- After successfully pairing, the speaker will make a prompt sound and the LED light turns blue.

Note:

Pairing times vary with different mobile phones. It only needs to pair the first time and it will auto connect the devices to which it has paired to before. (The speaker can only remember the last 8 paired devices' names)

AUX AUDIO-IN CONNECTOR

The speaker also features 1x AUX audio in port, simply connect the speaker to your non-Bluetooth mobile phone/MP3 player/PC/laptop with the 3.5mm audio cable. The green light turns on, and you can play via wired connection.

LOW POWER INDICATION

LED indicator light will RED flash to remind you to charge if battery is low (battery only 10% battery power remains).

CHARGING

Connect the micro USB charging cable to a computer or USB charger, a red LED indicates charging status. The Red LED turns off when fully charged. (4-5 hours for charging)

SPECIFICATIONS

Speaker Interfaces
Audio input connector: 3.5mm
AUX cable: supports aux external audio input.
Charging interface: Micro USB; Input 5V

Dimensions and Basic Parameters

Length: 77.8mm ± 0.2mm
Width: 74.7mm ± 0.2mm
Height: 190.8mm ± 0.2mm
Material: ABS + Fabric
Weight: 560g ± 5g

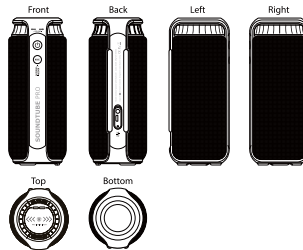

FUNCTION

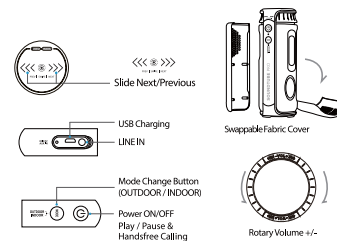

ELECTRICAL SPECIFICATIONS

• Bluetooth Compatibility: It is compatible with Bluetooth 4.1 Class II and supports A2DP V1.2, AVRCP V1.4 profiles.

- Transmission distance: up to 10 m
- Water Resistant: IPX4
- Signal to noise ratio S / N: ≥80dB
- Frequency Range: 180Hz-20KHz
- Distortion THD: ≤ 1%
- Speaker unit: outer diameter 45mm, inner magnet, 4Ω, 10W x 2

Parameters of power

- Battery: built-in lithium battery, 4000mAh
- Charging Voltage/Current: 5V ± 0.25V / 1A
- Charging time: 4-5 hours
- Playing time: 6-8 hours

Power ON / OFF	Press & Hld to power on/off.
Volume - or +	Turn Rotary Dial clockwise to turn the Volume up, counterclockwise to turn the Volume down.
Next/Previous	In the Bluetooth mode, slide to the right to get to the next track and to the left to get to the previous track .
Play/Pause	When playing music, tap to Pause/Play

Answering a call	When a call comes in, press the to pick up the call and press it again to hang up.
Refuse a call	When a call comes in, press twice "quickly" to refuse the call.
EQ mode	Press to select the mode to OUTDOOR or INDOOR, the icon will illuminate accordingly.

Note:
1. Under Bluetooth mode when the 3.5mm audio plug is inserted, the speaker will switch to line in status automatically;
2. When not in use, turn off the device to save power.

WORKING TEMPERATURE	STORAGE CONDITION
Temperature: 0° C ~ 40° C Humidity: 0% ~ 85% RH	Temperature: -30° C ~ 60° C Humidity: 0% ~ 90% RH

01

02

03

04

05

06