

# amber X

## Quick Start Guide

### 01 Download Amber X Manager Companion App

You can access the companion app here: [myamberlife.com/apps](https://myamberlife.com/apps)

We recommend using the Amber X Manager App on your smartphone for setup. If you prefer desktop setup, please follow the instructions on the last page.

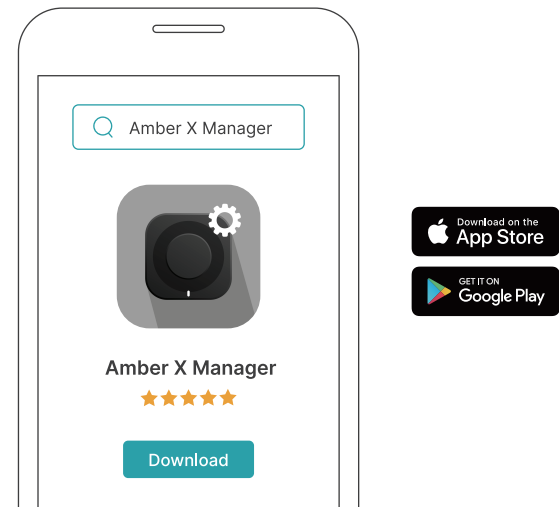

### 02 Physical Setup and Configuration

A. Connect the **LAN port** from your existing switch or router to the **LAN port** on Amber X, using the provided ethernet cable.

★ If you would like to use a WiFi connection for Amber X, please leave the **LAN port unconnected**.

B. Plug in your Amber X unit with the provided power adapter.

C. Power on your Amber X by firmly pressing the power button. Wait for LED to **blink yellow** then continue to **Step 3**.

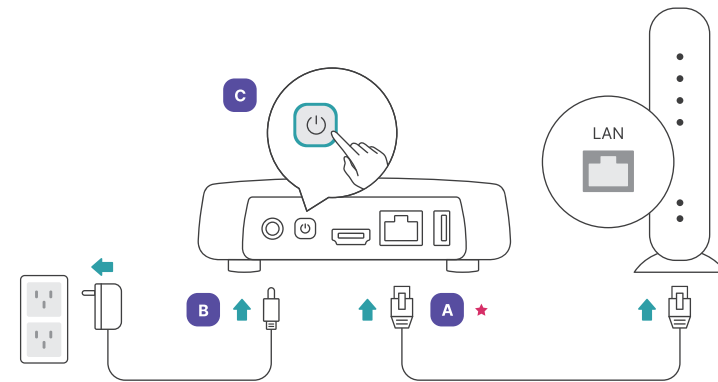

### 03 Amber X Setup

A. Launch the Amber X Manager App. Tap **SET UP MY AMBER** and scan the QR code. You can also find the QR Code on the bottom of Amber X unit.

B. Follow the in-app wizard to complete system setup. Please use the default login and password details below:

Default account / password

admin admin1234

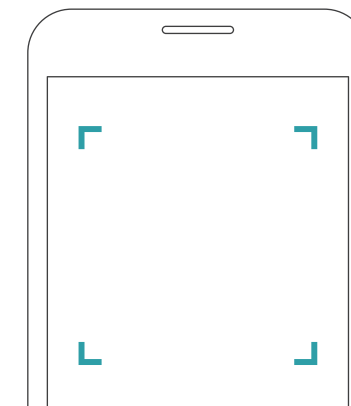

### Optional Desktop Setup - Ethernet Connection Required

A. Connect Amber X to your switch or router via wired connection. Please also connect your Desktop to the same network via wired or wireless connection.

B. Go to <http://latticenode.local> and follow the guide to complete setup.

Default account / password

admin admin1234

For more information, please visit: <https://support.myamberlife.com>.

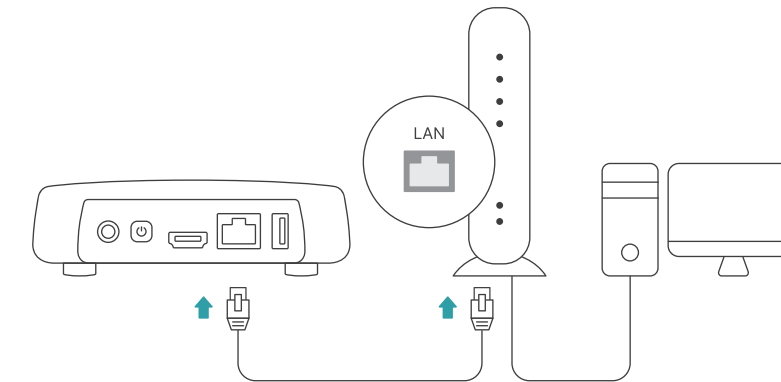

## LED Status Indicators

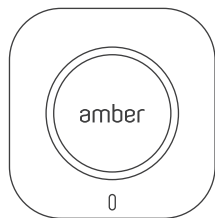

- Blinking White: Booting Up / Shutting Down
- Solid Blue: All Systems Normal
- Blinking Yellow: Waiting for User Action
- Blinking Red: System Errors
- Blinking Blue: No Internet Connection

## Tech Features and Spec

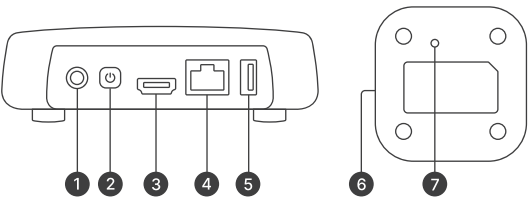

1. Power Connector
2. Power Button
3. HDMI 2.0
4. Gigabit Ethernet Port
5. USB 3.1 Type-A
6. SD Card Reader
7. Reset

## Information on The Network Connection

- A. Amber X supports a wired or wireless network connection. We recommend using a wired connection for optimal performance. When the cable is unplugged, Amber X will automatically re-connect with the last wireless access point it was connected to previously.
- B. If you like to change your wireless connection to a wired connection, simply plug in the network cable.
- C. If you like to switch your wireless connection from one access point to another one (or you are changing the password of your wireless access point), please press the reset button for 5 seconds. Wait for a blinking yellow indicator and use the Amber X Manager App to scan the QR code and repeat the initial set-up from the App.
- D. If it is your first time changing from a wired to wireless connection, please unplug the network cable, then press the reset button for 5 seconds and wait for the LED on Amber X to blink yellow. You will then be able to use the Amber X Manager App to scan the QR code and repeat the initial set-up from the App.
- E. If you experience any issues with your wireless connection, you can press the reset button for 5 seconds to restart network set-up. The network reset only clears the network configuration and will not affect other system settings or any personal data.

## Amber Companion Apps

You can find the Amber Companion Apps at: <https://www.myamberlife.com/apps/>.

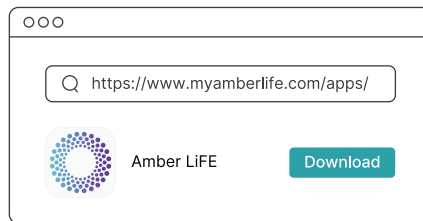

## Troubleshooting Information

- A. To reboot Amber X, firmly press the power button for 5 seconds. Wait until the LED indicator is completely off then press the power button to restart.
- B. To enter troubleshoot mode, firmly press the power and reset buttons together for 10 seconds. This will enable you to upgrade or reinstall the Amber OS.
- C. For product registration, warranty or technical information please visit the Amber support portal at: <https://support.myamberlife.com>.

### FCC ID: 2AP7A-AMBERX

This device complies with Part 15 of the FCC Rules. Operation is subject to the following two conditions:

- (1) This device may not cause harmful interference, and
- (2) this device must accept any interference received, including interference that may cause undesired operation.

This equipment has been tested and found to comply with the limits for a Class B digital device, pursuant to Part 15 of the FCC Rules. These limits are designed to provide reasonable protection against harmful interference in a residential installation. This equipment generates, uses and can radiate radio frequency energy and, if not installed and used in accordance with the instructions, may cause harmful interference to radio communications. However, there is no guarantee that interference will not occur in a installation. If this equipment does cause harmful interference to radio or television reception, which can be determined by turning the equipment off and on, the user is encouraged to try to correct the interference by one of the following measures:

- Reorient or relocate the receiving antenna.
- Increase the separation between the equipment and receiver.
- Connect the equipment into an outlet on a circuit different from that to which the receiver is connected.
- Consult the dealer or an experienced radio/TV technician for help.

### FCC Caution:

- Any changes or modifications not expressly approved by the party responsible for compliance could void the user's authority to operate this equipment.
- This transmitter must not be co-located or operating in conjunction with any other antenna or transmitter.

### FCC Radiation Exposure Statement:

This equipment complies with FCC radiation exposure limits set forth for an uncontrolled environment. This equipment should be installed and operated with minimum distance 20cm between the radiator & your body.

Note: The country code selection is for non-US model only and is not available to all US model. Per FCC regulation, all Wi-Fi product marketed in US must fixed to US operation channels only.

### CE

This device complies with Directive 2014/53/EU issued by the Commission of the European Community. A minimum separation distance of 20 cm must be maintained between the user's body and the device, including the antenna during body-worn operation to comply with the RF exposure requirements in Europe.

Radio Technology	Maximum Transmit Power EIRP(dBm)
WLAN WIFI 802.11x2.4G (2400~2480MHz)	19.71
WLAN WIFI 802.11a/ac 5G (5150~5850MHz)	22.83

- Operating temperature: 0 °C to 40 °C
- Battery and safety info.  
Lithium coin cell battery notice

**CAUTION:**  
DANGER OF EXPLOSION IF BATTERY IS INCORRECTLY REPLACED.

When replacing the lithium coin cell battery, use only the same or an equivalent type that is recommended by the manufacturer. The battery contains lithium and can explode if not properly used, handled, or disposed of.

Do not:

- Throw or immerse into water
- Heat to more than 100 °C
- Repair or disassemble

Dispose of the battery as required by local ordinances or regulations.

### - Declaration of Conformity

Hereby, LatticeWork, Inc. declares that the radio equipment type AL11 is in compliance with Directive 2014/53/EU. The full text of the EU declaration of conformity is available at the following internet address:  
<https://www.myamberlife.com/doc/>

### - WLAN 5GHz:

Operations in the 5.15-5.35GHz band are restricted to indoor usage in member states: AT, BE, BG, CH, CZ, DK, EE, FR, DE, HR, IS, IE, IT, EL, ES, FI, CY, LV, LI, LT, LU, HU, MT, NL, NO, PL, PT, RO, SE, SI, SK, TR, UK.

### ▲ CAUTION

The product contains components that can be damaged by electrostatic discharge (ESD). To reduce the chance of ESD damage, work over a non-carpeted floor, use a static dissipative work surface (such as a conductive foam pad), and wear an ESD wrist strap connected to a grounded surface.

Amber X  
Model: AL11

LatticeWork, Inc. © All Rights Reserved

2210 O'Toole Ave, Suite 250, San Jose, CA 95131, USA