

PHILIPS

User manual  
產品手冊

# SPK6314 Wireless keyboard 無線鍵盤

User manual  
English  
產品手冊  
中文



## Functional overview

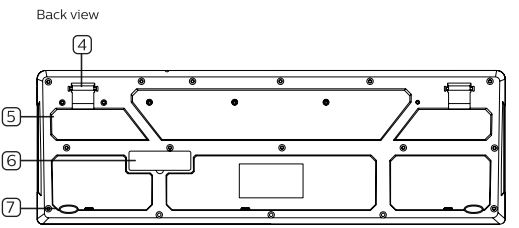
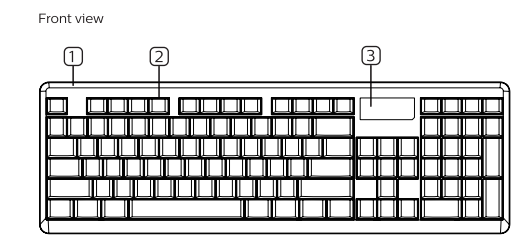

- ① Face cover
- ② Keycap
- ③ Low voltage indicator
- ④ Tripod
- ⑤ Bottom cover
- ⑥ AA battery
- ⑦ Foot pad

1

## Product description

- Connectivity: 2.4G wireless connectivity up to 10 meters barrier-free operating distance.
- Multiple automatic sleep function, unplug the receiver or shut down the state, the keyboard quickly enters deep sleep, more battery saving.
- Waterproof (splashing water) design, protect the keyboard in case of accidental splashing.
- Low voltage alarm: you will be remind to replace the battery once the low voltage alarms.

## Specification

- Number of keys: 104 (105/106/107)
- Key force: 55±5g
- Lifespan: 8 million times
- Product weight: 402±10g
- Power supply: 1\*AAA battery
- Product size: 433(L)mmx139.5(W)mmx20.5(H)mm±0.5mm
- Rated voltage / current: DC 1.5V / ≤ 5mA

2

## Install

**Plug and play**  
The wireless keyboard supports plug and play, and after the USB connection, the computer will automatically detect the keyboard, without driving or CD.

## Package contents

- Wireless keyboard
- USB receiver
- AAA alkaline battery
- Instruction book
- Warranty card

## Product certification

 This device complies with Part 15 of the FCC Rules. Operation is subject to the following two conditions: (1) This device may not cause harmful interference, and

(2) This device must accept any interference received, including interference that may cause undesired operation.

Warning: Changes or modifications not expressly approved by the party responsible for compliance could void the user's authority to operate the equipment.

3

**NOTE:** This equipment has been tested and found to comply with the limits for a Class B digital device, pursuant to Part 15 of the FCC Rules. These limits are designed to provide reasonable protection against harmful interference in a residential installation. This equipment generates uses and can radiate radio frequency energy and, if not installed and used in accordance with the instructions, may cause harmful interference to radio communications. However, there is no guarantee that interference will not occur in a particular installation. If this equipment does cause harmful interference to radio or television reception, which can be determined by turning the equipment off and on, the user is encouraged to try to correct the interference by one or more of the following measures: Reorient or relocate the receiving antenna. Increase the separation between the equipment and receiver.

Connect the equipment into an outlet on a circuit different from that to which the receiver is connected. Consult the dealer or an experienced radio/TV technician for help.

4

## SR002 wireless receiver instruction

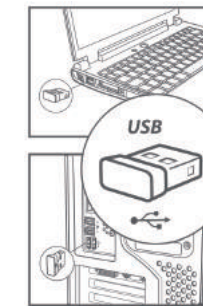

Device: empty computer USB port.

Plug and play, no need to install the driver.

5

## 功能概述

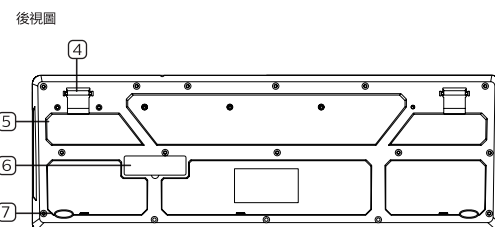
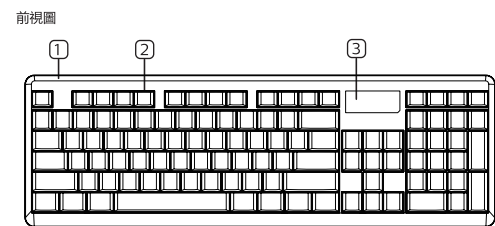

- ① 面蓋
- ② 鍵帽
- ③ 低壓指示燈
- ④ 腳架
- ⑤ 底蓋
- ⑥ 電池倉
- ⑦ 腳墊

6

## 產品描述

- 傳輸方式：2.4G無線傳輸可達10米無障礙操作距離。
- 多重自動休眠功能，拔掉接收器或開關等狀態，鍵盤快速進入深度休眠，更節省電池。
- 防液體（濺水）設計，如遇意外濺洒可適時保護鍵盤。
- 低電壓報警指示功能，可提醒更換電池。

## 規格

- 按鍵數量：104 (105/106/107)
- 按鍵力度：55±5g
- 按鍵壽命：800萬次
- 產品重量：402±10g
- 供電方式：1節AAA電池
- 產品尺寸：433(L)mmx139.5(W)mmx20.5(H)mm±0.5mm
- 額定電壓/電流：DC 1.5V / ≤5mA

7

## 安裝

**即插即用**  
無線鍵盤支持即插即用，與USB連接之後，電腦會自動偵測到鍵盤，無需驅動或者CD。

## 包裝內容

- 無線鍵盤
- USB接收器
- AAA鹼性電池
- 說明書
- 保修卡

## 產品認證

 **FCC認證聲明：** 該裝置符合FCC規則第15部分。運作須符合以下兩項條件：

(1) 本裝置不得造成有害干擾  
(2) 本設備必須接受接收到的任何干擾，包括可能導致不希望的操作的干擾。

警告：未經遵守方明確批准的變更或修改可能會使用戶喪失操作設備的權力。

注：該設備已經過測試，符合FCC規則第15部分對B類數字設備的限制。

8

這些限制旨在提供合理的保護，防止有害的干擾，在住宅安裝。本設備產生使用並能輻射射頻能量，如不按照說明安裝和使用，可能對無線電通信造成有害干擾。但是，不能保證在特定的安裝中不會發生干擾。如果該設備確實對無線電或電視接收造成有害干擾，可通過關閉或打開設備來確定，則鼓勵用戶採取下列一項或多項措施來糾正干擾：  
重新定位或重新定位接收天線。  
增加設備和接收器之間的距離。  
將設備連接到與所連接的接收器不同的電路上的插座上。  
向經銷商或有經驗的廣播/電視技術人員尋求幫助。

**射頻警告聲明：**  
該裝置已經過評估，以滿足一般射頻暴露要求。該裝置可在不受限制的便攜式暴露條件下使用。

9

## SR002接收器使用說明

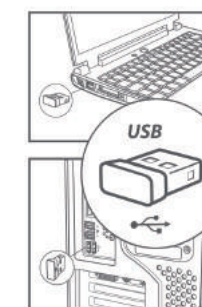

設備：空置電腦USB介面

即插即用，無需安裝驅動

10



© 2018 Koninklijke Philips N.V. All rights reserved.  
Specifications are subject to change without notice.  
Zhejiang and the Philips brand names are registered trademarks of Koninklijke Philips N.V. and are used under license from Koninklijke Philips N.V.  
Made in China  
Through the following website, register your product in order to get support:  
www.philips.com/welcome  
Execution Standard: GB/T 14088-2010  
Manufacturer: Dongguan Sipele Electronics Co., Ltd.  
Address: No.28 Huan Shou Street, Changlong Village, Huangjiang Town, Dongguan City, Guangdong, China

© 2018 Koninklijke Philips N.V. 保留所有權利。  
規格如有更改，恕不另行通知。  
浙江和 Philips 商標名稱均為皇家菲利浦電子公司註冊商標。  
此設備經許可在中國境內使用。  
中國製造  
請通過以下網站，註冊您的產品以獲得支持：  
www.philips.com/welcome  
執行標準：GB/T 14088-2010  
製造商：東莞賽普利電子有限公司  
地址：中國廣東省東莞市黃江鎮長壽村28號