

68.00 mm

# User Manual

Model: Qstand II

Qstand II is a wireless charging stand that can charge your smartphone wirelessly. It is designed to be used with a wall adapter and a Type-C cable. The stand is adjustable and can be used in both vertical and horizontal positions. It features an adjustable coil, a horizontal bracket, a vertical bracket, a sliding switch, a stand, an LED, and an input port.

**Output Power** 15W / 10W / 7.5W / 5W

**Dimensions** 5.4" x 2.68" x 0.31 inch

**Weight** 2.82oz (80g)

120.00 mm

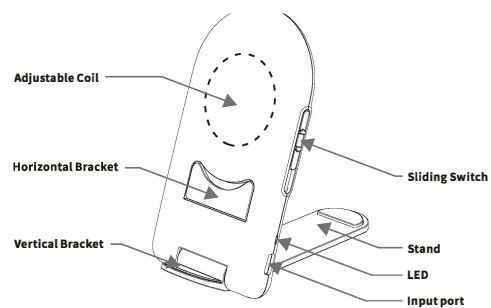

## Connect the charging cradle to the wall adapter.

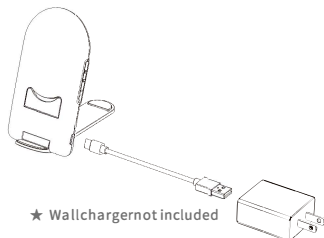

## Charging the mobile device

Place your mobile device on the wireless charger (Your phone must be able to support wireless charging or be equipped with a wireless receiver chip).

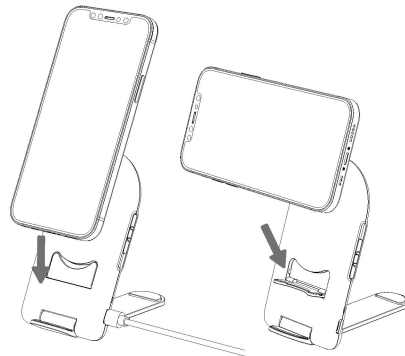

## Notice:

- In order to suit models in different sizes, you need to adjust button up or down on the right side to charge your device or get a better performance.
- For VERTICALLY charging, the height of the device (including the phone case) is:
  - ≤148mm (5.82") (like iPhone 12 mini & iPhone 8), switches down to the LOW gear;
  - ≥148mm (5.82"), switches up to the UPPER gear (Default mode),
- For HORIZONTALLY charging, switch down to the LOW gear and open the horizontal bracket and put the cell phones or airpods on it;
- If it does not charge, please toggle the position of the right button up or down.

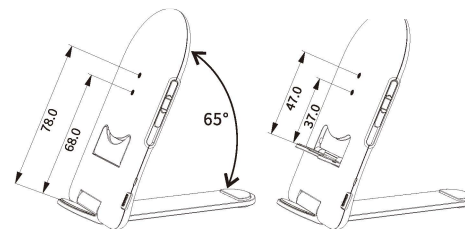
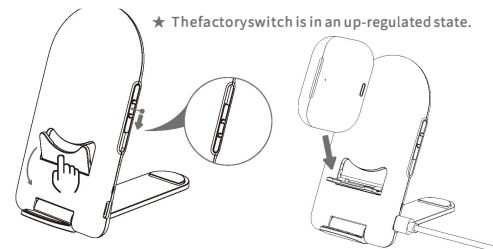

## CORRECT POSITION

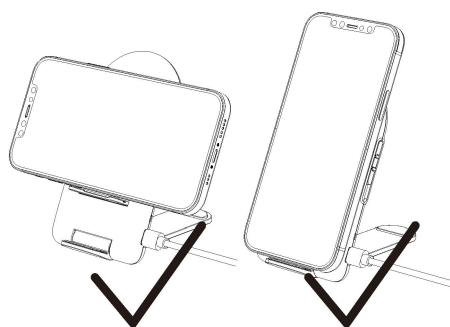

## NO WIRELESS CHARGING

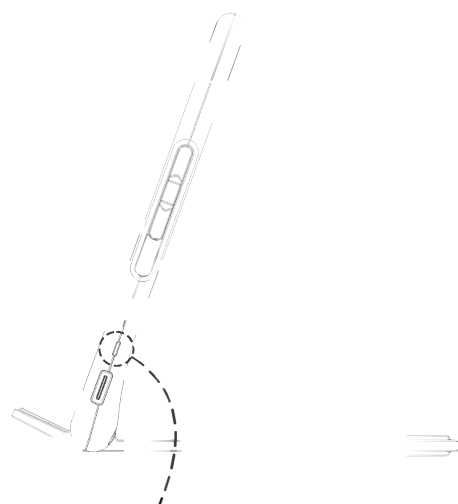
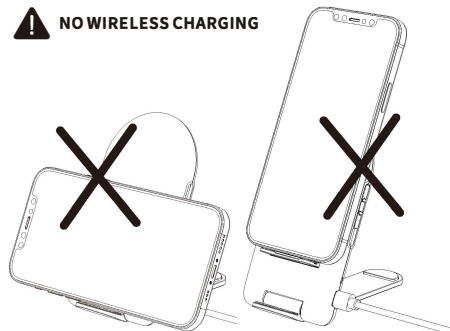

Standby	Red LED Stays On
Working Properly	Blue LED Stays On
Fully Charged	Blue LED Stays On
Over-voltage/Low voltage	Red LED Flashes
FOD	Red and Blue LED Flashes

- Quick charge QC2.0/ QC3.0/QC4.0 wall adapter required to access 15W fast wireless charging.
- To ensure proper use, please use our TYPE-C cable (included) or other fast charging TYPE-C cable.
- It is normal for the wireless charger and your smartphone to get hot under working conditions, especially when the phone is being charged and used at the same time (such as playing music).
- Not works with 5V/1A or lower input. (such as PC powered or USB port from socket).
- Remove the magnetic or metal accessories from the phone case when charging.



Please refer to the user manual for more information about the wireless charging and charging properties. The user manual is available at the bottom of the page.



This equipment has been tested and found to comply with the limits for a Class B digital device, pursuant to part 15 of the FCC Rules. These limits are designed to provide reasonable protection against harmful interference in a residential installation. This equipment generates, uses and can radiate radio frequency energy and, if not installed and used in accordance with the instructions, may cause harmful interference to radio communications. However, there is no guarantee that interference will not occur in a particular installation. If this equipment does cause harmful interference to radio or television reception, which can be determined by turning the equipment off and on, the user is encouraged to try to correct the interference by one or more of the following measures:

- Reorient or relocate the receiving antenna.
- Increase the separation between the equipment and receiver.
- Connect the equipment into an outlet on a circuit different from that to which the receiver is connected.
- Consult the dealer or an experienced radio/TV technician for help.

Caution: Any changes or modifications to this device not explicitly approved by manufacturer could void your authority to operate this equipment.

This device complies with part 15 of the FCC Rules. Operation is subject to the following two conditions: (1) This device may not cause harmful interference, and (2) this device must accept any interference received, including interference that may cause undesired operation.

The device has been evaluated to meet general RF exposure requirement.

The distance between user and products should be no less than 15cm.