

POWERHBQ Pro说明书

成品尺寸：80*80mm

POWERHBQ Wireless Headphones

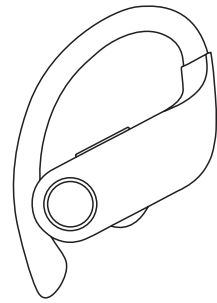

USER MANUAL

Function Diagram

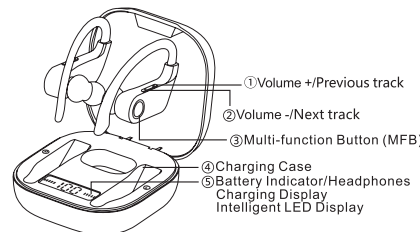

Specification

Headset Parameter

Wireless Version:V5.0+EDR	Wireless Operating Frequency: 2.402GHz-2.480GHz
Receiving Distance Range: ≤10 meters	Audio Signal/Noise Ratio S/N: ≥100dB
Battery: Lithium battery - 3.7V, 100mAh	Microphone MIC: Silicon Wheat, -42dB ±3DB
Charging Time: 1-1.5hrs to Charge earbuds; 2hrs to Charge charging case	
Call/Playtime: 8-10 Hours (80% volume) (the actual use time changes with the song types and volume requirements)	
Support: HFP1.7, 1.2, A2DP1.3, AVRCP1.6, SPP1.2andPBAP1.2,BDR/BLE	

Charging case battery capacity

Battery capacity: 950mAh	Charging voltage: 5V/1A
Charging port: Micro USB	To charge earbuds: 4-5 times

Volume "+"/Previous track: Short press/ long press
Volume "-"/Next track: Short press/ long press

MFB Multi-function Button

Answer/hang up a call: Click on Either of Earbud Multi-function Button Once
Reject an incoming call: Quick Click on Either of Earbud Multi-function Button Twice
To Activate Siri: In standby mode, long press on Either of Earbud Multi-function Button about 1 second, and hear a "beep" and then activate Siri.
When using with dual earbuds mode, the left channel is the host earbud and the right channel is the vice earbud.

Operating Instructions

Steps of pair the TWS Earbuds with Mobile phone(firstly)

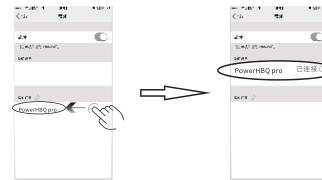

1. Take out L/R earbuds from the charging case, they will Auto power on (LED flashing Red and Blue alternately) and pair with each other (LED of R earbud goes off, the L one flashing Red and Blue alternately). Please turn on the "Wireless" on your cellphone and choose "PowerHBQ pro" on your list to connect.
 2. Switch on, Hold down the L/R earbuds multi-function buttons simultaneously about 2 seconds to power on the earbuds, (the earbuds LED will flash Blue light)Then they will pair with each other automatically. (Once they paired with each other successfully, R earbuds LED light goes off, and the L earbud LED flashing Red and Blue alternately,nonstop.) Please turn on the "Wireless" on your cellphone and choose "PowerHBQ pro" on your list to connect.
- If L/R earbuds cannot be pair with each other, please restore factory settings.

Automatic connection

After the first connection, the next time you turn it on, it will automatically connect back to the last phone.

Steps of pair the single Earbud with Mobile phone

1. Take out L earbud from the charging case, it will Auto power on, if TWS mode had connected with your phone, the L one will automatically connect back to your phone.
2. Using firstly, take out L earbud from the charging case.Auto power on/ Switch on, LED flashing Red and Blue alternately and turn on the "Wireless" on your cellphone and choose "PowerHBQ pro" on your list to connect. Take out R earbud from the charging case,Auto power on/ Switch on, R earbud will pair with L earbud automatically. At this time, they were used as the wireless TWS earbuds.
3. Using firstly, take out R earbud from the charging case,Auto power on/ Switch on, R LED flashing Red and Blue alternately and turn on the "Wireless" on your cellphone and choose "PowerHBQ pro" on your list to connect. Take out L earbud from the charging case, Auto power on/ Switch on, R earbud couldn't pair with L earbud. At this time, they were used as two Single Earbud individually.
4. If the TWS mode had connected to your phone, after that, R earbud as a single mode connected and goes off, long press the L/R earbuds multi-function buttons simultaneously to power on the earbuds or take out from the charging case auto power on, they will connect to the mobile device as the default TWS mode preferentially.

Using a single mode or due to unknown reasons, cause that two earbuds couldn't pair with each other automatically.(LED of one earbud flashing, or LED of two earbuds flashing Red and Blue alternately), please do the following steps to restore the factory settings : Take out L/R earbuds from the charging case at the same time and hold down the MFB button about 3

seconds to turn off (the red light quickly flashes three times), and long press the L/R earbuds MFB button at the same time about 9 seconds after the earbuds flash red and blue twice, please put off your hands,then the earphones will turn off. At this point, put earbuds back into the charging case and take out again, or switch on, both of them flash blue, after 1.5 seconds, pair with each other successfully, LED of R earbud goes off, the L one flashing Red and Blue alternately.
After restoring the factory settings, you need to re-pair with the mobile phone. Firstly please delete device: PowerHBQ pro on your mobile phone Wireless list , re-search for pairing name "PowerHBQ pro" again, click it to connect.

General problem of using process

How to charge?

(Prior to first use-Make sure both the Earbuds and the Charging Case are fully charged.)
To Charge the Charging Case
Connect the Micro USB charging port on the side of the Charging Case to a charger with USB ports, (or to the USB output of a PC or other computer)by the Micro USB cable; it will start charging. When being charged, the LED digital display will show current electricity quantity.
To Charge the Earbuds.

1. Make sure the Charging Case is fully charged, (or connect the included Micro USB Cable as guided above)
2. Put Earbuds into the charging slots correctly, Close the charging case's lid; it will start charging the Earbuds. (You can charge the Charging Case and Earbuds at the same time, you can also get the Charging Case fully at first, then use the charging case to charge the Earbuds. Once the earbuds are fully charged, the charging case will auto power off and the earbuds LED light goes off.)

How to Switch On/Off the Earbud?

To Switch On: Hold down the MFB about 2 seconds until the Earbud LED light flash Blue, at the same time there will be Voice Reminder "Power On"; (Or take out the earbud from charging case, it will Auto power on.)
To Switch Off: Hold down the MFB about 5 seconds, until the Earbud LED light flash Red, at the same time there will be two beeps, Voice Reminder "Power Off" (Or put the earbud back into the charging case, it will Auto power off.)

After using the earphone for a period of time, will be oxidized by the sweat/air, may cause earbud could not be charged or turned on, firstly using cloth with alcohol the to clean three charging points of earbud and three copper thimbles of the charging case, then it can be solved.

How to pair the Twins Earbuds with my phone?

(1)Pair twins earbuds firstly
Method 1: Take out two earbuds from the charging case, they will Auto power on and pair with each other.
Method 2: Hold down the 2 earbuds multi-function buttons simultaneously about 2 seconds to power on the earbuds, (the earbuds LED will flash Blue light.)Then they will pair with each other automatically. (Once they paired with each other successfully, one earbuds LED light goes off, and the other earbud LED flashing Red and Blue alternately,nonstop.)

(2)Connect to the device:
Now open the Bluetooth setting on your phone, search and select"PowerHBQ Pro"to connect, at this moment, you will hear a voice prompt "Connected"
Note: 1. When you put the earbuds back to the charging case, they will turn off and start to charging; if take out them from the charging case, they will turn on and pair with each other automatically.
2. When using with dual earbuds mode, the left channel is the host earbud, and the right channel is the vice earbud. If you put the host earbud [L] back to charging case, the vice earbud [R] will auto power off at the same time; but if you put the vice earbud back to charging case, the host earbuds will continue to work with single earbud mode.

Safety Precautions

The Earbuds are excellent quality, in order to extend lifespan, please refer to the instructions below:

1. Please Keep the device out of extreme heat, humidity, corrosion.
2. Please Prevent the device from being strike, fall, warp, soaking etc.
3. Please don't dismantle the Earbuds or Charging Case.
4. Please don't overcharge the device for a long time, otherwise it will decrease lifespan.
5. Please stop using the device if it causes any discomfort or pain.
6. Use DC 5V-1A chargers/adapters certified by a regulated manufacturer.
Recharging and discharging the headphones repeatedly will lead to decrease in battery performance over time, which is normal for all rechargeable electronic products.

Inside the Box:

- | | |
|---------------------|---------|
| 1. Wireless Earbuds | x2PCS |
| 2. Charging Case | x1PCS |
| 3. Micro USB Cable | x1PCS |
| 4. Extra Ear Caps | x2Pairs |
| 5. User Manual | x1PCS |

FCC Statement

This device complies with Part 15 of the FCC Rules. Operation is subject to the following two conditions: (1) this device may not cause harmful interference, and (2) this device must accept any interference received, including interference that may cause undesired operation.

Changes or modifications to this unit not expressly approved by the party responsible for compliance could void the user's authority to operate the equipment.

NOTE: This equipment has been tested and found to comply with the limits for a Class B digital device, pursuant to Part 15 of the FCC Rules. These limits are designed to provide reasonable protection against harmful interference in a residential installation. This equipment generates, uses and can radiate radio frequency energy and, if not installed and used in accordance with the instructions, may cause harmful interference to radio communications. However, there is no guarantee that interference will not occur in a particular installation. If this equipment does cause harmful interference to radio or television reception, which can be determined by turning the equipment off and on, the user is encouraged to try to correct the interference by one or more of the following measures:

-- Reorient or relocate the receiving antenna.

- Increase the separation between the equipment and receiver.
- Connect the equipment into an outlet on a circuit different from that to which the receiver is connected.
- Consult the dealer or an experienced radio/TV technician for help.

This device and its antenna(s) must not be co-located or operation in conjunction with any other antenna or transmitter.

The device has been evaluated to meet general RF exposure requirement. in portable exposure condition without restriction.