

MULTI BCONE OPERATION

When multiple Pool Units are paired with one Home Unit, the Pool Unit must be selected before an operation mode is set. The Select Device button alternates between the multiple Pool Units. The LEDs indicate the Pool Unit that is currently selected.

Press the Select Device button to light the LED of the relevant Pool Unit (i.e. press once to select the first Pool Unit, press twice to select the second Pool Unit, and so on).

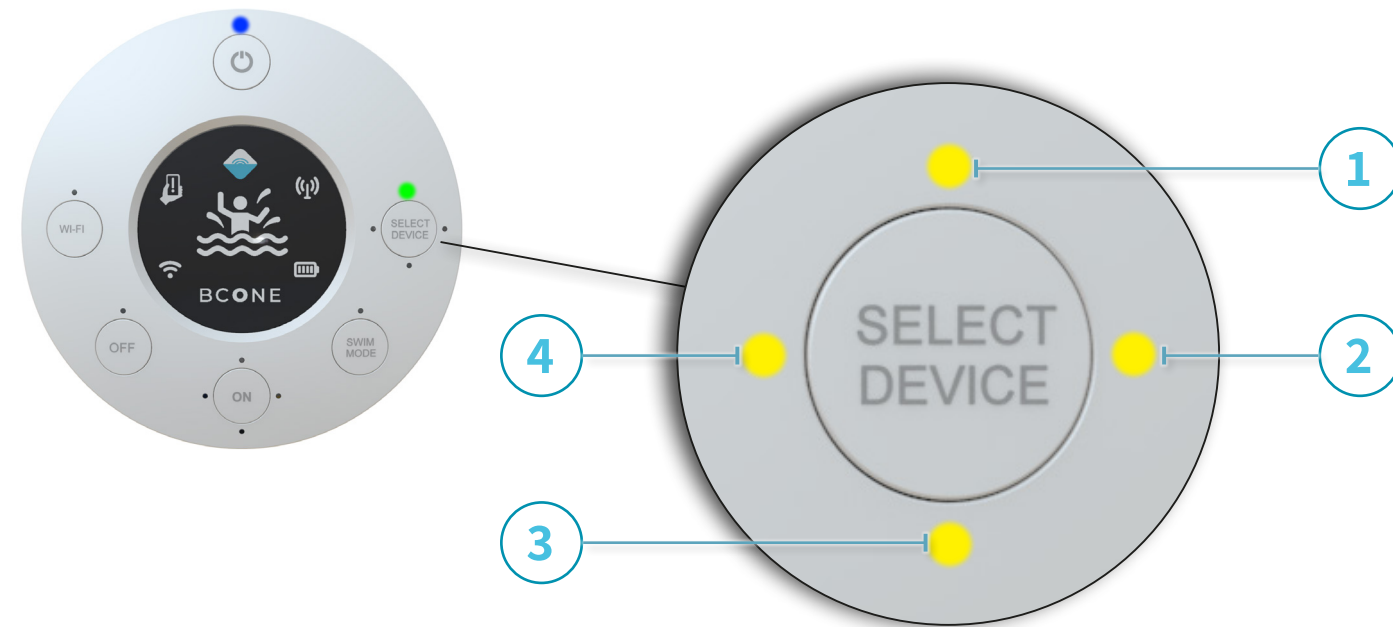

After selecting a Pool Unit, one of the operation mode LEDs lights up for a few seconds to indicate the current operation mode.

To change the Operation Mode for the selected Pool Unit, see [Operation Modes](#).

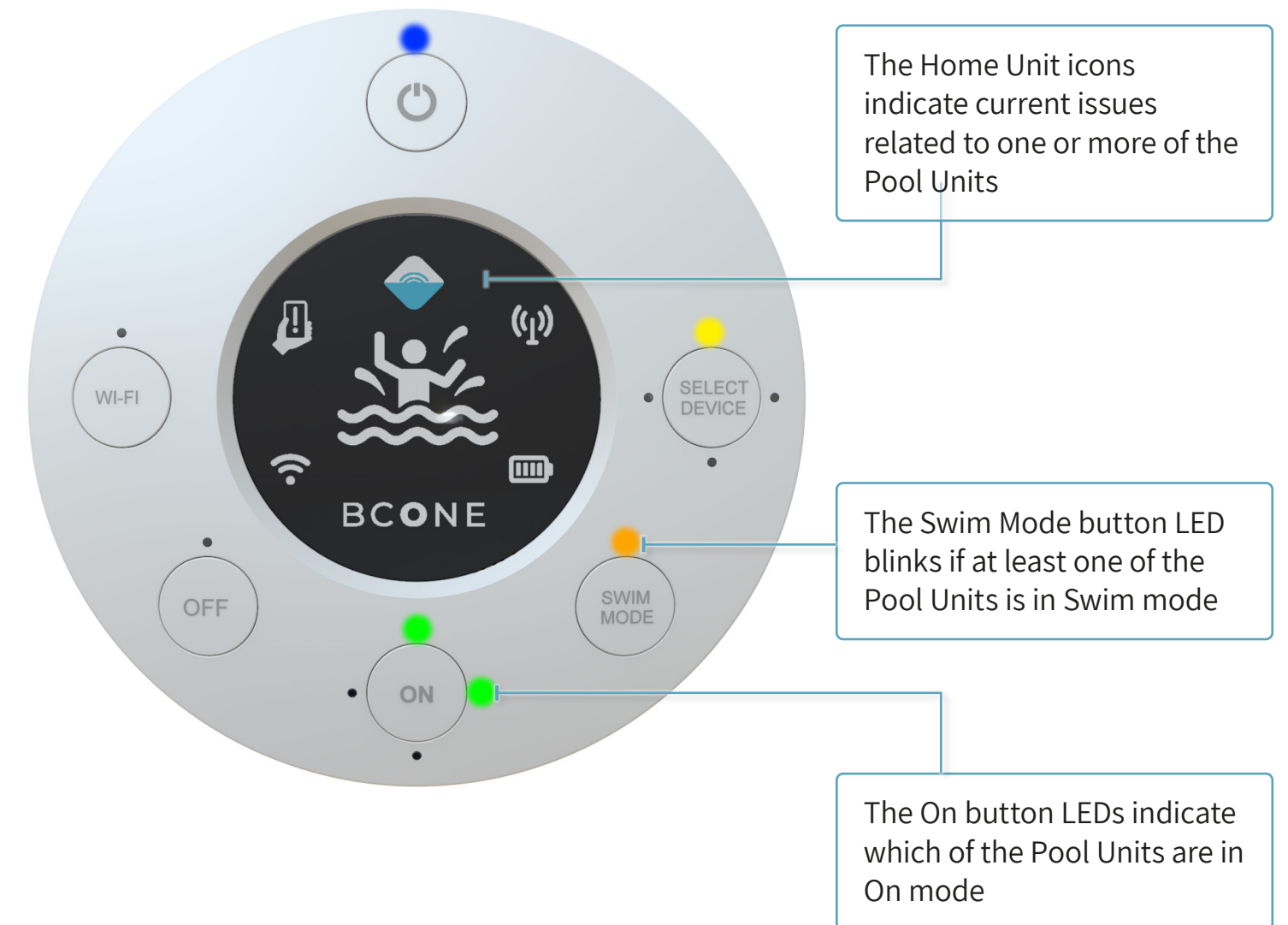

THANK YOU!

LIFEBUOY

Make Your Pool Safer



Yuvalim Business Campus,
Ness Ziona,
Israel



info@lifebuoyalarm.com

Copyright © 2021-2022 Lifebuoy, all rights reserved. No part of this publication may be reproduced, transmitted, transcribed, stored in a retrieval system, or translated into any language or computer language, in any form or by any means, electronic, mechanical or otherwise without prior written permission of Lifebuoy.

Rev B | Doc P/N: BC-00-70-002