

Your Family Pets Pals

 M STREAM

— 摩豆宠拍恋水宝 —

User Guide
使用说明书



Download App 下载App



Please download "MOORE CARE" app by searching App Store or Google Play or scanning the QR code.

App客户端请在应用商店搜索"MOORE CARE"或扫描二维码下载，完成注册流程。

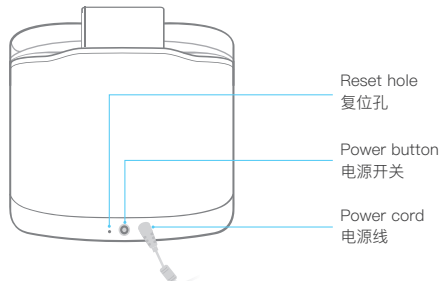
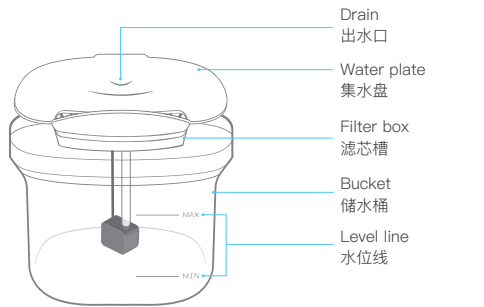
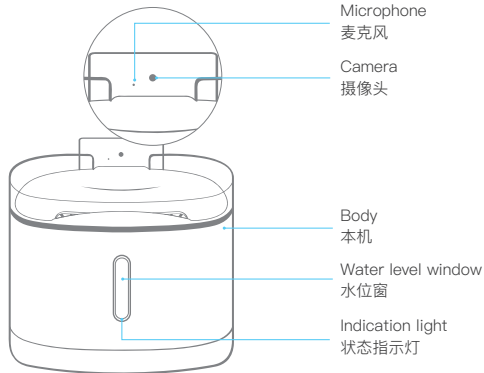

Warranty Card 保修卡

Product Name
产品名称 MOORE STREAM
摩豆宠拍恋水宝

Name
姓名

Phone
电话

Address
地址

Date
购买日期

Dealer stamp
经销商商店章

本凭证为商品退换货的重要依据，请您妥善保管！
本产品自销售日开始保修依原销售地购买的保修法规范围，
非人为因素造成的质量问题，可退换货。

非保修条例：

- * 用户在使用过程中，以下情况下不属于保修范围：
- * 因用户保管不当而造成的故障和损坏，或造成产品零部件的丢失。
- * 由于人为因素造成的破坏（如碰撞、事故）或未按照说明书使用所造成的故障。
- * 私自拆卸、改装产品、维修等。
- * 无保修凭证、缺失有效发票、产品已过保修期。
- * 不可抗力（如火灾、雷击、地震等）造成的故障、损坏。
- * 其他非因产品本身质量问题导致的故障或损坏。
- * 消耗品（滤芯、宠物扣内的纽扣电池）不在保修范围内。

Please keep Warranty Card for future service request. The Warranty depends on the local contract laws or rules of purchase place.

This Limited Warranty applied to physical goods, it covers any defects in material and workmanship under normal use during the warranty period. This Limited Warranty does not cover any problem that is caused by:

- * Conditions, malfunctions or damage not resulting from defects in material or workmanship.
- * Damage resulting from accident, alteration, misuse, abuse, fire, flood, weather issues, improper installation, act of god or use of product not approved by MOOREdoll Inc.
- * Repairs to parts or system resulting from unauthorized modifications made to the appliance.
- * Damage caused during shipping, or failures which are caused by product not supplied by warrantor.
- * Consumable materials. (filter, battery, belt)

Specs 规格

Product Name : MOORE STREAM

Model : MD005

Input : 5V --- 1A

Adapter : 100-240V ~ 50/60Hz

Weight : 2500g

Dimensions : (H)250x(W)243x(L)258 mm

Capacity : 3L

Manufacturer : Mooredoll Inc.

Address : 2F., No.29, Sec. 3, Nanjing E.Rd., Zhongshan Dist.,
Taipei City 104, Taiwan

Factory : Soartek Electronic Co., Ltd.

Address : No.9, Xifa Rd., Tangxia Town, Dongguan, Guangdong, China.

Service mail : care@mooredoll.com

<http://www.mooredoll.com/stream>

MADE IN CHINA

产品名称：摩豆宠拍恋水宝

型号：MD005

输入：5V ---1A

电源：100-240V ~ 50/60Hz

产品重量：2500g

外型尺寸：(H)250x(W)243x(L)258 mm

容量：3L

制造商：摩豆创意科技股份有限公司

地址：台北市中山区南京东路三段29号2楼

生产企业：太尼电电子科技(东莞)有限公司

地址：广东省东莞市塘厦镇林村西湖西发路9号

客服邮箱：care@mooredoll.com

<http://www.mooredoll.com/stream>

中国制造

FCC Statement

This equipment has been tested and found to comply with the limits for a Class B digital device, pursuant to part 15 of the FCC Rules. These limits are designed to provide reasonable protection against harmful interference in a residential installation. This equipment generates, uses and can radiate radio frequency energy and, if not installed and used in accordance with the instructions, may cause harmful interference to radio communications. However, there is no guarantee that interference will not occur in a particular installation. If this equipment does cause harmful interference to radio or television reception, which can be determined by turning the equipment off and on, the user is encouraged to try to correct the interference by one or more of the following measures:

- Reorient or relocate the receiving antenna.
- Increase the separation between the equipment and receiver.
- Connect the equipment into an outlet on a circuit different from that to which the receiver is connected.
- Consult the dealer or an experienced radio/TV technician for help.

FCC Radiation Exposure Statement

This device complies with FCC radiation exposure limits set forth for an uncontrolled environment and it also complies with Part 15 of the FCC RF Rules. This equipment must be installed and operated in accordance with provided instructions and the antenna(s) used for this transmitter must be installed to provide a separation distance of at least 20 cm from all persons and must not be co-located or operating in conjunction with any other antenna or transmitter. End-users and installers must be provided with antenna installation instructions and consider removing the no-collocation statement.

This device complies with Part 15 of the FCC Rules. Operation is subject to the following two conditions:

- (1) This device may not cause harmful interference, and
- (2) This device must accept any interference received, including interference that may cause undesired operation.

Caution!

Any changes or modifications not expressly approved by the party responsible for compliance could void the user's authority to operate the equipment.

This product supports Bluetooth communication between MOORE STREAM and MOORE TAG. According to the Bluetooth signal to detect your pet closing and drinking.

本产品支持蓝牙通讯，专为摩豆宠物扣所发送的蓝牙信号接收使用，为侦测宠物靠近喝水之依据。



Prepare to use 安装及使用

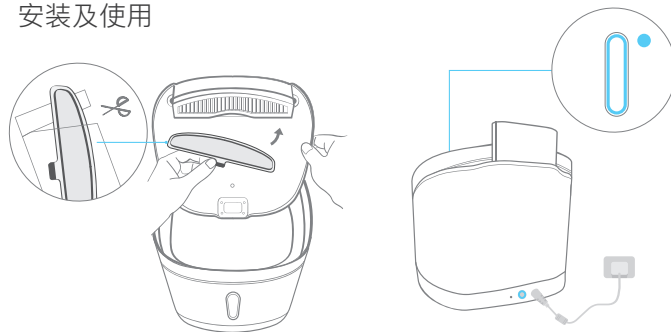

①

Install a filter to the back of water plate, and put the water plate back to water bucket.

* Suggest to replace the filter every 5-6 weeks.

请拆除滤芯外层的包装袋，拿起集水盘将滤芯插入内侧的滤芯槽内，再放回储水桶。

* 滤芯使用周期为5-6周。

②

Power on, and wait until the blue light becomes flashing.

请将产品插电并开启电源，水位窗灯号为蓝光长亮。

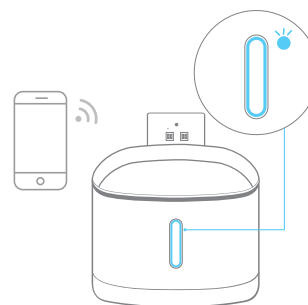

③

Please confirm the blue light is flashing and pull out the bucket, scales will be reset after paired. Follow App instructions to pair the device, the light will turn to breath and red after paired success.

当水位窗灯号变成蓝光闪烁表示产品进入配对状态，先将储水桶拿起来让产品归零，打开“MOORE CARE” App选取“摩豆宠拍恋水宝”跟着步骤进行配对，配对成功后会变成蓝光呼吸状态；低(无)水量时为红灯呼吸状态，再将储水桶放回本机。

Pair the device again 重新配对或切换网络

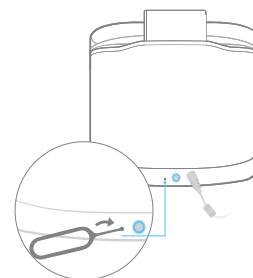

Use retrieve card pin to push the reset hole for 3-4 seconds, the blue light will turn to flash which means the device can be paired again.

当手机无法配对产品或想更换网络设定时，请将卡针插到电源钮旁边的复位孔超过三秒，看到水位窗的蓝光闪烁，表示产品进入配对状态，手机再按照App进行配对。

Water refill and clean 换水清洗

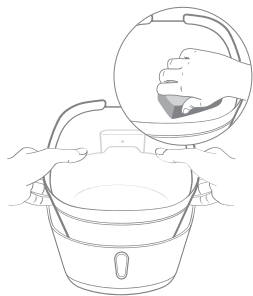

You could take the whole water bucket from device directly without power off, and use washing sponge to clean.

* DO NOT use brush.

* Refill the water to the MAX line, don't be higher than MAX line.

产品无需断电，直接将储水桶拿至水槽，使用海绵清洗后再放回主机即可。

* 请勿使用刷子刷储水桶。

* 装水建议参照水位线范围，不要低于或超过。

Software update 软件升级

In order to make the device better, it will perform reasonably probable software update automatically.

Indication light will be following behavior when software updating:

- Constant blue light
(The water is stopped flowing.)
- ↓
- ⚡ Flashing blue light
- ↓
- Constant blue light
- ↓
- ⚡ Software is updated, and device goes into standby mode.

*DO NOT turn off power when software updating.

本产品会不时执行自动升级以提供更好的服务

当碰到软件升级时的灯光状态:

- 蓝灯长亮(此时产品的水将停止流动)
- ↓
- ⚡ 蓝灯闪烁
- ↓
- 蓝灯长亮
- ↓
- ⚡ 升级成功蓝灯呼吸

* 软件升级时请不要关闭产品电源。

FAQ 疑难排解

Cannot perform pairing? Please check

- Already downloaded "MOORE CARE" app and finished the certification.
- Check the smart phone has connected to Wi-Fi.
- Device can only support Wi-Fi with 2.4GHz (5GHz is unavailable).
- Wi-Fi setting shall not be hidden mode, the SSID must be discoverable.
- Check the blue light are flashing (Pairing mode).
- Connected device numbers of Wi-Fi router shall be less than limitation.
- Check the Wi-Fi SSID and Password.
- Check the firewall settings, whether blocked some ports. (Such as 443).
- Indication light shall be blue and flashing when pairing.

无法成功配对? 请确认以下项目

- 已下载"MOORE CARE"应用并完成手机注册。
- 家中需安装可连线的无线路由器。
- 无线路由器须为2.4GHz频段。
- 无线路由器不可为隐藏模式。
- 配对前，需确保无线路由器可以用手机搜索到，并将手机连接到此网络。
- 当无线路由器连接太多设备将可能配对失败。
- 配对时手机App应用上输入的无线路由器名称(SSID)以及密码须正确。
- 请检查防火墙设置，不可阻挡了常用端口(如443)。
- 配对时摩豆宠物水宝LED必须为蓝灯闪烁状态。

Light instructions 灯光状态

Normal

Blue light	● Constant	⚡ Flashing	● Breath
Status	Starting	Pairing mode	Standby mode

Abnormal

Red light	● Constant	⚡ Flashing	● Breath
Status	Live Streaming	Wi-Fi Disconnected	Insufficient water

常态使用

蓝灯	● 长亮	⚡ 闪烁	● 呼吸
状态	机器开始启动	产品进入配对状态	水量充足 产品处于待机状态

异常提醒

红灯	● 长亮	⚡ 闪烁	● 呼吸
状态	摄像头使用中	网络不通	水量不足

Warring 警告注意

- Do not pull or cut the wire.
- Please make sure you are in safe condition when inserting the plug.
- Please do not use the incorrect adapter.
- Please do not use chloride (ex: bleach) to wash the device.
- Please stop to use the device when any issue happened (Such as high temperature, abnormal noise, etc.)
- Do not disassembly product by youeself.

- 搬运和拆装时请勿拉拽电源线，以免发生短路或断线现象。
- 切勿使用潮湿的手插拔电源插头，会造成触电危险。
- 请勿使用不合适的电源插座。
- 请勿使用氯化物(如漂白剂等)、酸性的洗涤剂，请使用海绵清洗。
- 若产品发出异响和高温，请立即停止使用。
- 请勿自行拆卸产品内部硬体结构。